

15.075-20165-0000

STATE OF KANSAS
STATE CORPORATION COMMISSION

Give All Information Completely
Make Required Affidavit
Mail or Deliver Report to
Conservation Division
State Corporation Commission
245 North Water
Wichita, KS 67202

FORM CP-4

WELL PLUGGING RECORD

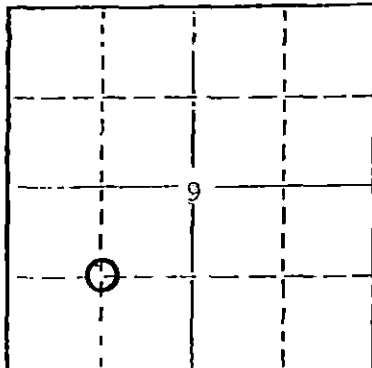

Locate well correctly on above
Section Plot

Hamilton County, Sec. 9 Twp. 24 Rge. 39 (E) W (W)
Location as "NE/CNW/SE/SW" or footage from lines C SW/4
Lease Owner American Public Energy Company
Lease Name Dunn-Burraston Well No. 1
Office Address 8350 No. Central Expressway, Dallas, Tx. 75206
Character of Well (completed as Oil, Gas or Dry Hole) Dry Hole
Date well completed 11-6-76 19
Application for plugging filed (Verbal) 11-6-76 19
Application for plugging approved 11-6-76 19
Plugging commenced 11-6-76 19
Plugging completed 11-6-76 19
Reason for abandonment of well or producing formation No commercial gas shows
If a producing well is abandoned, date of last production 19
Was permission obtained from the Conservation Division or its agents before plugging was commenced? Yes

Name of Conservation Agent who supervised plugging of this well Clarence Thomas
Producing formation _____ Depth to top _____ Bottom _____ Total Depth of Well 3220' Feet
Show depth and thickness of all water, oil and gas formations.

OIL, GAS OR WATER RECORDS				CASING RECORD		
FORMATION	CONTENT	FROM	TO	SIZE	PUT IN	PULLED OUT
Surface Hole	Shale	Surface	375	8-5/8"	366, 9'	None

Describe in detail the manner in which the well was plugged, indicating where the mud fluid was placed and the method or methods used in introducing it into the hole. If cement or other plugs were used, state the character of same and depth placed, from _____ feet to _____ feet for each plug set.
Spotted 35 sacks, 50% Pozmix plus 6% gel through drill pipe w/900'.
Pulled drill pipe to 300' & spotted 35 sacks cement
Made bridge in 8-5/8" casing @ 40' and spotted 15 sacks cement to surface.
Put 5 sacks cement in rat hole.
12-6-76

(If additional description is necessary, use BACK of this sheet)
Name of Plugging Contractor DNB Drilling, Inc. 701 First National Bldg.
Address Wichita, Kansas 67702

STATE OF TEXAS COUNTY OF DALLAS ss.
Elmer T. Ireton (employee of owner) or (owner or operator) of the above-described

well, being first duly sworn on oath, says: That I have knowledge of the facts, statements, and matters herein contained and the log of the above-described well as filed and that the same are true and correct. So help me God.

(Signature) [Signature]
8350 N. Central Expressway, Dallas, Tx 75206
(Address)

SUBSCRIBED AND SWORN TO before me this 2nd day of December, 1976

My commission expires 6-1-77 M. Joyce Degnan Notary Public.

DRILLERS' LOG

AMERICAN PUBLIC ENERGY CORPORATION
 No. 1 Dunn-Burraston
 C SW, Sec. 9-24S-39W
 Hamilton County, Kansas

Commenced: 10-28-76
 Completed: 11-6-76

Surface Casing: 367' of
 8-5/8" cemented w/375 sx
 common cement Class 'H',
 38 cc. 10-29-76

FORMATIONDEPTH

Surface Hole	0 - 375
Shale	375 - 1073
Sand & Shale	1073 - 1765
Shale, Sand & Lime	1765 - 1991
Shale & Lime	1991 - 2360
Lime & Shale	2360 - 2480
Shale	2480 - 2528
Lime & Shale	2528 - 2535
Shale & Lime	2535 - 2885
Lime & Shale	2885 - 2985
Shale & Lime	2985 - 3090
Lime & Shale	3090 - 3220 RTD

12-3-1976
 L. H. ...
 Wichita, Kansas

I do hereby certify that the foregoing statements are true and correct to the best of my knowledge and belief.

D. N. B. DRILLING, INC.

James A. Donelson
 JAMES A. DONELSON

STATE OF KANSAS: ss:

Subscribed and sworn to before me this 18th day of November, 1976.

Ella Priess
 Ella Priess, Notary Public

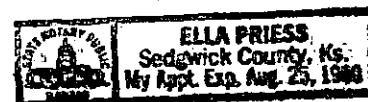

IMPORTANT
 Kans. Geo. Survey request
 samples on this well.

KANSAS DRILLERS LOG

S. 9 T. 24 R. 39 ^R/_W

Loc. C SW

County Hamilton

API No. 15 — 075 — 20,165-0000
County Number

Operator
American Public Energy Company

Address
744 Campbell Centre Dallas, Texas 75206

Well No. #1 Lease Name R. A. Dunn-Burraston

Footage Location
1980 feet from (X) (S) line 1980 feet from (X) (W) line

Principal Contractor DNB Drilling Inc. Geologist R. N. Freeman

Spud Date 10-29-76 Total Depth 3220' P.B.T.D. --

Date Completed 11-6-76 Oil Purchaser ---

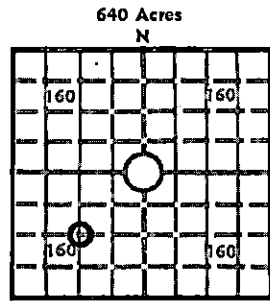

Elev.: Gr. 3290'

DF 3295; KB 3296'

CASING RECORD

Report of all strings set — surface, intermediate, production, etc.

Purpose of string	Size hole drilled	Size casing set (in O.D.)	Weight lbs/ft.	Setting depth	Type cement	Sacks	Type and percent additives
Surf. Csg	12 1/4"	8-5/8"	20#	375	Class "H"	275	3% CaCl

LINER RECORD

PERFORATION RECORD

Top, ft.	Bottom, ft.	Sacks cement	Shots per ft.	Size & type	Depth interval

TUBING RECORD

Size	Setting depth	Packer set at

ACID, FRACTURE, SHOT, CEMENT SQUEEZE RECORD

Amount and kind of material used	Depth interval treated

INITIAL PRODUCTION

Date of first production		Producing method (flowing, pumping, gas lift, etc.)			
RATE OF PRODUCTION PER 24 HOURS	Oil	Gas	Water	Gas-oil ratio	
	bbls.	MCF	bbls.	CFPB	
Disposition of gas (vented, used on lease or sold)			Producing interval(s)		

INSTRUCTIONS: As provided in KCC Rule 82-2-125, within 90 days after completion of a well, one completed copy of this Drillers Log shall be transmitted to the State Geological Survey of Kansas, 4150 Monroe Street, Wichita, Kansas 67209. Copies of this form are available from the Conservation Division, State Corporation Commission, 3830 So. Meridian (P.O. Box 17027), Wichita, Kansas 66217. Phone AC 316-522-2206. If confidential custody is desired, please note Rule 82-2-125. Drillers Logs will be on open file in the Oil and Gas Division, State Geological Survey of Kansas, Lawrence, Kansas 66044.

Operator AMPECO (American Public Energy Company) DESIGNATE TYPE OF COMP.: OIL, GAS, DRY HOLE, SWDW, ETC.:

Well No. 1 Lease Name R. A. Dunn - Burraston Dry Hole

S. 9 T. 24 R. 30 E. W

WELL LOG
 Show all important zones of porosity and contents thereof; cored intervals, and all drill-stem tests, including depth interval tested, cushion used, time tool open, flowing and shut-in pressures, and recoveries. SHOW GEOLOGICAL MARKERS, LOGS RUN, OR OTHER DESCRIPTIVE INFORMATION.

FORMATION DESCRIPTION, CONTENTS, ETC.	TOP	BOTTOM	NAME	DEPTH
<p><u>DRILLSTEM TEST NO. 1</u> 3/4" bottom choke, 1/2" top choke open 15 mins, SI 30 mins Second open 60 mins, Si 60 mins No gas show, no fluid recovered - charts showed tool was open IHP 1291#, IFBHP 53-59# FFBHP 35 to 39#, ISIBHP 35#, FSIBHP 26#, FHP 1291.</p>	2553	2580		
<p><u>DRILLSTEM TEST NO. 2</u> 3/4" Bottom choke, 1/2" top choke Tool open 15 mins, SI 30 mins, Open 60 mins, SI 90 mins Weak blow through both flow periods Rec 3' drlg fluid, no wtr. IHP 1317#, IFBHP 53, FFBHP 53#, ISIBHP 106#, FSIBHP 159#, FHP 1317.</p>	2476	2528		
<p><u>DRILLSTEM TEST NO. 3</u> IFP 15 mins, FFP 60 mins, ISIP 30 mins, FSIP 120 mins. Very weak blow through- out both flow periods. Rec 180' wtr cut mud. IFBHP 26.7 - 91 psi, FFBHP 105 to 118.2 psi, ISIBHP 782.5, FFBHP 787 psi Schlumberger Dual Laterlog 375' 5220' Compensated Neutron 2000' 3220' Caliper & Gamma</p>	2526	2802		

USE ADDITIONAL SHEETS, IF NECESSARY, TO COMPLETE WELL RECORD.

Date Received _____
 Signature: *Elmer T. Ireton*
 Elmer T. Ireton, Manager Production & Engineering
 Title
 December 2, 1976
 Date