

15-009-20945-0000

STATE OF KANSAS  
STATE CORPORATION COMMISSION

WELL PLUGGING RECORD

Give All Information Completely  
Make Required Affidavit  
Mail or Deliver Report to  
Conservation Division  
State Corporation Comm.  
245 North Water  
Wichita, KS 67202

Barton County. Sec. 7 Twp. 16 Rge. 11 E/W  
Location as "NE/CNW $\frac{1}{4}$ SW $\frac{1}{4}$ " or footage from lines

NW NW  
Lease Owner Lario Oil & Gas Co.  
Lease Name Esfeld #3 Well No.  
Office Address Wichita, Kansas 67202  
Character of Well (Completed as Oil, Gas or Dry Hole)

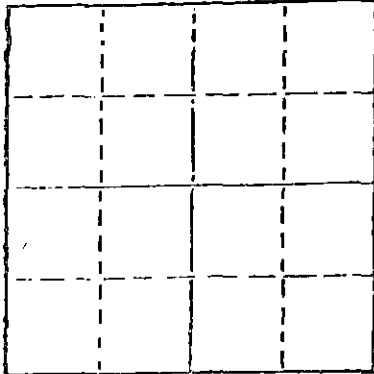

Locate well correctly on above  
Section Plot

Date Well completed 19  
Application for plugging filed 19  
Application for plugging approved 19  
Plugging commenced 4/5/78 19  
Plugging completed 4/10/78 19  
Reason for abandonment of well or producing formation  
depleted.

If a producing well is abandoned, date of last production 19

Was permission obtained from the Conservation Division or  
its agents before plugging was commenced? yes

Name of Conservation Agent who supervised plugging of this well Rankin  
Producing formation Depth to top Bottom Total Depth of Well 3328  
Show depth and thickness of all water, oil and gas formations.

OIL, GAS OR WATER RECORDS

CASING RECORD

FORMATION	CONTENT	FROM	TO	SIZE	PUT IN	PULLED OUT
				8-5/8	786	none
				5-1/2"	3328	2624'

Describe in detail the manner in which the well was plugged, indicating where the mud fluid was placed and the method or methods used in introducing it into the hold. If cement or other plugs were used, state the character of same and depth placed, from feet to feet for each plug set.

Sanded to 2900' and dumped 5 sacks cement. Shot pipe at 2700', 2608', pulled 85 joints. Mudded to 420' and set 20' rock bridge, filled hole with 6 yards ready mix from 400' to base of cellar.

PLUGGING COMPLETE.

RECEIVED  
STATE CORPORATION COMMISSION

APR 17 1978  
4-17-78  
CONSERVATION DIVISION  
Wichita, Kansas

(If additional description is necessary, use BACK of this sheet)

Name of Plugging Contractor KELSO CASING PULLING  
CHASE, KANSAS

STATE OF KANSAS COUNTY OF RICE, ss.  
R. DARRELL KELSO (employee of owner) or (owner or operator)  
of the above-described well, being first duly sworn on oath, says: That I have knowledge of the facts, statements, and matters herein contained and the log of the above-described well as filed and that the same are true and correct. So help me God.

(Signature) *R. Darrell Kelso*  
CHASE, KANSAS  
(Address)

SUBSCRIBED AND SWORN TO before me this 14th day of April, 19 78

My commission expires

MARGARET MELCHER  
Rice County, Ks.  
My Comm. Exp. Feb. 15, 1979

*Margaret Melcher*  
Notary Public.

**KANSAS DRILLERS LOG**

S. 7 T. 16 R. 11 <sup>E</sup><sub>W</sub>

API No. 15 — 009 — 20,945-0900  
County Number

Loc. C NW NW

Operator  
Lario Oil & Gas Company

County Barton

Address  
301 South Market Wichita, Kansas 67202

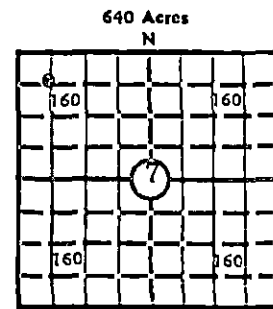

Well No. #3 Lease Name Esfeld

Footage Location  
660 feet from (N) ~~SE~~ 660 feet from ~~SW~~ (W) line

Principal Contractor Red Tiger Drilling Company Geologist Lewis Chubb

Spud Date September 28, 1975 Total Depth 3328 P.B.T.D.

Locate well correctly  
 Elev.: Gr. 1887

Date Completed October 11, 1975 Oil Purchaser Cities Service

DF \_\_\_\_\_ KB 1892

**CASING RECORD**

Report of all strings set — surface, intermediate, production, etc.

Purpose of string	Size hole drilled	Size casing set (in O.D.)	Weight lbs/ft.	Setting depth	Type cement	Sacks	Type and percent additives
		8 5/8		794		350	
		5 1/2		3321		125	18% salt, .75% CFR <sub>2</sub>

**LINER RECORD**

**PERFORATION RECORD**

Top, ft.	Bottom, ft.	Sacks cement	Shots per ft.	Size & type	Depth interval
<b>TUBING RECORD</b>					
Size	Setting depth	Packer set at			

**ACID, FRACTURE, SHOT, CEMENT/SQUEEZE RECORD**

Amount and kind of material used	Depth interval treated
<u>JAN 20 1976</u>	
CONSERVATION DIVISION Wichita, Kansas	

**INITIAL PRODUCTION**

Date of first production <u>October 24, 1975</u>		Producing method (flowing, pumping, gas lift, etc.) <u>Pump</u>			
RATE OF PRODUCTION PER 24 HOURS	Oil <u>77</u> bbls.	Gas bbls.	Water <u>Trace</u> bbls.	Gas-oil ratio	CFPB
Disposition of gas (vented, used on lease or sold)			Producing interval(s) <u>3321-3328</u>		

INSTRUCTIONS: As provided in KCC Rule 82-2-125, within 90 days after completion of a well, one completed copy of this Drillers Log shall be transmitted to the State Geological Survey of Kansas, 4150 Monroe Street, Wichita, Kansas 67209. Copies of this form are available from the Conservation Division, State Corporation Commission, 3830 So. Meridian (P.O. Box 17027), Wichita, Kansas 66217. Phone AC 316-522-2206. If confidential custody is desired, please note Rule 82-2-125. Drillers Logs will be on an open file in the Oil and Gas Division, State Geological Survey of Kansas, Lawrence, Kansas 66044.

Operator Lario Oil & Gas Company		DESIGNATE TYPE OF COMP.: OIL, GAS, DRY HOLE, SWDW, ETC.: Oil
Well No. 3	Lease Name Esfeld	
S <u>7</u> T <u>16S</u> R <u>7</u> <u>E</u> <u>XX</u>		

**WELL LOG**

Show all important zones of porosity and contents thereof; cored intervals, and all drill-stem tests, including depth interval tested, cushion used, time tool open, flowing and shut-in pressures, and recoveries.

SHOW GEOLOGICAL MARKERS, LOGS RUN, OR OTHER DESCRIPTIVE INFORMATION.

FORMATION DESCRIPTION, CONTENTS, ETC.	TOP	BOTTOM	NAME	DEPTH
Post Rock	0	55	Anhydrite	754
Shale	55	170	Topeka	2650
Sand & Shale	170	444	Heebner	2938
Hard Sand	444	453	Toronto	2958
Shale, Hard Sand & Pyrite	453	467	Douglas	2970
Shale	467	730	Brown Lime	3031
Red Bed	730	756	Lansing	3047
Anhydrite	756	782	Base K.C.	3302
Shale	782	1450	Arbuckle	3321
Lime & Shale	1450	1640		
Shale	1640	1877		
Lime & Shale	1877	2670		
Lime	2670	3328		

USE ADDITIONAL SHEETS, IF NECESSARY, TO COMPLETE WELL RECORD.

Date Received	<i>ME Kraft</i> Signature
	Div. Prod. Supt. Title
	October 27, 1975 Date