

STATE OF KANSAS
STATE CORPORATION COMMISSION

15-09-22346-0000

WELL PLUGGING RECORD

Give All Information Completely
Make Required Affidavit
Mail or Deliver Report to
Conservation Division
State Corporation Comm.
245 North Water
Wichita, KS 67202

Barton County. Sec. 7 Twp. 16S Rge. 11 NW
Location as "NE/CNW $\frac{1}{4}$ /SW $\frac{1}{4}$ " or footage from lines _____
S/2 SE SW

Lease Owner Rains & Williamson Oil Co., Inc.
Lease Name Staudinger Well No. #2
Office Address 435 Page Court, 220 W. Douglas, Wichita, Ks.
Character of Well (Completed as Oil, Gas or Dry Hole) _____

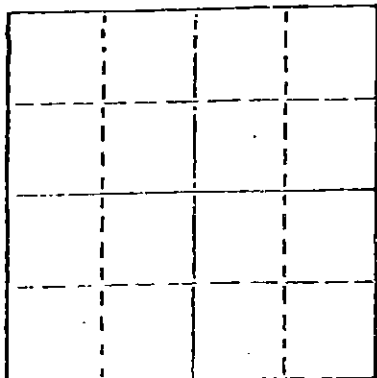

Locate well correctly on above
Section Plat

Dry Hole
Date Well completed 5-2-81 19
Application for plugging filed 5-2-81 19
Application for plugging approved 5-2-81 19
Plugging commenced 5-2-81 19
Plugging completed 5-2-81 19

Reason for abandonment of well or producing formation _____
Commercial quantities of oil not found
If a producing well is abandoned, date of last production _____ 19.

Was permission obtained from the Conservation Division or
its agents before plugging was commenced? Yes

Name of Conservation Agent who supervised plugging of this well Gilbert Tolman
Producing formation _____ Depth to top _____ Bottom _____ Total Depth of Well 3335'
Show depth and thickness of all water, oil and gas formations.

OIL, GAS OR WATER RECORDS

CASING RECORD

| FORMATION | CONTENT | FROM | TO | SIZE | PUT IN | PULLED OUT |
|-----------|---------|------|----|--------|--------|------------|
| | | | | 8 5/8" | 287' | None |
| | | | | | | |
| | | | | | | |
| | | | | | | |

Describe in detail the manner in which the well was plugged, indicating where the mud fluid was placed and the method or methods used in introducing it into the hold. If cement or other plugs were used, state the character of same and depth placed, from _____ feet to _____ feet for each plug set.

Plug @ 500' w/40 sx.
Plug @ 280' w/25 sx.
Plug @ 40' w/10 sx.
Rat Hole 5 sx.

(If additional description is necessary, use BACK of this sheet)

Name of Plugging Contractor Rains & Williamson Oil Co., Inc.

STATE OF Kansas COUNTY OF Sedgwick, ss.
Wilson Rains, President of Rains & Williamson Oil Co. (employee of owner) or (owner or operator) of the above-described well, being first duly sworn on oath, says: That I have knowledge of the facts, statements, and matters herein contained and the log of the above-described well as filed and that the same are true and correct. So help me God.

(Signature) Wilson Rains
435 Page Court, 220 W. Douglas, Wichita, Kans. 67202
(Address)

SUBSCRIBED AND SWORN TO before me this 6 day of May, 1981

My commission expires 10-4-83

Juanita M. Green
Juanita M. Green Notary Public.

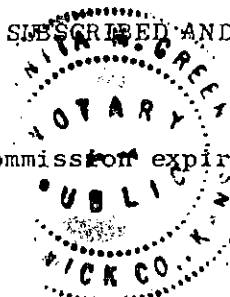

RECEIVED
STATE CORPORATION COMMISSION

MAY 14 1981
5-14-81
CONSERVATION DIVISION
Wichita, Kansas

DRILLER'S LOG

15009-22346-0000

COMPANY: Rains & Williamson Oil Co., Inc.

SEC. 7 T. 16S R. 11W

WELL NAME: Staudinger #2

LOC. S/2 SE SW

COUNTY: Barton

RIG NO. #9

TOTAL DEPTH 3335'

ELEVATION 1867 KB

COMMENCED: 4-25-81

COMPLETED: 5-2-81

CONTRACTOR: Rains & Williamson Oil Co., Inc.

CASING RECORD:

SURFACE: 8 5/8" @ 287' w/175 sx. 60/40 poz., 3% cc., 2% gel.

PRODUCTION: D&A

LOG

(Figures Indicate Bottom of Formations)

| | |
|---------------------------|-------------|
| Sand & Shale | 295 |
| Shale | 1398 |
| Shale & Lime | 2180 |
| Lime & Shale | 3335 |
| <u>ROTARY TOTAL DEPTH</u> | <u>3335</u> |

RECEIVED
STATE CORPORATION COMMISSION

MAY 14 1981

CONSERVATION DIVISION
Wichita, Kansas

STATE OF Kansas)

COUNTY OF Sedgwick)

SS:

I, Wilson Rains, President of Rains & Williamson Oil Co., Inc.
upon oath state that the above and foregoing is a true and correct copy of the log of the
Staudinger #2 well.

Wilson Rains
Wilson Rains

Subscribed and sworn to before me this 6 day of May, 1981.

My Appointment Expires:

10-4-83

Juanita M. Green
Juanita M. Green

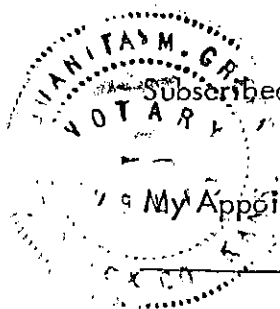

KANSAS DRILLERS LOG

RECEIVED
STATE CORPORATION COMMISSION 7 T. 16S R. 11 W

API No. 15 — 009 — 22346-0000
County Number

MAY 18 1981

Loc. S/2 SE SW

County Barton

Operator
Rains & Williamson Oil Co., Inc.

CONSERVATION DIVISION
Wichita, Kansas

Address
435 Page Court, 220 W. Douglas, Wichita, Kansas 67202

Well No. #2 Lease Name Staudinger

Footage Location
feet from (N) (S) line feet from (E) (W) line

Principal Contractor Rains & Williamson Oil Co., Inc. Geologist Kenneth B. Hamlin

Spud Date 4-25-81 Total Depth 3335' P.B.T.D.

Date Completed 5-2-81 Oil Purchaser

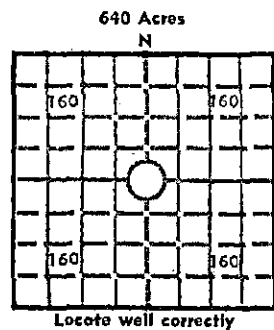

Elev.: Gr. _____

DF _____ KB 1867

CASING RECORD

Report of all strings set — surface, intermediate, production, etc.

| Purpose of string | Size hole drilled | Size casing set (in O.D.) | Weight lbs/ft. | Setting depth | Type cement | Sacks | Type and percent additives |
|-------------------|-------------------|---------------------------|----------------|---------------|-------------|---------|----------------------------|
| | 12 1/4" | 8 5/8" | 20# | 287' | 60/40 poz. | 175 sx. | 3% cc., 2% gel. |
| | | | | | | | |
| | | | | | | | |
| | | | | | | | |

LINER RECORD

PERFORATION RECORD

| Top, ft. | Bottom, ft. | Sacks cement | Shots per ft. | Size & type | Depth interval |
|----------|-------------|--------------|---------------|-------------|----------------|
| | | | | | |

TUBING RECORD

| Size | Setting depth | Packer set at |
|------|---------------|---------------|
| | | |

ACID, FRACTURE, SHOT, CEMENT SQUEEZE RECORD

| Amount and kind of material used | Depth interval treated |
|----------------------------------|------------------------|
| | |
| | |
| | |

INITIAL PRODUCTION

| | | | | | |
|--|-------|---|------------------------|---------------|--|
| Date of first production | | Producing method (flowing, pumping, gas lift, etc.) | | | |
| RATE OF PRODUCTION PER 24 HOURS | Oil | Gas | Water | Gas-oil ratio | |
| | bbls. | MCF | bbls. | CFPB | |
| Disposition of gas (vented, used on lease or sold) | | | Producing interval (s) | | |

INSTRUCTIONS: As provided in KCC Rule 82-2-125, within 90 days after completion of a well, one completed copy of this Drillers Log shall be transmitted to the State Geological Survey of Kansas, 4150 Monroe Street, Wichita, Kansas 67209. Copies of this form are available from the Conservation Division, State Corporation Commission, 3830 So. Meridian (P.O. Box 17027), Wichita, Kansas 66217. Phone AC 316-522-2206. If confidential custody is desired, please note Rule 82-2-125. Drillers Logs will be on an open file in the Oil and Gas Division, State Geological Survey of Kansas, Lawrence, Kansas 66044.

Operator Rains & Williamson Oil Co., Inc. DESIGNATE TYPE OF COMP.: OIL, GAS, DRY HOLE, SWDW, ETC.: Dry Hole

Well No. #9 Lease Name Staudinger #2

S 7 T 16S R 11^W

WELL LOG

Show all important zones of porosity and contents thereof; cored intervals, and all drill-stem tests, including depth interval tested, cushion used, time tool open, flowing and shut-in pressures, and recoveries.

SHOW GEOLOGICAL MARKERS, LOGS RUN, OR OTHER DESCRIPTIVE INFORMATION.

| FORMATION DESCRIPTION, CONTENTS, ETC. | TOP | BOTTOM | NAME | DEPTH |
|--|-----|--------|--------------------|---------------------|
| DST #1 - 3012-3060, 30 (30) 60 (30). Rec. 180' GIP, 210' SO&GCM. FP's 59-59, 71-95. IBHP 307, FBHP 307. Temp. 101°. | | | <u>SAMPLE TOPS</u> | |
| | | | Anhydrite | 728 (+1139) |
| | | | B/Anhydrite | 755 (+1112) |
| | | | Topeka | 2625 (-758) |
| | | | Heebner | 2914 (-1047) |
| | | | Toronto | 2932 (-1065) |
| | | | Douglas | 2945 (-1078) |
| | | | Brown Lime | 3009 (-1142) |
| | | | Lansing | 3021 (-1154) |
| | | | Congl. Sand | 3319 (-1452) |
| | | | <u>RTD</u> | <u>3335 (-1468)</u> |
| DST #2 - 3278-3335, 30 (30) 60 (30). Rec. 1543' saltwater w/sp. oil in top two jts. FP's 442-560, 709-768. IBHP 756, FBHP 855. | | | | |

USE ADDITIONAL SHEETS, IF NECESSARY, TO COMPLETE WELL RECORD.

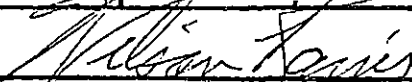
| | |
|---------------|--|
| Date Received |  |
| | Wilson Rains <small>Signature</small> |
| | President <small>Title</small> |
| | 5-13-81 <small>Date</small> |