

Give All Information Completely
Make Required Affidavit
Mail or Deliver Report to:
Conservation Division
State Corporation Commission
500 Bittling Building
Wichita, Kansas

15. 167. 04295.00.00
WELL PLUGGING RECORD

NORTH

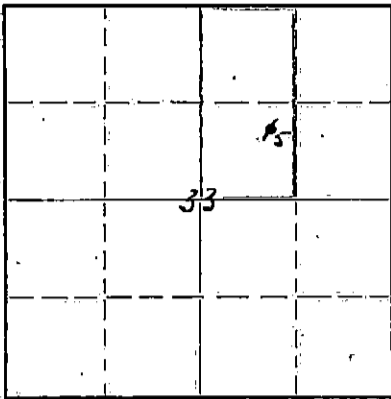

Locate well correctly on above Section Plat

Russell County, Sec. 33, Twp 13S, Rge. (E) 14 (W)
Location as "NE/CNW 1/4 SW 1/4" or footage from lines NE/4 ~~SW/4~~ NE/4
Lease Owner Skelly Oil Company
Lease Name Boxberger "A" Well No. 5
Office Address Box 1650, Tulsa, Oklahoma
Character of Well (completed as Oil, Gas or Dry Hole) Dry Hole
Date well completed February 21, 1949
Application for plugging filed February 22, 1949
Application for plugging approved February 24, 1949
Plugging commenced February 21, 1949
Plugging completed February 21, 1949
Reason for abandonment of well or producing formation Dry Hole

If a producing well is abandoned, date of last production 19
Was permission obtained from the Conservation Division or its agents before plugging was commenced? Yes (verbally)

Name of Conservation Agent who supervised plugging of this well C. D. Stough
Producing formation None Depth to top Bottom Total Depth of Well 3353 Feet
Show depth and thickness of all water, oil and gas formations.

OIL, GAS OR WATER RECORDS

CASING RECORD

Formation	Content	From	To	OD Size	Put In	Pulled Out
Arhuckle Lime	Dry	3335'	3353'	8-5/8"	909'2"	None

Describe in detail the manner in which the well was plugged, indicating where the mud fluid was placed and the method or methods used in introducing it into the hole. - If cement or other plugs were used, state the character of same and depth placed, from feet to feet for each plug set.

25 sacks of cement 3353' to 3272'
Mud laden fluid 3272' to 900'
25 sacks of cement 900' to 822'
Mud laden fluid 822' to 40'
25 sacks of cement 40' to 6'
Surface soil 6' to 0'

(If additional description is necessary, use BACK of this sheet)

Correspondence regarding this well should be addressed to Skelly Oil Company
Address Box 391
Hutchinson, Kansas

STATE OF Kansas COUNTY OF Reno ss.
H. E. Wamsley (employee of owner, lessor or operator) of the above-described well,
being first duly sworn on oath, says: That I have knowledge of the facts, statements, and matters herein contained and the log of the above-described well as filed and that the same are true and correct. So help me God.

(Signature) *[Handwritten Signature]*
Box 391, Hutchinson, Kansas
(Address)

SUBSCRIBED AND SWORN to before me this 31st day of March, 1949.

My commission expires April 7, 1951

[Handwritten Signature]
Notary Public.

PLUGGING
FILE SEC 33 T 13 R 14W
BOOK PAGE 84 LINE 16

SKELLY OIL COMPANY

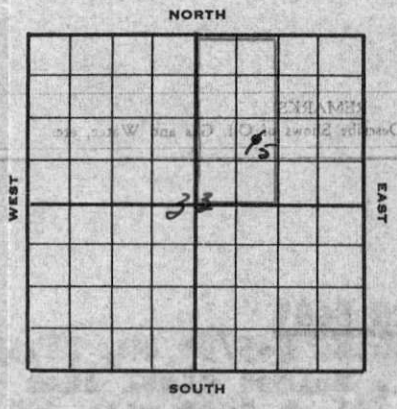

Well Record

Lease Name and No. Borberger "A" 711075 Well No. 5 Elev. 1864'07
 Lease Description 1/2 NE/4 Sec. 33-130-14N, Russell County, Kansas
 Location made February 5, 1949 by E. S. Tompler
990 feet from North line 990 feet from East line 115/4
990 feet from South line 990 feet from West line of Sec. 33

Work com'd. 2/6 1949 Rig comp'd. 2/8 1949 Drlg. com'd. 2/8 1949 Drlg. comp'd. 2/21 1949
 Rig Contractor Claude Wentworth Drilling Co., Inc.
 Drilling Contractor Claude Wentworth Drilling Co., Inc., Tulsa, Oklahoma
 Rotary Drilling from Top to 3353' Cable Tool Drilling from _____ to _____

Commenced Producing DRY HOLE 19____ { Initial Prod. before shot or acid _____ Bbls.
 Initial Prod. after shot or acid _____ Bbls.
 Dry Gas Well Press _____ Volume _____ Cu. ft.
 Casing Head Gas Pressure _____ Volume _____ Cu. ft.
 Braden Head (_____ Size) Gas Pressure _____ Volume _____ Cu. ft.
 Braden Head (_____ Size) Gas Pressure _____ Volume _____ Cu. ft.

PRODUCING FORMATION DRY HOLE (Name) Top _____ Bottom _____ TOTAL DEPTH 3353'

CASING RECORD

OD Size	Wt.	Thds.	Where Set	PULLED OUT			LEFT IN			KIND	Cond'n	CEMENTING	
				Jts.	Feet	In.	Jts.	Feet	In.			Sacks Used	Method Employed
<u>8-5/8"</u>	<u>28 1/2</u>	<u>SR</u>	<u>905'</u>				<u>41</u>	<u>907</u>	<u>2</u>	<u>RI LF</u>	<u>A</u>	<u>450</u>	<u>Halliburton</u>
<u>(8-5/8" OD casing set 6' in collar)</u>													

Liner Set at _____ Length _____ Perforated at _____
 Liner Set at _____ Length _____ Perforated at _____
 Packer Set at _____ Size and Kind _____
 Packer Set at _____ Size and Kind _____

SHOT OR ACID TREATMENT RECORD

Date	FIRST		SECOND		THIRD		FOURTH	
	Ft.	and Ft.	Ft.	and Ft.	Ft.	and Ft.	Ft.	and Ft.
Acid Used								
Size Shot								
Shot Between								
Size of Shell								
Put in by (Co.)								
Length anchor								
Distance below Cas'g								
Damage to Casing or Casing Shoulder								

SIGNIFICANT GEOLOGICAL FORMATIONS

NAME	Top	Bottom	GAS		OIL		REMARKS
			From	To	From	To	
<u>Heobner shale</u>	<u>2995'</u>						
<u>Lansing line</u>	<u>3048'</u>						
<u>Arbuckle line</u>	<u>3335'</u>				<u>3335'</u>	<u>3344'</u>	<u>oil, por. & stained</u>
					<u>3344'</u>	<u>3353'</u>	<u>slightly porous</u>

CLEANING OUT RECORDS

	DATE COMMENCED	DATE COMPLETED	PROD. BEFORE	PROD. AFTER	REMARKS
1st					See Reverse for other details.
2nd					" " " " "
3rd					" " " " "
4th					" " " " "

PLUGGING BACK AND DEEPENING RECORDS

	Date Commenced	Date Completed	No. Feet Plugged Back or Deepened	Prod. Before	Prod. After	REMARKS
1st						See Reverse for other details.
2nd						" " " " "
3rd						" " " " "
4th						" " " " "

(See Reverse for Record of Formation)

RECORD OF FORMATIONS

Table with columns: FORMATION, TOP, BOTTOM, REMARKS. Includes geological descriptions like 'Surface and line sand', 'shale and shells', 'pyrites of iron', etc.

Table with columns: KIND, LEFT IN, PULLED OUT, etc. Includes text: 'Nan Halliburton drill stem test with packer set at 3335', 'and recovered 10' of sulphur water, no oil.'

Plugged and abandoned February 21, 1949. PLUGGING FILE SEC 82 T 13 R 140 BOOK PAGE 84 LINE 16

Table with columns: REMARKS, PROD. BEFORE, PROD. AFTER, DATE COMPLETED, etc. Includes text: 'Tests were taken at 250' intervals from 250' to 500' inc., with no deviation from vertical noted.'

Table with columns: REMARKS, PROD. BEFORE, PROD. AFTER, DATE COMPLETED, etc. Includes text: 'CLEANING OUT RECORDS'

Table with columns: REMARKS, PROD. BEFORE, PROD. AFTER, DATE COMPLETED, etc. Includes text: 'PLUGGING BACK AND DEEPENING RECORDS'

(See Reverse for Record of Formations)