

STATE OF KANSAS
STATE CORPORATION COMMISSION

WELL PLUGGING RECORD

Give All Information Completely
Make Required Affidavit
Mail or Deliver Report to:
Conservation Division
State Corporation Commission
211 No. Broadway
Wichita, Kansas

NORTH

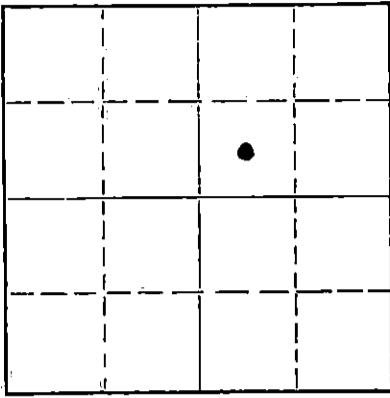

Locate well correctly on above
Section Plat

Hamilton County, Sec. 31 Twp 22S Rge. 40 (E) W (W)
Location as "NE/CNWxSWx" or footage from lines 1980' E & 1980' From North
Lease Owner Livingston Oil Company
Lease Name # 3120 F. Adams Well No. 3120
Office Address Box 610 Syracuse, Kansas
Character of Well (completed as Oil, Gas or Dry Hole) Dry Hole
Date well completed 9-18-1962
Application for plugging filed 11-23-1964
Application for plugging approved 11-24-1964
Plugging commenced 11-24-1964
Plugging completed 11-24-1964
Reason for abandonment of well or producing formation Not Enough Gas Volume & Too much water
If a producing well is abandoned, date of last production None 19
Was permission obtained from the Conservation Division or its agents before plugging was commenced? Yes

Name of Conservation Agent who supervised plugging of this well Hugh Scott
Producing formation Wintfield Depth to top 2586' Bottom 2606' Total Depth of Well 2607 Feet
Show depth and thickness of all water, oil and gas formations.

OIL, GAS OR WATER RECORDS

CASING RECORD

FORMATION	CONTENT	FROM	TO	SIZE	PUT IN	PULLED OUT
				7 5/8	120	none
				4 3/8	2592	none

Describe in detail the manner in which the well was plugged, indicating where the mud fluid was placed and the method or methods used in introducing it into the hole. If cement or other plugs were used, state the character of same and depth placed, from _____ feet to _____ feet for each plug set.

Mix 20 sacks cement to plug off open hole at 2592. Stop plug at 2500'. Pump 10 sacks cement at 200' to 100' and 5 sacks cement 50' to 0'. Cut off and cap same. Complete 11-24-64

RECEIVED
STATE CORPORATION COMMISSION

DEC 9 1964 12-09-64

CONSERVATION DIVISION
Wichita, Kansas

(If additional description is necessary, use BACK of this sheet)

Name of Plugging Contractor Sargent's Casing Pulling Service
Address Box 506 Liberal, Kansas

STATE OF Kansas, COUNTY OF Hamilton, ss.

(employee or owner) or (owner or operator) of the above-described well, being first duly sworn on oath, says: That I have knowledge of the facts, statements, and matters herein contained and the log of the above-described well as filed and that the same are true and correct. So help me God.

(Signature) Max Townsend
Box 610 Syracuse, Kas.
(Address)

SUBSCRIBED AND SWORN to before me this 8th day of December, 1964

My commission expires June 20, 1967

Steve N. McDonald
Notary Public.



Kansas

(STATE)

Hamilton

(COUNTY)

Bradshaw

(FIELD)

Livingston Oil Company

WELL PROGRESS REPORT

Plug & Abandon Report

3120

(LEASE & WELL NUMBER)

(SUBDIVISION)

31-22-40

(SEC., TWP. & RGE.)

DATE	DEPTH		REMARKS
	From	To	
11-23-64			Sargent's Casing pulling rigged up & put 20 sks Common Cement plus at 3100' then come up hole to 300' & put 15 sks. Common cement from 200' to 0'
11-24-64			Hot welding cut pipe off at 4' below ground & welded on plates. Covered up same. Complete on 11-24-64 State plugged. Mr. Hugh Scott on job.
			Cement was circulated, on 4 1/2" when run.

RECEIVED
STATE CORPORATION COMMISSION

DEC 9 1964

CONSERVATION DIVISION
Wichita, Kansas

15-075-10077.0000

STATEMENT

Livingston Oil Company

Box 610

Syracuse, Kansas

In Account With

SARGENT'S CASING PULLING SERVICE
Phone MA. 4-7455 121 West 9th Street
Liberal, Kansas

Adams # 3120

Date	Invoice No.		Amount	
11-30-64	(515)	Plug and clean out cellar on well #3120.	200.	00
		Kill well and stand by while tubing was being pulled.	100.	00
		Total	<u>\$300.</u>	<u>00</u>
		Thanks		

RECEIVED
STATE CORPORATION COMMISSION
DEC 9 1964
CONSERVATION DIVISION
Wichita, Kansas

GAS WELL OR LAND SURVEY

Plat No. _____

PROPERTY OWNERS F. Adams # 1-31 Hamilton Bro. Inc.

STATE OF Kansas TO BE A Well location SURVEY

Surveyed: 11-10, 1961; Platted 11-14, 1961; The fee will be \$ 85.00 / 5.70

This Section is: 5241.0 ft. Ch. wide as found in the field on north
5207.4 ft. wide as per State notes = \$ 90.70

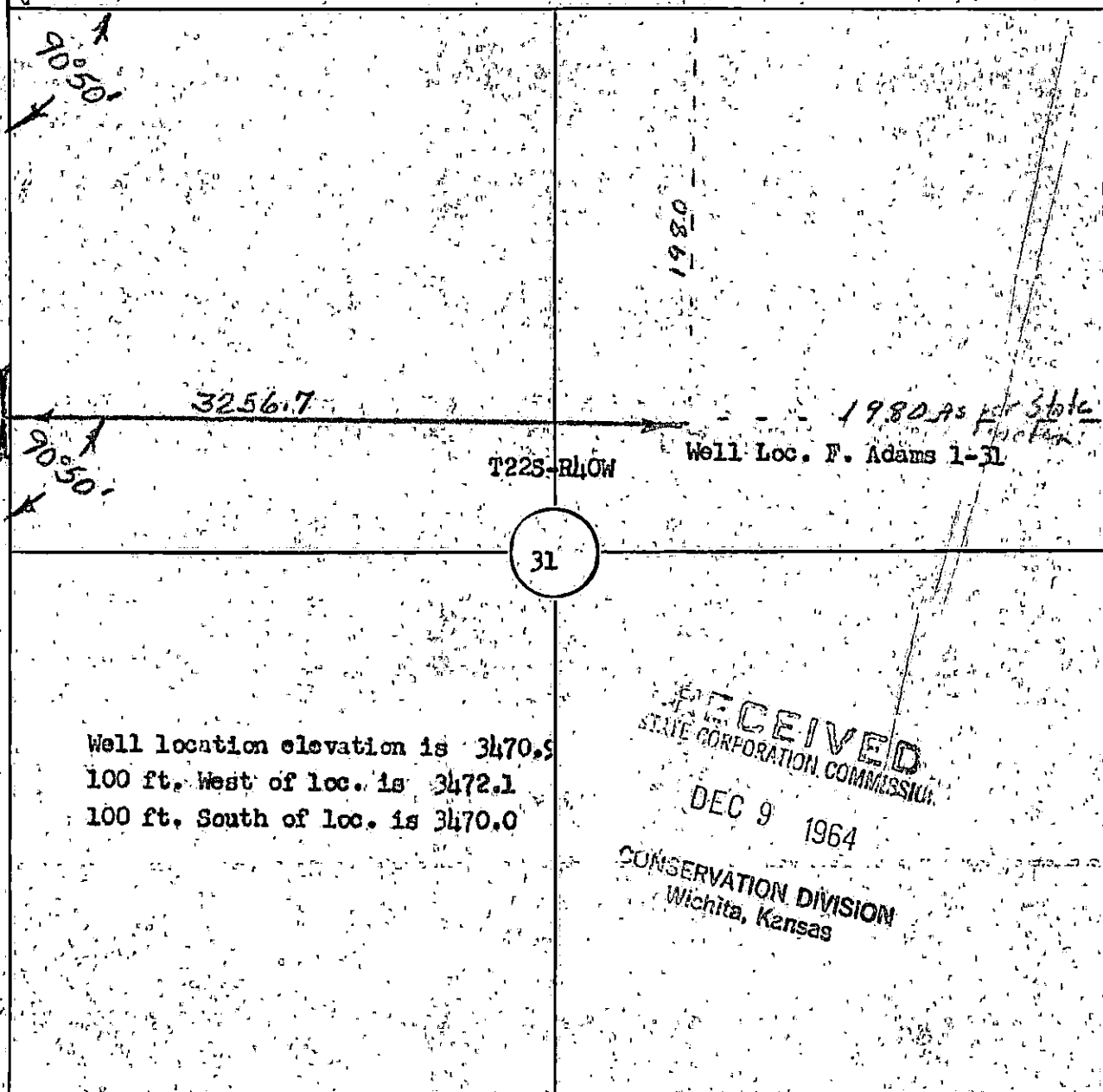

Scale: 1" = 800 ft.

This Section is: 5285.0' Calc. wide as found in the field on west
5280' wide as per State notes

This Section is: 5280 ft. wide as found in the field on east
5280' wide as per State notes

This Section is: 5282.1 ft. Calc. wide as found in the field on south
5280 ft. wide as per State notes

Northwest corner of Section 30-T22S-R40W
R.P. 40d Spk. C.F.P. 85.0 NE
R.P. 40d Spk. H.L.P. 62.0 NW
Blacktop North and South

Northeast corner of Section 31-T22S-R40W
R.P. 40d Spk. in C.F.P. 35.2 NE
R.P. 3" Pipe 8 ft. high 22.4 N.W.
Fe. going south is 23.0 east
Fe. going west is 29.0 north

P. S. Checking later from other surveys, the north side in field was 5241.0 ft. and south side 5282.1. Hence the well should have gone east 19.7 ft. however it is staked according to State Notes, with the corners shown as found in the field.

I, Herbert C. Williams being a Registered Professional Civil Engineer in the State of Texas, Seal No. 5859; in the State of Kansas, Seal No. 3147; in the State of Oklahoma, Seal No. 138 and a licensed County Engineer under the laws of the State of Oklahoma; do hereby certify that I made this survey

of all of Section 31-T22S-R40W in the County of Hamilton State of Kansas and certify that all measurements, bearings, and monuments are correctly shown and indicated on the above plat as found and staked in the field as so dated above.

Witness my hand and seal this 14 day of November, 1961

Signed: H. C. Williams

H. C. WILLIAMS
Consulting and County Engineer
of Texas County, Oklahoma
1201 James, Guymon, Oklahoma
Office phone 338-6904 and Resident phone 338-6923