

STATE OF KANSAS  
STATE CORPORATION COMMISSION

WELL PLUGGING RECORD

Give All Information Completely  
Make Required Affidavit  
Mail or Deliver Report to  
Conservation Division  
State Corporation Comm.  
245 North Water  
Wichita, KS 67202

Hamilton County. Sec. 18 Twp. 22 Rge. 41W E/W  
Location as "NE/CNW $\frac{1}{4}$ SW $\frac{1}{4}$ " or footage from lines  
C/NE/NE

Lease Owner Ladd Petroleum Corporation  
Lease Name HCU Well No. 1821 "B"  
Office Address Box 520, Great Bend, KS 67530  
Character of Well (Completed as Oil, Gas or Dry Hole)  
Oil

Date Well completed 19  
Application for plugging filed 19  
Application for plugging approved 19  
Plugging commenced October 14 1980  
Plugging completed October 30 1980  
Reason for abandonment of well or producing formation  
Depleted

If a producing well is abandoned, date of last production 19

Was permission obtained from the Conservation Division or its agents before plugging was commenced? Yes

Name of Conservation Agent who supervised plugging of this well Clarence Thomas, Jr.  
Producing formation Depth to top Bottom Total Depth of Well 2700'  
Show depth and thickness of all water, oil and gas formations.

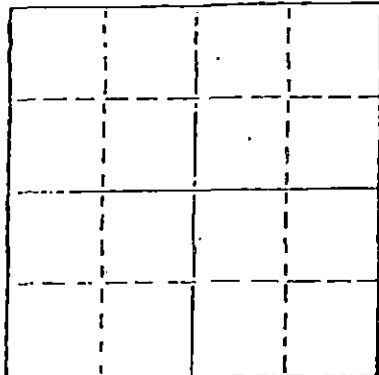

Locate well correctly on above Section Plot

OIL, GAS OR WATER RECORDS

CASING RECORD

FORMATION	CONTENT	FROM	TO	SIZE	PUT IN	PULLED OUT
				8-5/8"	325'	None
				4-1/2"	2700	2010.16'

Describe in detail the manner in which the well was plugged, indicating where the mud fluid was placed and the method or methods used in introducing it into the hold. If cement or other plugs were used, state the character of same and depth placed, from feet to feet for each plug set.

Dumped sand to 2625' and 4 sacks cement.  
Shot pipe at 2200', 2100' and 2000'.  
Pulled 64 joints of 4-1/2" casing.  
Halliburton plugged well with 50 sacks cement at 350' and 10 sacks cement from 40' to surface.

(If additional description is necessary, use BACK of this sheet)

Name of Plugging Contractor Rockhold Engineering, Inc.

STATE OF KANSAS COUNTY OF BARTON, ss.  
(employee of owner) or (owner or operator)  
of the above-described well, being first duly sworn on oath, says: That I have knowledge of the facts, statements, and matters herein contained and the log of the above-described well as filed and that the same are true and correct. So help me God.

(Signature)

James W. Rockhold, Box 698, Great Bend, KS 67530  
(Address)

SUBSCRIBED AND SWORN TO before me this 3rd day of December, 19 80

Ruth L. Sloan

Notary Public.

My commission expires September 27, 1981

Ruth L. Sloan

RECEIVED  
STATE CORPORATION COMMISSION

DEC - 5 1980

CONSERVATION DIVISION  
Wichita, Kansas

**KANSAS DRILLERS LOG**

S. 18 T. 22 R. 41 F  
W

API No. 15<sup>a</sup> - 075 - 30017-0000  
County Number

Loc. C NE NE  
 County Hamilton

Operator  
Ladd Petroleum Corporation

Address  
830 Denver Club Bldg., Denver, CO 80202

Well No. 1821-B Lease Name HCU

Footage Location  
660 feet from (N) (S) line 660 feet from (E) (W) line

Principal Contractor \_\_\_\_\_ Geologist \_\_\_\_\_

Spud Date 12/12/64 Total Depth \_\_\_\_\_ P.B.T.D. 2700'

Date Completed 12/17/64 Oil Purchaser \_\_\_\_\_

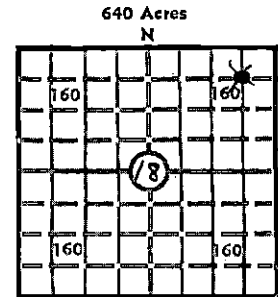

Locate well correctly  
 Elev.: Gr. 3610'  
 DF \_\_\_\_\_ KB \_\_\_\_\_

**CASING RECORD**

Report of all strings set — surface, intermediate, production, etc.

Purpose of string	Size hole drilled	Size casing set (in O.D.)	Weight lbs/ft.	Setting depth	Type cement	Sacks	Type and percent additives
surface	12 1/4"	8-5/8"	28#	325'	common	300	3% sunset cmt
production	7-7/8"	4 1/2"	9.5#	2700'		100	

**LINER RECORD**

**PERFORATION RECORD**

Top, ft.	Bottom, ft.	Sacks cement	Shots per ft.	Size & type	Depth interval
					2678-2674' *

Size	Setting depth	Packer set at:
1 1/4"	2674'	

**ACID, FRACTURE, SHOT, CEMENT SQUEEZE RECORD**

Amount and kind of material used	Depth interval treated
Frac - 2000 gal 3% gel acid, 2000# 20-40 sand & 100# 12-20 wal-nut hulls	2678-2674'

**RECEIVED**  
 STATE CORPORATION COMMISSION

**INITIAL PRODUCTION**

**SEP 29 1980**

Date of first production 1/11/65 Producing method (flowing, pumping, gas lift, etc.) Flowing

RATE OF PRODUCTION PER 24 HOURS  
 Oil \_\_\_\_\_ Gas 230 MCF Water \_\_\_\_\_  
bbls. bbls. CFPB

Disposition of gas (vented, used on lease or sold) SI (1st gas sold 3/23/65) Producing interval (s) Winfield

**INSTRUCTIONS:** As provided in KCC Rule 82-2-125, within 90 days after completion of a well, one completed copy of this Drillers Log shall be transmitted to the State Geological Survey of Kansas, 4150 Monroe Street, Wichita, Kansas 67209. Copies of this form are available from the Conservation Division, State Corporation Commission, 3830 So. Meridian (P.O. Box 17027), Wichita, Kansas 66217. Phone AC 316-522-2206. If confidential custody is desired, please note Rule 82-2-125. Drillers Logs will be on open file in the Oil and Gas Division, State Geological Survey of Kansas, Lawrence, Kansas 66044.

DESIGNATE TYPE OF COMP.: OIL, GAS, DRY HOLE, SWDW, ETC.:

Operator  
Ladd Petroleum Corporation

Well No. 1821-B Lease Name HCU

gas

S 18 T 22 R 41 E W

WELL LOG

Show all important zones of porosity and contents thereof; cored intervals, and all drill-stem tests, including depth interval tested, cushion used, time tool open, flowing and shut-in pressures, and recoveries.

SHOW GEOLOGICAL MARKERS, LOGS RUN, OR OTHER DESCRIPTIVE INFORMATION.

FORMATION DESCRIPTION, CONTENTS, ETC.	TOP	BOTTOM	NAME	DEPTH
Winfield	2674			

USE ADDITIONAL SHEETS, IF NECESSARY, TO COMPLETE WELL RECORD.

Date Received

*Michael J. Wardling*  
 Signature  
 Production Engineer  
 Title  
 9/24/80  
 Date