

Give All Information Completely
Make Required Affidavit
Mail or Deliver Report to:
Conservation Division
State Corporation Commission
211 No. Broadway
Wichita, Kansas

WELL PLUGGING RECORD

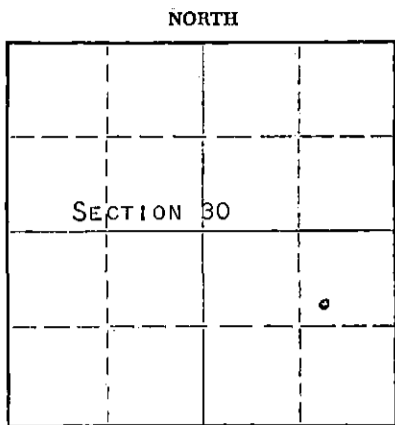

Locate well correctly on above Section Plat

STAFFORD County. Sec. 30 Twp. 24S Rge. 13W ~~(E)~~ X (W)
Location as "NE/CNW/SW" or footage from lines SW NE SE
Lease Owner PETROLEUM, INC.
Lease Name TOLAND "F" Well No. 1
Office Address ROUTE 2, GREAT BEND, KANSAS
Character of Well (completed as Oil, Gas or Dry Hole) DRY HOLE
Date well completed FEBRUARY 15, 19 62
Application for plugging filed FEBRUARY 19, 19 62
Application for plugging approved FEBRUARY 28, 19 62
Plugging commenced MARCH 1, 19 62
Plugging completed MARCH 7, 19 62
Reason for abandonment of well or producing formation NO PRODUCIBLE FORMATION

If a producing well is abandoned, date of last production NONE 19
Was permission obtained from the Conservation Division or its agents before plugging was commenced? YES

Name of Conservation Agent who supervised plugging of this well W. L. LACKAMP, JR.
Producing formation --- Depth to top --- Bottom --- Total Depth of Well 4219 Feet
Show depth and thickness of all water, oil and gas formations.

OIL, GAS OR WATER RECORDS

CASING RECORD

FORMATION	CONTENT	FROM	TO	SIZE	PUT IN	PULLED OUT
SIMPSON	WATER, NO SHOW OF OIL	4158	4162	8-5/8" 4-1/2"	232' 4216'	NONE 3017'
MISSISSIPPI	WATER, NO SHOW OF OIL	3938	3944			
KANSAS CITY	WATER AND A LITTLE OIL	3746	3856			

Describe in detail the manner in which the well was plugged, indicating where the mud fluid was placed and the method or methods used in introducing it into the hole. If cement or other plugs were used, state the character of same and depth placed, from feet to feet for each plug set.

PLUGGED BACK T.D. 3912'

FILLED HOLE WITH CRUSHED ROCK FROM 3912' TO 3700', PLACED 4 SACKS CEMENT ONTO CRUSHED ROCK TO 3670'. FILLED HOLE WITH HEAVY MUD TO 200', BUILT SOLID ROCK AT 200'. PLACED 20 SACKS CEMENT ONTO ROCK BRIDGE. FILLED HOLE WITH HEAVY MUD TO 35', BUILT SOLID ROCK BRIDGE. PLACED 10 SACKS CEMENT ONTO ROCK BRIDGE TO BASE OF WELL CELLAR.

NOTE: WELL WAS A WASH DOWN. ORIGINALLY DRILLED BY ARTNELL COMPANY TO A T.D. OF 4219', 8-5/8" 24# CASING WAS SET BY ARTNELL AT 232'. WAS DRY AND ABANDONED 3-1-57. WELL LOG WAS PREVIOUSLY FILED BY ARTNELL COMPANY.

3-16-62

RECEIVED
STATE CORPORATION COMMISSION

MAR 15 1962

CONSERVATION DIVISION
WICHITA, KANSAS

(If additional description is necessary, use BACK of this sheet)

Name of Plugging Contractor MORGAN WELL PLUGGING SERVICE
Address 102 WEST 18TH STREET, HUTCHINSON, KANSAS

STATE OF KANSAS, COUNTY OF BARTON, ss. DON SEARLE (employee of owner) or (owner/operator) of the above-described well, being first duly sworn on oath, says: That I have knowledge of the facts, statements, and matters herein contained and the log of the above-described well as filed and that the same are true and correct. So help me God. DON SEARLE, DIST. PROD. SUPT.

(Signature) Don Searle

ROUTE 2, GREAT BEND, KANSAS (Address)

SUBSCRIBED AND SWORN TO before me this 14TH day of MARCH, 19 62

Arthur J. [Signature]

Notary Public.

My commission expires APRIL 14, 1963.

