

STATE CORPORATION COMMISSION OF KANSAS  
OIL & GAS CONSERVATION DIVISION  
WELL COMPLETION OR RECOMPLETION FORM  
ACO-1 WELL HISTORY  
DESCRIPTION OF WELL AND LEASE

API NO. 15-057-20,467-0000  
County Ford  
C NW/4 Sec 2 Twp 25 Rge 22 East  
XX West

Operator: License # 5104  
Name Blue Goose Drilling Co., Inc.  
Address P.O. Box 1413  
Great Bend, KS 67530  
City/State/Zip

3960 Ft North from Southeast Corner of Section  
3960 Ft West from Southeast Corner of Section  
(Note: Locate well in section plat below)

Purchaser n/a

Lease Name Thomas Well # 1

Operator Contact Person Martin Miller  
Phone 316 792-5633

Field Name

Producing Formation D & A

Contractor: License # same  
Name Company tools

Elevation: Ground 2381 KB 2391

Wellsite Geologist Bob Douglass  
Phone 316 263-7135

Designate Type of Completion  
 New Well  Re-Entry  Workover  
 Oil  SWD  Temp Abd  
 Gas  Inj  Delayed Comp.  
 Dry  Other (Core, Water Supply etc.)

RECEIVED  
STATE CORPORATION COMMISSION  
JUN 5 1989  
CONSERVATION DIVISION  
Wichita, Kansas

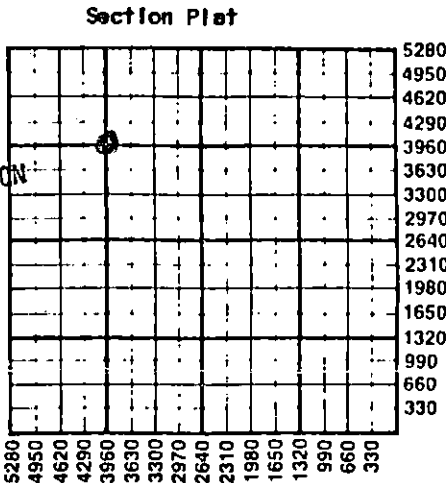

If OWHO: old well info as follows:  
Operator  
Well Name  
Comp. Date Old Total Depth

WATER SUPPLY INFORMATION  
Disposition of Produced Water: Disposal  
Docket # Repressuring

WELL HISTORY

Drilling Method:  
 Mud Rotary  Air Rotary  Cable  
4/3/89 4/12/89 4/13/89  
Spud Date Date Reached TD Completion Date  
4811 Plugged & abandoned  
Total Depth PBTD  
Amount of Surface Pipe Set and Cemented at 468' KB  
Multiple Stage Cementing Collar Used? Yes No  
If yes, show depth set feet  
If alternate 2 completion, cement circulated  
from n/a feet depth to w/ SX cmt  
Cement Company Name  
Invoice # A-I D&O

Questions on this portion of the ACO-1 call:  
Water Resources Board (913) 296-3717  
Source of Water:  
Division of Water Resources Permit # existing  
water well (landowner's)  
 Groundwater 3300 Ft North from Southeast Corner  
(Well) 3300 Ft West from Southeast Corner of  
C SE NW Sec 2 Twp 25 Rge 22 East XX West  
 Surface Water Ft North from Southeast Corner  
(Stream, pond etc) Ft West from Southeast Corner  
Sec Twp Rge East West  
 Other (explain) (purchased from city, R.W.D. #)

INSTRUCTIONS: This form shall be completed in triplicate and filed with the Kansas Corporation Commission, 200 Colorado Derby Building, Wichita, Kansas 67202, within 120 days of the spud date of any well. Rule 82-3-130, 82-3-107 and 82-3-106 apply. Information on side two of this form will be held confidential for a period of 12 months if requested in writing and submitted with the form. See rule 82-3-107 for confidentiality in excess of 12 months. One copy of all wireline logs and drillers time log shall be attached with this form. Submit CP-4 form with all plugged wells. Submit CP-111 form with all temporarily abandoned wells.

All requirements of the statutes, rules and regulations promulgated to regulate the oil and gas industry have been fully complied with and the statements herein are complete and correct to the best of my knowledge.

Signature [Signature]

Title Contracts/Exploration Date 6/2/89

Subscribed and sworn to before me this 2nd day of June 1989

Notary Public [Signature]

Date Commission Expires

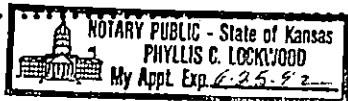

K.C.C. OFFICE USE ONLY  
F Letter of Confidentiality Attached  
C  Wireline Log Received  
C  Drillers Timelog Received  
Distribution  
 KCC  SWD/Rep  NGPA  
 KGS  Plug  Other  
(Specify)  
6-5-89  
Form ACO-1 (5-86)

Sec. 2 Twp 25 Rge 22 East

SIDE TWO

Operator Name Blue Goose Drilling Co., Inc Lease Name Thomas Well # 1

Sec. 2 Twp. 25 Rge. 22  East  West County Ford

WELL LOG

INSTRUCTIONS: Show important tops and base of formations penetrated. Detail all cores. Report all drill stem tests giving interval tested, time tool open and closed, flowing and shut-in pressures, whether shut-in pressure reached static level, hydrostatic pressures, bottom hole temperature, fluid recovery, and flow rates if gas to surface during test. Attach extra sheet if more space is needed. Attach copy of log.

Drill Stem Tests Taken  Yes  No  
 Samples Sent to Geological Survey  Yes  No  
 Cores Taken  Yes  No

Formation Description  
 Log  Sample

DST #1: 4739-4777' (Miss) 30-30-30-30 Rec: 20' mud w/few specks of oil. IHP 2399 IFP 42-42 ISIP 235 FFP 42-42 FSIP 143 FHP 2386

DST #2: 4768-4687' (Miss) Misrun: packer failure  
 DST #3: 4738-4787' (Miss) Misrun: packer failure

DST #4: 4705-4787' (Miss) 30-60-30-30 Rec: 50' very slightly oil-cut mud (1% oil) IHP 2472 IFP 43-47 ISIP 1015 FFP 52-52 FSIP 383 FHP 2373

DST #5: 4788-4814' (Miss) 30-45-60-45 Rec: 1980' water, chlorides 26000. IHP 2463 IFP 140-523 ISIP 1475 FFP 589-1014 FSIP 1475 FHP 2408

Name	Top	Bottom
Anhydrite	1506' (+ 885)	
Heebner	4034' (-1643)	
Toronto	4051' (-1660)	
Brown Lime	4126' (-1735)	
Lansing	4135' (-1744)	
B/KC	4519' (-2128)	
Cherokee	4669' (-2278)	
Miss. Lime	4754' (-2363)	
Miss. Dol.	4766' (-2375)	
Miss. War.	4783' (-2392)	

CASING RECORD <input checked="" type="checkbox"/> New <input type="checkbox"/> Used							
Report all strings set-conductor, surface, intermediate, production, etc.							
Purpose of String	Size Hole Drilled	Size Casing Set (In O.D.)	Weight Lbs/Ft.	Setting Depth	Type of Cement	#Sacks Used	Type and Percent Additives
Surface	12 1/2"	8 5/8"	20	468	60/40 pos	235	2% gel 3% cc

PERFORATION RECORD		Acid, Fracture, Shot, Cement Squeeze Record	
Shots Per Foot	Specify Footage of Each Interval Perforated	(Amount and Kind of Material Used)	Depth

TUBING RECORD			
Size	Set At	Packer at	Liner Run <input type="checkbox"/> Yes <input type="checkbox"/> No

Date of First Production	Producing Method		
d & a	<input type="checkbox"/> Flowing	<input type="checkbox"/> Pumping	<input type="checkbox"/> Gas Lift <input type="checkbox"/> Other (explain).....

Estimated Production Per 24 Hours	Oil	Gas	Water	Gas-Oil Ratio	Gravity
	Bbls	MCF	Bbls	CFPB	

METHOD OF COMPLETION

Production Interval

Disposition of gas:  Vented  Open Hole  Perforation  
 Sold  Other (Specify) .....  
 Used on Lease  Dually Completed .....  
 Commingled