

For KCC Use:  
 Effective Date: 11-12-02  
 District #: 2  
 SGA?  Yes  No

KANSAS CORPORATION COMMISSION  
 OIL & GAS CONSERVATION DIVISION

RECEIVED  
 10-22-02  
 OCT 22 2002

Form C-1  
 September 1999  
 Form must be Typed  
 Form must be Signed  
 All blanks must be Filled

NOTICE OF INTENT TO DRILL

Must be approved by KCC five (5) days prior to commencing well

KCC WICHITA

Expected Spud Date: NOVEMBER 11, 2002  
 month day year

OPERATOR: License# 6236  
 Name: MTM PETROLEUM,  
 Address: P.O. BOX 82  
 City/State/Zip: SPIVEY KS 67142-0082  
 Contact Person: MARVIN A. MILLER  
 Phone: 620-532-3794

CONTRACTOR: License# 5929  
 Name: DUKE DRILLING CO, INC.

Well Drilled For:	Well Class:	Type Equipment:
<input checked="" type="checkbox"/> Oil	<input type="checkbox"/> Enh Rec	<input checked="" type="checkbox"/> Infield
<input checked="" type="checkbox"/> Gas	<input type="checkbox"/> Storage	<input type="checkbox"/> Pool Ext.
<input type="checkbox"/> OWWO	<input type="checkbox"/> Disposal	<input type="checkbox"/> Wildcat
<input type="checkbox"/> Seismic;	<input type="checkbox"/> # of Holes	<input type="checkbox"/> Other
<input type="checkbox"/> Other		<input checked="" type="checkbox"/> Mud Rotary
		<input type="checkbox"/> Air Rotary
		<input type="checkbox"/> Cable

If OWWO: old well information as follows:  
 Operator: \_\_\_\_\_  
 Well Name: \_\_\_\_\_  
 Original Completion Date: \_\_\_\_\_ Original Total Depth: \_\_\_\_\_  
 Directional, Deviated or Horizontal wellbore?  Yes  No  
 If Yes, true vertical depth: \_\_\_\_\_  
 Bottom Hole Location: \_\_\_\_\_  
 KCC DKT #: \_\_\_\_\_

Spot NE - SW - NW Sec. 36 Twp. 30 S. R. 8  
1680 feet from N (circle one) Line of Section  
1075 feet from W (circle one) Line of Section  
 Is SECTION  Regular  Irregular?

(Note: Locate well on the Section Plat on reverse side)  
 County: KINGMAN  
 Lease Name: BOYLE/HILLS Well #: 3  
 Field Name: SPIVEY-GRABS-BASIL

Is this a Prorated / Spaced Field?  Yes  No  
 Target Formation(s): MISSISSIPPIAN  
 Nearest Lease or unit boundary: 990

Ground Surface Elevation: 1629 feet MSL  
 Water well within one-quarter mile:  Yes  No  
 Public water supply well within one mile:  Yes  No

Depth to bottom of fresh water: 100  
 Depth to bottom of usable water: 180  
 Surface Pipe by Alternate: X 1 2  
 Length of Surface Pipe Planned to be set: 210  
 Length of Conductor Pipe required: N/A  
 Projected Total Depth: 4500

Formation at Total Depth: MISSISSIPPIAN  
 Water Source for Drilling Operations:  
 Well  Farm Pond  Other

DWR Permit #: \_\_\_\_\_  
 (Note: Apply for Permit with DWR )  
 Will Cores be taken?  Yes  No  
 If Yes, proposed zone: \_\_\_\_\_

AFFIDAVIT

The undersigned hereby affirms that the drilling, completion and eventual plugging of this well will comply with K.S.A. 55-101, et. seq.  
 It is agreed that the following minimum requirements will be met:

1. Notify the appropriate district office **prior** to spudding of well;
2. A copy of the approved notice of Intent to drill **shall be** posted on each drilling rig;
3. The minimum amount of surface pipe as specified below **shall be set** by circulating cement to the top; in all cases surface pipe **shall be set** through all unconsolidated materials plus a minimum of 20 feet into the underlying formation.
4. If the well is dry hole, an agreement between the operator and the district office on plug length and placement is necessary **prior to plugging**;
5. The appropriate district office will be notified before well is either plugged or production casing is cemented in;
6. If an ALTERNATE II COMPLETION, production pipe shall be cemented from below any usable water to surface within **120 days** of spud date. **In all cases, NOTIFY district office** prior to any cementing.

I hereby certify that the statements made herein are true and to the best of my knowledge and belief.

Date: 10-21-02 Signature of Operator or Agent: Marvin A. Miller Title: President

For KCC Use ONLY  
 API # 15 - 095-21828-00-00  
 Conductor pipe required NONE feet  
 Minimum surface pipe required 200 feet per Alt. ① &  
 Approved by: RSP 11-7-02  
 This authorization expires: 5-7-03  
 (This authorization void if drilling not started within 6 months of effective date.)  
 Spud date: \_\_\_\_\_ Agent: \_\_\_\_\_

Remember to:

- File Drill Pit Application (form CDP-1) with Intent to Drill;
- File Completion Form ACO-1 within 120 days of spud date;
- File acreage attribution plat according to field proration orders;
- Notify appropriate district office 48 hours prior to workover of re-entry;
- Submit plugging report (CP-4) after plugging is completed;
- Obtain written approval before disposing or injecting salt water.

36  
30  
82

RECEIVED

OCT 22 2002

KCC WICHITA

**IN ALL CASES PLOT THE INTENDED WELL ON THE PLAT BELOW**

*Plat of acreage attributable to a well in a prorated or spaced field*

*If the intended well is in a prorated or spaced field, please fully complete this side of the form. If the intended well is in a prorated or spaced field complete the plat below showing that the well will be properly located in relationship to other wells producing from the common source of supply. Please show all the wells and within 1 mile of the boundaries of the proposed acreage attribution unit for gas wells and within 1/2 mile of the boundaries of the proposed acreage attribution unit for oil wells.*

API No. 15 - \_\_\_\_\_  
Operator: MTM PETROLEUM, INC.  
Lease: BOYLE/HILLS  
Well Number: 3  
Field: SPIVEY-GRABS-BASIL

Number of Acres attributable to well: \_\_\_\_\_  
QTR / QTR / QTR of acreage: NE - SW - NW

Location of Well: County: KINGMAN  
1650 feet from S N (circle one) Line of Section  
990 feet from E W (circle one) Line of Section  
Sec. 36 Twp. 30 S. R. 8  East  West

Is Section  Regular or  Irregular

If Section is Irregular, locate well from nearest corner boundary.  
Section corner used:  NE  NW  SE  SW

**PLAT**

*(Show location of the well and shade attributable acreage for prorated or spaced wells.)  
(Show footage to the nearest lease or unit boundary line.)*

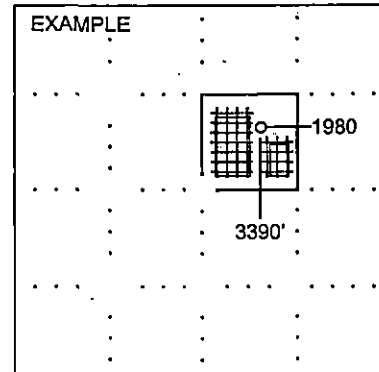
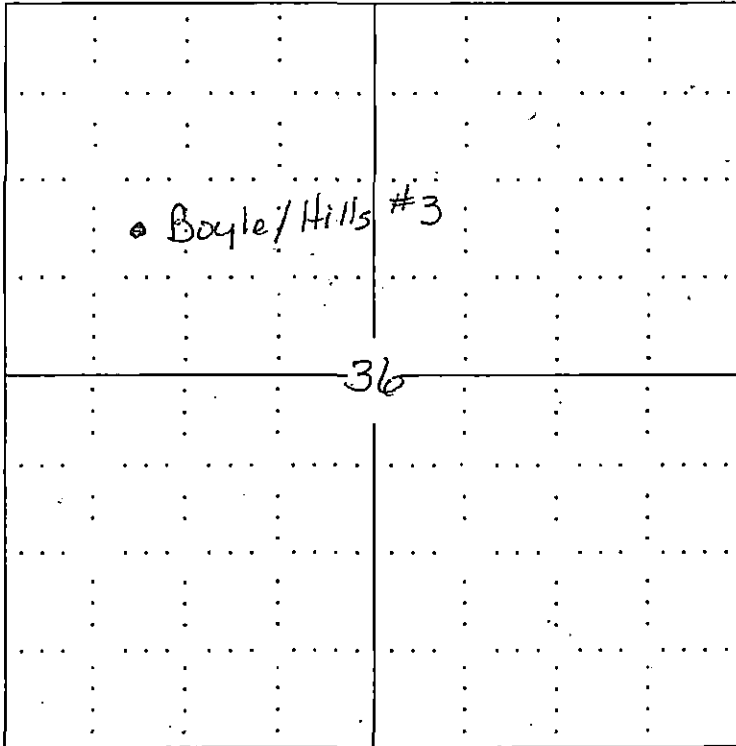

**NOTE: In all cases locate the spot of the proposed drilling location.**

**In plotting the proposed location of the well, you must show:**

1. The manner in which you are using the depicted plat by identifying section lines, i.e. 1 section, 1 section with 8 surrounding sections, 4 sections, etc.
2. The distance of the proposed drilling location from the section's south / north and east / west.
3. The distance to the nearest lease or unit boundary line.
4. If proposed location is located within a prorated or spaced field a certificate of acreage attribution plat must be attached: (C0-7 for oil wells; CG-8 for gas wells).