

FOR KCC USE:

FORM C-1 7/9

FORM MUST BE TYPE

FORM MUST BE SIGNED

ALL BLANKS MUST BE FILLED

EFFECTIVE DATE: 9-5-99
DISTRICT # 1
SSA? Yes No

State of Kansas

NOTICE OF INTENTION TO DRILL

Must be approved by the K.C.C. five (5) days prior to commencing well

Expected Spud Date September 7th, 1999
month day year

Spot
C. SW. NE. Sec. 3. Twp. 28. S. Rg. 29. X East

OPERATOR: License # 4767
Name: Ritchie Exploration, Inc.
Address: P.O. Box 783188
City/State/Zip: Wichita, KS 67278-3188
Contact Person: Rocky Milford
Phone: 316/691-9516

1980 feet from South / North line of Section
1980 feet from East West line of Section
IS SECTION X REGULAR IRREGULAR?

(NOTE: Locate well on the Section Plat on Reverse Side)
County: Gray
Lease Name: Yost-3A Well #: 1
Field Name: WILCAT

CONTRACTOR: License #: ADVISE ON ACO-1
Name: unknown

Is this a Prorated/Spaced Field? yes no
Target Formation(s): Mississippian
Nearest lease or unit boundary: 660'
Ground Surface Elevation: est 2792' feet MSL

Well Drilled For: Well Class: Type Equipment:
..X Oil ... Enh Rec ... Infield ..X Mud Rotary
... Gas ... Storage ... Pool Ext. ... Air Rotary
... OWWO ... Disposal ..X Wildcat ... Cable
... Seismic; ... # of Holes ... Other

Water well within one-quarter mile: yes no
Public water supply well within one mile: yes no
Depth to bottom of fresh water: 220'
Depth to bottom of usable water: 760'
Surface Pipe by Alternate: 1 X 240'
Length of Surface Pipe Planned to be set: 5200'
Length of Conductor pipe required: 5200'

If OWWO: old well information as follows:
Operator:
Well Name:
Comp. Date: Old Total Depth

Projected Total Depth: 5200'
Formation at Total Depth: Mississippian
Water Source for Drilling Operations:
... well ... farm pond ..X other

Directional, Deviated or Horizontal wellbore? yes no
If yes, true vertical depth:
Bottom Hole Location:

DWR Permit #:
Will Cores Be Taken? yes X no
If yes, proposed zone:

AFFIDAVIT

The undersigned hereby affirms that the drilling, completion and eventual plugging of this well will comply with K.S.A. 55-101, et. seq.

It is agreed that the following minimum requirements will be met:

- 1. Notify the appropriate district office prior to spudding of well;
- 2. A copy of the approved notice of intent to drill shall be posted on each drilling rig;
- 3. The minimum amount of surface pipe as specified below shall be set by circulating cement to the top; in all cases surface pipe shall be set through all unconsolidated materials plus a minimum of 20 feet into the underlying formation;
- 4. If the well is dry hole, an agreement between the operator and the district office on plug length and placement is necessary prior to plugging;
- 5. The appropriate district office will be notified before well is either plugged or production casing is cemented in;
- 6. IF AN ALTERNATE IS COMPLETED, PRODUCTION PIPE SHALL BE CEMENTED FROM BELOW ANY USABLE WATER TO SURFACE WITHIN 120 DAYS OF SPUD DATE. IN ALL CASES, NOTIFY DISTRICT OFFICE PRIOR TO ANY CEMENTING.

I hereby certify that the statements made herein are true and to the best of my knowledge and belief.
Date: 8/23/99 Signature of Operator or Agent: [Signature] Title: President

FOR KCC USE: API # 15- 069-20270-0000
Conductor pipe required NONE feet
Minimum surface pipe required 240 feet per Alt. X(2)
Approved by: JK 8-31-99
This authorization expires: 2-29-2000
(This authorization void if drilling not started within 6 months of effective date.)
Spud date: Agent:

REMEMBER TO:

- File Drill Pit Application (form DP-1) with Intent to Drill;
- File Completion Form ACO-1 within 120 days of spud date;
- acreage attribution plat according to field proration orders;
- Notify appropriate district office 48 hours prior to workover or re-entry;
- Submit plugging report (CP-6) after plugging is completed;
- Obtain written approval before disposing or injecting salt water.

Mail to: Conservation Division, 200 Colorado Derby Building, 202 W. First St., Wichita, Kansas 67202-1266.

8-27-99
1999 AUG 27 A 11:31
28
29

IN ALL CASES PLOT THE INTENDED WELL ON THE PLAT BELOW

PLAT OF ACREAGE ATTRIBUTABLE TO A WELL IN A PRORATED OR SPACED FIELD

If the intended well is in a prorated or spaced field, please fully complete this side of the form. If the intended well is in a prorated or spaced field complete the plat below showing that the well will be properly located in relationship to other wells producing from the common source of supply. Please show all the wells within 1 mile of the boundaries of the proposed acreage attribution unit for gas wells and within 1/2 mile of the boundaries of the proposed acreage attribution unit for oil wells.

API NO. 15- _____
 OPERATOR Ritchie Exploration, Inc.
 LEASE Yost-3A
 WELL NUMBER 1
 FIELD _____

LOCATION OF WELL: COUNTY Gray
1980 feet from south/north line of section
1980' feet from east/west line of section
 SECTION 3 TWP 28S RG 29W

NUMBER OF ACRES ATTRIBUTABLE TO WELL _____
 QTR/QTR/QTR OF ACREAGE C - SW - NE

IS SECTION X REGULAR or IRREGULAR
IF SECTION IS IRREGULAR, LOCATE WELL FROM NEAREST CORNER BOUNDARY.

Section corner used: NE NW SE SW
PLAT

(Show location of the well and shade attributable acreage for prorated or spaced wells.)
 (Show footage to the nearest lease or unit boundary line.)

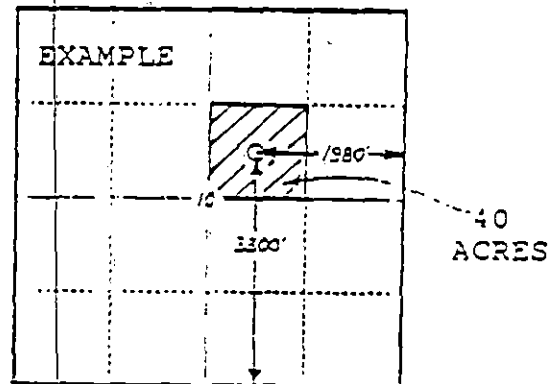
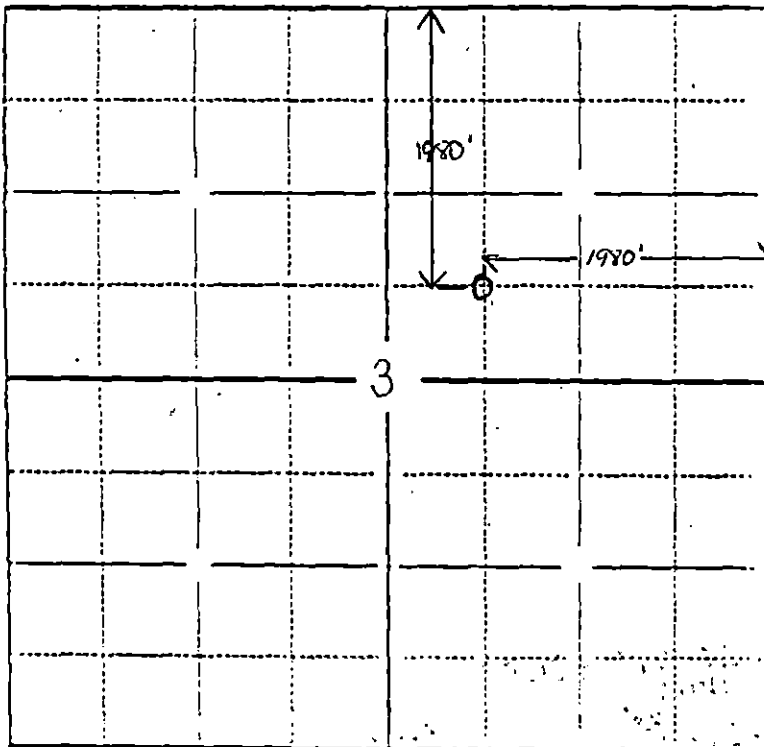

SEWARD CO.

In plotting the proposed location of the well, you must show:

- 1) The manner in which you are using the depicted plat by identifying section lines, i.e. 1 section, 1 section with 8 surrounding sections, 4 sections, etc.;
- 2) the distance of the proposed drilling location from the section's south/north and east/west lines; and
- 3) the distance to the nearest lease or unit boundary line.