

STATE OF KANSAS
STATE CORPORATION COMMISSION

Form CP-4

WELL PLUGGING RECORD

Give All Information Completely
Make Required Affidavit
Mail or Deliver Report to:
Conservation Division
State Corporation Commission
211 No. Broadway
Wichita, Kansas

Kearney County, Sec. 4 Twp. 22S Rge. (E) 35 (W)
Location as "NE/CNW/SW" or footage from lines C-SW-SE
Lease Owner Petroleum, Inc.
Lease Name WILLIAMSON Well No. 1
Office Address Box 1255, Liberal, Kansas 67901
Character of Well (completed as Oil, Gas or Dry Hole) DRY HOLE
Date well completed December 14 1972
Application for plugging filed December 15 1972
Application for plugging approved December 18 1972
Plugging commenced December 14 1972
Plugging completed December 14 1972
Reason for abandonment of well or producing formation -

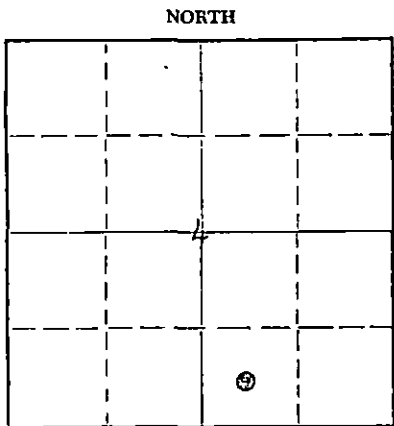

Locate well correctly on above
Section Flat

If a producing well is abandoned, date of last production - 19
Was permission obtained from the Conservation Division or its agents before plugging was commenced? Yes

Name of Conservation Agent who supervised plugging of this well Mr. Ed Eves
Producing formation - Depth to top - Bottom - Total Depth of Well 5051 Feet
Show depth and thickness of all water, oil and gas formations.

OIL, GAS OR WATER RECORDS

CASING RECORD

FORMATION	CONTENT	FROM	TO	SIZE	PUT IN	PULLED OUT
				8 5/8"	867'	None

Describe in detail the manner in which the well was plugged, indicating where the mud fluid was placed and the method or methods used in introducing it into the hole. If cement or other plugs were used, state the character of same and depth placed, from - feet to - feet for each plug set.

Plugged with 35 sk. Plug 850-750', 15 sk. Plug 40' to 0'.

Job complete at 8:00 P.M. 12/14/72.

RECEIVED
STATE CORPORATION COMMISSION
JAN 2 1973
CONSERVATION DIVISION
Wichita, Kansas

(If additional description is necessary, use BACK of this sheet)
Name of Plugging Contractor Garvey Drilling Company
Address P.O. Box 1164, Great Bend, Kansas 67901

STATE OF Kansas, COUNTY OF Seward, ss.
Ned E. Lowry (employee of owner) or (owner or operator) of the above-described well, being first duly sworn on oath, says: That I have knowledge of the facts, statements, and matters herein contained and the log of the above-described well as filed and that the same are true and correct. So help me God.

(Signature) Ned E. Lowry
P.O. Box 1255, Liberal, Ks. 67901
(Address)

SUBSCRIBED AND SWORN TO before me this 29th day of December, 1972

My commission expires September 19, 1974 James R. Hatfield Notary Public.

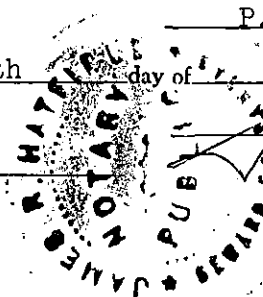

WELL LOG

COMPANY Petroleum, Inc.

SEC. 4 T. 22S R. 35W

FARM Williamson NO. 1

LOC. C SW SE

TOTAL DEPTH 5051'

COUNTY Kearny, Kansas

COMM. 11-29-72 COMP. 12-14-72

CONTRACTOR Garvey Drilling Company

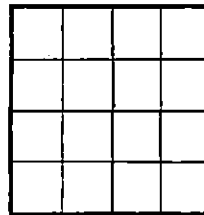

CASING

8 5/8" @ 867' w/425sx

ELEVATION 3105'D.F.

PRODUCTION D & A

FIGURES INDICATE BOTTOM OF FORMATIONS

- 185' Surface Clay & Sand
- 380' Shale
- 1170' Red Bed
- 1520' Shale & Red Bed
- 1750' Sand
- 1935' Shale & Lime
- 2655' Lime & Shale
- 4160' Lime
- 5051' Lime
- 5051' RTD

RECEIVED
 STATE CORPORATION COMMISSION
 JAN 2 1973
 CONSERVATION DIVISION
 Wichita, Kansas

State of Kansas }
 County of Barton } SS

I, Charlene Marker of Garvey Drilling Company

upon oath state the above and foregoing is a true and correct copy of the log of the Williamson #1 well.

Subscribed and sworn to before me this 19th day of December 19 72

My Commission Expires: July 8, 1974

Charlene Marker
James A. Maxwell
 NOTARY PUBLIC

RECEIVED
STATE CORPORATION COMMISSION

JAN 2 1973

CONSERVATION DIVISION
Wichita, Kansas

KANSAS CORPORATION COMMISSION

WELL RECORD

(Mail to Kansas Geological Survey, 4150 Monroe Street, Wichita, Kansas 67209)

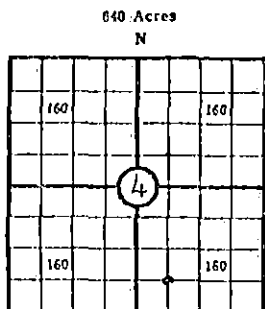

Lease Name: WILLIAMSON Well No. 1
 Well Located: C-SW-SE
SEC 4th TWP 22S RGE 35W
 Operator: Petroleum, Inc.
 Address: Box 1255, Liberal, Kansas 67901
 Elevation: Ground 3099' D.F. 3105' K.B. 3107'
 Type Well: (Oil, gas, dry hole) Dry Hole

Drilling Commenced: 11/30 1972 Drilling Completed: 12/14 1972
 Well Completed: 12/14 1972 Total Depth 5051'
 Initial Production: ---

Casing Record

Size: 8-5/8" Set at 867' Size: Set at
 Size: Set at Size: Set at

Liner Record

Size: Set from To

Cementing

<u>Casing Size</u>	<u>Sacks</u>	<u>Type Cement and Additives</u>
<u>8-5/8"</u>	<u>425</u>	<u>275 sks. Halliburton Lite-weight, 2%CC. 150 sks. Common, 3%CC.</u>
<u> </u>	<u> </u>	<u> </u>
<u> </u>	<u> </u>	<u> </u>

Perforations

<u>Formation</u>	<u>Perforated Interval and Number Shots</u>
<u>---</u>	<u>---</u>
<u> </u>	<u> </u>
<u> </u>	<u> </u>
<u> </u>	<u> </u>

Electric Log Run (Show type log and depths covered)

(Fill in formation and related information on reverse side)

