

Give All Information Completely
Make Required Affidavit
Mail or Deliver Report to:
Conservation Division
State Corporation Commission
212 No. Market
Wichita, Kansas 67202

WELL PLUGGING RECORD

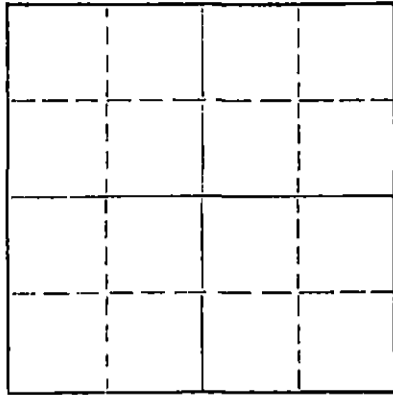

Locate well correctly on above Section Plat

Location as "NE/CNWxSWx" or footage from lines Barton County, Sec. 31 Twp. 16 Rge. 11 (E) (W) x
NW SE NE
Lease Owner Skelly Oil Co.
Lease Name J. F. Zorn Well No. #8
Office Address Star Route Russell, Kansas
Character of Well (completed as Oil, Gas or Dry Hole) _____
Date well completed _____ 19____
Application for plugging filed _____ 19____
Application for plugging approved _____ 19____
Plugging commenced 4-14-70 _____ 19____
Plugging completed 4-16-70 _____ 19____
Reason for abandonment of well or producing formation _____
If a producing well is abandoned, date of last production _____ 19____
Was permission obtained from the Conservation Division or its agents before plugging was commenced? _____

Name of Conservation Agent who supervised plugging of this well Donald Truan
Producing formation _____ Depth to top _____ Bottom _____ Total Depth of Well 3409' Feet
Show depth and thickness of all water, oil and gas formations.

OIL, GAS OR WATER RECORDS

CASING RECORD

FORMATION	CONTENT	FROM	TO	SIZE	PUT IN	PULLED OUT
				5 1/2"	3353'	2262.72'
				8 5/8"	745'	

Describe in detail the manner in which the well was plugged, indicating where the mud fluid was placed and the method or methods used in introducing it into the hole. If cement or other plugs were used, state the character of same and depth placed, from _____ feet to _____ feet for each plug set.

Made bottom hole plug back with sand from 3409' to 3340'. Mixed and ran 5 sacks cement thru dump bailer from 3340' to 3300'.
Mudded hole from 3300' to 374'. Set 25' rock bridge from 375' to 350'. Filled hole with 5 yards ready mix from 350' to base of cellar.

RECEIVED
STATE CORPORATION COMMISSION
APR 20 1970
CONSERVATION DIVISION
Wichita, Kansas

(If additional description is necessary, use BACK of this sheet)
Name of Plugging Contractor Southwest Casing Pulling Co.
Address Box 364, Great Bend, Kansas

STATE OF Kansas, COUNTY OF Barton, ss.
Southwest Casing Pulling Co. (employee of owner) or (owner or operator) of the above-described well, being first duly sworn on oath, says: That I have knowledge of the facts, statements, and matters herein contained and the log of the above-described well as filed and that the same are true and correct. So help me God.

(Signature) W. E. Spencer, Sr.
Box 364, Great Bend, Kansas
(Address)

SUBSCRIBED AND SWORN to before me this 17 day of April, 19 70

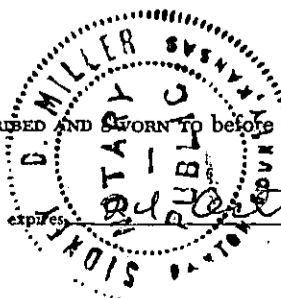

Sidney D. Miller
Notary Public.

My commission expires October 1972

See

SKELLY OIL COMPANY

REPORT OF CHANGE IN WELL RECORD

Give complete description of all cleaning out, deepening, plugging back and fishing jobs, changes in casing, material lost in hole, etc., not recorded in original well record.

SNOW

~~F. B. Valente~~ J. F. Zorn
LEASE

48 Western Kansas
WELL NO. DISTRICT

SEC. 31 T. 16S R. 11W

COUNTY Barton Exp.
JOB NO.

SURVEY BLOCK

STATE Kansas

CLEANING OUT RECORD				PLUGGING BACK OR DEEPENING RECORD			
Date commenced.....	<u>April 7,</u>	19	<u>55</u>	Date commenced.....		19	
Date completed.....	<u>April 7,</u>	19	<u>55</u>	Date completed.....		19	
Cleaned out from.....	to.....	T.D.	<u>3409'</u>	Plugged back or deepened from.....	to.....	T.D.	
Input Prod. before.....	oil.....	bbbls. #	bbbls. #	cu. ft. gas	oil.....	bbbls. #	bbbls. #
Input Prod. after.....	oil.....	bbbls. <u>45</u>	bbbls. <u>/hr by Gravity</u>	cu. ft. gas	oil.....	bbbls. #	bbbls. #
Kind of tools used:.....				Kind of tools used:.....			
Tools owned by:.....				Tools owned by:.....			

ACID TEST SHOT RECORD

Date	<u>4/7/55</u>						
Size shot	<u>1000 gals. 7X</u>	Qts.		Qts.		Qts.	
Shot between	<u>3353</u> Ft. and <u>3409</u> Ft.	Ft. and	Ft.	Ft. and	Ft.	Ft. and	Ft.
Size of shell							
Put in by (Co.)	<u>Halliburton</u>						
Length anchor							
Distance below casing							
Damage to casing or casing shoulder							

CHANGES IN CASING RECORD

SIZE	Wt.	Thds.	Where Set	PULLED OUT			LEFT IN			KIND	Cond'n	CEMENTING	
				Jts.	Feet	In.	Jts.	Feet	In.			Sacks Used	Method Employed

Liner set at..... Length..... Perforated at.....
Packer set at..... Size and kind.....

*Would not take all the water from wells connected to it.

Superintendent.

REMARKS (Give review of work accomplished and any other comment of interest) On April 7, 1955, pulled 2 1/2" tubing and packer, reran 2" tubing w/ HM packer and treated with 1000 gallons of Halliburton 30% acid as follows:

ACID TREATMENT NO. 9 - Between 3353' and 3409'

Treatment put in 4/7/55 by Halliburton, using 1000 gallons of acid and 15 barrels of water to flush.

TIME	CP	YP	REMARKS
11:35 am			Loaded hole
12:08 pm			Start acid
12:12 pm		850'	Acid on bottom
12:23 pm		850'	Start flush
12:28 pm		1100'	Acid out

Pulled tubing and packer, ran 2 1/2" cement lined tubing with 5 1/2" x 2 1/2" Lanco-Wells packer set at 3340'. Tested for input and well took 45 barrels of water per hour by gravity.

RECORD OF FORMATIONS

FORMATION	TOP	BOTTOM	REMARKS
			Indicate Casing Points, Describe Shows of Oil, Gas and Water, etc.



SKELLY OIL COMPANY

REPORT OF CHANGE IN WELL RECORD

Give complete description of all cleaning out, deepening, plugging back and fishing jobs, changes in casing, material lost in hole, etc., not recorded in original well record.

S.W.D.N.

LEASE V. S. Valenta Z. F. Zorn

WELL NO. 48 DISTRICT Western Kansas

SEC. 31 T. 169 R. 11W

COUNTY Barton Exp.
JOB NO.

SURVEY BLOCK

STATE Kansas

CLEANING OUT RECORD				PLUGGING BACK OR DEEPENING RECORD			
Date commenced.....	October 5, 1955			Date commenced.....	19.....		
Date completed.....	October 7, 1955			Date completed.....	19.....		
Cleaned out from.....	to..... T.D. 3409'			Plugged back or deepened from.....	to..... T.D.....		
Input Prod. before.....	bbls. oil	65	cu. ft. gas	Prod. before.....	bbls. oil	bbls. water	cu. ft. gas
Input Prod. after.....	bbls. oil	65	cu. ft. gas	Prod. after.....	bbls. oil	bbls. water	cu. ft. gas
Kind of tools used:	Truck #8577 gravity			Kind of tools used:		
Tools owned by:	Skelly Oil Company			Tools owned by:		

ACID SHOT RECORD

Date	Size shot	Shot between	Size of shell	Put in by (Co.)	Length anchor	Distance below casing	Damage to casing or casing shoulder
10/7/55	2000 gals. 2 1/2"	3353 Ft. and 3409 Ft.		Halliburton			

CHANGES IN CASING RECORD

SIZE	Wt.	Thds.	Where Set	PULLED OUT			LEFT IN			KIND	Cond'n	CEMENTING	
				Jts.	Feet	In.	Jts.	Feet	In.			Sacks Used	Method Employed

Liner set at..... Length..... Perforated at.....
Packer set at..... Size and kind.....

*Would not take all the water from wells connected to it.

Superintendent.

REMARKS (Give review of work accomplished and any other comment of interest) On October 5, pulled

2 1/2" tubing and ran 1" tubing. Treated with 2000 gallons of 30% Halliburton acid as follows:

ACID TREATMENT NO. 10 - Between 3353' and 3409'

Treatment put in 10/7/55 by Halliburton, using 2000 gallons of acid and 100 barrels of water.

<u>TIME</u>	<u>OP</u>	<u>IP</u>	<u>REMARKS</u>
9:10 am			Start acid
9:50 am	1500'		1000 gallons of acid in hole
10:15 am	1500'		2000 gallons of acid in hole
11:55 am	1500'		Finished flush with 100 barrels of water

Pulled 1" tubing and ran 2 1/2" cement lined tubing with Lane-Wells Hook Wall packer. Tested for input and well took 65 barrels of water per hour by gravity.

RECORD OF FORMATIONS

<u>FORMATION</u>	<u>TOP</u>	<u>BOTTOM</u>	<u>REMARKS</u> Indicate Casing Points, Describe Shows of Oil, Gas and Water, etc.
------------------	------------	---------------	--

SKELLY OIL COMPANY

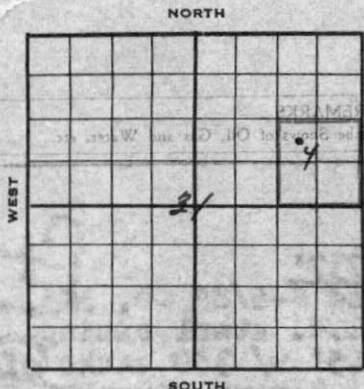

J. F. Zorn

Well Record

Lease Name and No. **F. H. Valenta** Well No. **48** Elev. **1896'**
 Lease Description **East 40 acres of S/2 NE/4 Section 31-16S-11W, Barton County, Kansas (40 Acres)**
 Location made **January 2, 1954** by **R. V. Morse**
 feet from North line **990** feet from East line **NE/4**
 feet from South line **990** feet from West line of **Sec. 31**

Work com'd **1/3** 19**54** Rig comp'd **1/4** 19**54** Drlg. com'd **1/4** 19**54** Drlg. comp'd **1/16** 19**54**

Rig Contractor **Claude Wentworth Drilling Co., Inc.**
 Drilling Contractor **Claude Wentworth Drilling Co., Inc., Tulsa, Oklahoma**
 Rotary Drilling from **0'** to **3376'** Cable Tool Drilling from **To complete** to

Commenced Producing **DRY HOLE** 19**54** Initial Prod. before shot or acid _____ Bbls.
 Initial Prod. after shot or acid _____ Bbls.
 Dry Gas Well Press. _____ Volume _____ Cu. ft.
 Casing Head Gas Pressure _____ Volume _____ Cu. ft.
 Braden Head (**6-5/8" 25.1" OD**) Gas Pressure _____ Volume _____ Cu. ft.
 Braden Head (_____ Size _____) Gas Pressure _____ Volume _____ Cu. ft.

PRODUCING FORMATION **DRY HOLE** (Name) Top _____ Bottom _____ TOTAL DEPTH **3376'**
PB 2941'

CASING RECORD

OD Size	Wt.	Thds.	Where Set	PULLED OUT			LEFT IN			KIND	Cond'n	Sacks Used	CEMENTING Method Employed
				Jts.	Feet	In.	Jts.	Feet	In.				
8-5/8"	32	8R	745'				37	744	3	R1 LW	C	350	Halliburton
5-1/2"	14	8R	3353'				107	3379	9	J55 R2 SS	A	125	Halliburton
(8-5/8" casing set 2' in cellar and 5 1/2" cased to derrick floor)													
(5 1/2" casing perforated from 3098'-3102' with 59 holes, 3206'-14' with 24 holes, from 3324'-34' with 59 holes)													
(Used 1 - 5 1/2" OD Larkin Combination Guide & Float Shoe)													

Liner Set at _____ Length _____ Perforated at _____
 Liner Set at _____ Length _____ Perforated at _____
 Packer Set at _____ Size and Kind _____
 Packer Set at _____ Size and Kind _____

SHOT OR ACID TREATMENT RECORD

	FIRST	SECOND	THIRD	FOURTH
Date	1/22/54	1/25/54	1/29/54	
Acid Used				
Size Shot			500	
Shot Between	3324 Ft. and 3334 Ft.	2998 Ft. and 3012 Ft.	2970 Ft. and 2978 Ft.	
Size of Shell				For remaining treatments see remarks
Put in by (Co.)	Halliburton	Halliburton	Halliburton	
Length anchor				
Distance below Cas'g	(Sand-Oil-Frac)	(Sand-Oil-Frac)		
Damage to Casing or Casing Shoulder				

SIGNIFICANT GEOLOGICAL FORMATIONS

NAME	Top	Bottom	GAS		OIL		REMARKS
			From	To	From	To	
Heebner Shale	2951'						
Douglas Sand	2995'						
Lansing Lime	3065'						
Conglomerate	3322'						
Arbuckle Lime	3343'						
Quartzite	3372'						

CLEANING OUT RECORDS

	DATE COMMENCED	DATE COMPLETED	PROD. BEFORE	PROD. AFTER	REMARKS
1st					See Reverse for other details.
2nd					" " " " "
3rd					" " " " "
4th					" " " " "

PLUGGING BACK AND DEEPENING RECORDS

	Date Commenced	Date Completed	No. Feet Plugged Back or Deepened	Prod. Before	Prgd. After	REMARKS
1st						See Reverse for other details.
2nd						" " " " "
3rd						" " " " "
4th						" " " " "

STATE CORPORATION COMMISSION (See Reverse for Record of Formation)
 RECEIVED

RECORD OF FORMATIONS

FORMATION	TOP	BOTTOM	REMARKS
Sand rock and clay	0	50	
Shale and shells	50	467	
Red bed and shells	467	737	
Anhydrite	737	745	<u>TOP ANHYDRITE 737'</u>
Anhydrite	745	765	Set and cemented 8-5/8" OD, 32', R-1, R-2, J-55, Pittsburgh 5 1/2" casing (A cond.) at 745' w/ 350 sacks of Pozmix cement. Cement circulated.
Red bed, shale and shells	765	1070	
Salt and shale	1070	1170	
Shale and shells	1170	1400	
Lime and shale	1400	1800	
Lime	1800	1945	
Lime and shale	1945	2760	
Lime	2760	2965	<u>TOP HERRIN SHALE 2951'</u>
Lime and shale	2965	2995	<u>TOP TORONTO LIME 2963'</u>
Gray and buff, fine grained sand	2995	3050	<u>TOP DOUGLAS SHALE 2980'</u> <u>TOP BALDWIN SAND 2995'</u> <u>TOP BROWN LIME 3050'</u> Good porosity, slight to good odor of oil, good saturation. Ran Halliburton drill stem test, packer set 2979', open 1 hour, light blow at start, decreased to weak blow, recovered 60' of drilling mud, BHP-470.

FORMATION	TOP	BOTTOM	REMARKS
Lime	3050	3285	(3097'-3101)', buff, fine crystalline lime, fair porosity, slight stain; 3106'-11', light gray to buff, fine crystalline oolitic lime, slight porosity and stain; 3208'-11', light gray and tan, fine crystalline oolitic lime, very few oil saturated pieces.
Lime and shale	3285	3323	<u>TOP LANSING LIME 3065'</u> <u>TOP CONGLOMERATE 3322'</u>
Vari-colored shale with rounded sand grains and some chert	3323	3343	<u>TOP ANBUCKLE LIME 3343'</u>
Light gray finely crystalline dolomite	3343	3350	Very slight porosity, no stain or odor.

FORMATION	TOP	BOTTOM	REMARKS
Light gray finely crystalline dolomite	3350	3358	Very slight porosity, no stain or odor.
Gray and light tan coarsely crystalline dolomite	3358	3368	Fair porosity, slight oil stain.
Dense gray dolomite	3368	3372	No porosity or stain. <u>TOP QUARTZITE 3372'</u>
Light gray, hard dense quartzite	3372	3376	No shows.

Set and cemented 5 1/2" OD, 14 1/2' R-2, J-55, Pittsburgh 5 1/2" casing (A cond.) at 3353' w/ 125 sacks of Pozmix cement. Finished cementing at 3:40 p.m. 1/16/54. Halliburton Temperature Survey showed top of cement behind 5 1/2" casing at 2315'.

Rigged up cable tools and bailed the hole down on January 20, and 5 1/2" casing tested dry. Drilled cement plug and cleaned out to bottom, and cement job tested OK. Swabbed off bottom 7 hours, 163 barrels of water and no oil. Ran Lane-Wells Gamma Ray Survey, then set Lane-Wells bridging plug at 3346'. Plugged back with 1 sack of Gal-Seal from 3346' to 3337'. Perforated 5 1/2" casing from 3324' to 3334' with 59 holes by Lane-Wells, no shows. Bailed and tested 5 hours, hole tested dry. Ran tubing and set Halliburton HM packer at 3284', then ran Halliburton Sand-Oil-Frac as follows:

SAND-OIL-FRAC TREATMENT NO. 1 - Between 3324' and 3334'			
Used 48 barrels heavy crude oil			
2000 lbs of sand			
173 barrels of regular grade to fill and flush			
Maximum 1000-PSI pressure, broke to 3600 PSI			
Time 30 minutes			
See Reverse for other details			
Conservation Division	Wichita, Kansas		
APR 9 1970			

RECEIVED
STATE CORPORATION COMMISSION

Pulled 2" tubing and packer and swabbed through 5 1/2" casing to bottom 2 hours, 73 barrels of oil used in treating, no water; then swabbed off bottom 6 hours, 4 barrels of oil used in treating. Bailed and tested 5 hours, 7 gallons of oil used in treating. Set Lane-Wells bridging plug at 3050' and plugged back with 1 sack of Cal-Seal from 3050' to 3041 1/2'.

Perforated 5 1/2" casing from 2998' to 3012' with 84 holes by Lane-Wells. Bailed and tested 12 hours, 14 gallons of water with gum of oil per hour. On January 25, ran 2" tubing and set Halliburton HM packer at 2965'. Treated with Halliburton Sand-Oil-Frac as follows:

SAND-OIL-FRAC TREATMENT NO. 2 - Between 2998' and 3012'

Used 6000# of sand
 100 barrels of heavy crude oil
 249 barrels of light crude oil to fill and flush
 Maximum TP-2700#, broke to 1800#
 Time 30 minutes

Pulled tubing and packer, then swabbed through 5 1/2" casing 9 hours, 124 barrels of oil used in treating and 97 barrels of water. On January 27, swabbed through 5 1/2" casing 24 hours, 23 barrels of oil used in treating and 143 barrels of water. On January 28, ran 2" tubing and set Halliburton DM retainer at 2990' and cemented off perforations from 2998' to 3012' with 200 sacks of Pozmix cement, maximum TP-3000#. Pulled tubing and swabbed and bailed the hole dry and 5 1/2" casing tested dry.

Perforated 5 1/2" casing from 2970' to 2978' with 50 holes by Lane-Wells, no shows. Treated through 5 1/2" casing with 500 gallons of Halliburton 15% acid as follows:

ACID TREATMENT NO. 1 - Between 2970' and 2978'

Treatment put in 1/29/54 by Halliburton, using 500 gallons of acid and 92 barrels of oil to fill hole and flush.

TIME	CP	REMARKS
1:00 pm		500 gallons of acid in
1:10 pm		Start oil
1:30 pm		Filled hole with 70 barrels of oil
1:33 pm	450#	Start flush
1:36 pm	450#	125 gallons of acid in formation
1:39 pm	400#	300 gallons of acid in formation
1:41 pm	400#	500 gallons of acid in formation

Swabbed through 5 1/2" casing to bottom 1 hour, 62 barrels of oil used in treating; then swabbed off bottom 14 hours, 2 barrels of oil used in treating and 12 barrels of acid water with 26 barrels of formation water. Ran 2" tubing to 2975' and cemented off perforations from 2970' to 2978' with 50 sacks of Pozmix cement, maximum TP-1000#. Pulled tubing and on February 1, swabbed and bailed the hole dry and 5 1/2" casing tested dry. Drilled cement plug and cleaned out to 2990'. Drilled retainer and cement plug to 3030'. Bailed and tested 6 hours, 12 gallons of water with gum of oil per hour. On February 3, ran 2" tubing and set Halliburton HRC packer at 2991' and located leak in 5 1/2" casing from 2998' to 3012'. Reset packer at 2958' and cemented off leak with 120 sacks of Pozmix cement, maximum TP-4000#. Pulled tubing and packer.

On February 5, swabbed and bailed the hole dry and drilled cement plug to 2985' and hole tested dry. Drilled cement and Cal-Seal plug to 3050' and 5 1/2" casing tested dry. Drove Lane-Wells bridging plug to 3335'. Perforated 5 1/2" casing from 3206' to 3314' with 24 holes and from 3098' to 3102' with 47 holes by Lane-Wells. On February 7, ran 2" tubing with Halliburton straddle packers, set top packer at 3190' and bottom at 3221'. Treated from 3206' to 3214' with 500 gallons of Halliburton 15% acid as follows:

ACID TREATMENT NO. 2 - Between 3206' and 3214'

Treatment put in 2/7/54 by Halliburton, using 500 gallons of acid and 13 barrels of oil to flush.

TIME	CP	TP	REMARKS
12:00 m			Hole loaded
1:37 pm			Start acid
1:43 pm			Acid on bottom, start flush
1:45 pm	400#	1500#	10 gallons of acid in formation
1:50 pm		1100#	70 gallons of acid in formation
1:53 pm		1300#	500 gallons of acid in formation

Swabbed through 2" tubing to bottom 1 hour, 12 barrels of oil used in treating; then swabbed 14 hours off bottom, 1 barrel of oil used in treating and 3 1/2 barrels of acid water. Reset straddle packers with top packer at 3080' and bottom at 3110' and treated from 3098' to 3102' with 500 gallons of Halliburton 15% acid as follows:

STATE CORPORATION COMMISSION
 RECEIVED

ACID TREATMENT NO. 3 - Between 3098' and 3102'

Treatment put in 2/8/54 by Halliburton, using 500 gallons of acid and 13 barrels of oil to flush.

TIME	CP	TP	REMARKS
10:38 am			Start acid
10:45 am			Acid on bottom, start flush
10:52 am		1000'	500 gallons of acid in

Swabbed through tubing 1 hour and swabbed to bottom, 13 barrels of oil used in treating; then swabbed off bottom 10 hours, 5 barrels of acid water and no oil. Pulled tubing and packer. Set Baker bridging plug at 2950' and 5 1/2" casing tested dry. Plugged back with 1 sack of Cal-seal from 2950' to 2941'.

Perforated 5 1/2" casing from 2895' to 2906' with 45 holes by Lane-Wells, no shows. Treated through 5 1/2" casing with 500 gallons of Halliburton 15% acid as follows:

ACID TREATMENT NO. 4 - Between 2895' and 2906'

Treatment put in 2/9/54 by Halliburton, using 500 gallons of acid and 72 barrels of oil to fill hole and flush.

TIME	CP	TP	REMARKS
3:33 pm			500 gallons of acid in casing
3:50 pm			Acid on bottom
3:55 pm		250'	170 gallons of acid in formation
3:58 pm		250'	500 gallons of acid in formation

Swabbed through 5 1/2" casing 2 hours, swabbed to bottom, 72 barrels of oil used in treating and 7 barrels of acid water. Swabbed off bottom 9 hours, 5 barrels of acid water and 15 barrels of formation water. On February 10, set Baker bridging plug at 2840'. Plugged back with 1 sack of Cal-seal from 2840' to 2830' and 5 1/2" casing tested dry.

Perforated 5 1/2" casing from 2795' to 2806' with 45 holes by Lane-Wells, no shows. Treated through 5 1/2" casing with 500 gallons of Halliburton 15% acid as follows:

ACID TREATMENT NO. 5 - Between 2795' and 2806'

Treatment put in 2/10/54 by Halliburton, using 500 gallons of acid and 80 barrels of oil to fill hole and flush.

TIME	CP	TP	REMARKS
3:40 pm			Start acid
4:05 pm	100'		Start flush
4:07 pm	400'		40 gallons of acid in formation
4:09 pm	350'		200 gallons of acid in formation
4:11 pm	300'		500 gallons of acid in formation

Swabbed through 5 1/2" casing 1 hour, 68 barrels of oil used in treating; then swabbed off bottom 11 hours, 12 barrels of acid water and 78 barrels of formation water. Drove Lane-Wells bridging plug from 2840' to 2941'. Ran 2" tubing and set Halliburton HRC packer at 2781'. Cemented off perforations from 2795' to 2806' and 2895' to 2906' with 300 sacks of Pozmix cement, maximum TP-3500'. Pulled tubing and shut down for cement to set and future completion as a salt water disposal well.

SLOPE TEST DATA

DEPTH	ANGLE OF DEFLECTION
130'	1/2 Degree
350'	1/2 "
650'	0 "
1000'	0 "
1250'	0 "
1500'	0 "
1750'	0 "
2000'	0 "
2250'	0 "
2500'	0 "
3050'	0 "

RECEIVED
STATE CORPORATION COMMISSION
APR 9 1970
CONSERVATION DIVISION
Wichita, Kansas

SKELLY OIL COMPANY

CHANGE IN WELL RECORD

Give complete description of all cleaning out, deepening, plugging back and fishing jobs, changes in casing, material lost in hole, etc, not recorded in original well record.

LEASE NAME J. F. Zorn
 SEC. 31 T. 16S R. 11W
 BLOCK _____ SURVEY _____

WELL NO. 8 DISTRICT Kansas
 COUNTY Barton AFE NO. Exp.
 STATE Kansas

TYPE OF WORK ACIDIZE

Date commenced November 13, 1962 Date completed November 14, 1962
 Deepened from _____ to _____ Total Depth 3409'
 Plugged back from _____ to _____ P.B.T.D. _____
 Cleaned out from _____ to _____
 Production before _____ bbls. oil _____ bbls. water _____ cu. ft. gas.
 Production after _____ bbls. oil _____ bbls. water _____ cu. ft. gas.
 Tools owned by; Wood Well Service Kind used; Pulling Unit No. days rig time; 18 hrs.
 Cost of Job \$ _____ Revised Estimated Payout (Mos.) _____

TREATMENT RECORD

DATE	TYPE TREATMENT	INTERVAL TREATED	AMOUNT OF TREATMENT
11/13/62	Acid	3353-3409'	1000 gals. 30% FB

CHANGES IN CASING RECORD

STRINGS	SIZE	WHERE SET (Depth)	CEMENTING RECORD		REMARKS
			Sacks Used	Top Cem't. Bh'd. Casg.	
Production					
Liner					Top liner;

SIZE	WT.	THDS.	KIND	COND.	LEFT IN				PULLED OUT					
					Jts.	LTM		WTM		Jts.	LTM		WTM	
						Feet	In.	Feet	In.		Feet	In.	Feet	In.

PRODUCING FROM INPUT FORMATION

BASAL ARBUCKLE FORMATION thru ~~OPEN HOLE~~ PERFORATIONS 3353' TOP 3409' BOTTOM Total No. Shots _____

REMARKS (Give review of work performed and any other comment of interest)

The well stopped up and would only take 120 barrels water per day.
 11/13/62 moved in well servicing unit and found 1" tubing would not go into 2 1/2" cement lined tubing. Pulled 2 1/2" cement lined tubing and packer. Ran 1" tubing.
TREATMENT NO. 14 - (Acid) - 3353'-3409'
 11/13/62 treated through tubing by Halliburton with 1000 gallons of 30% FB acid jetted at 750#, flushed with 9 barrels salt water, time 55 minutes.
 Pulled 1" tubing and ran 2 1/2" cement lined tubing with packer set at 3340'. Tested input and well took 29 barrels of water per hour by gravity for 2 hours, hole did not fill.

RECEIVED
 STATE CONSERVATION COMMISSION
 FEB 8 1962
 CONSERVATION DIVISION
 Wichita, Kansas

SKELLY OIL COMPANY

CHANGE IN WELL RECORD

This complete set of all records, including piping, box and fitting logs, changes in casing, material lost in hole, etc., not recorded in original well record.

WELL NAME _____ DISTRICT _____
 COUNTY _____ STATE _____
 SURVY _____
 AREA NO. _____

TYPE OF WORK

Cost of job \$ _____
 Tool owned by _____
 Production before _____
 Production after _____
 Spillage out from _____
 Spillage back from _____
 Produced from _____
 This connection _____
 Kind used _____
 No days in hole _____

TREATMENT RECORD

DATE	TYPE TREATMENT	INTERVAL TREATED	AMOUNT OF TREATMENT

CHANGES IN CASING RECORD

LINE	PRODUCTION	SIZE	WHERE SET	REMARKS

PRODUCING FROM

FORMERLY _____
 FORMERLY _____
 FORMERLY _____

RECEIVED
 STATE CORPORATION COMMISSION
 APR 9 1970
 CONSERVATION DIVISION
 Wichita, Kansas

RECEIVED
 STATE CORPORATION COMMISSION
 APR 9 1970
 CONSERVATION DIVISION
 Wichita, Kansas