

STATE OF KANSAS
STATE CORPORATION COMMISSION

Form CP-4

WELL PLUGGING RECORD

Give All Information Completely
Make Required Affidavit
Mail or Deliver Report to:
Conservation Division
State Corporation Commission
P. O. Box 17027
Wichita, Kansas 67217
NORTH

Hodgeman County, Sec. 26 Twp 22S Rge. (E) 24 (W)
Location as "NE/CNW'SW" or footage from lines C NW SE
Lease Owner Dane G. Hansen Trust
Lease Name Ford Well No. 2
Office Address Logan, Kansas 67646
Character of Well (completed as Oil, Gas or Dry Hole) Dry Hole
Date well completed October 13, 1975
Application for plugging filed October 13, 1975
Application for plugging approved October 13, 1975
Plugging commenced October 13, 1975
Plugging completed October 13, 1975
Reason for abandonment of well or producing formation Too low structurally

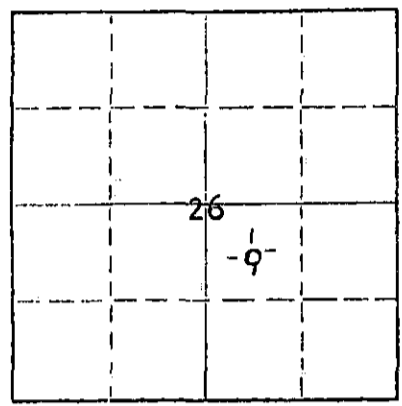

Locate well correctly on above Section Plat

If a producing well is abandoned, date of last production 19
Was permission obtained from the Conservation Division or its agents before plugging was commenced? Yes

Name of Conservation Agent who supervised plugging of this well Edgar J. Eves, Sublette, Kansas
Producing formation _____ Depth to top _____ Bottom _____ Total Depth of Well 4660 Feet
Show depth and thickness of all water, oil and gas formations.

OIL, GAS OR WATER RECORDS

CASING RECORD

FORMATION	CONTENT	FROM	TO	SIZE	PUT IN	PULLED OUT
				8 5/8"	403.52'	NONE

Describe in detail the manner in which the well was plugged, indicating where the mud fluid was placed and the method or methods used in introducing it into the hole. If cement or other plugs were used, state the character of same and depth placed, from _____ feet to _____ feet for each plug set.

Filled with heavy mud to 550'. Set plug.
Put in 50 sacks cement. Filled with heavy mud to 300'. Set plug. Put in 25 sacks cement. Filled with heavy mud, up to 40'. Set plug. Filled to top with 10 sacks cement.

10-30-75

(If additional description is necessary, use BACK of this sheet)

Name of Plugging Contractor C-G DRILLING CO
Address 1107 Union National Bldg, Wichita, KS 67202

STATE OF Kansas, COUNTY OF Sedgwick, ss.
Jay H. Galloway (employee of owner) or (owner or operator) of the above-described

well, being first duly sworn on oath, says: That I have knowledge of the facts, statements, and matters herein contained and the log of the above-described well as filed and that the same are true and correct. So help me God.

(Signature) Jay H. Galloway
Jay H. Galloway 1107 Union Natl Bldg
(Address)

Subscribed and sworn to before me this 18th day of October, 1975

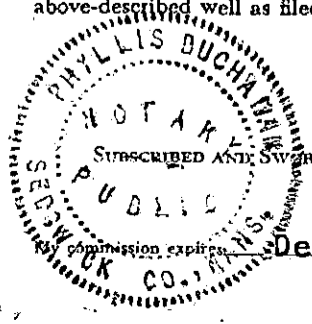

Phyllis Buchanan
Phyllis Buchanan
Notary Public.

December 7, 1975

KANSAS DRILLERS LOG

S. 26 T. 22S R. 24 ^X/_W

API No. 15 — 083 — 20441-0000
 County Number

Loc. C NW SE

County Hodgeman

Operator
DANE G HANSEN TRUST

Address
LOGAN, KANSAS 67546

Well No. 2 Lease Name FORD

Footage Location
660 feet from (N) ~~(S)~~ line 660 feet from ~~(E)~~ (W) line

Principal Contractor C-G DRILLING CO Geologist J. JESPERSEN

Spud Date OCTOBER 3, 1975 Total Depth 4660' P.B.T.D.

Date Completed OCTOBER 13, 1975 Oil Purchaser

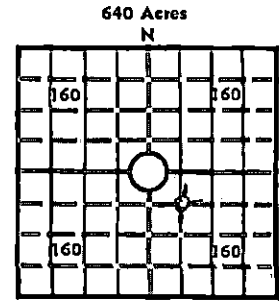

Elev.: Gr. _____

DF _____ KB 2391

CASING RECORD

Report of all strings set—surface, intermediate, production, etc.

Purpose of string	Size hole drilled	Size casing set (in O.D.)	Weight lbs/ft.	Setting depth	Type cement	Sacks	Type and percent additives
SURFACE	12 1/4"	8 5/8"	32#	403.52'	Common	250	2% GEL 3% CC

LINER RECORD

PERFORATION RECORD

Top, ft.	Bottom, ft.	Sacks cement	Shots per ft.	Size & type	Depth interval

TUBING RECORD

Size	Setting depth	Packer set at

ACID, FRACTURE, SHOT, CEMENT SQUEEZE RECORD

Amount and kind of material used	Depth interval treated

INITIAL PRODUCTION

Date of first production	Producing method (flowing, pumping, gas lift, etc.)
RATE OF PRODUCTION PER 24 HOURS	Oil _____ Gas _____ Water _____ Gas-oil ratio _____
Disposition of gas (vented, used on lease or sold)	Producing interval (s) _____

INSTRUCTIONS: As provided in KCC Rule 82-2-125, within 90 days after completion of a well, one completed copy of this Drillers Log shall be transmitted to the State Geological Survey of Kansas, 4150 Monroe Street, Wichita, Kansas 67209. Copies of this form are available from the Conservation Division, State Corporation Commission, 3830 So. Meridian (P.O. Box 17027), Wichita, Kansas 66217. Phone AC 316-522-2206. If confidential custody is desired, please note Rule 82-2-125. Drillers Logs will be on open file in the Oil and Gas Division, State Geological Survey of Kansas, Lawrence, Kansas 66044.

Operator

DANE G HANSEN TRUST

DESIGNATE TYPE OF COMP.: OIL, GAS, DRY HOLE, SWDW, ETC.:

DRY HOLE

Well No.

2

Lease Name

FORD

526 T22S R 24 ^{XB}/_W

WELL LOG

Show all important zones of porosity and contents thereof; cored intervals, and all drill-stem tests, including depth interval tested, cushion used, time tool open, flowing and shut-in pressures, and recoveries.

SHOW GEOLOGICAL MARKERS, LOGS RUN, OR OTHER DESCRIPTIVE INFORMATION.

FORMATION DESCRIPTION, CONTENTS, ETC.	TOP	BOTTOM	NAME	DEPTH
SAND & SHALE	0	1180		
SAND	1180	1290		
RED BED	1290	1607		
ANHYDRITE	1607	1649		
SHALE & SHELLS	1649	2185		
SHALE & LIME	2185	2430		
LIME & SHALE	2430	4295		
LIME	4295	4660		
TOTAL DEPTH		4660		

DST #1: 4608-4640' OPEN 30 SI 30
 OP 30 SI 30. WEAK BLOW F/10 MIN.
 REC 10' MUD. FBHP 154#, IFP 24#,
 FFP @24#, IBHP 521#.

USE ADDITIONAL SHEETS, IF NECESSARY, TO COMPLETE WELL RECORD.

Date Received

Phyllis Buchanan

Phyllis Buchanan
Office Manager

Signature

Title

October 20, 1975

Date