

STATE OF KANSAS
STATE CORPORATION COMMISSION

Form CP-4

Give All Information Completely
Make Required Affidavit
Mail or Deliver Report to:
Conservation Division
State Corporation Commission
212 No. Market
Wichita, Kansas 67202

WELL PLUGGING RECORD

HODGEMAN County, Sec. 17 Twp. 22s Rge. 24 (EXX) (W)

Location as "NE/CNW/SE/SW" or footage from lines C NE NW

Lease Owner PETROLEUM, INC.,

Lease Name SCHAUVLIEGE 'B' Well No. 1

Office Address R. R. #2, GREAT BEND, KANSAS

Character of Well (completed as Oil, Gas or Dry Hole) DRY HOLE

Date well completed FEBRUARY 8 19 72

Application for plugging filed FEBRUARY 8 19 72

Application for plugging approved FEBRUARY 8 19 72

Plugging commenced FEBRUARY 8 19 72

Plugging completed FEBRUARY 8, 19 72

Reason for abandonment of well or producing formation NO COMMERCIAL ZONE

If a producing well is abandoned, date of last production NONE 19

Was permission obtained from the Conservation Division or its agents before plugging was commenced? YES

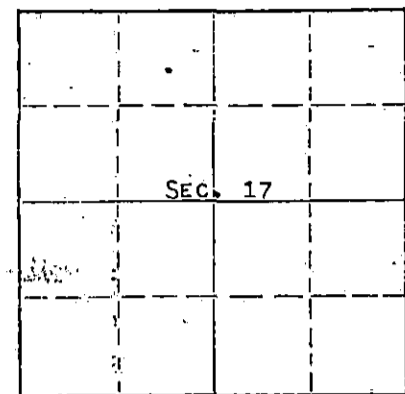

Locate well correctly on above Section Plat

Name of Conservation Agent who supervised plugging of this well ELDON J. EVES

Producing formation Depth to top Bottom Total Depth of Well 4710 Feet

Show depth and thickness of all water, oil and gas formations.

OIL, GAS OR WATER RECORDS.

CASING RECORD

FORMATION	CONTENT	FROM	TO	SIZE	PUT IN	PULLED OUT
				8-5/8"	596'	NONE

Describe in detail the manner in which the well was plugged, indicating where the mud fluid was placed and the method or methods used in introducing it into the hole. If cement or other plugs were used, state the character of same and depth placed, from feet to feet for each plug set.

HEAVY MUD TO 600', WOODEN PLUG, FOLLOWED WITH 70 SACKS CEMENT. HEAVY MUD TO 40', WOODEN PLUG, FOLLOWED WITH 1/2 SACK HULLS AND 10 SACKS CEMENT TO BASE OF WELL CELLAR.

RECEIVED
STATE CORPORATION COMMISSION
FEB 16 1972
CONSERVATION DIVISION
Wichita, Kansas

(If additional description is necessary, use BACK of this sheet)

Name of Plugging Contractor GARVEY DRILLING COMPANY

Address R.R. #2, GREAT BEND, KANSAS

STATE OF KANSAS, COUNTY OF BARTON, ss. MONTE CHADD (employee of owner) or (owner or operator) of the above-described well, being first duly sworn by oath, says: That I have knowledge of the facts, statements, and matters herein contained and the log of the above-described well as filed and that the same are true and correct. So help me God. MONTE CHADD, DIST. PROD. Supt.

(Signature) [Signature]

R.R. #2, GREAT BEND, KANSAS 67530 (Address)

Subscribed and sworn to before me this 14 day of FEBRUARY, 19 72

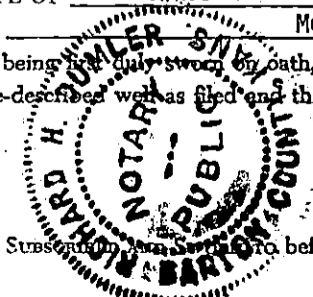

[Signature] Notary Public.

My commission expires MAY 28, 1973

WELL LOG

COMPANY Petroleum, Inc.
 FARM Schauvliege 'B' NO. 1
 TOTAL DEPTH 4710'
 COMM. 1-30-72 COMP. 2-8-72
 CONTRACTOR Garvey Drilling Company

SEC. 17 T. 22S R. 24W
 LOC. C NE NW
 COUNTY Hodgeman, Kansas

CASING
 8 5/8" @ 596' w/325sx

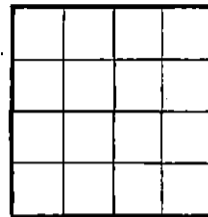

ELEVATION 2486' KB

PRODUCTION D & A

FIGURES INDICATE BOTTOM OF FORMATIONS

- 40' Clay
- 75' Sand
- 135' Shale
- 597' Sand & Shale
- 960' Shale & Red Bed
- 1160' Red Bed & Shale
- 1355' Sand
- 1620' Shale
- 1707' Anhydrite
- 2300' Lime & Shale
- 2595' Shale & Lime
- 2720' Lime & Shale
- 4150' Lime
- 4710' Lime
- 4710' RTD

RECEIVED
 STATE CORPORATION COMMISSION
 FEB 16 1972
 CONSERVATION DIVISION
 Wichita, Kansas

State of Kansas }
 County of Barton } SS

I, Charlene Marker of Garvey Drilling Company

upon oath state the above and foregoing is a true and correct copy of the log of the Schauvliege 'B' #1 well.

Subscribed and sworn to before me this 10th day of February 19 72

My Commission Expires: July 8, 1974

Charlene Marker

George A. [Signature]

 NOTARY PUBLIC