

STATE OF KANSAS  
STATE CORPORATION COMMISSION

Form CP-4

Give All Information Completely  
Make Required Affidavit  
Mail or Deliver Report to:  
Conservation Division  
State Corporation Commission  
212 No. Market  
Wichita, Kansas 67202

WELL PLUGGING RECORD

HO DGEMAN County. Sec. 9 Twp. 22s Rge. 24 (E) (W)

Location as "NE/CNW/SW" or footage from lines NE NE SW  
Lease Owner PETROLEUM, INC.,  
Lease Name COLLINGWOOD TRUSTEE 'C' Well No. 2  
Office Address R.R. #2, GREAT BEND, KANSAS  
Character of Well (completed as Oil, Gas or Dry Hole) DRY HOLE  
Date well completed OCTOBER 30 19 72  
Application for plugging filed OCTOBER 30 19 72  
Application for plugging approved OCTOBER 30 19 72  
Plugging commenced OCTOBER 30 19 72  
Plugging completed OCTOBER 30 19 72  
Reason for abandonment of well or producing formation NO COMMERCIAL ZONE

If a producing well is abandoned, date of last production NONE 19  
Was permission obtained from the Conservation Division or its agents before plugging was commenced? YES

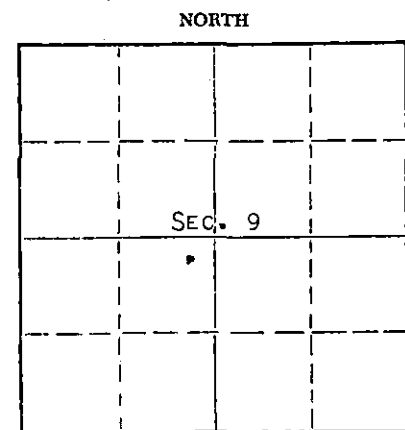

Locate well correctly on above Section Plat

Name of Conservation Agent who supervised plugging of this well EDGAR J. EVES  
Producing formation \_\_\_\_\_ Depth to top \_\_\_\_\_ Bottom \_\_\_\_\_ Total Depth of Well 4715 Feet  
Show depth and thickness of all water, oil and gas formations.

OIL, GAS OR WATER RECORDS

CASING RECORD

FORMATION	CONTENT	FROM	TO	SIZE	PUT IN	PULLED OUT
				8-5/8	682'	NONE

Describe in detail the manner in which the well was plugged, indicating where the mud fluid was placed and the method or methods used in introducing it into the hole. If cement or other plugs were used, state the character of same and depth placed, from \_\_\_\_\_ feet to \_\_\_\_\_ feet for each plug set.

HEAVY MUD TO 680', FOLLOWED WITH 35 SACKS CEMENT. HEAVY MUD TO 40', FOLLOWED WITH 15 SACKS CEMENT TO BASE OF WELL CELLAR.

RECEIVED  
STATE CORPORATION COMMISSION  
NOV 3 1972  
CONSERVATION DIVISION  
Wichita, Kansas

(If additional description is necessary, use BACK of this sheet)  
Name of Plugging Contractor GARVEY DRILLING COMPANY  
Address R.R. #2, GREAT BEND, KANSAS

STATE OF KANSAS, COUNTY OF BARTON, ss.  
MONTE CHADD, (employee of owner) or (owner or operator) of the above-described well, being first duly sworn on oath, says: That I have knowledge of the facts, statements, and matters herein contained and the log of the above-described well as filed and that the same are true and correct. So help me God. MONTE CHADD, DIST. PROD. SUPT.

(Signature) *Monte Chadd*  
R.R. #2, GREAT BEND, KANSAS  
(Address)

Subscribed and sworn to before me this 2 day of NOVEMBER, 1972

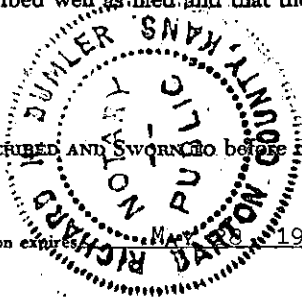

*Richard H. Dumber*  
Notary Public.

# WELL LOG

COMPANY Petroleum, Inc.

SEC. 9 T. 22S R. 24W

FARM Collingwood Trustee 'C' NO. 2

LOC. NE NE SW

TOTAL DEPTH 4715'

COUNTY Hodgeman, Kansas

COMM. 10-19-72 COMP. 10-30-72

CONTRACTOR Garvey Drilling Company

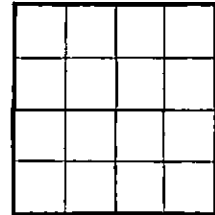

CASING  
8 5/8" @ 682' w/325sx

ELEVATION 2473' KB

PRODUCTION D & A

FIGURES INDICATE BOTTOM OF FORMATIONS

- 60' Shale & Sand
- 150' Shale
- 1070' Shale & Red Bed
- 1190' Red Bed & Shale
- 1390' Sand
- 1620' Red Bed & Shale
- 1758' Anhydrite
- 2000' Shale
- 2345' Lime & Shale
- 4195' Lime
- 4690' Lime & Chert
- 4715' Lime & Chert
- 4715' RTD

**RECEIVED**  
 STATE CORPORATION COMMISSION  
 NOV 3 1972  
 CONSERVATION DIVISION  
 Wichita, Kansas

State of Kansas }  
 County of Barton } SS

I, Charlene Marker of Garvey Drilling Company

upon oath state the above and foregoing is a true and correct copy of the log of the Collingwood Trustee 'C' #2 well.

Charlene Marker

Subscribed and sworn to before me this 1st day of November 1972

My Commission Expires: July 8, 1974

Leone A. Powell  
 NOTARY PUBLIC