

STATE OF KANSAS
STATE CORPORATION COMMISSION

Form CP-4

Give All Information Completely
Make Required Affidavit
Mail or Deliver Report to:
Conservation Division
State Corporation Commission
212 No. Market
Wichita, Kansas 67202

WELL PLUGGING RECORD

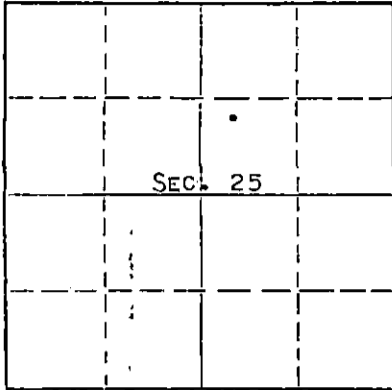

KINGMAN County. Sec. 25 Twp. 30s Rge. 9 (W)
Location as "NE/CNW/SW" or footage from lines NW SW NE
Lease Owner PETROLEUM, INC.,
Lease Name DEPENBUSCH 'K' Well No. 1
Office Address R.R. #2, GREAT BEND, KANSAS
Character of Well (completed as Oil, Gas or Dry Hole) DRY HOLE
Date well completed NOVEMBER 28 19 70
Application for plugging filed NOVEMBER 28 19 70
Application for plugging approved NOVEMBER 28 19 70
Plugging commenced NOVEMBER 28 19 70
Plugging completed NOVEMBER 28 19 70
Reason for abandonment of well or producing formation NO PRODUCING ZONE

If a producing well is abandoned, date of last production NONE 19
Was permission obtained from the Conservation Division or its agents before plugging was commenced? YES

Name of Conservation Agent who supervised plugging of this well R. G. BIBERSTEIN
Producing formation _____ Depth to top _____ Bottom _____ Total Depth of Well 4354' Feet
Show depth and thickness of all water, oil and gas formations.

OIL, GAS OR WATER RECORDS

CASING RECORD

FORMATION	CONTENT	FROM	TO	SIZE	PUT IN	PULLED OUT
				8-5/8"	257'	NONE

Describe in detail the manner in which the well was plugged, indicating where the mud fluid was placed and the method or methods used in introducing it into the hole. If cement or other plugs were used, state the character of same and depth placed, from _____ feet to _____ feet for each plug set.

HEAVY MUD TO 250', WOODEN PLUG, PLACED 25 SACKS CEMENT ON TOP OF PLUG.
HEAVY MUD TO 40', WOODEN PLUG, PLACED 10 SACKS CEMENT ON TOP OF PLUG TO BASE OF WELL CELLAR.

RECEIVED
STATE CORPORATION COMMISSION
DEC 7 - 1970
CONSERVATION DIVISION
Wichita, Kansas

(if additional description is necessary, use BACK of this sheet)
Name of Plugging Contractor GARVEY DRILLING COMPANY
Address R.R. #2, GREAT BEND, KANSAS

STATE OF KANSAS, COUNTY OF BARTON, ss.
MONTE CHADD (employee of owner) or (owner or operator) of the above-described well, being first duly sworn on oath, says: That I have knowledge of the facts, statements, and matters herein contained and the log of the above-described well is filed and that the same are true and correct. So help me God. MONTE CHADD, DIST. PROD. SUPT.

(Signature)

R.R. #2, GREAT BEND, KANSAS 67530
(Address)

Subscribed and sworn to before me this 3 day of DECEMBER, 1970

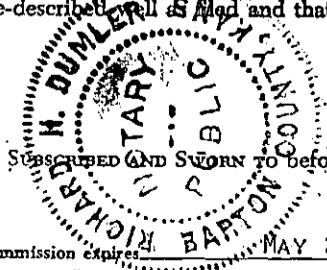

My commission expires

MAY 28, 1973

Notary Public.

WELL LOG

COMPANY Petroleum, Inc.

SEC. 25. T. 30S R. 9W

FARM Depenbusch "K" NO. 1

LOC. NW SW NE

TOTAL DEPTH 4354'

COUNTY Kingman, Kansas

COMM. 11-20-70 COMP. 11-28-70

CONTRACTOR Garvey Drilling Company

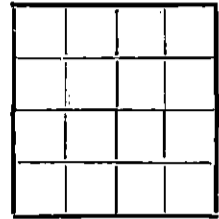

CASING
8 5/8" @ 257' w/200sx

ELEVATION 1624' KB.

PRODUCTION D & A

FIGURES INDICATE BOTTOM OF FORMATIONS

- 10' Sand
- 190' Red Bed
- 1470' Red Bed, Shale, & Shells
- 1760' Shale & Lime
- 2030' Lime & Shale
- 3865' Lime
- 4354' Lime & Chert
- 4354' RTD

RECEIVED
STATE CORPORATION COMMISSION
DEC 7 - 1970
CONSERVATION DIVISION
Wichita, Kansas

State of Kansas }
County of Barton } SS

I, Charlene Marker of Garvey Drilling Company

upon oath state the above and foregoing is a true and correct copy of the log of the Depenbusch "K" No. 1 well.

Subscribed and sworn to before me this 1st day of December 19 70

My Commission Expires: July 8, 1974

Charlene Marker
[Signature]
NOTARY PUBLIC