

115-095-01310-0000

STATE OF KANSAS  
STATE CORPORATION COMMISSION

Give All Information Completely  
Make Required Affidavit  
Mail or Deliver Report to:  
Conservation Division  
State Corporation Commission  
211 No. Broadway  
Wichita, Kansas

WELL PLUGGING RECORD

NORTH

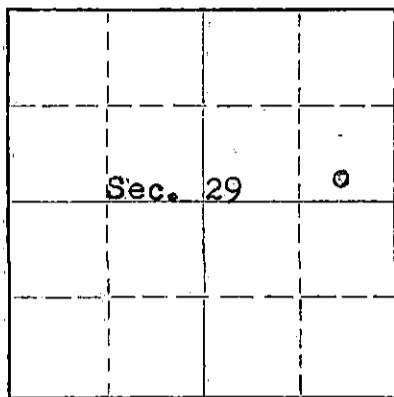

Locate well correctly on above  
Section Plat

Kingman County. Sec. 29 Twp. 30 Rge. 9 (E) W (W)  
Location as "NE/CNW/SW" or footage from lines Approx. C SE NE  
Lease Owner Petroleum, Inc.  
Lease Name Werner Well No. 1  
Office Address Route 2, Great Bend, Kansas  
Character of Well (completed as Oil, Gas or Dry Hole) Dry hole  
Date well completed February 7 19 58  
Application for plugging filed February 8 19 58  
Application for plugging approved February 7 19 58  
Plugging commenced February 7 19 58  
Plugging completed February 7 19 58  
Reason for abandonment of well or producing formation No producible zones

If a producing well is abandoned, date of last production None 19       
Was permission obtained from the Conservation Division or its agents before plugging was commenced? Yes

Name of Conservation Agent who supervised plugging of this well Mr. Fred W. Hampel  
Producing formation ----- Depth to top -- Bottom -- Total Depth of Well 4447 Feet  
Show depth and thickness of all water, oil and gas formations.

OIL, GAS OR WATER RECORDS

CASING RECORD

FORMATION	CONTENT	FROM	TO	SIZE	PUT IN	PULLED OUT
				8 5/8"	268'	None

Describe in detail the manner in which the well was plugged, indicating where the mud fluid was placed and the method or methods used in introducing it into the hole. If cement or other plugs were used, state the character of same and depth placed, from      feet to      feet for each plug set.

Mud up with heavy mud to 250' pushed down 1/2 sack hulls to 250' followed by wooden plug. Placed 20 sacks cement through drill pipe on to plug. Mud up to 35' and placed 1/3 sack hulls at 35' followed by wooden plug and 10 sacks cement to base of well cellar.

RECEIVED  
STATE OF KANSAS

FEB 15 1958

CONSERVATION DIVISION  
WICHITA, KANSAS

2-15-58

(If additional description is necessary, use BACK of this sheet)

Name of Plugging Contractor Garvey Drilling Co.  
Address Route 2, Great Bend, Kansas

STATE OF KANSAS, COUNTY OF BARTON, ss.  
Don Searle (employee of owner) or (~~owner~~) of the above-described well, being first duly sworn on oath, says: That I have knowledge of the facts, statements, and matters herein contained and the log of the above-described well as filed and that the same are true and correct. So help me God.

(Signature) Don Searle

Route 2, Great Bend, Kansas  
(Address)

SUBSCRIBED AND SWORN TO before me this 12th day of February, 19 58

John J. Brown  
Notary Public.

My commission expires July 11, 1960

PLUGGING  
FIL- SEC 29T.30R.9W  
BOOK PAGE 8/11 LINE 25

# WELL LOG

15-095-01310-0000

COMPANY PETROLEUM, INCORPORATED

SEC. 29 T. 30S R. 9W

FARM WERNER NO. 1

Loc. Approx. C-SE, NE

TOTAL DEPTH 4447'

COUNTY KINGMAN CO., KANSAS

COMM. January 27, 1958 COMP. February 7, 1958

CONTRACTOR GARVEY DRILLING COMPANY

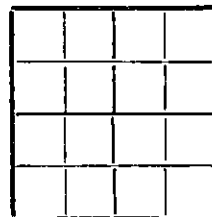

CASING 8 5/8" @ 268' W/200 sax.

ELEVATION

PRODUCTION D & A

FIGURES INDICATE BOTTOM OF FORMATIONS

15	Surface soil
75	Sand
168	Red bed
487	Red bed & shale
1430	Shale & shells
1720	Lime & shale
1907	Lime
3400	Lime & shale
3704	Sand, lime & shale
4180	Lime
4340	Lime & shale
4347	Lime
4367	Chert
4397	Chert & lime
4447	Lime
4447	T. D.

RECEIVED  
STATE CORPORATION COMMISSION

FEB 15 1958

CONSERVATION DIVISION

2-15-58

State of KANSAS }  
County of BARTON } ss:

PLUGGING  
FILE SEC 29 T. 30 R. 9W  
BOOK PAGE 81 LINE 25

I, VERNE A. MORRIS of GARVEY DRILLING COMPANY

upon oath state that the above and foregoing is a true and correct copy of the log of the #1 WERNER well

*Verne A. Morris*

Subscribed and sworn to before me this 11th day of February 19 58

My Commission Expires: November 12, 1958

*Beauford*  
NOTARY PUBLIC