

STATE CORPORATION COMMISSION  
Wichita State Office Building  
130 S. Market, Room 2078  
Wichita, KS 67202

K.A.R.-82-3-117

API NUMBER 15-055-20081-000

LEASE NAME Garden City "B"

TYPE OR PRINT  
NOTICE: Fill out completely  
and return to Coas. Div.  
office within 30 days.

WELL NUMBER 10

1980 Ft. from <sup>N</sup> Section Line

660 Ft. from <sup>W</sup> Section Line

SEC. 5 TWP. 22SRGE.33W (E) or (W)

COUNTY Finney

LEASE OPERATOR Cross Timbers Operating Company

ADDRESS 210 Park Ave., Suite 2350

PHONE# (405) 232-4011 OPERATORS LICENSE NO. 5153

Character of Well Oil

Date Well Completed 03-13-72

Plugging Commenced 05-22-97

(Oil, Gas, D&A, SWD, Input, Water Supply Well)

Plugging Completed 05-29-97

The plugging proposal was approved on approximately May 2, 1997 (date)

by Mr. Steve Durrant (KCC District Agent's Name).

is ACO-1 filed? NA If not, is well log attached? Mailed w/CP-1 05-01-97

Producing Formation St. Louis Depth to Top 4703' Bottom 4711' T.D. 4800'

Show depth and thickness of all water, oil and gas formations.

OIL, GAS OR WATER RECORDS | CASING RECORD

Formation	Content	From	To	Size	Put In	Pulled out
St. Louis	Oil	4703	4711	8 5/8"	412'	-0-
Ft. Scott	Oil	4406	4412	5 1/2"	4799'	700'
Marmaton	Oil	4325	4381			

Describe in detail the manner in which the well was plugged, indicating where the mud fluid was placed and the method or methods used in introducing it into the hole. If cement or other plug were used, state the character of same and depth placed, from feet to feet each set.  
Pump 50 bbls mud, well on vacuum, set 5 1/2" CTBP @ 4397' w/2 sxs cmt on top. Set 8 5/8" CTBP @ 4275' w/2 sxs cmt on top. Load hole with mud, cut casing @ 1150' casing would not pull. Pump 80 sxs cmt from 1150 to 1050', cut casing @ 700', pull casing. RTW w/tubing, circ-hole with mud. Pump 50 sxs cmt from 450' to 350', lay down tubing. Pump 10 sxs cmt from 40' to 44' cut off head and weld on ID plate.

Name of Plugging Contractor Petrofield Services Corporation License No. 7-31330

Address 110 South Hartford, Suite 117, Tulsa, Oklahoma 74120

Name of Party Responsible for Plugging Fees: Cross Timbers Operating Company

State of Oklahoma County of Oklahoma, ss.

Bruce E. Hankins (Employee of Operator) or (Operator) of above-described well, being first duly sworn on oath, says: That I have knowledge of the facts and statements, and matters herein contained and the log of the above-described well as filed that the same are true and correct, so help me God.

(Signature) Bruce E. Hankins

(Address) 210 Park Ave., Suite 2350  
Oklahoma City, Oklahoma 73102

SUBSCRIBED AND SWORN TO before me this 25th day of June, 19 97

Kayle Dunham  
Notary Public

My Commission Expires: 11-19-98

USE ONLY ONE SIDE OF EACH FORM

# WELL LOG

COMPANY **Texaco, Inc.**  
 FARM **Garden City 'B'** NO. **10**  
 TOTAL DEPTH **4800'**  
 COMM. **2-18-72** COMP. **2-28-72**  
 CONTRACTOR **Garvey Drilling Company**

SEC. **5** T. **22S** R. **33W**  
 LOC. **C SW NW**

COUNTY **Finney, Kansas**

**CASING**

**8 5/8" @ 412' w/350sx**  
**5 1/2" @ 4799' w/100sx**  
**DV tool @ 2810' w/100sx**

ELEVATION

PRODUCTION

FIGURES INDICATE BOTTOM OF FORMATIONS

- 320' Shale & Clay
- 412' Shale & Shells
- 1250' Shale & Sand
- 2010' Shale
- 2620' Shale & Lime
- 2787' Shale
- 2915' Shale & Lime
- 3315' Lime & Shale
- 4360' Lime
- 4800' Lime
- 4800' RTD

**RECEIVED**  
 KANSAS CORPORATION COMMISSION

**MAY 02 1997**

CONSERVATION DIVISION  
 WICHITA, KS

State of Kansas }  
 County of Barton } as

I, Charlene Marker of Garvey Drilling Company

upon oath state the above and foregoing is a true and correct copy of the log of the Garden City 'B' #10 well.

Charlene Marker

Subscribed and sworn to before me this 1st day of March 19 72

My Commission Expires: July 8, 1974

George A. Quinn  
 NOTARY PUBLIC

KANSAS CORPORATION COMMISSION

WELL RECORD

CONSERVATION DIVISION  
WICHITA, KANSAS

15-OSS-20081-0600

(Mail to Kansas Geological Survey, 4150 Monroe Street, Wichita, Kansas 67209)

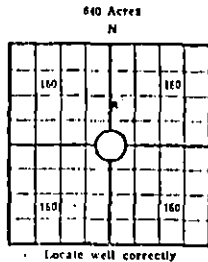

Lease Name: Garden City "B" Well No. 10  
 Well Located: 5-22S-33W  
SEC C TWP SW RGE NW  
 Operator: Texaco Inc.  
 Address: Box 2420, Tulsa, Okla.  
 Elevation: Ground 2890' D.F. 2895' K.B. 2897'  
 Type Well: (Oil, gas, dry hole) Oil

Drilling Commenced: 2-19 1972 Drilling Completed: 2-27 1972  
 Well Completed: 3-13- 1972 Total Depth 4800'  
 Initial Production: 102 BO - Tr wtr/24 hrs.

Casing Record

Size: 8-5/8" Set at 412' Size: \_\_\_\_\_ Set at \_\_\_\_\_  
 Size: 5-1/2" Set at 4799' Size: \_\_\_\_\_ Set at \_\_\_\_\_

Liner Record

Size: None Set from \_\_\_\_\_ To \_\_\_\_\_

Cementing

Casing Size	Sacks	Type Cement and Additives
<u>8-5/8</u>	<u>350</u>	<u>50-50 poz, 3% CaCl</u>
<u>5-1/2</u>	<u>100 Thru Shoe</u>	<u>50-50 poz, 10% salt + 12.5# Gilsomite</u>
	<u>100 5/8 Thru DV T&amp;I @ 2810</u>	<u>50/50 Poz 10% Salt + 12.5# Gilsomit-</u>

Perforations

Formation	Perforated Interval and Number Shots
<u>St. Louis</u>	<u>4703-11' w/2jets/ft.</u>
_____	_____
_____	_____

Electric Log Run (Show type log and depths covered)

Dual Ind. Laterolog - 410 to 4800'  
Comp. Formation Density 3300 to 4800'

(Fill in formation and related information on reverse side)

FORMATION, TESTING AND COMPLETION RECORD

Formation	Top	Bottom	Show Drill Stem Tests, Well Stimulation and Production Tests
St. Louis	4768	4800	Complete Oil Pmpg 102 BO - Tr wtr 24 hrs from St. Lou perms 4703-11' after acidizing with 2,000 gal 15% NEA.

**RECEIVED**  
KANSAS CORPORATION COMMISSION

MAY 02 1997

CONSERVATION DIVISION  
WICHITA, KS

PETROFIELD SERVICES CORPORATION

April 30, 1997

Controlling Agency: K.C.C. District I  
Field Representative: Richard Lachey

(316)225-6760

15-055-20081-0001

**Well:** Garden City "B" #10  
Cross Timber Operating Company  
C SW NW Sec. 05-22S-33W  
Finney Co., KS

**Tubulars:** 8-5/8" 24.0# H-40 @ 411' w/350 sacks.  
5-1/2" J-55 @ 4,799' w/100 sacks.  
2-3/8" J-55 EUE @ 4,702'.  
3/4" & 5/8" rods @ 4,800'.

**Recovery:** 5-1/2" J-55 - (est. 511' - 2000').  
2-3/8" J-55 EUE - est. 4,702'.  
3/4" & 5/8" rods - est. 4,800'.

**Comments:** Completed: 03-1972  
BTW: 000'.

Perfs: Marmaton: 4,325' - 4,330'.  
Marmaton: 4,385' - 4,387'.  
Ft. Scott: 4,406' - 4,412'.  
St. Louis: 4,703' - 4,711'.  
TD: 4,800' PBD: 4,765'.  
TOC: 4,200'

BOP: Yes

DV tool at 2,811', sqz. w/100 sacks.

Csg. leak at 3,470' - 3,502'. Sqz. w/100 sacks, resqz. w/50 sacks.

No rig anchors.

RECEIVED  
KANSAS CORPORATION COMMISSION

MAY 02 1997

CONSERVATION DIVISION  
WICHITA, KS

**PLUGGING PROCEDURE**

1. Rig to location.
2. Install rig anchors.
3. Rig up.
4. Install BOP.
5. Pull rods - LD 4,800'.
6. Circulate and load hole with 9.0# mud.
7. Pull 2-3/8" tubing - standing back 2000'.
8. Run gauge ring and junk basket.
9. Set 5-1/2" CIBP with 2 sacks of cement at 4,397'.
10. Set 5-1/2" CIBP with 2 sacks of cement at 4,275'.
11. Set off head and weld on 5-1/2" nipple.
12. Take slips off head and work 5-1/2" casing.

Plugging Procedure  
Garden City "B" #10  
Page #2

13. Shoot 5-1/2" casing at freepoint.
14. Pull 5-1/2" casing - laying down.
15. RIH with 2-3/8" tubing to 2000'.
16. Load hole with 9.0# mud.
17. Spot 50 sacks of cement at 2000'.
18. Pull tubing up to 1150' and spot 80 sacks of cement.
19. Pull tubing up to 450' and spot 50 sacks of cement.
20. Pull tubing up to 40' and spot 10 sacks of cement.
21. Cut off head 4' below ground and weld on ID plate.
22. Rig down.

**RECEIVED**  
KANSAS CORPORATION COMMISSION

MAY 02 1997

CONSERVATION DIVISION  
WICHITA, KS

**Cross Timbers Operating Co.  
Garden City B #10**

C SW NW Sec 5-22S-33W  
Finney County, Ks

Spud: 02/18/72  
Comp: 03-13-72

Surf Csg: 8 5/8", 24 lb, H40. Set  
@ 411'. Cmt'd w/ 350 sx 50/50  
Pozmix. Circ. 12 1/4" hole.

DV Tool @ 2811'

11 1/75 Csg Leak 3470-3502'. Sqz w/  
100 sx H. Resqz w/ 50 sx H. Tst to  
600#

TOC : Good bond to top of log @4200'

Prod Csg: 5 1/2", J55. Set @  
4799'. Cmt w/ 100 sx 50/50  
Pozmix w/ 10% salt and 12 1/2#  
Gilsonite. DV Tool @ 2811'. Cmt  
w/ 100 sx same.

PBTD: 4765'  
TD: 4800'

**Present Completion**

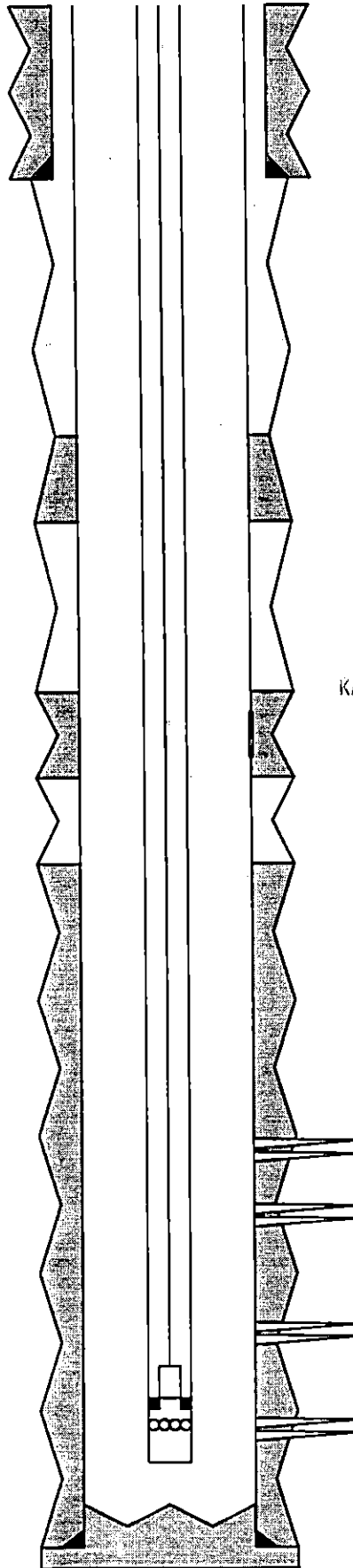

8/9/95

15-055-20081-0001

GL: 2890'  
KB: 2897'

**Tbg Detail (06-89)**

150 jts 2 3/8" J-55 EUE  
1 2 3/8" SN @ 4702'  
1 Baker TAC  
1 P.S.  
1 BP/MA

**Rod Detail**

75 5/8" rods  
117 3/4" rods  
1 2" x 1 1/2" x 15' Pmp

**RECEIVED**  
KANSAS CORPORATION COMMISSION

MAY 02 1997

CONSERVATION DIVISION  
WICHITA, KS

12/16/78 Marmaton 4325-30' (4 SPF)  
Acid: 2000g 15%. Com tst 72 BO & 188 BW.

12/16/78 Marmaton 4385-87' (4 SPF)  
Acid: 1000g 15%. Com tst 72 BO & 188 BW.

12/16/78 Ft Scott 4406-12' (4 SPF)  
Acid: 2000g 15%. Com tst 72 BO & 188 BW.

St Louis 4703-11' ( 2 SPF)  
Orig Acid: 2000g 15% NEA. IP 87 BO & tr Wtr



DUAL INDUCTION  
SHORT GUARD LOG  
EXPERIMENTAL

COMPANY WELL FIELD County State	COMPANY	TEXACO INC				
		15-055-20081-0000				
	WELL	GARDEN CITY "B" #10				
	FIELD	DAMME				
	County	FINNEY	STATE	KANSAS		
	Location	C SW NW		Other Services: TEL COM DEN		
	Sec.	5	Twp	225	Rge	33W

Permanent Datum	66	Elev.	2890	Elev.: K.B.	2897
Log Measured From	KB	7	RECEIVED	D.F.	2895
Drilling Measured From	KB	KANSAS CORPORATION COMMISSION		G.L.	2890

Date	2-27-72	MAY 02 1997 CONSERVATION DIVISION WICHITA, KS CONFIDENTIAL			
Run No.	ONE				
Depth-Driller	4800				
Depth-Welex	4798				
Btm. Log Inter.	4798				
Top Log Inter.	1500				
Casing-Driller	8 3/8 @ 412	@	@	@	@
Casing-Welex	410				
Bit Size	7 7/8				
Type Fluid in Hole	W. B. MUD CHEMICALS				
Dens.   Visc.	9.6   59				
pH   Fluid Loss	19.2 ml	ml	ml	ml	ml
Source of Sample	CIRCULATED				
R <sub>int</sub> @ Meas. Temp.	.24 @ 46 °F	@ °F	@ °F	@ °F	@ °F
R <sub>int</sub> @ Meas. Temp.	.15 @ 60 °F	@ °F	@ °F	@ °F	@ °F
R <sub>int</sub> @ Meas. Temp.	.27 @ 58 °F	@ °F	@ °F	@ °F	@ °F
Source R <sub>int</sub> R <sub>int</sub>	MEASURED				
R <sub>int</sub> @ BHT	.10 @ 115 °F	@ °F	@ °F	@ °F	@ °F
Time Since Circ.	3 HR				
Max. Rec. Temp.	115 °F @ 4790	°F @	°F @	°F @	°F @
Equip.   Location	8429   LIB				
Recorded By	OWENS, FERRIS	SEIBER			
Witnessed By	MR. NORMAN				

LAHOH --- AA .05845

Fold Here