

STATE OF KANSAS
STATE CORPORATION COMMISSION
200 Colorado Derby Bldg.
Wichita, Kansas 67202

RECEIVED
OCT 25 1982
STATE CORPORATION COMMISSION
CONSERVATION DIVISION
Wichita, Kansas

WELL PLUGGING RECORD

Give All Information Completely
Make Required Affidavit

COUNTY Rice SEC. 3 TWP. 22S RGE. 8W E/W
Location as in quarters or footage from lines:
SW SW

Locate Well
correctly on above
Section Platt.

Lease Owner Hinkle Oil Company
Lease Name Mayer A-1 Well No. _____
Office Address 1016 Union Center Wichita, Ks. 67202
Character of Well (Completed as Oil, Gas or Dry Hole): _____
Date Well Completed _____
Application for plugging filed _____
Plugging commenced 10-13-82
Plugging completed 10-19-82
Reason for abandonment of well or producing formation _____

Depleted
Was permission obtained from the Conservation Division or it's
Agent's before plugging was commenced? Yes

Name of Conservation Agent who supervised plugging of this well Gilbert Toman
Producing formation _____ Depth to top _____ bottom _____ T.D. 3480'
Show depth and thickness of all water, oil and gas formations.

OIL, GAS OR WATER RECORDS Casing Record

Formation	Content	From	To	Size	Put in	Pulled Out
				8-5/8"	238'	none
				4-1/2"	3468'	2807'

Describe in detail the manner in which the well was plugged, indicating where the mud fluid was placed and the method or methods used in introducing it into the hold. If cement or other plugs were used, state the character of same and depth placed, from _____ feet to _____ feet for each plug set.

Pumped bottom with 50 sacks cement, 3% cc and plug stopped @3300'. Shot casing @2920', 2835', pulled a total of 67 joints of 4-1/2" casing. Plugged well with 5 sacks hulls, 25 sacks gel, 100 sacks 50/50 pos, 2% gel, 3% cc.
Plugging Complete.

(If additional description is necessary, use BACK of this sheet)
Name of Plugging Contractor Kelso Casing Pulling

STATE OF Kansas COUNTY OF Rice, ss.
R. Darrell Kelso (employee of owner) or (owner or operator) of the above-described well, being first duly sworn on oath, says: That I have knowledge of the facts, statements, and matters herein contained and the log of the above-described well as filed and that the same are true and correct. So help me God.

(Signature) R. Darrell Kelso
Box 347 Chase, Ks. 67524
(Address)

SUBSCRIBED AND SWORN TO before me this 21st. day of October, 19 82

My Commission expires:  Irene Hoover
Notary Public.

KANSAS

WELL COMPLETION REPORT AND
DRILLER'S LOG

S. 3 T. 22S R. 8 XX
W

API No. 15 — 159 — 21,074-0000
County Number

Loc. SW SW

County Rice

Operator
Hinkle Oil Company

Address
1016 Union Center Building, Wichita, Kansas 67202

Well No. 1 Lease Name Mayer "A"

Footage Location
660 feet from (N) (S) line 660 feet from (E) (W) line

Principal Contractor Dunne-Gardner Petroleum, Inc. Geologist Orvie Howell

Spud Date 3-30-81 Date Completed 5-12-81 Total Depth 3480' P.B.T.D. 3431'

Directional Deviation Oil and/or Gas Purchaser Peoples Natural Gas Co.

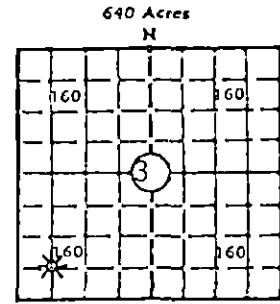

Elev.: Gr. 1647
DF _____ KB 1657'

CASING RECORD

Report of all strings set— surface, intermediate, production, etc.

Purpose of string	Size hole drilled	Size casing set (in O.D.)	Weight lbs/ft.	Setting depth	Type cement	Sacks	Type and percent additives
Surface	10 3/4"	8 5/8"	20#	238'	60-40 Posmix	200	2% Ge1, 3% CaCl
Production	7 7/8"	4 1/2"	10.5#	3468'	60-40 Posmix	125	-

LINER RECORD

PERFORATION RECORD

Top, ft.	Bottom, ft.	Sacks cement	Shots per ft.	Size & type	Depth interval
			2	SSB	3357-67

Size	Setting depth	Packer set at
2 3/8"	3320'	

ACID, FRACTURE, SHOT, CEMENT SQUEEZE RECORD

Amount and kind of material used	Depth interval treated
20,000 Gallons Foam Frac + 20,000# Sand	3357-67

INITIAL PRODUCTION

Date of first production Shut In		Producing method (flowing, pumping, gas lift, etc.)			
RATE OF PRODUCTION PER 24 HOURS	Oil	Gas	Water	Gas-oil ratio	CFPB
	bbls.	80	MCF	10	bbls.
Disposition of gas (vented, used on lease or sold) Will Sell			Producing interval(s) 3357-67		

INSTRUCTIONS: As provided in KCC Rule 82-2-125, within 90 days after completion of a well, one completed copy of this Drillers Log shall be transmitted to the State Geological Survey of Kansas, 4150 Monroe Street, Wichita, Kansas 67209. Copies of this form are available from the Conservation Division, State Corporation Commission, 245 No. Water, Wichita, Kansas 67202. Phone AC 316-522-2206. If confidential custody is desired, please note Rule 82-2-125. Drillers Logs will be on an open file in the Oil and Gas Division, State Geological Survey of Kansas, Lawrence, Kansas 66044.

15-159-21074-0000

Operator **Hinkle Oil Company** DESIGNATE TYPE OF COMP.: OIL, GAS, DRY HOLE, SWDW, ETC.: **Gas**

Well No. **7** Lease Name **Mayer "A"** Cased Hole Gamma Ray Neutron

S **3** T **22S** R **8** E **W**

WELL LOG

Show all important zones of porosity and contents thereof; cored intervals, and all drill-stem tests, including depth interval tested, cushion used, time tool open, flowing and shut-in pressures, and recoveries.

SHOW GEOLOGICAL MARKERS, LOGS RUN, OR OTHER DESCRIPTIVE INFORMATION.

FORMATION DESCRIPTION, CONTENTS, ETC.	TOP	BOTTOM	NAME	DEPTH
			HEEBNER	2814
			BROWN LIME	2959
			LANSING	2980
			BKC	3300
			MISSISSIPPIAN CHERT	3353
			KINDERHOOK SHALE	3376
			PBTD	3431

USE ADDITIONAL SHEETS, IF NECESSARY, TO COMPLETE WELL RECORD.

Date Received	<i>Chris Lowell</i>
	Signature
	Manager
	Title
	<i>May 27, 1981</i>
	Date