

CONFIDENTIAL

ORIGINAL

RELEASED

15-185-22544-0001

MAR 05 1992

SIDE ONE

CONFIDENTIAL

STATE CORPORATION COMMISSION OF KANSAS
OIL & GAS CONSERVATION DIVISION
WELL COMPLETION FORM
ACO-1 WELL HISTORY
DESCRIPTION OF WELL AND LEASE

API NO. FROM 160-22-544-A

Operator: License # 6030

Name: Ainsworth Operating Company

Address Box 1269

City/State/Zip Colorado Springs, CO 80901

Purchaser: Clear Creek

Operator Contact Person: Terry Hidy

Phone (719) 576-5300

Contractor: Name: Abercrombie Drilling, Inc.

License: 5422

Wellsite Geologist: Terry Hidy

Designate Type of Completion

New Well Re-Entry Workover

Oil SWD Temp. Abd.

Gas Inj Delayed Comp.

Dry Other (Core, Water Supply, etc.)

If OWO: old well info as follows:

Operator: H-30 Incorporated

Well Name: 1A-5 Sleeper

Comp. Date 9-25-88 Old Total Depth 3660'

Drilling Method:

Mud Rotary Air Rotary Cable

1-15-91 1-17-91 1-25-91

Spud Date Date Reached TD Completion Date

County Stafford

S/2 SW NW Sec. 5 Twp. 22S Rge. 11 East West

2970' Ft. North from Southeast Corner of Section

4950' Ft. West from Southeast Corner of Section

(NOTE: Locate well in section plat below.)

Lease Name Sleeper C Well # 1 (OWWO)

Field Name Wildcat

Producing Formation WYCKOFF Conglomerate Sand

Elevation: Ground '1755' KB 1767'

Total Depth 3666' PBTD 3605

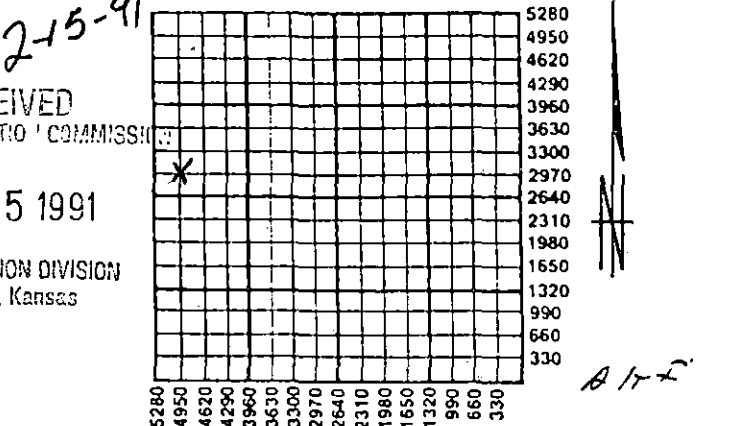

Amount of Surface Pipe Set and Cemented at 268' Feet

Multiple Stage Cementing Collar Used? Yes No

If yes, show depth set _____ Feet

If Alternate II completion, cement circulated from _____

feet depth to _____ w/ _____ sx cmt.

INSTRUCTIONS: This form shall be completed in triplicate and filed with the Kansas Corporation Commission, 200 Colorado Derby Building, Wichita, Kansas 67202, within 120 days of the spud date of any well. Rule 82-3-130, 82-3-107 and 82-3-106 apply. Information on side two of this form will be held confidential for a period of 12 months if requested in writing and submitted with the form. See rule 82-3-107 for confidentiality in excess of 12 months. One copy of all wireline logs and drillers time log shall be attached with this form. ALL CEMENTING TICKETS MUST BE ATTACHED. Submit CP-4 form with all plugged wells. Submit CP-111 form with all temporarily abandoned wells. Any recompletion, workover or conversion of a well requires filing of ACO-2 within 120 days from commencement date of such work.

All requirements of the statutes, rules and regulations promulgated to regulate the oil and gas industry have been fully complied with and the statements herein are complete and correct to the best of my knowledge.

Signature Terry Hidy

Title Geologist Date 2-11-91

Subscribed and sworn to before me this 11th day of February, 19 91.

Notary Public Trisha K. Nolen

Date Commission Expires 10/07/94

K.C.C. OFFICE USE ONLY

F Letter of Confidentiality Attached

C Wireline Log Received

C Drillers Timelog Received

Distribution

KCC SWD/Rep NGPA

KGS Plug Other (Specify)

ORIGINAL

CONFIDENTIAL

SIDE TWO

Operator Name Ainsworth Operating Co.

Lease Name Sleeper C (OWWO) Well # 1

East

County Stafford

Sec. 5 Twp. 22S Rge. 11

West

INSTRUCTIONS: Show important tops and base of formations penetrated. Detail all cores. Report all drill stem tests giving interval tested, time tool open and closed, flowing and shut-in pressures, whether shut-in pressure reached static level, hydrostatic pressures, bottom hole temperature, fluid recovery, and flow rates if gas to surface during test. Attach extra sheet if more space is needed. Attach copy of log.

Drill Stem Tests Taken Yes No
(Attach Additional Sheets.)

Samples Sent to Geological Survey Yes No

Cores Taken Yes No

Electric Log Run Yes No
(Submit Copy.)

Formation Description

Log Sample

Name Top Bottom
Coglomerated Sand 3479'
TD. 3605'

see old ACO-1 filed by H-30 Incorporated

CASING RECORD

New Used

Report all strings set-conductor, surface, intermediate, production, etc.

Purpose of String	Size Hole Drilled	Size Casing Set (In O.D.)	Weight Lbs./Ft.	Setting Depth	Type of Cement	# Sacks Used	Type and Percent Additives
Surface		8 5/8"		268'			
Production	7 7/8"	4 1/2"	10.5#	3664'	60/40 poz	150	10% salt, .5% Halad 322

PERFORATION RECORD

Shots Per Foot Specify Footage of Each Interval Perforated

Acid, Fracture, Shot, Cement Squeeze Record (Amount and Kind of Material Used) Depth

4	3526'-3531'	250 gal 15% MCA	3570-3531
4	3479'-3490'		

TUBING RECORD

Size Set At Packer At
2 3/8" 3520'

Liner Run Yes No

Date of First Production 2-1-91
Producing Method Flowing Pumping Gas Lift Other (Explain)

Estimated Production Per 24 Hours Oil 75 Bbls. Gas Mcf Water Bbls. Gas-Oil Ratio Gravity 47

Disposition of Gas: Vented Sold Used on Lease
(If vented, submit ACO-18.)

METHOD OF COMPLETION

Open Hole Perforation Dually Completed Commingled
 Other (Specify)

Production Interval

3526-3531
3479-3490

MAR 05 1992

FORM 1906 R-11

WELL NO. - FARM OR LEASE NAME C-1 Sleeper		COUNTY STAFFORD	FROM STATE KS	DATE 3-16-91
CHARGE TO Ainsworth Op. Co.		OWNER SAME	TICKET TYPE (CHECK ONE) SERVICE <input checked="" type="checkbox"/> SALES <input type="checkbox"/>	
ADDRESS Box 1269		CONTRACTOR ADE R Crombie	LOCATION 1 G+BOND	NITROGEN JOB YES <input type="checkbox"/> NO <input checked="" type="checkbox"/>
CITY, STATE, ZIP Colorado Springs Co 80901		SHIPPED VIA 2924	LOCATION 2	CODE 25520
WELL TYPE 01	WELL CATEGORY 01	WELL PERMIT NO.	DELIVERED TO Wellsite	LOCATION 3
TYPE AND PURPOSE OF JOB O35		ORDER NO. B-917699	REFERRAL LOCATION	

As consideration, the above-named Customer agrees to pay Halliburton in accord with the rates and terms stated in Halliburton's current price lists. Invoices payable NET by the 20th of the following month after date of invoice. Upon Customer's default in payment of Customer's account by the last day of the month following the month in which the invoice is dated, Customer agrees to pay interest thereon after default at the highest lawful contract rate applicable, but never to exceed 18% per annum. In the event it becomes necessary to employ an attorney to enforce collection of said account, Customer agrees to pay all collection costs and attorney fees in the amount of 20% of the amount of the unpaid account. These terms and conditions shall be governed by the law of the state whose services are performed or equipment or materials are furnished.

Halliburton warrants only title to the products, supplies and materials and that the same are free from defects in workmanship and materials. THERE ARE NO WARRANTIES, EXPRESS OR IMPLIED, OF MERCHANTABILITY, FITNESS FOR A PARTICULAR PURPOSE OR OTHERWISE WHICH EXTEND BEYOND THOSE STATED IN THE IMMEDIATELY PRECEDING SENTENCE. Halliburton's liability and customer's exclusive remedy in any cause of action (whether in contract, tort, product liability, breach of warranty or otherwise) arising out of the sale or use of any products, supplies or materials is expressly limited to the replacement of such products, supplies or materials on their return to Halliburton or, at Halliburton's option, to the allowance to the customer of credit for the cost of such items. In no event shall Halliburton be liable for special, incidental, indirect, punitive or consequential damages.

PRICE REFERENCE	SECONDARY REF OR PART NO.	L O C.	ACCOUNT	DESCRIPTION	UNITS 1		UNITS 2		UNIT PRICE	AMOUNT	
					QTY	MEAS	QTY	MEAS			
000-117		1		MILEAGE	24	mi			235	56	40
000-117		1		MILEAGE SURCHG.	24	mi			40	9	60
001-016		1		PUMP CHARGE	366	ft			145	1145	00
030-018		1		Plug SW	1	CA	4 1/2		45.00	45	00
018-317		1		Superflush K	10	SK			74.00	740	00
17A	825.201	1		Guideshoe	1	CA	4 1/2		83.00	83	00
24A	805.19101	1		Insert Float	1	CA	"		73.00	73	00
27	815.19111	1		Auto Fill up	1	CA			27.50	27	50
40	80793004	1		Centralized	6	CA	4 1/2		41.00	246	00
60	807.0007	1		Surf treatments	20	CA			22.00	440	00
66	80764021	1		Surf treatments	4	CA	4 1/2		9.60	9	60

NOT AN INVOICE

RECEIVED
STATE OF KANSAS
FEB 15 1991
HALLIBURTON DIVISION
Wichita, Kansas

AS PER ATTACHED BULK MATERIAL DELIVERY TICKET NO. **B-917699** 2002 40

WAS JOB SATISFACTORILY COMPLETED? _____

WAS OPERATION OF EQUIPMENT SATISFACTORY? _____

WAS PERFORMANCE OF PERSONNEL SATISFACTORY? _____

X Terry H. dy
CUSTOMER OR HIS AGENT (RELEASE PRINT)

X [Signature]
CUSTOMER OR HIS AGENT (SIGNATURE)

WE CERTIFY THAT THE FAIR LABOR STANDARDS ACT OF 1938, AS AMENDED HAS BEEN COMPLIED WITH IN THE PRODUCTION OF GOODS AND OR WITH RESPECT TO SERVICES FURNISHED UNDER THIS CONTRACT.

[Signature]
HALLIBURTON OPERATOR

HALLIBURTON APPROVAL _____

CUSTOMER _____

SUB TOTAL _____

APPLICABLE TAXES WILL BE ADDED ON INVOICE.



ORIGINAL WORK ORDER CONTRACT AND PRE-TREATMENT DATA

15-185-22544-0001

FORM 1908 R-7

A Division of Halliburton Company

ATTACH TO INVOICE & TICKET NO. 060824

DISTRICT 67 BEND FROM OWN FIELD DATE 1-16-91

YOU ARE HEREBY REQUESTED TO FURNISH EQUIPMENT AND SERVICEMEN TO DELIVER AND OPERATE THE SAME AS AN INDEPENDENT CONTRACTOR TO Ainsworth Ode (CUSTOMER)

AND DELIVER AND SELL PRODUCTS, SUPPLIES, AND MATERIALS FOR THE PURPOSE OF SERVICING CONFIDENTIAL

WELL NO. C-1 LEASE SLEEPER SEC. 5 TWP. 22 RANGE 11

FIELD Stafford COUNTY Ks OWNED BY SAME

THE FOLLOWING INFORMATION WAS FURNISHED BY THE CUSTOMER OR HIS AGENT

FORMATION NAME	TYPE	NEW USED	WEIGHT	SIZE	FROM	TO	MAX. ALLOW. P.S.I.
FORMATION THICKNESS	FROM TO						
PACKER TYPE	SET AT						
TOTAL DEPTH	MUD WEIGHT						
BORE HOLE							
INITIAL PROD. OIL BPD, H ₂ O BPD, GAS MCF							
PRESENT PROD. OIL BPD, H ₂ O BPD, GAS MCF							
CASING				4 1/2	KB	3661	
LINER							
TUBING							
OPEN HOLE STATE CORPORATION	COMMISS				3661	602	SHOTS/FT.
PERFORATIONS							
PERFORATIONS							
PERFORATIONS							

PREVIOUS TREATMENT: DATE TYPE MATERIALS

TREATMENT INSTRUCTIONS: TREAT THRU TUBING ANNULUS CASING TUBING/ANNULUS HYDRAULIC HORSEPOWER ORDERED

Set 3661' 4 1/2" PROD w/ 150 SKS 40/60 P02 107B SALT, 5# GILSONITE PER/SK 5/6 HA/AO-322

300# SALT FOR ZOBBI PREFLUSH & 10 bbl SUPREFLUSH

CUSTOMER OR HIS AGENT WARRANTS THE WELL IS IN PROPER CONDITION TO RECEIVE THE PRODUCTS, SUPPLIES, MATERIALS, AND SERVICES

- As consideration, the above-named Customer agrees: THIS CONTRACT MUST BE SIGNED BEFORE WORK IS COMMENCED
- To pay Halliburton in accord with the rates and terms stated in Halliburton's current price list. Invoices are payable NET by the 20th of the following month after date of invoice. Upon Customer's default in payment of Customer's account by the last day of the month following the month in which the invoice is dated, Customer agrees to pay interest thereon after default at the highest lawful contract rate applicable, but never to exceed 18% per annum. In the event it becomes necessary to employ attorneys to enforce collection of said account, Customer agrees to pay all collection costs and attorney fees in the amount of 20% of the amount of the unpaid account.
 - To defend, indemnify, release and hold harmless Halliburton, its divisions, subsidiaries, parent and affiliated companies and the officers, directors, employees, agents and servants of all of them from and against any claims, liability, expenses, attorneys fees, and costs of defense to the extent permitted by law for:
 - Damage to property owned by, in the possession of, or leased by Customer, and/or the well owner (if different from Customer), including, but not limited to, surface and subsurface damage. The term "well owner" shall include working and royalty interest owners.
 - Reservoir, formation, or well loss or damage, subsurface trespass or any action in the nature thereof.
 - Personal injury or death or property damage (including, but not limited to, damage to the reservoir, formation or well), or any damages whatsoever, growing out of or in any way connected with or resulting from pollution, subsurface pressure, losing control of the well and/or a well blowout or the use of radioactive material.

The defense, indemnity, release and hold harmless obligations of Customer provided for in this Section b) and Section c) below shall apply to claims of liability even if caused or contributed to by Halliburton's negligence, strict liability, or the unseaworthiness of any vessel owned, operated, or furnished by Halliburton or any defect in the data, products, supplies, materials, or equipment of Halliburton whether in the preparation, design, manufacture, distribution, or marketing thereof, or from a failure to warn any person of such defect. Such defense, indemnity, release and hold harmless obligations of Customer shall not apply where the claims or liability are caused by the gross negligence or willful misconduct of Halliburton. The term "Halliburton" as used in said Sections b) and c) shall mean Halliburton, its divisions, subsidiaries, parent and affiliated companies, and the officers, directors, employees, agents and servants of all of them.
 - That because of the uncertainty of variable well conditions and the necessity of relying on facts and supporting services furnished by others, Halliburton is unable to guarantee the effectiveness of the products, supplies or materials, nor the results of any treatment or service, nor the accuracy of any chart interpretation, research analysis, job recommendation or other data furnished by Halliburton. Halliburton personnel will use their best efforts in gathering such information and their best judgment in interpreting it; but Customer agrees that Halliburton shall not be liable for and Customer shall indemnify Halliburton against any damages arising from the use of such information.
 - That Halliburton warrants only title to the products, supplies and materials and that the same are free from defects in workmanship and materials. THERE ARE NO WARRANTIES, EXPRESS OR IMPLIED, OF MERCHANTABILITY, FITNESS OR OTHERWISE WHICH EXTEND BEYOND THOSE STATED IN THE IMMEDIATELY PRECEDING SENTENCE. Halliburton's liability and Customer's exclusive remedy in any cause of action (whether in contract, tort, breach of warranty or otherwise) arising out of the sale or use of any products, supplies or materials is expressly limited to the replacement of such products, supplies or materials on their return to Halliburton or, at Halliburton's option, to the allowance to the Customer of credit for the cost of such items. In no event shall Halliburton be liable for special, incidental, indirect, punitive or consequential damages.
 - That Customer shall, at its risk and expense, attempt to recover any Halliburton equipment, tools or instruments which are lost in the well and if such equipment, tools or instruments are not recovered, Customer shall pay Halliburton its replacement cost unless such loss is due to the sole negligence of Halliburton. If Halliburton equipment, tools or instruments are damaged in the well, Customer shall pay Halliburton the lesser of its replacement cost or the cost of repairs unless such damage is caused by the sole negligence of Halliburton. In the case of equipment, tools or instruments for marine operations, Customer shall, in addition to the foregoing, be fully responsible for loss of or damage to any of Halliburton's equipment, tools or instruments which occurs at any time after delivery to Customer at the landing until returned to the landing, unless such loss or damage is caused by the sole negligence of Halliburton.
 - To waive the provisions of the Deceptive Trade Practices - Consumer Protection Act, to the extent permitted by law.
 - That this contract shall be governed by the law of the state where services are performed or materials are furnished.
 - That Halliburton shall not be bound by any changes or modifications in this contract, except where such change or modification is made in writing by a duly authorized executive officer of Halliburton.

I HAVE READ AND UNDERSTAND THIS CONTRACT AND REPRESENT THAT I AM AUTHORIZED TO SIGN THE SAME AS CUSTOMER'S AGENT

SIGNED [Signature] CUSTOMER

DATE 1-16-91

TIME 9:00 A.M.

We certify that the Fair Labor Standards Act of 1938, as amended, has been complied with in the production of goods and/or with respect to services furnished under this contract.

CUSTOMER

WELL DATA

FIELD _____ SEC 5 TWP. 22 RING. 11 COUNTY SENECA STATE KS

FORMATION NAME	TYPE	NEW USED	WEIGHT	SIZE	FROM	TO	MAXIMUM PSI ALLOWABLE
FORMATION THICKNESS	FROM TO						
INITIAL PROD: OIL _____ BPD. WATER _____ BPD. GAS _____ MCFD							
PRESENT PROD: OIL _____ BPD. WATER _____ BPD. GAS _____ MCFD							
COMPLETION DATE _____ MUD TYPE _____ MUD WT. _____							
PACKER TYPE _____ SET AT _____							
BOTTOM HOLE TEMP. _____ PRESSURE _____							
MISC. DATA _____ TOTAL DEPTH _____							

TOOLS AND ACCESSORIES

TYPE AND SIZE	QTY.	MAKE
FLOAT COLLAR		
FLOAT SHOE		
GUIDE SHOE		
CENTRALIZERS <u>123567</u>	<u>6</u>	
BOTTOM PLUG <u>Langford Clamp</u>	<u>1</u>	
TOP PLUG		
HEAD		
OTHER: <u>20 sections centralizers 20</u>		
OTHER: <u>Insulet & Anchor 1140</u>	<u>1</u>	

MATERIALS

TREAT. FLUID _____ DENSITY _____ LB/GAL-API

DISPL. FLUID _____ DENSITY _____ LB/GAL-API

PROP. TYPE _____ SIZE _____ LB.

PROP. TYPE _____ SIZE _____ LB.

ACID TYPE _____ GAL _____ %

ACID TYPE _____ GAL _____ %

ACID TYPE _____ GAL _____ %

SURFACTANT TYPE _____ GAL _____ IN

NE AGENT TYPE _____ GAL _____ IN

FLUID LOSS ADD. TYPE _____ GAL-LB _____ IN

GELLING AGENT TYPE _____ GAL-LB _____ IN

FRIC. RED. AGENT TYPE _____ GAL-LB _____ IN

BREAKER TYPE _____ GAL-LB _____ IN

BLOCKING AGENT TYPE _____ GAL-LB _____

PERFPAC BALLS TYPE _____ QTY. _____

OTHER _____

OTHER _____

JOB DATA

CALLED OUT	ON LOCATION	JOB STARTED	JOB COMPLETED
DATE <u>1-16</u>	DATE <u>1-16</u>	DATE _____	DATE _____
TIME <u>11:00</u>	TIME <u>17:45</u>	TIME _____	TIME _____

PERSONNEL AND SERVICE UNITS

NAME	UNIT NO. & TYPE	LOCATION
<u>74221 McDuff</u>	<u>2924</u>	
<u>19501 Gussner</u>	<u>4100</u>	<u>25520</u>
<u>02924 RAMBOY</u>	<u>4100</u>	
	<u>Bulk</u>	

DEPARTMENT Cmt

DESCRIPTION OF JOB Set 3661' 4 1/2" Field

JOB DONE THRU: TUBING CASING ANNULUS TBG/ANN.

CUSTOMER REPRESENTATIVE X [Signature]

HALLIBURTON OPERATOR [Signature] COPIES REQUESTED _____

CEMENT DATA

STAGE	NUMBER OF SACKS	CEMENT	BRAND	BULK SACKED	ADDITIVES	YIELD CU.FT./SK.	MIXED LBS/GAL
	<u>150</u>	<u>POL</u>	<u>40/60</u>	<u>B</u>	<u>20-10</u>	<u>140</u>	<u>13.8</u>
	<u>25</u>	<u>POL</u>	<u>40/60</u>	<u>B</u>	<u>20-10</u>	<u>126</u>	<u>14.15</u>

PRESSURES IN PSI

CIRCULATING _____ DISPLACEMENT _____ PRES. LOSS: 20-10 GAL TYPE SALT-SURF

BREAKDOWN _____ MAXIMUM _____ LOAD & BKDN: BBL-GAL _____ PAD: BBL-GAL _____

AVERAGE _____ FRACTURE GRADIENT _____ TREATMENT: BBL-GAL _____ DISPL: BBL-GAL 57.71

SHUT-IN: INSTANT _____ 5-MIN. _____ 15-MIN. _____ CEMENT SLURRY: BBL-GAL _____

ORDERED _____ AVAILABLE _____ USED _____ TOTAL VOLUME: BBL-GAL _____

AVERAGE RATES IN BPM _____ REMARKS _____

TREATING _____ DISPL. _____ OVERALL _____ CEMENT LEFT IN PIPE _____

FEET 29.90 REASON Insulet

FEB 15 1991

CUSTOMER: Conservation Div
 LEASE: Stange
 WELL NO: C-1
 JOB TYPE: 4 1/2" Field
 DATE: 1-16-91

HALLIBURTON SERVICES
JOB LOG

WELL NO. 15.185-22544-0001 LEASE 1002 TICKET NO. 0160824
 CUSTOMER Missouri State Co PAGE NO. 1
 JOB TYPE 4 1/2 Prod DATE 1-16-91

FORM 2013 R-2

CHART NO.	TIME	RATE (BPM)	VOLUME (BBL) (GAL)	PUMPS		PRESSURE		DESCRIPTION OF OPERATION AND MATERIALS
				T	C	TUBING	CASING	
								RELEASED MAR 05 1992 FROM CONFIDENTIAL
								CONFIDENTIAL Centralizers 1,2,3,5,6,7
	2315							Break Circ
	2357	7	-				500	START 20601 Salt Flush
	2400	7	20				650	START 10601 Super Flush
	0023	6 1/2	30				750	START 3740601 SL
	0030	6 1/2	67.40				300	Flush MIXING
	0032							Clear Lines
	0032							Release Plugs
	0033	8	-				400	START 5779601 DISO
	0043	4	125.19				1100	Plug Down
	0043							Release
	0040							Plug Pathole
	0045							Plug Mousehole
								Job Complete
								THANK YOU
								TRAVIS SHAW DENNIS

RECEIVED
STATE COMPTROLLER'S COMMISSION

FEB 15 1991

REGISTRATION DIVISION
Wichita Kansas



BULK MATERIALS DELIVERY AND TICKET CONTINUATION

RELEASED ORIGINAL
MAR 05 1991 INVOICE AND TICKET NO. 060824

15-185-22544-0001

DATE 1-16-91	CUSTOMER ORDER NO.	WELL NO. AND FARM Sleeper C-1	COUNTY Stafford	STATE Ks.
CHARGE TO Ainsworth Operation Company		OWNER Same	CONTRACTOR Abercrombie Drlg.	No. B 917699
MAILING ADDRESS		DELIVERED FROM Gt. Bend, Ks.	LOCATION CODE 25520	PREPARED BY J.M. Sheets
CITY & STATE		DELIVERED TO Location	TRUCK NO. 4604-8206	RECEIVED BY <i>J.M. Sheets</i>

PRICE REFERENCE	SECONDARY REF. OR PART NO.	CODE		DESCRIPTION	UNITS 1		UNITS 2		UNIT PRICE	AMOUNT	
		L	D		QTY.	MEAS.	QTY.	MEAS.			
				175 40% Pozmix 60% Cement 2% Gel							
504-308	516.00261	1	b	Standard Cement	105	sk			5.35	561.75	
506-105	516.00286	1	b	Pozmix A	70	sk			2.79	195.30	
506-121	516.00259	1	b	3 ^H alliburton Gel 2% allowed						NC	
509-968	516.00315	1	b	Salt Blended 10% W/150	750	lb.			.10	75.00	
509-968	516.00158	1	b	Salt not mixed	300	lb.			.10	30.00	
508-292	70.15573	1	b	Gilsonite Blended 5# W/150	750	lb.			.47	352.50	
507-775	516.00144	1	b	Halad 322 Blended .5% W/150	65	lb.			5.95	386.75	
500-307		1	b	surecharge	206.59				.10	20.66	
				Returned Mileage Charge							
				TOTAL WEIGHT		LOADED MILES		TON MILES			
				SERVICE CHARGE ON MATERIALS RETURNED				CU. FEET			
500-207		1	B	SERVICE CHARGE				CU. FEET 205	1.10	225.50	
500-307		1	B	Mileage Charge	17,216	24	206.59	TON MILES	.75	154.94	
No. B 917699							CARRY FORWARD TO INVOICE		SUB-TOTAL		2002.40

THIS IS NOT AN INVOICE

RECEIVED
STATE COMMISSION
FEB 15 1991
CONSERVATION DIVISION
Wichita, Kansas