

FOR KCC USE:

FORM C-1 7/91

FORM MUST BE TYPED

EFFECTIVE DATE: 3-31-97

State of Kansas

FORM MUST BE SIGNED

DISTRICT # 2

NOTICE OF INTENTION TO DRILL

ALL BLANKS MUST BE FILLED

SCA7. Yes... No

Must be approved by the K.C.C. five (5) days prior to commencing well.

Expected Spud Date March 10, 1997
month day year

Spot SE SW Sec 35 Twp 30S S, Rg 9W East West

OPERATOR: License # 31088
Name: COLT RESOURCES CORPORATION
Address: 16701 Greenspoint, Park Drive, Suite 225
City/State/Zip: Houston, Texas 77060
Contact Person: Ed Childers
Phone: 713/876-1209

660 feet from South / ~~XXXX~~ line of Section
1980 feet from ~~XXXX~~ / West line of Section
IS SECTION REGULAR IRREGULAR?

(NOTE: Locate well on the Section Plat on Reverse Side)

CONTRACTOR: License #: 5929
Name: DUKE DRILLING CO., INC.

County: Kingman

Lease Name: MORRIS WOLF KEIMIG Well #: 4-35

Field Name: Spivey-Grabs

Is this a Prorated/Spaced Field? yes no

Target Formation(s): Miss.

Nearest lease or unit boundary: 660'

Ground Surface Elevation: 1686' feet MSL

Water well within one-quarter mile: yes no

Public water supply well within one mile: yes no

Depth to bottom of fresh water: 120'

Depth to bottom of usable water: 180'

Surface Pipe by Alternate: 1 2

Length of Surface Pipe Planned to be set: 200'

Length of Conductor pipe required: N/A

Projected Total Depth: 4500'

Formation at Total Depth: Mississippi

Water Source for Drilling Operations:

well farm pond other

Well Drilled For: Well Class: Type Equipment:
 Oil ... Enh Rec Infield Mud Rotary
... Gas ... Storage ... Pool Ext. ... Air Rotary
... OWWO ... Disposal ... Wildcat ... Cable
... Seismic; ... # of Holes ... Other
... Other

If OWWO: old well information as follows:
Operator:
Well Name:
Comp. Date: Old Total Depth

Directional, Deviated or Horizontal wellbore? yes no
If yes, true vertical depth:
Bottom Hole Location:

Will Cores Be Taken?: yes no
If yes, proposed zone:

AFFIDAVIT

RECEIVED

KANSAS CORPORATION COMMISSION

The undersigned hereby affirms that the drilling, completion and eventual plugging of this well will comply with K.S.A. 55-101, et. seq.

It is agreed that the following minimum requirements will be met:

MAR 06 1997
3-6-97

1. Notify the appropriate district office prior to spudding of well;
2. A copy of the approved notice of intent to drill shall be posted on each drilling rig;
3. The minimum amount of surface pipe as specified below shall be set by circulating cement to the surface pipe shall be set through all unconsolidated materials plus a minimum of 20 feet into the underlying formation;
4. If the well is dry hole, an agreement between the operator and the district office on plug length and placement is necessary prior to plugging;
5. The appropriate district office will be notified before well is either plugged or production casing is cemented in;
6. IF AN ALTERNATE II COMPLETION, PRODUCTION PIPE SHALL BE CEMENTED FROM BELOW ANY USABLE WATER TO SURFACE WITHIN 120 DAYS OF SPUD DATE. IN ALL CASES, NOTIFY DISTRICT OFFICE PRIOR TO ANY CEMENTING.

I hereby certify that the statements made herein are true and to the best of my knowledge and belief.

Date: 2/27/97 Signature of Operator or Agent: Sally R. Rogers Title: _____ Agent

FOR KCC USE: 095-217200000
 API # 15-
 Conductor pipe required NONE feet
 Minimum surface pipe required 200 feet per Alt. X
 Approved by: JK 3-26-97
 This authorization expires: 9-26-97
 (This authorization void if drilling not started within 6 months of effective date.)
 Spud date: _____ Agent: _____

REMEMBER TO:

- File Drill Pit Application (form CDP-1) with Intent to Drill;
- File Completion Form ACO-1 within 120 days of spud date;
- File acreage attribution plat according to field proration orders;
- Notify appropriate district office 48 hours prior to workover or re-entry;
- Submit plugging report (CP-4) after plugging is completed;
- Obtain written approval before disposing or injecting salt water.

Mail to: KCC - Conservation Division, 130 S. Market - Room 2078, Wichita, Kansas 67202.

35
30
9W

IN ALL CASES PLOT THE INTENDED WELL ON THE PLAT BELOW

PLAT OF ACREAGE ATTRIBUTABLE TO A WELL IN A PRORATED OR SPACED FIELD

If the intended well is in a prorated or spaced field, please fully complete this side of the form. If the intended well is in a prorated or spaced field complete the plat below showing that the well will be properly located in relationship to other wells producing from the common source of supply. Please show all the wells within 1 mile of the boundaries of the proposed acreage attribution unit for gas wells and within 1/2 mile of the boundaries of the proposed acreage attribution unit for oil wells.

API NO. 15- _____
 OPERATOR COLT RESOURCES CORPORATION
 LEASE MORRIS-WOLF-KEIMIG
 WELL NUMBER 4
 FIELD Spivey-Grabs

LOCATION OF WELL: COUNTY Kingman
660 feet from south/~~west~~ line of section
1980 feet from ~~east~~/west line of section
 SECTION 35 TWP 30S RG 9W

NUMBER OF ACRES ATTRIBUTABLE TO WELL 40
 QTR/QTR/QTR OF ACREAGE _____ - SE - SW

IS SECTION X REGULAR or _____ IRREGULAR
 IF SECTION IS IRREGULAR, LOCATE WELL FROM NEAREST CORNER BOUNDARY.

Section corner used: _____ NE _____ NW _____ SE X _____ SW

PLAT

(Show location of the well and shade attributable acreage for prorated or spaced wells.)
 (Show footage to the nearest lease or unit boundary line.)

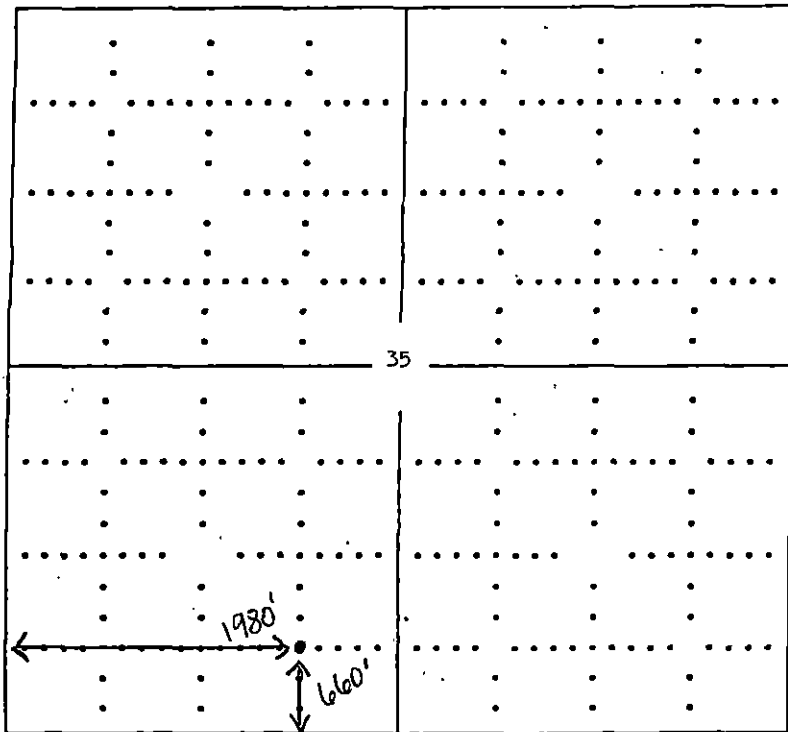

KINGMAN COUNTY

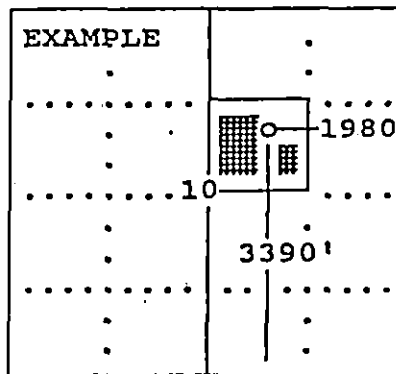

SEWARD CO.

In plotting the proposed location of the well, you must show:

- 1) The manner in which you are using the depicted plat by identifying section lines, i.e. 1 section, 1 section with 8 surrounding sections, 4 sections, etc.;
- 2) the distance of the proposed drilling location from the section's south/north and east/west; and
- 3) the distance to the nearest lease or unit boundary line.