

COR

FOR KCC USE:

CORRECTION

FORM C-1 7/91

EFFECTIVE DATE: 2-18-97
DISTRICT # 2
SGA7 Yes...No

State of Kansas
NOTICE OF INTENTION TO DRILL

FORM MUST BE TYPED
FORM MUST BE SIGNED
ALL BLANKS MUST BE FILLED

Must be approved by the K.C.C. five (5) days prior to commencing well.

Expected Spud Date March 21, 1997
month day year

Spot 50'S of
C-W/2- NW- SE- Sec 35 Twp 30S, Rg 9W East West

OPERATOR: License # 31088
Name: COLT RESOURCES CORPORATION
Address: 16701 Greenspoint Park Drive, Suite 225
City/State/Zip: Houston, Texas 77060
Contact Person: Ed Childers
Phone: 713/876-1209

1930 feet from South / ~~KCC~~ line of Section
2310 feet from East / ~~KCC~~ line of Section
IS SECTION REGULAR IRREGULAR?

CONTRACTOR: License #: 5929
Name: DUKE DRILLING CO., INC.

(NOTE: Locate well on the Section Plat on Reverse Side)
County: Kingman
Lease Name: MORRIS & WOLF KEIMIG Well #: 5-35
Field Name: Spivey-Grabs

Well Drilled For: Well Class: Type Equipment:

Oil ... Enh Rec Infield Mud Rotary
... Gas ... Storage ... Pool Ext. ... Air Rotary
... OWMO ... Disposal ... Wildcat ... Cable
... Seismic; ... # of Holes ... Other

Is this a Prorated/Spaced Field? yes ... no
Target Formation(s): Miss.
Nearest lease or unit boundary: 330'
Ground Surface Elevations: 1695' feet MSL
Water well within one-quarter mile: yes no
Public water supply well within one mile: yes no
Depth to bottom of fresh water: 140'
Depth to bottom of usable water: 180'
Surface Pipe by Alternate: 1 ... 2
Length of Surface Pipe Planned to be set: 200'
Length of Conductor pipe required: N/A
Projected Total Depth: 4500'
Formation at Total Depth: Mississippi
Water Source for Drilling Operations:
... well ... farm pond other

Directional, Deviated or Horizontal wellbore? ... yes no
If yes, true vertical depth:
Bottom Hole Location:

Will Cores Be Taken?: ... yes no
If yes, proposed zone:

* WAS: MORRIS - WOLF - KEIMIG 5

* IS: MORRIS & WOLF KEIMIG - 5-35

The undersigned hereby affirms that the drilling, completion and eventual plugging of this well will comply with K.S.A. 55-101, et. seq.

It is agreed that the following minimum requirements will be met:

1. Notify the appropriate district office prior to spudding of well;
2. A copy of the approved notice of intent to drill shall be posted on each drilling rig;
3. The minimum amount of surface pipe as specified below shall be set by circulating cement to the top; in all cases surface pipe shall be set through all unconsolidated materials plus a minimum of 20 feet into the underlying formation;
4. If the well is dry hole, an agreement between the operator and the district office on plug length and placement is necessary prior to plugging;
5. The appropriate district office will be notified before well is either plugged or production casing is cemented in;
6. IF AN ALTERNATE II COMPLETION, PRODUCTION PIPE SHALL BE CEMENTED FROM BELOW ANY USABLE WATER TO SURFACE WITHIN 120 DAYS OF SPUD DATE. IN ALL CASES, NOTIFY DISTRICT OFFICE PRIOR TO ANY CEMENTING.

I hereby certify that the statements made herein are true and to the best of my knowledge and belief.

Date: March 18, 1997 Signature of Operator or Agent: [Signature] Title: Agent

WAS: Morris-Wolf-Keimig #5

FOR KCC USE:
 API # 15- 095-21,718-0000
 Conductor pipe required NONE feet
 Minimum surface pipe required 200 feet per Alt.
 Approved by: DWS 3-19-97 / ORIG JK 3-13-97
 This authorization expires: 9-13-97
 (This authorization void if drilling not started within 6 months of effective date.)
 Spud date: _____ Agent: _____

35
30
92
3-19-97
RECEIVED
KANSAS CORP COMM
1997 MAR 19 A 11: 18

REMEMBER TO:

- File Drill Pit Application (form CDP-1) with Intent to Drill;
- File Completion Form ACO-1 within 120 days of spud date;
- File acreage attribution plat according to field proration orders;
- Notify appropriate district office 48 hours prior to workover or re-entry;
- Submit plugging report (CP-4) after plugging is completed;
- Obtain written approval before disposing or injecting salt water.

Mail to: KCC - Conservation Division, 130 S. Market - Room 2078, Wichita, Kansas 67202.

IN ALL CASES PLOT THE INTENDED WELL ON THE PLAT BELOW

PLAT OF ACREAGE ATTRIBUTABLE TO A WELL IN A PRORATED OR SPACED FIELD

If the intended well is in a prorated or spaced field, please fully complete this side of the form. If the intended well is in a prorated or spaced field complete the plat below showing that the well will be properly located in relationship to other wells producing from the common source of supply. Please show all the wells within 1 mile of the boundaries of the proposed acreage attribution unit for gas wells and within 1/2 mile of the boundaries of the proposed acreage attribution unit for oil wells.

API NO. 15- 095-21,718
 OPERATOR COLT RESOURCES CORPORATION
 LEASE MORRIS & WOLF KEIMIG
 WELL NUMBER 5-35
 FIELD Spivey-Grabs

LOCATION OF WELL: COUNTY Kingman
1930 feet from south/~~north~~ line of section
2310 feet from east/~~west~~ line of section
 SECTION 35 TWP 30S RG 9W

NUMBER OF ACRES ATTRIBUTABLE TO WELL 40
 QTR/QTR/QTR OF ACREAGE - NW - SE

IS SECTION X REGULAR or IRREGULAR
 IF SECTION IS IRREGULAR, LOCATE WELL FROM NEAREST
CORNER BOUNDARY.

Section corner used: NE NW SE SW

PLAT

(Show location of the well and shade attributable acreage for prorated or spaced wells.)
 (Show footage to the nearest lease or unit boundary line.)

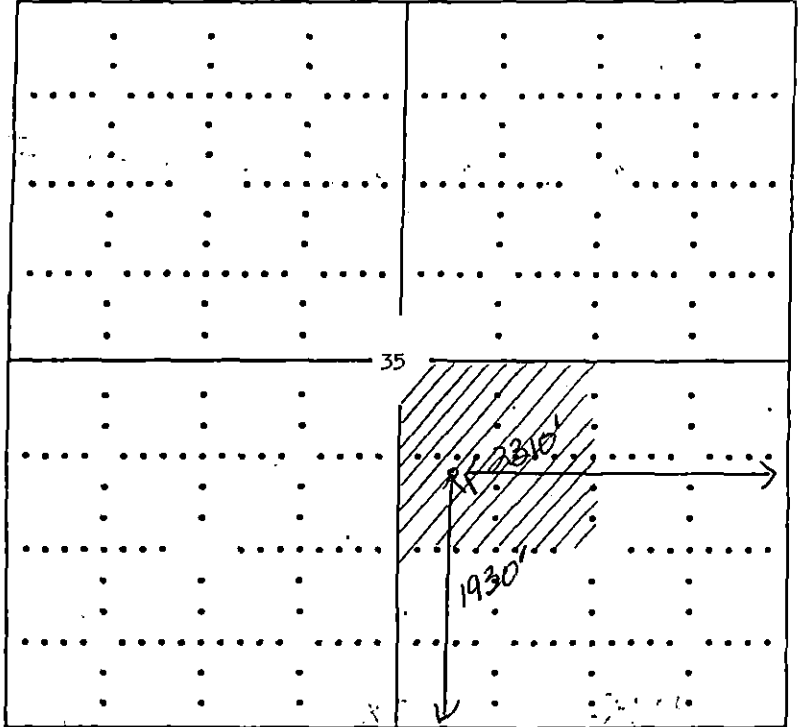

KINGMAN COUNTY

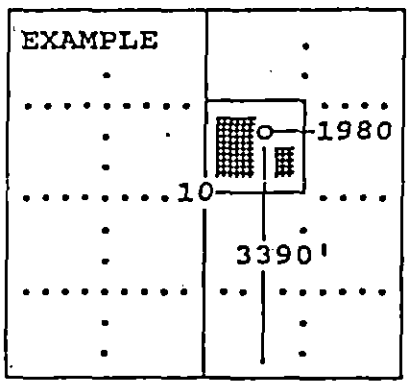

SEWARD CO.

In plotting the proposed location of the well, you must show:

- 1) The manner in which you are using the depicted plat by identifying section lines, i.e. 1 section, 1 section with 8 surrounding sections, 4 sections, etc.;
- 2) the distance of the proposed drilling location from the section's south/north and east/west; and
- 3) the distance to the nearest lease or unit boundary line.