

FOR KCC USE:

FORM C-1 7/91

FORM MUST BE TYPED

FORM MUST BE SIGNED

ALL BLANKS MUST BE FILLED

EFFECTIVE DATE: 7-19-94

State of Kansas

DISTRICT # 2

NOTICE OF INTENTION TO DRILL

SGAT: X Yes, No

Must be approved by the K.C.C. five (5) days prior to commencing well

Spot C SW SW Sec 35 Twp 30S S Rg 09 X West

Expected Spud Date July 15 1994 month day year

660' FSL feet from South North line of Section
660' EWL feet from East West line of Section
IS SECTION X REGULAR IRREGULAR?

OPERATOR: License # 30793
Name: Energy Marketing, Inc.
Address: c/o Suite 1100 Bank IV Bldg 15W 6th St
City/State/Zip: Tulsa OK 74119-5461
Contact Person: Mark Reichardt
Phone: (918) 583-1600

(NOTE: Locate well on the Section Plat on Reverse Side)

County: Kingman
Lease Name: Morris Wolf Keimig Well #: 3-35
Field Name: Spivey Grab

CONTRACTOR: License #: 5929
Name: Duke Drilling

Is this a Prorated/Spaced Field? X yes no

Target Formation(s): Mississippi Chat

Nearest lease or unit boundary: 660'

Ground Surface Elevation: 1712' feet MSL

Water well within one-quarter mile: yes X no

Public water supply well within one mile: yes X no

Depth to bottom of fresh water: 110'

Depth to bottom of usable water: 200-220'

Surface Pipe by Alternate: X 1 2

Length of Surface Pipe Planned to be set: (250) 240'

Length of Conductor pipe required: N/A

Projected Total Depth: 4500'

Formation at Total Depth: Mississippi Chat

Water Source for Drilling Operations:

well X farm pond other

DUR Permit #:

Will Cores Be Taken?: yes X no

If yes, proposed zone:

Well Drilled For: Well Class: Type Equipment:

as per M. R.

Oil ... Enh Rec ... Infield ... Mud Rotary
Gas ... Storage ... Pool Ext. ... Air Rotary
OWWO ... Disposal ... Wildcat ... Cable
Seismic: # of Holes Other

If OWWO: old well information as follows:

Operator:
Well Name:
Comp. Date: Old Total Depth

Directional, Deviated or Horizontal wellbore? yes XX no

If yes, true vertical depth:

Bottom Hole Location:

AFFIDAVIT

The undersigned hereby affirms that the drilling, completion and eventual plugging of this well will comply with K.S.A. 55-101, et. seq.

It is agreed that the following minimum requirements will be met:

- 1. Notify the appropriate district office prior to spudding of well;
2. A copy of the approved notice of intent to drill shall be posted on each drilling rig;
3. The minimum amount of surface pipe as specified below shall be set by circulating cement to the top; in all cases surface pipe shall be set through all unconsolidated materials plus a minimum of 20 feet into the underlying formation;
4. If the well is dry hole, an agreement between the operator and the district office on plug length and placement is necessary prior to plugging;
5. The appropriate district office will be notified before well is either plugged or production casing is cemented in;
6. IF AN ALTERNATE II COMPLETION, PRODUCTION PIPE SHALL BE CEMENTED FROM BELOW ANY USABLE WATER TO SURFACE WITHIN 120 DAYS OF SPUD DATE. IN ALL CASES, NOTIFY DISTRICT OFFICE PRIOR TO ANY CEMENTING.

I hereby certify that the statements made herein are true and to the best of my knowledge and belief.

Date: 6/30/94 Signature of Operator or Agent: Mark Reichardt Title: Sr. operations eng

FOR KCC USE: 095-21695-0000
API # 15-
Conductor pipe required NONE feet
Minimum surface pipe required 240' feet per Alt.
Approved by: CB 7-14-94
This authorization expires: 1-14-95
(This authorization void if drilling not started within 6 months of effective date.)
Spud date: Agent:

Sr. Operations Engineer

Rec'd 7-6-94

REMEMBER TO:

- File Drill Pit Application (form CDP-1) with Intent to Drill;
- File Completion Form ACO-1 within 120 days of spud date;
- File acreage attribution plat according to field proration orders;
- Notify appropriate district office 48 hours prior to workover or re-entry;
- Submit plugging report (CP-4) after plugging is completed;
- Obtain written approval before disposing or injecting salt water.

Mail to: Conservation Division, 200 Colorado Derby Building, 202 W. First St., Wichita, Kansas 67202-1286.

35
30S
09W

IN ALL CASES PLOT THE INTENDED WELL ON THE PLAT BELOW

PLAT OF ACREAGE ATTRIBUTABLE TO A WELL IN A PRORATED OR SPACED FIELD

If the intended well is in a prorated or spaced field, please fully complete this side of the form. If the intended well is in a prorated or spaced field complete the plat below showing that the well will be properly located in relationship to other wells producing from the common source of supply. Please show all the wells within 1 mile of the boundaries of the proposed acreage attribution unit for gas wells and within 1/2 mile of the boundaries of the proposed acreage attribution unit for oil wells.

API NO. 15- \_\_\_\_\_  
 OPERATOR COLT RESOURCES CORPORATION  
 LEASE MORRIS & WOLF-KEIMIG  
 WELL NUMBER #3-35  
 FIELD SPIVEY-GRABS

LOCATION OF WELL: COUNTY KINGMAN  
660 feet from south/north line of section  
660 feet from east/west line of section  
 SECTION 35 TWP 30S RG 9W

NUMBER OF ACRES ATTRIBUTABLE TO WELL 80  
 QTR/QTR/QTR OF ACREAGE \_\_\_\_\_ - S/2 - SW/4

IS SECTION X REGULAR or IRREGULAR  
IF SECTION IS IRREGULAR, LOCATE WELL FROM NEAREST CORNER BOUNDARY.

Section corner used: NE NW SE SW

PLAT

(Show location of the well and shade attributable acreage for prorated or spaced wells.)  
 (Show footage to the nearest lease or unit boundary line.)

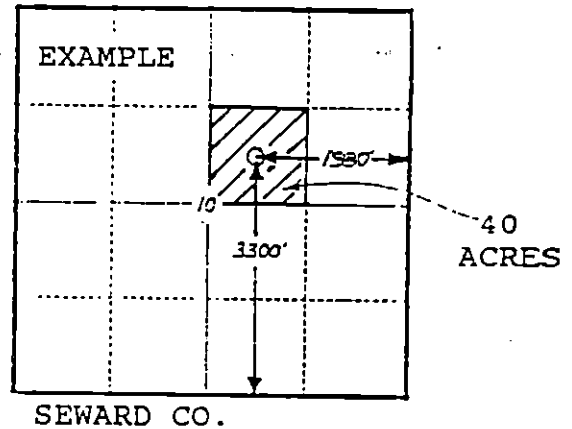
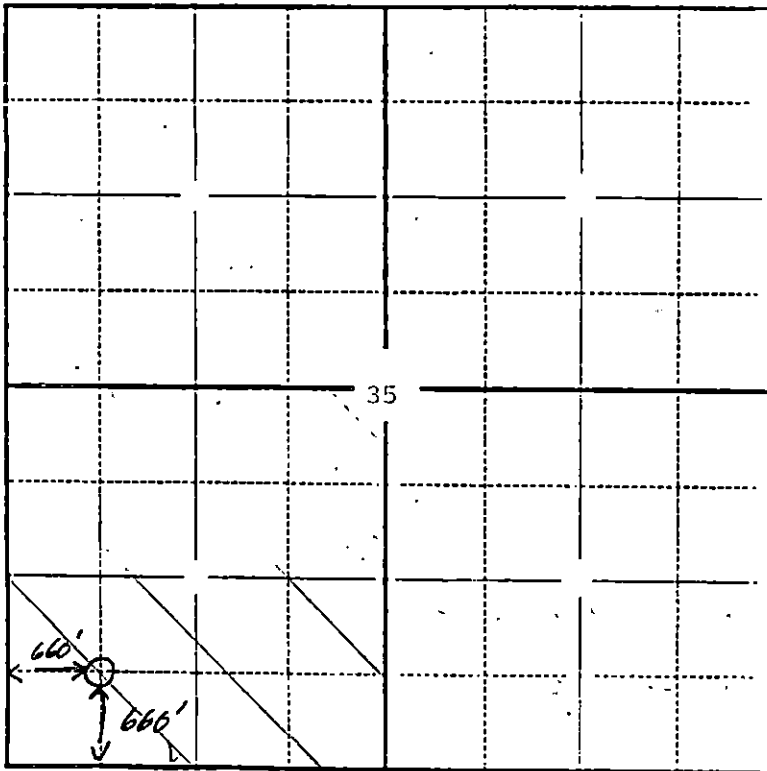

**RECEIVED**  
 KANSAS CORPORATION COMMISSION  
 JUL 06 1994 pm  
 CONSERVATION DIVISION  
 WICHITA, KS

In plotting the proposed location of the well, you must show:

- 1) The manner in which you are using the depicted plat by identifying section lines, i.e. 1 section, 1 section with 8 surrounding sections, 4 sections, etc.;
- 2) the distance of the proposed drilling location from the section's south/north and east/west lines; and
- 3) the distance to the nearest lease or unit boundary line.