

FOR KCC USE:

FORM C-1 7/91

FORM MUST BE TYPED

EFFECTIVE DATE: 7-25-93

State of Kansas

FORM MUST BE SIGNED

DISTRICT # 2

NOTICE OF INTENTION TO DRILL

ALL BLANKS MUST BE FILLED

SGA? Yes... No

Must be approved by the K.C.C. five (5) days prior to commencing well

Spot S2 SE NE Sec 36 Twp 30 S, Rg 9 East West

Expected Spud Date 7 30 93 month day year

2310 feet from South / North line of Section 535 feet from East West line of Section

OPERATOR: License # 30793 Name: Energy Marketing, Inc. Address: c/o Colt Resources, 601 S. Boulder, Ste 600 City/State/Zip: Tulsa, OK, 74119 Contact Person: Mark Reichardt Phone: (918) 583-1600

IS SECTION X REGULAR IRREGULAR? County: Kingman

CONTRACTOR: License #: 5822 Name: Val Energy

(NOTE: Locate well on the Section Plat on Reverse Side)

Lease Name: SWINGLE Well #: 2-36

Field Name: Spivey-Grabs-Basil

Is this a Prorated/Spaced Field? X yes no

Target Formation(s): Mississippi

Nearest lease or unit boundary: 330 FSL

Ground Surface Elevation: 1683 feet MSL

Water well within one-quarter mile: X yes no

Public water supply well within one mile: yes X no

Depth to bottom of fresh water: 100'

Depth to bottom of usable water: 200'

Surface Pipe by Alternate: X 1 2

Length of Surface Pipe Planned to be set: (325) 220'

Length of Conductor pipe required: N/A

Projected Total Depth: 4500'

Formation at Total Depth: Mississippi

Water Source for Drilling Operations: X well farm pond other

DWR Permit #:

Will Cores Be Taken?: yes X no

If yes, proposed zone:

Well Drilled For: Well Class: Type Equipment:

X Oil Enh Rec X Infield X Mud Rotary

Gas Storage Pool Ext. Air Rotary

OWWO Disposal Wildcat Cable

Seismic; # of Holes Other

Other

If OWWO: old well information as follows:

Operator:

Well Name:

Comp. Date: Old Total Depth

Directional, Deviated or Horizontal wellbore? yes X no

If yes, true vertical depth:

Bottom Hole Location:

AFFIDAVIT

The undersigned hereby affirms that the drilling, completion and eventual plugging of this well will comply with K.S.A. 55-101, et. seq.

It is agreed that the following minimum requirements will be met:

- 1. Notify the appropriate district office prior to spudding of well;
2. A copy of the approved notice of intent to drill shall be posted on each drilling rig;
3. The minimum amount of surface pipe as specified below shall be set by circulating cement to the top; in all cases surface pipe shall be set through all unconsolidated materials plus a minimum of 20 feet into the underlying formation;
4. If the well is dry hole, an agreement between the operator and the district office on plug length and placement is necessary prior to plugging;
5. The appropriate district office will be notified before well is either plugged or production casing is cemented in;
6. IF AN ALTERNATE IS COMPLETION, PRODUCTION PIPE SHALL BE CEMENTED FROM BELOW ANY USABLE WATER TO SURFACE WITHIN 120 DAYS OF SPUD DATE. IN ALL CASES, NOTIFY DISTRICT OFFICE PRIOR TO ANY CEMENTING.

I hereby certify that the statements made herein are true and to the best of my knowledge and belief.

Date: 7/15/93 Signature of Operator or Agent: Title: Vice President Engineering

FOR KCC USE: API # 15- 095-21679-0000 Conductor pipe required None feet Minimum surface pipe required 220 feet per Alt. Approved by: C.B. 7-20-93 This authorization expires: 1-20-94 (This authorization void if drilling not started within 6 months of effective date.) Spud date: Agent:

RECEIVED CORPORATION COMMISSION 7-16-93 JUL 16 1993 CONSERVATION DIVISION WICHITA, KS

REMEMBER TO:

- File Drill Pit Application (form CDP-1) with Intent to Drill;
- File Completion Form ACO-1 within 120 days of spud date;
- File acreage attribution plat according to field proration orders;
- Notify appropriate district office 48 hours prior to workover or re-entry;
- Submit plugging report (CP-4) after plugging is completed;
- Obtain written approval before disposing or injecting salt water.

Mail to: Conservation Division, 200 Colorado Derby Building, 202 W. First St., Wichita, Kansas 67202-1286.

IN ALL CASES PLOT THE INTENDED WELL ON THE PLAT BELOW

PLAT OF ACREAGE ATTRIBUTABLE TO A WELL IN A PRORATED OR SPACED FIELD

If the intended well is in a prorated or spaced field, please fully complete this side of the form. If the intended well is in a prorated or spaced field complete the plat below showing that the well will be properly located in relationship to other wells producing from the common source of supply. Please show all the wells within 1 mile of the boundaries of the proposed acreage attribution unit for gas wells and within 1/2 mile of the boundaries of the proposed acreage attribution unit for oil wells.

API NO. 15- _____
 OPERATOR Energy Marketing, Inc.
 LEASE SWINGLE
 WELL NUMBER 2-36
 FIELD Spivey-Grabs

LOCATION OF WELL: COUNTY Kingman
2310 feet from south/north line of section
535 feet from east/west line of section
 SECTION 36 TWP 30S RG 9W

NUMBER OF ACRES ATTRIBUTABLE TO WELL 40
 QTR/QTR/QTR OF ACREAGE S2 - SE - NE

IS SECTION X REGULAR or IRREGULAR
IF SECTION IS IRREGULAR, LOCATE WELL FROM NEAREST CORNER BOUNDARY.

Section corner used: NE NW SE SW

PLAT

(Show location of the well and shade attributable acreage for prorated or spaced wells.)
 (Show footage to the nearest lease or unit boundary line.)

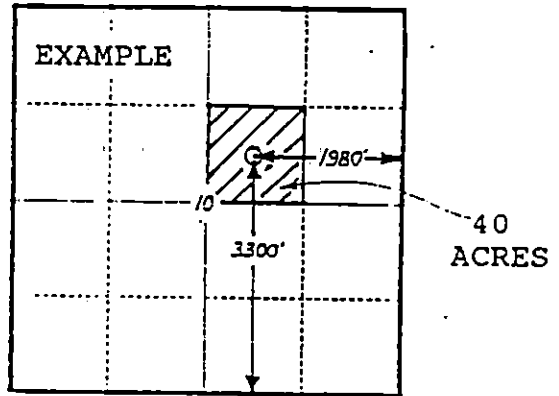
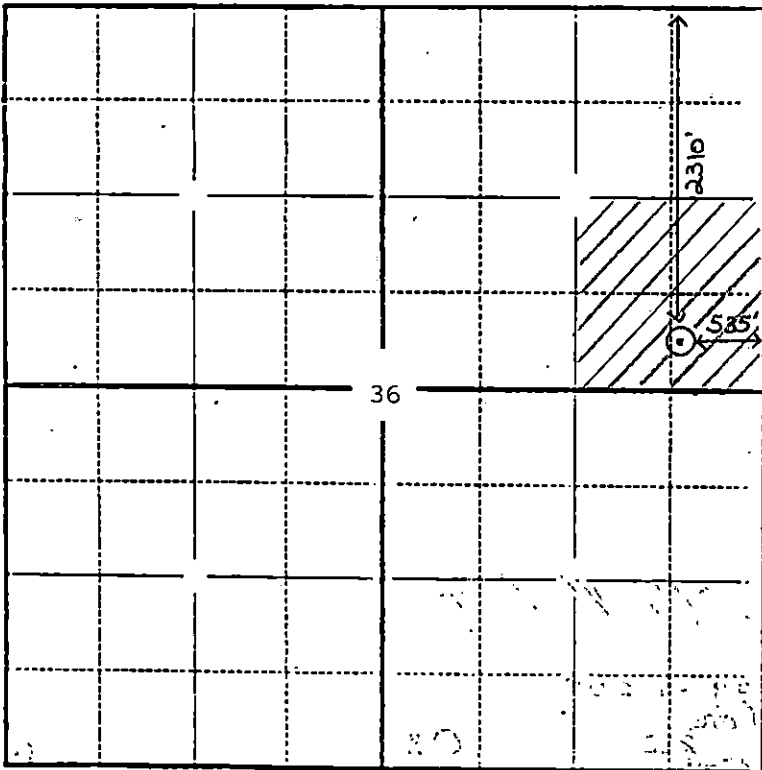

SEWARD CO.

In plotting the proposed location of the well, you must show:

- 1) The manner in which you are using the depicted plat by identifying section lines, i.e. 1 section, 1 section with 8 surrounding sections, 4 sections, etc.;
- 2) the distance of the proposed drilling location from the section's south/north and east/west lines; and
- 3) the distance to the nearest lease or unit boundary line.