

STATE CORPORATION COMMISSION OF KANSAS  
OIL & GAS CONSERVATION DIVISION

WELL COMPLETION OR RECOMPLETION FORM  
ACO-1 WELL HISTORY

DESCRIPTION OF WELL AND LEASE

Operator: license # 6718  
name Fell Oil and Gas Co.  
address P.O. Box 9487  
City/State/Zip Tulsa, OK 74157

Operator Contact Person Bruce L. Taton  
Phone 918-446-6114

Contractor: license # 5107  
name H-30, Inc.

Wellsite Geologist Wayne Lebsack  
Phone 316-938-2396

Designate Type of Completion  
 New Well  Re-Entry  Workover  
 Oil  SWD  Temp Abd  
 Gas  Inj  Delayed Comp.  
 Dry  Other (Core, Water Supply etc.)

If OWWO: old well info as follows:  
Operator  
Well Name  
Comp. Date Old Total Depth

WELL HISTORY

Drilling Method:  Mud Rotary  Air Rotary  Cable  
7/2/84 7/10/84 7/10/84  
Spud Date Date Reached TD Completion Date  
4250' 3850  
Total Depth PBD

Amount of Surface Pipe Set and Cemented at \_\_\_\_\_ feet  
Multiple Stage Cementing Collar Used?  Yes  No

If Yes, Show Depth Set \_\_\_\_\_ feet  
If alternate 2 completion, cement circulated  
from \_\_\_\_\_ feet depth to \_\_\_\_\_ w/ \_\_\_\_\_ SX cmt

API NO. 15 - 155-20, 996 - 0000

County Reno

E/2 SE SW Sec 21 Twp 23 Rge 10 East West XX

660 Ft North from Southeast Corner of Section  
3630 Ft West from Southeast Corner of Section  
(Note: locate well in section plat below)

Lease Name Kreie "D" (Hurst) Well# 5

Field Name Peace Creek-Zenith

Producing Formation Viola

Elevation: Ground 1779' KB 1784'

1-25-85

RECEIVED  
STATE CORPORATION COMMISSION  
JAN 25 1985  
CONSERVATION DIVISION  
Wichita Kansas

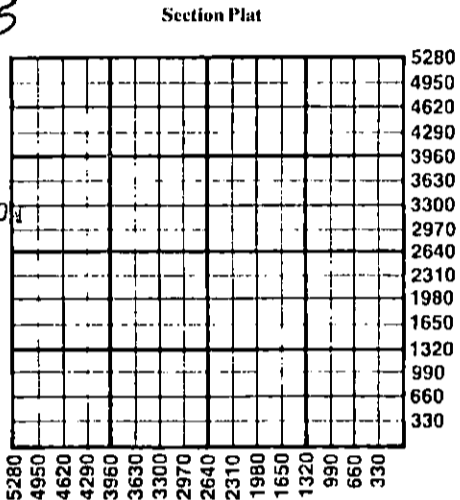

WATER SUPPLY INFORMATION

Source of Water:  
Division of Water Resources Permit #  
 Groundwater... 1650... Ft North From Southeast Corner and  
(Well) ... 3300... Ft. West From Southeast Corner of  
Sec 23 Twp 21 Rge 10  East  West  
 Surface Water... Ft North From Southeast Corner and  
(Stream, Pond etc.)... Ft West From Southeast Corner  
Sec Twp Rge  East  West  
 Other (explain) \_\_\_\_\_  
(purchased from city, R.W.D.#)

Disposition of Produced Water:  Disposal  Repressuring  
Hauled  
Docket # \_\_\_\_\_

INSTRUCTIONS: This form shall be completed in duplicate and filed with the Kansas Corporation Commission, 200 Colorado Derby Building, Wichita, Kansas 67202, within 90 days after completion or recompletion of any well. Rules 82-3-130 and 82-3-107 apply.

Information on side two of this form will be held confidential for a period of 12 months if requested in writing and submitted with the form. See rule 82-3-107 for confidentiality in excess of 12 months.

One copy of all wireline logs and drillers time log shall be attached with this form. Submit CP-4 form with all plugged wells. Submit CP-111 form with all temporarily abandoned wells.

All requirements of the statutes, rules, and regulations promulgated to regulate the oil and gas industry have been fully complied with and the statements herein are complete and correct to the best of my knowledge.

Signature Bruce L. Taton  
Title Production Coordinator Date 12/6/84

Subscribed and sworn to before me this 6th day of December 19 84

Notary Public Gloria A. Sam  
Date Commission Expires 2/14/88

K.C.C. OFFICE USE ONLY  
F  Letter of Confidentiality Attached  
C  Wireline Log Received  
C  Drillers Timelog Received  
Distribution  
 KCC  SWD/Rep  NGPA  
 KGS  Plug  Other (Specify)

Sec 21 Twp 23 Rge 10

SIDE TWO

Operator Name Fell Oil and Gas Lease Name Kreie "D" Well# 5 SEC 21 TWP. 23S RGE. 10  East  West

WELL LOG

**INSTRUCTIONS:** Show important tops and base of formations penetrated. Detail all cores. Report all drill stem tests giving interval tested, time tool open and closed, flowing and shut-in pressures, whether shut-in pressure reached static level, hydrostatic pressures, bottom hole temperature, fluid recovery, and flow rates if gas to surface during test. Attach extra sheet if more space is needed. Attach copy of log.

Drill Stem Tests Taken  Yes  No  
 Samples Sent to Geological Survey  Yes  No  
 Cores Taken  Yes  No

Formation Description  
 Log  Sample

Name	Top	Bottom
Sand, Clay	0'	120'
Red Bed	120'	210'
Shale	210'	215'
Shale and Red Bed	215'	1230'
Shale and Lime	1230'	1515'
Lime and Shale	1515'	2095'
Shale and Lime	2095'	2305'
Lime and Shale	2305'	2800'
Shale and Lime	2800'	2960'
Lime and Shale	2960'	3325'
Shale and Lime	3325'	3460'
Lime and Shale	3460'	3695'
Shale and Lime	3695'	3785'
Lime and Shale	3785'	3960'
Lime	3960'	4250'
Rotary total depth	4250'	

CASING RECORD <input checked="" type="checkbox"/> new <input type="checkbox"/> used							
Report all strings set - conductor, surface, intermediate, production, etc.							
Purpose of string	size hole drilled	size casing set (in O.D.)	weight lbs/ft.	setting depth	type of cement	# sacks used	type and percent additives
SURFACE	12-1/4"	8 5/8"	32#	207'	60/40. poz	185	2% gel 3% cc
PRODUCTION	7-7/8"	5 1/2"	14#	3995'	Reg. Poz.	200	
					Howco. lite	50	.075. CER2

PERFORATION RECORD		Acid, Fracture, Shot, Cement Squeeze Record	
shots per foot	specify footage of each interval perforated	(amount and kind of material used)	Depth
2	3876-80	Acid-500 Gal. 15% FE. Halliburton	3876
2	3773-75	Acid-250 Gal. 15% NE. Halliburton	3773

TUBING RECORD			
size	set at	packer at	Liner Run <input type="checkbox"/> Yes <input checked="" type="checkbox"/> No
2 7/8	3800	N/A	

Date of First Production	Producing method <input type="checkbox"/> flowing <input checked="" type="checkbox"/> pumping <input type="checkbox"/> gas lift <input type="checkbox"/> Other (explain)				
9/1/84					

Estimated Production Per 24 Hours	Oil	Gas	Water	Gas-Oil Ratio	Gravity
5 Bbls	TSTM	MCF	5 Bbls	N/A	CFPB 37°

Disposition of gas:  vented  open hole  perforation  sold  other (specify)  used on lease  other (specify)  Dually Completed.  Commingled

PRODUCTION INTERVAL  
 3773-75