

Give All Information Completely  
Make Required Affidavit  
Mail or Deliver Report to:  
Conservation Division  
State Corporation Commission  
212 No. Market  
Wichita, Kansas

WELL PLUGGING RECORD

15.083.20037.00.00

HODGEMAN County, Sec. 22 Twp. 21 Rge. 24 KEY (W)

Location as "NE/CNW&SW" or footage from lines C NE SW

Lease Owner PETROLEUM, INC.,

Lease Name CROFT Well No. 1

Office Address R.R. #2, GREAT BEND, KANSAS

Character of Well (completed as Oil, Gas or Dry Hole) DRY HOLE

Date well completed MARCH 10 1968

Application for plugging filed MARCH 10 1968

Application for plugging approved MARCH 10 1968

Plugging commenced MARCH 10 1968

Plugging completed MARCH 10 1968

Reason for abandonment of well or producing formation NO PRODUCIBLE ZONE

If a producing well is abandoned, date of last production NONE 19

Was permission obtained from the Conservation Division or its agents before plugging was commenced? YES

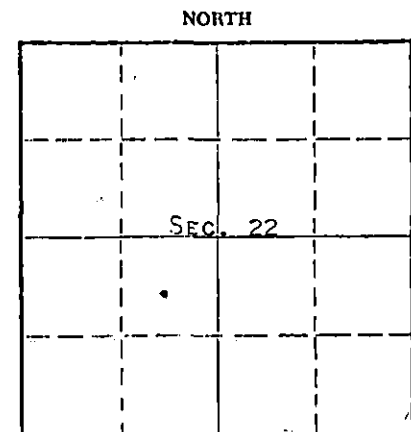

Locate well correctly on above Section Plat

Name of Conservation Agent who supervised plugging of this well E. EYES

Producing formation \_\_\_\_\_ Depth to top \_\_\_\_\_ Bottom \_\_\_\_\_ Total Depth of Well 4648' Feet

Show depth and thickness of all water, oil and gas formations.

OIL, GAS OR WATER RECORDS

CASING RECORD

FORMATION	CONTENT	FROM	TO	SIZE	PUT IN	PULLED OUT
				8-5/8"	558'	NONE

Describe in detail the manner in which the well was plugged, indicating where the mud fluid was placed and the method or methods used in introducing it into the hole. If cement or other plugs were used, state the character of same and depth placed, from \_\_\_\_\_ feet to \_\_\_\_\_ feet for each plug set.

HEAVY MUD TO 800', 100 SACKS CEMENT. HEAVY MUD TO 45', 15 SACKS CEMENT TO BASE OF WELL CELLAR.

RECEIVED  
STATE CORPORATION COMMISSION  
MAR 25 1968  
CONSERVATION DIVISION  
Wichita, Kansas

(If additional description is necessary, use BACK of this sheet)

Name of Plugging Contractor GARVEY DRILLING CO.

Address R.R. #2, GREAT BEND, KANSAS

STATE OF KANSAS, COUNTY OF BARTON, ss.

MONTE CHADD, DIST. PROD. SUPT. (employee of owner) or (owner or operator) of the above-described well, being first duly sworn on oath, says: That I have knowledge of the facts, statements, and matters herein contained and the log of the above-described well as filed and that the same are true and correct. So help me God.

(Signature) *Monte Chadd*

R.R. #2, GREAT BEND, KANSAS (Address)

SUBSCRIBED AND SWORN to before me this 22 day of MARCH, 1968

My commission expires MAY 28, 1969

*Richard H. Duviler*  
Notary Public.

15. 083. 20037. 00. 00

# WELL LOG

COMPANY Petroleum, Inc.  
 FARM Croft  
 TOTAL DEPTH 4700'  
 COMM. 2-27-68  
 CONTRACTOR Garvey Drilling Company

RECEIVED  
 STATE CORPORATION COMMISSION  
 MAR 25 1968  
 CONSERVATION DIVISION  
 Wichita, Kansas

SEC. 22 T. 21S R. 24W  
 LOC. C NE SW  
 COUNTY Hodgeman

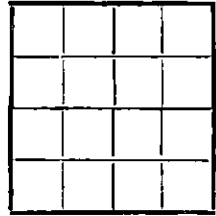

ELEVATION 2365' DF

PRODUCTION D & A

FIGURES INDICATE BOTTOM OF FORMATIONS

- 40' Surface Soil
- 558' Shale
- 970' Shale and Shells
- 985' Blain Anhydrite
- 1060' Shale
- 1150' Sand
- 1244' Sand and Shale
- 1338' Shale w/Sand Streaks
- 1588' Red Bed and Shale
- 1630' Anhydrite
- 2200' Shale and Shells
- 2460' Shale and Lime
- 2588' Lime and Shale
- 2705' Lime
- 3690' Lime and Shale
- 3796' Shale and Lime
- 3900' Lime and Shale
- 4090' Lime
- 4133' Lime with Chalk Streaks
- 4210' Lime w/Shale Streaks
- 4325' Lime
- 4405' Lime with Chert
- 4462' Lime
- 4500' Lime, Chert and Dolomite
- 4520' Lime and Chert
- 4535' Lime and Dolomite
- 4545' Lime
- 4570' Lime and Shale
- 4648' Lime
- 4648' RTD

State of Kansas }  
 County of Barton } SS

I, Sam N. Stephens of Garvey Drilling Company

upon oath state the above and foregoing is a true and correct copy of the log of the Croft No. 1 well.

*Sam N. Stephens*

Subscribed and sworn to before me this 21st day of March 1968

My Commission Expires: November 5th, 1969

*Richard A. Boep*  
 NOTARY PUBLIC