

Give All Information Completely
Make Required Affidavit
Mail or Deliver Report to:
Conservation Division
State Corporation Commission
800 Bittling Building
Wichita, Kansas

WELL PLUGGING RECORD **05571**
OR **15-009-05771-0000**
FORMATION PLUGGING RECORD Strike out upper line when reporting plugging of formations.

Barton County, Sec. **32** Twp. **16S** Rge. **11** (E) **11** (W)
Location as "NE $\frac{1}{4}$ NW $\frac{1}{4}$ SW $\frac{1}{4}$ " or footage from lines **NE $\frac{1}{4}$ SW $\frac{1}{4}$ SW $\frac{1}{4}$**

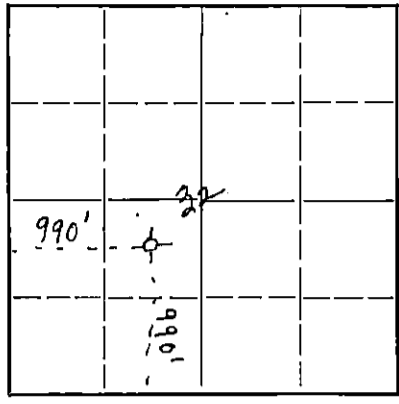

Locate well correctly on above Section Plat

Lease Owner **Black-Marshall Oil Co.**
Lease Name **Hitschmann Estate (R.V.)** Well No. **2**
Office Address **P.O. Box 36 - Great Bend, Kansas**
Character of Well (completed as Oil, Gas or Dry Hole) **Dry Hole**
Date well completed **April 21** 19 **43**
Application for plugging filed **April 22** 19 **43**
Application for plugging approved **April 22** 19 **43**
Plugging commenced **April 23** 19 **43**
Plugging completed **April 27** 19 **43**
Reason for abandonment of well or producing formation **Dry Hole**

If a producing well is abandoned, date of last production **--** 19 **---**
Was permission obtained from the Conservation Division or its agents before plugging was commenced? **Yes**

Name of Conservation Agent who supervised plugging of this well **E. T. Alexander**
Producing formation **None** Depth to top **---** Bottom **---** Total Depth of Well **3432** Feet
Show depth and thickness of all water, oil and gas formations.

OIL, GAS OR WATER RECORDS CASING RECORD

Formation	Content	From	To	Size	Put In	Pulled Out
				8 5/8 O.D.	258	None
				5 1/2 O.D.	3432	1613' 2"

Describe in detail the manner in which the well was plugged, indicating where the mud fluid was placed and the method or methods used in introducing it into the hold. If cement or other plugs were used, state the character of same and depth placed, from **---** feet to **---** feet for each plug set.

Cemented from 3432 to 3360'
Bridged from 3360 to 3210
Cemented from 3210 to 3170

Hole was pumped full of heavy rotary mud with Sun Oil Well Cementing Co.

Bridged at 258 and cemented to 238
Mud from 238 to 26
Cemented from 26 to 3

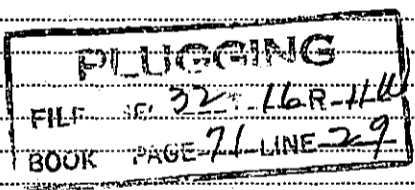

(If additional description is necessary, use BACK of this sheet)

Correspondence regarding this well should be addressed to **Black-Marshall Oil Co.**
Address **P.O. Box #6 - Great Bend, Kansas**

STATE OF **Kansas**, COUNTY OF **Barton**, ss.

Leon F. Huff (employee of owner) of the above-described well, being first duly sworn on oath, says: That I have knowledge of the facts, statements, and matters herein contained and the log of the above-described well as filed and that the same are true and correct. So help me God. **Black-Marshall Oil Co.**

(Signature) **[Signature]**, Asst. Secy. & Treas.
1910 Broadway - Great Bend, Kansas
(Address)

SUBSCRIBED AND SWORN to before me this **29th** day of **April**, 19 **43**

My commission expires **January 15, 1947**
Geneva Martin Weaver
Notary Public.

BLACK-MARSHALL OIL COMPANY

R. V. Hitchman #2

Sec. 32 - 16S - 11W
NE SW SW
County: Barton

Total Depth 3438
Comm. 4-2-43
Comp. Drig. 4-15-43

Elevation: 1926

Figures Indicate Bottom of Formations

Surface	4		
Shale & Shells	210	Top Anhydrite	785
Sand&Shale&Shells	220	Top Topeka	2717
Shale & Shells	250	T. LKC (Brown)	3077
Lime & Shells	263	T. LKC (White)	3095
Shale & Shells	480	Conglomerate	3378
Sand, Shale breaks		Arbuckle	3425
and iron	533		
Red Rock	540		
Shale, blue	555		
Red Rock	730		
Red Rock & Shale	785		
Anhydrite	820		
Shale & Shells	1290		
Salt	1455		
Lime&Shale breaks	1540		
Shale & Shells	1740		
Lime	1780		
Shale	1790		
Lime&Shale breaks	1940		
Lime	2125		
Shale	2135		
Shale & Shells	2472		
Broken lime	2487		
Shale & Shells	2660		
Lime	3004		
Lime&Shale breaks	3084		
Lime	3236		
Lime&Shale breaks	3378		
Conglomerate	3425		
Arbuckle	3438		
Total Depth	3434		

PI LICENSING
FILE 32 16 11W
300 21 LINE 29-

APR 29 1943
BARTON COUNTY MISSOURI