

STATE OF KANSAS
STATE CORPORATION COMMISSION

WELL PLUGGING RECORD

Give All Information Completely
Make Required Affidavit
Mail or Deliver Report to:
Conservation Division
State Corporation Commission
211 No. Broadway
Wichita, Kansas

NORTH

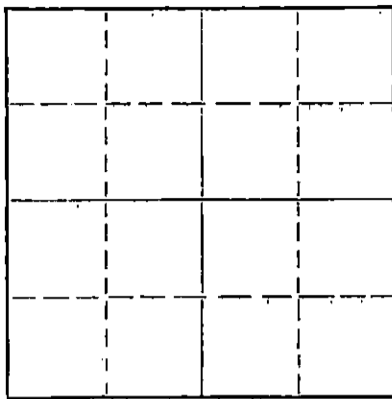

Locate well correctly on above
Section Plat

Pawnee County. Sec. 29 Twp. 22S Rge. 16 (E) (W) X
Location as "NE/CNW/SW" or footage from lines SE SE SW
Lease Owner John O. Farmer, Inc.
Lease Name Snowberger Well No. 1
Office Address Russell, Kansas
Character of Well (completed as Oil, Gas or Dry Hole) _____
Date well completed _____ 19____
Application for plugging filed December 9, 1963 19____
Application for plugging approved December 10, 1963 19____
Plugging commenced December 13, 1963 19____
Plugging completed December 18, 1963 19____
Reason for abandonment of well or producing formation Dry

If a producing well is abandoned, date of last production _____ 19____
Was permission obtained from the Conservation Division or its agents before plugging was commenced? Yes

Name of Conservation Agent who supervised plugging of this well Petty
Producing formation _____ Depth to top _____ Bottom _____ Total Depth of Well 4300 Feet
Show depth and thickness of all water, oil and gas formations.

OIL, GAS OR WATER RECORDS

CASING RECORD

FORMATION	CONTENT	FROM	TO	SIZE	PUT IN	PULLED OUT
				8 5/8	254	None
				5 1/2	None	2635

Describe in detail the manner in which the well was plugged, indicating where the mud fluid was placed and the method or methods used in introducing it into the hole. If cement or other plugs were used, state the character of same and depth placed, from _____ feet to _____ feet for each plug set.

Cleaning out cellar. Rigged up jacks. Sanded back to 4100' and 5 sacks of cement.
Shot well at 3500'. Working pipe. Shot at 3115'. Working pipe. Shot at 2860'. Working pipe. Shot at 2630'. Shot didn't go off.
Dropped weight and line. Fishing for line. Got out same.
Pulled shot. Shot well at 2850'. Working pipe. Shot at 2632'.
Pulled pipe.
Plugging well. Circulated mud. Spotted 20 sacks of cement at 250'. Spotted 30 sacks of cement. Pulled pipe.

RECEIVED
STATE CORPORATION COMMISSION
DEC 24 1963
CONSERVATION DIVISION
Wichita, Kansas

12-24-63

(If additional description is necessary, use BACK of this sheet)

Name of Plugging Contractor Forbes Casing Pulling, Inc.
Address Box 221 Great Bend, Kansas

STATE OF Kansas, COUNTY OF Barton, ss.
J. O. Forbes (employee of owner) or (owner or operator) of the above-described well, being first duly sworn on oath, says: That I have knowledge of the facts, statements, and matters herein contained and the log of the above-described well as filed and that the same are true and correct. So help me God.

(Signature) J. O. Forbes
Box 221 Great Bend, Kansas
(Address)

SUBSCRIBED AND SWORN TO before me this 20 day of December, 19 63

My commission expires May 27, 1964

[Signature]
Notary Public.

15-145-00273-0000

Form 1024

OPERATOR Jones, Shelburne & Farmer, Inc.

FORMATION RECORD

ADDRESS Russell, Kansas

This formation record is a record of the formation, depth, and other data obtained from a well.

WELL NO. SNOWBERGER COUNTY PAWNEE TWP 22 SEC 29 RGE 16

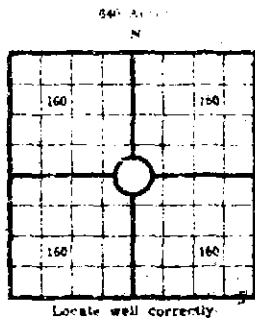

COUNTY Pawnee SEC 29 TWP 22 RGE 16
 COMPANY OPERATING Jones, Shelburne & Farmer, Inc.
 OFFICE ADDRESS Russell, Kansas
 FARM NAME SNOWBERGER WELL NO. 1
 DRILLING STARTED 2/28 1957 DRILLING FINISHED 3/16 1957
 DATE OF FIRST PRODUCTION _____ COMPLETED _____
 WELL LOCATED SE 1/4 SE 1/4 NE 1/4 North of South
 Line and _____ ft East of West Line of Quarter Section
 Elevation (Relative to sea level) DERRICK FLOOR 2058 GROUND 2055
 CHARACTER OF WELL (Oil, gas or dryhole) Gas

OIL OR GAS SANDS OR ZONES

Name	From	To	Name	From	To
1			4		
2			5		
3			6		

Perforating Record If Any

Formation	From	To	No. of Shots	Formation	From	To	Size of Shot

CASING RECORD

Amount Set						Amount Pulled				Casing Record	
Size	Wt.	Thick	Make	ft	in	ft	in	Size	Length	Depth Set	Make
8-5/8				254							

Liner Record: Amount _____ Kind _____ Top _____ Bottom _____

CEMENTING AND MUDDING

Size	Amount Set		Sacks Cement	Chemical		Method of Cementing	Amount	Mudding Method	Results (See Note)
	Ft.	In.		Gal.	Make				
5/8	254		200						
5-1/2	4237		100						

Note: What method was used to protect sands if outer strings were pulled? _____

NOTE: Were bottom hole plugs used? _____ If so, state kind, depth set and results obtained.

TOOLS USED

Runny Tools were used from _____ feet to _____ feet. Tools that were used from _____ feet to _____ feet and from _____ feet to _____ feet.

Type of _____

INITIAL PRODUCTION TEST

Describe initial test, when made, flow rate, etc. _____

Formation	Top	Bottom	Formation	Top	Bottom
Clay & sand	0	169			
Shale	169	340			
Redbed	340	500			
Shale, redbed streaks	500	540			
sand	540	610			
Shale & redbed	610	975			
Redbed	975	1076			
Anhydrite	1076	1100			
Shale & shells	1100	1860			
Shale & lime	1860	1975			
Lime & shale	1975	2360			
Shale & lime	2360	2550			
Lime & shale	2550	2620			
Shale & lime	2620	3375			
Lime & shale	3375	3720			
Lime	3720	3770			
Lime & shale	3770	4100			
Congl & shale	4100	4120			
Cherty Conglomerate	4120	4135			
Congl	4135	4255			
Cherty, shale & lime	4255	4285			
Chert lime & shale	4285	4300			
T.D.		4300			

TOPS:

Elevation: RB	2060
Anhydrite	1076
Heebner	3586
Toronto	3608
Brown Lime	3709
Lansing	3709
B/Kansas City	3975
Shaley Conglomerate	4087
Conglomerate	4110
Viola	4164
Simpson	4220
T.D.	4300
5-1/2" at	4307
with 100 sacks cement.	

OPERATOR Jones, Shelburne & Farmer, Inc.

15-145-00273-0000

FORMATION RECORD

ADDRESS Russell, Kansas

Give detailed description and thickness of all formations drilled through, contents of sand, whether dry, water, oil or gas:

WELL NO. 1 COUNTY Pawnee SEC. 29 TWP. 22 RGE. 16

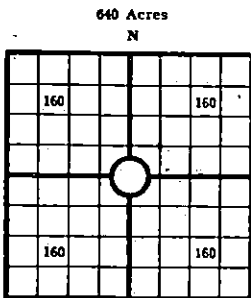

COUNTY Pawnee, SEC. 29, TWP. 22, RGE. 16

COMPANY OPERATING Jones, Shelburne & Farmer, Inc.

OFFICE ADDRESS Russell, Kansas

FARM NAME SNOWBERGER WELL NO. 1

DRILLING STARTED 2/28, 1957 DRILLING FINISHED 3/16, 1957

DATE OF FIRST PRODUCTION COMPLETED

WELL LOCATED SE 1/4, SW 1/4, SW 1/4, SE 1/4, North of South

Line and _____ ft. East of West Line of Quarter Section

Elevation (Relative to sea level) DERRICK FLOOR 2058 GROUND 2055

CHARACTER OF WELL (Oil, gas or dryhole) Gas

OIL OR GAS SANDS OR ZONES

Name	From	To	Name	From	To
1			4		
2			5		
3			6		

Perforating Record If Any

Shot Record

Formation	From	To	No. of Shots	Formation	From	To	Size of Shot

CASING RECORD

Amount Set						Amount Pulled				Packer Record	
Size	Wt.	Thds.	Make	Ft.	In.	Ft.	In.	Size	Length	Depth Set	Make
8-5/8				254							

Liner Record: Amount _____ Kind _____ Top _____ Bottom _____

CEMENTING AND MUDDING

Size	Amount Set		Sacks Cement	Chemical		Method of Cementing	Amount	Mudding Method	Results (See Note)
	Ft.	In.		Gal.	Make				
6/8	254		200						
5-1/2	4237		100						

Note: What method was used to protect sands if outer strings were pulled? _____

NOTE: Were bottom hole plugs used? _____ If so, state kind, depth set and results obtained _____

TOOLS USED

Rotary Tools were used from _____ feet to _____ Cable tools were used from _____ feet to _____

_____ feet, and from _____ feet to _____ feet, and from _____ feet to _____

Type Rig _____

INITIAL PRODUCTION TEST

Describe initial test: whether by flow through tubing or casing or by pumping, _____

Amount of Oil Production _____ bbls. Size of choke, if any _____ Length of test _____ Water

Production _____ bbls. Gravity of oil _____ Type of Pump if pump is used, describe _____

Formation	Top	Bottom	Formation	Top	Bottom
Clay & sand	0	169			
Shale	169	340			
Redbed	340	500			
Shale, redbed strks	500	540			
sand	540	610			
Shale & redbed	610	975			
Redbed	975	1076			
Anhydrite	1076	1100			
Shale & shells	1100	1860			
Shale & lime	1860	1975			
Lime & shale	1975	2360			
Shale & lime	2360	2550			
Lime & shale	2550	2620			
Shale & lime	2620	3375			
Lime & shale	3375	3720			
Lime	3720	3770			
Lime & shale	3770	4100			
Congl. & shale	4100	4120			
Cherty Conglomerate	4120	4135			
Congl	4135	4255			
Cherty, shale & lime	4255	4285			
Chert lime & shale	4285	4300			
T.D.		4300			

TOPS:

Elevation: RB 2060
 Anhydrite 1076
 Heebner 3588
 Toronto 3608
 Brown Lime 3701
 Lansing 3709
 B/Kansas City 3976
 Shaley Conglomerate 4081
 Conglomerate 4112
 Viola 4164
 Simpson 4220
 T.D. 4300
 5-1/2" at 4237
 with 100 sacks cement.

RECEIVED
 COMMISSION
 705
 SEC. 29
 TWP. 22
 RGE. 16
 PAWNEE COUNTY
 KANSAS
 NOTARIAL PUBLIC
 MICHAEL J. ...

I, the undersigned, being first duly sworn upon oath, state that this well record is true, correct and complete according to the records of this office and to the best of my knowledge and belief.

John D. Terover
 Vice-Pres.
 Name and title of representative of company

Subscribed and sworn to before me this 28th day of March, 1957
 My Commission expires 10/11/58
Lucius ...
 Notary Public.