

STATE CORPORATION COMMISSION OF KANSAS
OIL & GAS CONSERVATION DIVISION
WELL COMPLETION FORM
ACO-1 WELL HISTORY
DESCRIPTION OF WELL AND LEASE

API NO. 15- 145-21,346-0000 APR 09 1992

County Pawnee FROM CONFIDENTIAL East

NE SE SE Sec. 34 Twp. 22 Rge. 16W X West

990 Ft. North from Southeast Corner of Section

330 Ft. West from Southeast Corner of Section

(NOTE: Locate well in section plat below.)

Lease Name Wurm Well # #1

Field Name Shady

Producing Formation Lansing-Kansas City

Elevation: Ground 2031 KB 2036

Total Depth 4060' PBDT 4037

Operator: License # 5403

Name: Mr. Wayne Walcher

Address 701 Bitting Building

City/State/Zip Wichita, KS 67202

Purchaser: _____

Operator Contact Person: Mr. Wayne Walcher

Phone (316) 267-1611

Contractor: Name: Red Tiger Drilling

License: 5302

Wellsite Geologist: Wayne Walcher

Designate Type of Completion

New Well Re-Entry Workover

Oil SWD Temp. Abd.

Gas Inj Delayed Comp.

Dry Other (Core, Water Supply, etc.)

If OWMO: old well info as follows:

Operator: _____

Well Name: _____

Comp. Date _____ Old Total Depth _____

Drilling Method:

Mud Rotary Air Rotary Cable

11-20-90 11-29-90 11-30-90

Spud Date Date Reached TD Completion Date

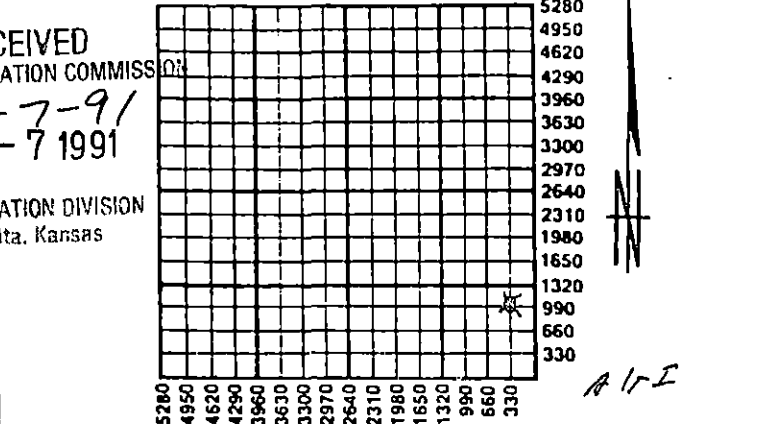

Amount of Surface Pipe Set and Cemented at 311' Feet

Multiple Stage Cementing Collar Used? Yes No

If yes, show depth set _____ Feet

If Alternate II completion, cement circulated from _____

feet depth to _____ w/ _____ sx cmt.

INSTRUCTIONS: This form shall be completed in triplicate and filed with the Kansas Corporation Commission, 200 Colorado Derby Building, Wichita, Kansas 67202, within 120 days of the spud date of any well. Rule 82-3-130, 82-3-107 and 82-3-106 apply. Information on side two of this form will be held confidential for a period of 12 months if requested in writing and submitted with the form. See rule 82-3-107 for confidentiality in excess of 12 months. One copy of all wireline logs and drillers time log shall be attached with this form. ALL CEMENTING TICKETS MUST BE ATTACHED. Submit CP-4 form with all plugged wells. Submit CP-111 form with all temporarily abandoned wells. Any recompletion, workover or conversion of a well requires filing of ACO-2 within 120 days from commencement date of such work.

All requirements of the statutes, rules and regulations promulgated to regulate the oil and gas industry have been fully complied with and the statements herein are complete and correct to the best of my knowledge.

Signature Wayne Walcher

Title Operator Date 5-6-91

Subscribed and sworn to before me this 6th day of March, 1991.

Notary Public Francis E. Barham

Date Commission Expires April 20, 1991

K.C.C. OFFICE USE ONLY
F Letter of Confidentiality Attached
C Wireline Log Received
C Drillers Timelog Received
Distribution
 KCC SWD/Rep NGPA
 KGS Plug Other
(Specify)



CONFIDENTIAL

SIDE TWO

Operator Name Mr. Wayne Walcher Lease Name Wurm Well # #1
 Sec. 34 Twp. 22 Rge. 16W East County Pawnee
 West

INSTRUCTIONS: Show important tops and base of formations penetrated. Detail all cores. Report all drill stem tests giving interval tested, time tool open and closed, flowing and shut-in pressures, whether shut-in pressure reached static level, hydrostatic pressures, bottom hole temperature, fluid recovery, and flow rates if gas to surface during test. Attach extra sheet if more space is needed. Attach copy of log.

Drill Stem Tests Taken Yes No
 (Attach Additional Sheets.)
 Samples Sent to Geological Survey Yes No
 Cores Taken Yes No
 Electric Log Run Yes No
 (Submit Copy.)

DST 3602-25 Opn 1 hr, GTS
 12 min. Stab @ 63 Mcfd/20
 min in 2nd opn'g.
 Recov. 60' mud.
 ISIP 1200# FSIP 1198#

Name	Formation Description	
	Top	Bottom
Anhydrite	989	1008
Heebner	3480	
Brn. Lime	3598	
Lansing	3607	
Base KC	3862	
Conglomerate	3986	
Rot. TD	4060	

CASING RECORD <input checked="" type="checkbox"/> New <input checked="" type="checkbox"/> Used							
Report all strings set-conductor, surface, intermediate, production, etc.							
Purpose of String	Size Hole Drilled	Size Casing Set (In O.D.)	Weight Lbs./Ft.	Setting Depth	Type of Cement	# Sacks Used	Type and Percent Additives
Surface	12 1/4	8 5/8		311'	60-40poz	200	2%gel 3%cc
Production		4 1/2	10 1/2#	4055'		200	
PERFORATION RECORD				Acid, Fracture, Shot, Cement Squeeze Record			
Shots Per Foot	Specify Footage of Each Interval Perforated			(Amount and Kind of Material Used) Depth			
2	3609-15			1250 gal FESD			
TUBING RECORD				Liner Run <input type="checkbox"/> Yes <input checked="" type="checkbox"/> No			
	Size	Set At	Packer At				
	2-3/8"	3605	none				
Date of First Production	Producing Method <input checked="" type="checkbox"/> Flowing <input type="checkbox"/> Pumping <input type="checkbox"/> Gas Lift <input type="checkbox"/> Other (Explain)						
Estimated Production Per 24 Hours	Oil Bbls.	Gas Mcf	Water Bbls.	Gas-Oil Ratio		Gravity	
		603					

Disposition of Gas: Shut in Gas Well Vented Sold Used on Lease (If vented, submit ACO-18.) Open Hole Perforation Dually Completed Commingled Other (Specify) _____

METHOD OF COMPLETION _____

Production Interval _____

RELEASED

ORIGINAL CONFIDENTIAL

APR 09 1992

Phone Plainville 913-434-2812

Phone ~~FROM CONFIDENTIAL~~

ALLIED CEMENTING CO., INC. No. 7327

Home Office P. O. Box 31

Russell, Kansas 67665

20-90	Sec. 34	Twp. 22	Range 16	Called Out 10:45 A.M.	On Location 12:30 P.M.	Job Start 2:30 P.M.	Finish 3:15 P.M.
Well No. #1	S. side of Larned, SS, 2E, 4N, W/1/2 P. 1/2 Sec. 34			County Pawnee		State KS	
Red Tiger Rig #4				Owner Same			
Surface				To Allied Cementing Co., Inc. You are hereby requested to rent cementing equipment and furnish cementer and helper to assist owner or contractor to do work as listed.			
12 1/4"	I.D. 314'			Charge To Wayne Walcher			
8 3/8"	Depth 314'			Street 701 Biting Bldg.			
	Depth			City Wichita State Ko. 67202			
	Depth			The above was done to satisfaction and supervision of owner agent or contractor			
Left in Csg. 15'	Shoe Joint			Purchase Order No.			
	Minimum			Gordon R. Hick			
	Displace 19 1/2 bbls			CEMENT			

EQUIPMENT

No. 63	Cementor	Tim
	Helper	Cary
No. 68	Cementor	
	Helper	
	Driver	Jack S.
	Driver	

Amount Ordered	200 SKS ⁶⁰ / ₄₀ 3% CC, 2% Gel,		
Consisting of			
Common	120	5.25	630.00
Poz. Mix	80	2.25	180.00
Gel.	4	6.75	N/C
Chloride	6	21.00	126.00
Quickset			

RECEIVED
STATE CORPORATION COMMISSION Sales Tax

of Job	Pump Trk Charge	380.00
26	Pump Trk Mileage	52.00
1	8" Wooden Plug	42.00
	14' at 39	N/C
	Total	474.00

Handling	200	MAR - 7 1991	1.00	200.00
Mileage	26			208.00
CONSERVATION DIVISION Wichita, Kansas				Sub Total
				Total 1344.00

Floating Equipment				
Total #	1818.00			
Disc -	363.60			
	# 1454.40			

Ran 314' of 8 3/8 csg, Mixed
200 SKS ⁶⁰/₄₀ 3+2. Pumped Plug
to 299' with fresh water.
Cement did circulate,
Allied Cementing Co. Inc. - T. D. ...
By T. ...

Phone 316-793-5861, Great Bend, Kansas

CONFIDENTIAL

15-145-21346-0000
Phone Plainville 913-434-2812
RELEASED
Phone Ness City 913-798-3843

ALLIED CEMENTING CO., INC. APR 1992 NO 7337

Home Office P. O. Box 31

Russell, Kansas 67665

New

FROM CONFIDENTIAL

Date	11-30-90	Sec.	34	Twp.	22	Range	16	Called Out	2:00 A.M.	On Location	4:15 A.M.	Job Start	9:30 A.M.	Finish	10:30
Lease	Worm	Well No.	#1	Location	Lyons, SS, 2E, 4N, W/1st Pawnee				County	KS	State	KS			
Contractor	Red Tiger Rig #4				Owner	Same									
Type Job	Production														
Hole Size	7 7/8"			T.D.	4060'										
Csg.	4 1/2"			Depth	4053'										
Tbg. Size				Depth											
Drill Pipe				Depth											
Tool				Depth											
Cement Left in Csg.	13'			Shoe Joint	13'										
Press Max.	300#			Minimum											
Meas Line				Displace	64 bbl										
Perf.															

To Allied Cementing Co., Inc.
You are hereby requested to rent cementing equipment and furnish cementer and helper to assist owner or contractor to do work as listed.

Charge To *Wayne Walcher*
Street *701 Biting Bldg*
City *Wichita* State *KS 67202*
The above was done to satisfaction and supervision of owner agent or contractor

Purchase Order No.
X *Wayne Walcher*
CEMENT

Amount Ordered	150 SKS 60/40 10% salt		
Consisting of			
Common	90	5.25	472.50
Poz. Mix	60	2.25	135.00
Gel.			
Chloride			
Quickset			
	<i>Salt-15</i>	4.75	71.25
		Sales Tax	
Handling	150	1.00	150.00
Mileage	26		156.00

TOTAL \$2485.75 Sub Total
Disc - 497.15
\$1988.60 Total *# 980*

EQUIPMENT

#	No.	Cementor	<i>Tim</i>
Pumptrk	181	Helper	<i>Cary</i>
	No.	Cementor	
Pumptrk		Helper	
#		Driver	
Bulktrk	179		
Bulktrk		Driver	

RECEIVED
STATE CONSERVATION COMMISSION

MAR - 7 1991

DEPTH of Job CONSERVATION DIVISION
Wichita, Kansas

Reference:	<i>Pumptrk Charge</i>	880.00
<i>26</i>	<i>Pum Ptk Mileage</i>	52.00
<i>1</i>	<i>4 1/2" Ribber Plug</i>	33.00
	Sub Total	
	Tax	
	Total	965.00

Remarks: *Ran 4053' of 4 1/2" csg. Mixed 150 SKS 60/40 10% salt. Washed line Clean of Cement & Pumped Plug to 4044' with Fresh water. Float Did Hold. Plugged Rathole*

Floating Equipment		
<i>1-4 1/2" Guideshoe</i>	-	109.00
<i>1-4 1/2" Insert</i>	-	169.00
<i>6-4 1/2" Centralizers</i>	-	258.00
		\$ 536.00
Allied Cementing Co Inc. By <i>Tim Dickson</i>		