

# ORIGINAL

SIDE ONE

STATE CORPORATION COMMISSION OF KANSAS  
OIL & GAS CONSERVATION DIVISION  
WELL COMPLETION FORM  
ACO-1 WELL HISTORY  
DESCRIPTION OF WELL AND LEASE

API NO. 15- 083-21,330-0000

Operator: License # 4767  
Name: Ritchie Exploration, Inc.  
Address 125 N. Market, Suite 1000

County Hodgeman  
150' S of  
C NW NE Sec. 24 Twp. 22S Rge. 22  East  
West

City/State/Zip Wichita, KS 67202  
Purchaser: n/a

4470 Ft. North from Southeast Corner of Section  
1980 Ft. West from Southeast Corner of Section  
(NOTE: Locate well in section plat below.)

Operator Contact Person: Rocky Milford  
Phone (316) 267-4375

Lease Name Anna Webster Well # 1  
Field Name unknown

Contractor: Name: Murfin Drilling Co.  
License: 6033

Producing Formation n/a  
Elevation: Ground 2139' KB 2144'  
Total Depth 4430' PBDT n/a

Wellsite Geologist: Bob Mathiesen

Designate Type of Completion  
 New Well  Re-Entry  Workover  
 Oil  SWD  Temp. Abd.  
 Gas  Inj  Delayed Comp.  
 Dry  Other (Core, Water Supply, etc.)

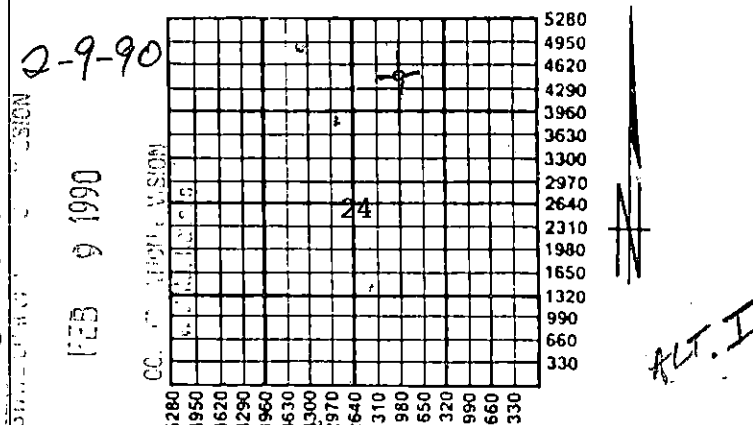

If OWMO: old well info as follows:  
Operator: \_\_\_\_\_  
Well Name: \_\_\_\_\_  
Comp. Date \_\_\_\_\_ Old Total Depth \_\_\_\_\_

Amount of Surface Pipe Set and Cemented at 1301' Feet

Drilling Method:  
 Mud Rotary  Air Rotary  Cable  
9/03/89 9/12/89 9/13/89  
Spud Date Date Reached TD Completion Date

Multiple Stage Cementing Collar Used?  Yes  No

If yes, show depth set \_\_\_\_\_ Feet

If Alternate II completion, cement circulated from \_\_\_\_\_

feet depth to \_\_\_\_\_ w/ \_\_\_\_\_ sx cmt.

**INSTRUCTIONS:** This form shall be completed in triplicate and filed with the Kansas Corporation Commission, 200 Colorado Derby Building, Wichita, Kansas 67202, within 120 days of the spud date of any well. Rule 82-3-130, 82-3-107 and 82-3-106 apply. Information on side two of this form will be held confidential for a period of 12 months if requested in writing and submitted with the form. See rule 82-3-107 for confidentiality in excess of 12 months. One copy of all wireline logs and drillers time log shall be attached with this form. ALL CEMENTING TICKETS MUST BE ATTACHED. Submit CP-4 form with all plugged wells. Submit CP-111 form with all temporarily abandoned wells. Any recompletion, workover or conversion of a well requires filing of ACO-2 within 120 days from commencement date of such work.

All requirements of the statutes, rules and regulations promulgated to regulate the oil and gas industry have been fully complied with and the statements herein are complete and correct to the best of my knowledge.

Signature [Signature]  
Title President Date 1/03/90

Subscribed and sworn to before me this 3rd day of January, 19 90.

Notary Public [Signature]  
Date Commission Expires 6/07/92

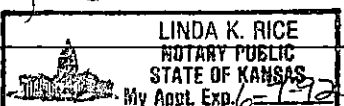

**K.C.C. OFFICE USE ONLY**  
F  Letter of Confidentiality Attached  
C  Wireline Log Received  
C  Drillers Timelog Received  
**Distribution**  
 KCC  SWD/Rep  NGPA  
 KGS  Plug  Other  
(Specify)

PI-E

ORIGINAL

SIDE TWO

Operator Name Ritchie Exploration, Inc. Lease Name Anna Webster Well # 1  
 Sec. 24 Twp. 22S Rge. 22  East County Hodgeman  
 West

**INSTRUCTIONS:** Show important tops and base of formations penetrated. Detail all cores. Report all drill stem tests giving interval tested, time tool open and closed, flowing and shut-in pressures, whether shut-in pressure reached static level, hydrostatic pressures, bottom hole temperature, fluid recovery, and flow rates if gas to surface during test. Attach extra sheet if more space is needed. Attach copy of log.

Drill Stem Tests Taken  Yes  No  
 (Attach Additional Sheets.)  
 Samples Sent to Geological Survey  Yes  No  
 Cores Taken  Yes  No  
 Electric Log Run  Yes  No  
 (Submit Copy.)

SEE ATTACHED PAGE.

**Formation Description**  
 Log  Sample  
 Name Top Bottom

SEE ATTACHED PAGE.

CASING RECORD <input checked="" type="checkbox"/> New <input type="checkbox"/> Used							
Report all strings set-conductor, surface, intermediate, production, etc.							
Purpose of String	Size Hole Drilled	Size Casing Set (In O.D.)	Weight Lbs./Ft.	Setting Depth	Type of Cement	# Sacks Used	Type and Percent Additives
Surface	12 1/4"	8-5/8"	24#	1301'	60/40poz	400	2%gel, 3%CC
PERFORATION RECORD				Acid, Fracture, Shot, Cement Squeeze Record			
Shots Per Foot	Specify Footage of Each Interval Perforated			(Amount and Kind of Material Used)			Depth
TUBING RECORD				Liner Run <input type="checkbox"/> Yes <input type="checkbox"/> No			
Size	Set At	Packer At					
Date of First Production	Producing Method <input type="checkbox"/> Flowing <input type="checkbox"/> Pumping <input type="checkbox"/> Gas Lift <input type="checkbox"/> Other (Explain)						
Estimated Production Per 24 Hours	Oil Bbls.	Gas Mcf	Water Bbls.	Gas-Oil Ratio	Gravity		

Disposition of Gas:  Vented  Sold  Used on Lease (If vented, submit ACO-18.)

METHOD OF COMPLETION:  Open Hole  Perforation  Dually Completed  Commingled  Other (Specify) \_\_\_\_\_

Production Interval \_\_\_\_\_

ORIGINAL

Ritchie Exploration, Inc.  
 #4767  
 #1 Anna Webster  
 150' S of C NW NE  
 Section 24-22S-22W  
 Hodgeman County, Ks

ACO-1  
 Page 2

DRILL STEM TESTS

DST #1 from 4342' to 4376' (Miss. Osage).  
 Recovered 20' of mud with a few oil specks.  
 IFP:43-53#/30"; ISIP:65#/30";  
 FFP:56-56#/30"; FSIP:56#/30".

DST #2 from 4376' to 4384' (Miss. Osage).  
 Recovered 10' of mud, good show of oil in  
 tool.  
 IFP:10-10#/30"; ISIP:30#/30";  
 FFP:10-10#/30"; FSIP:19#/30".

DST #3 from 4384' to 4392' (Miss. Osage).  
 Recovered 20' of mud with oil specks.  
 IFP:20-20#/30"; ISIP:69#/30";  
 FFP:20-20#/30"; FSIP:49#/30".

DST #4 from 4392' to 4400' (Miss. Osage). Recovered 70' of muddy water,  
 no show of oil.  
 IFP:29-39#/45"; ISIP:1244#/45";  
 FFP:49-49#/45"; FSIP:1235#/45".  
 RTD 4430'. Ran electric log. Plugged and abandoned. First plug set  
 at 1330' with 50 sacks of 60/40 pozmix, 6% gel; second plug set at 420'  
 with 30 sacks; third plug set at 40' with 10 sacks; and 15 sacks in  
 the rat hole.

ELECTRIC LOG TOPS

Anhydrite	1280' (+ 864)	+6
B/Anhydrite	1301' (+ 843)	+8
Heebner	3710' (-1566)	+9
Lansing	3769' (-1625)	+13
Stark	4019' (-1875)	+12
B/KC	4101' (-1957)	+9
Marmaton	4121' (-1977)	+9
Pawnee	4253' (-2109)	+8
Ft. Scott	4295' (-2151)	+10
Cherokee	4319' (-2175)	+10
Miss.	4371' (-2227)	+14
LTD	4432' (-2288)	

RECEIVED  
 STATE GEOLOGICAL COMMISSION  
 FEB 9 1990  
 CORRELATION DIVISION  
 WICHITA, KANSAS