

STATE OF KANSAS  
STATE CORPORATION COMMISSION

WELL PLUGGING RECORD

Give All Information Completely  
Make Required Affidavit  
Mail or Deliver Report to:  
Conservation Division  
State Corporation Commission  
219 North Market, Insurance Bldg.  
Wichita, Kansas

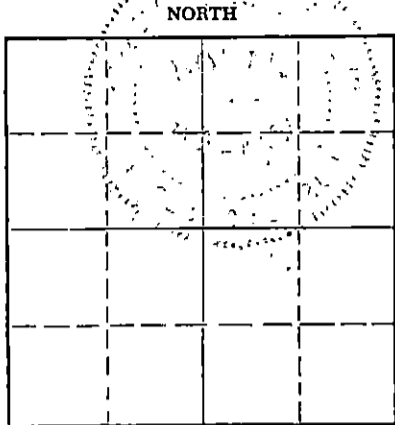

Locate well correctly on above  
Section Plat

Hodgeman County. Sec. 14 Twp. 22S Rge. 26W (E) (W)  
Location as "NE/CNW/SW" or footage from lines C SW, NE  
Lease Owner John O. Farmer, Inc., & Aylward Drilling Co.  
Lease Name Stapleton "B" Well No. 1  
Office Address P.O. Box 352, Russell, Kansas 67665  
Character of Well (completed as Oil, Gas or Dry Hole) Dryhole  
Date well completed 6/12/1968  
Application for plugging filed 6/12/1968  
Application for plugging approved 6/12/1968  
Plugging commenced 6/12/1968  
Plugging completed 7 P.M. 6/12/1968  
Reason for abandonment of well or producing formation Dryhole

If a producing well is abandoned, date of last production \_\_\_\_\_ 19\_\_\_\_  
Was permission obtained from the Conservation Division or its agents before plugging was commenced? Yes

Name of Conservation Agent who supervised plugging of this well Edgar Eves, Subblett, Kansas  
Producing formation \_\_\_\_\_ Depth to top \_\_\_\_\_ Bottom \_\_\_\_\_ Total Depth of Well 4602 Feet  
Show depth and thickness of all water, oil and gas formations.

OIL, GAS OR WATER RECORDS

CASING RECORD

FORMATION	CONTENT	FROM	TO	SIZE	PUT IN	PULLED OUT

Describe in detail the manner in which the well was plugged, indicating where the mud fluid was placed and the method or methods used in introducing it into the hole. If cement or other plugs were used, state the character of same and depth placed, from \_\_\_\_\_ feet to \_\_\_\_\_ feet for each plug set.

Plug # 1 900' 80 sx. cement  
Plug # 2 300' 50 sx. cement  
Plug # 3 45' 15 sx. cement  
Completed: 7 P.M. 6/12/68  
Edgar Eves, State Plugger

RECEIVED  
STATE CORPORATION COMMISSION  
JUN 17 1968  
CONSERVATION DIVISION  
Wichita, Kansas

(If additional description is necessary, use BACK of this sheet)  
Name of Plugging Contractor John O. Farmer, Inc.  
Address P.O. Box 352, Russell, Kansas 67665

STATE OF KANSAS COUNTY OF RUSSELL, ss.  
JOHN O. FARMER, President (employee of owner) or (owner or operator) of the above-described well, being first duly sworn, on oath, says: That I have knowledge of the facts, statements, and matters herein contained and the log of the above-described well as filed and that the same are true and correct. So help me, God.

(Signature) John O. Farmer  
P.O. Box 352, Russell, Kansas  
(Address)

Subscribed and sworn to before me this 14th day of June, 1968

My commission expires February 15, 1971

Helen Carlson  
Helen Carlson Notary Public.

OPERATOR John O. Farmer, Inc. & Aylward Drilling Company

15-083-20044-0000  
FORMATION RECORD

ADDRESS Russell, Ks. Wichita, Kansas

Give detailed description and thickness of all formation drilled through, contents of sand, whether dry, water, oil or gas.

FARM NAME Stapleton "B" WELL NO. 1 COUNTY Hodgeman SEC. 14 TWP. 22S RGE. 26W

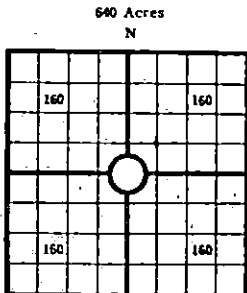

COUNTY Hodgeman, SEC. 14, TWP. 22S, RGE. 26W  
 COMPANY OPERATING John O. Farmer, Inc.  
 OFFICE ADDRESS Box 352 Russell, Ks.  
 DRILLING STARTED 5/30, 1968, DRILLING FINISHED 6/12, 1968  
 DATE OF FIRST PRODUCTION \_\_\_\_\_ COMPLETED \_\_\_\_\_  
 WELL LOCATED C 1/4 SW 1/4 NE 1/4, North of South  
 Line and \_\_\_\_\_ ft. East of West Line of Quarter Section  
 Elevation (Relative to sea level) DERRICK FLOOR 2473 @ GROUND 2470  
 CHARACTER OF WELL (Oil, gas or dryhole) Dryhole

OIL OR GAS SANDS OR ZONES

Name	From	To	Name	From	To
1-			4		
2-			5		
3-			6		

Perforating Record If Any

Shot Record

Formation	From	To	No. of Shots	Formation	From	To	Size of Shot

CASING RECORD

Amount Set				Amount Pulled				Packer Record			
Size	Wt.	Thds.	Make	Ft.	In.	Ft.	In.	Size	Length	Depth Set	Make

Liner Record: Amount \_\_\_\_\_ Kind \_\_\_\_\_ Top \_\_\_\_\_ Bottom \_\_\_\_\_

CEMENTING AND MUDDING

Size	Amount Set	Sacks	Chemical		Method of	Amount	Mudding	Results
Ft.	In.	Cement	Gal.	Make	Cementing		Method	(See Note)
8.5/8"	210'	150	sx. cement					

Note: What method was used to protect sands if outer strings were pulled?

NOTE: Were bottom hole plugs used? If so, state kind, depth set and results obtained

TOOLS USED

Rotary Tools were used from 0 feet to R.T.D. Cable tools were used from \_\_\_\_\_ feet to \_\_\_\_\_ feet, and from \_\_\_\_\_ feet to \_\_\_\_\_ feet, and from \_\_\_\_\_ feet to \_\_\_\_\_ feet

Type Rig Rotary

INITIAL PRODUCTION TEST

Describe initial test: whether by flow through tubing or casing or by pumping

Amount of Oil Production \_\_\_\_\_ bbls. Size of choke, if any \_\_\_\_\_ Length of test \_\_\_\_\_ Water

Production \_\_\_\_\_ bbls. Gravity of oil \_\_\_\_\_ Type of Pump if pump is used, describe \_\_\_\_\_

Formation	Top	Bottom	Formation	Top	Bottom
Surface		960			
Redbed	960	1080			
Shale shells	1080	1460			
Redbed shells	1460	1670			
Shale shells	1670	2000			
Shale lime	2000	2145			
Lime shale	2145	2680			
Shale lime	2680	2848			
Lime shale	2848	3955			
Lime	3955	4602			
			Sample Tops		
			Anhydrite	1068'	?
			Heebner	385'	
			Toronto	3870'	
			Lansing	3895'	
			Base Kansas City	4295'	
			Marmaton	4319'	
			Cherokee	4405'	
			Mississippi	4529'	
			Spergen Warsaw	4551'	
			Rotary T.D.	4602'	

RECEIVED  
STATE CORPORATION COMMISSION  
JUN 17 1968  
CONSERVATION DIVISION  
Wichita, Kansas

I, the undersigned, being first duly sworn upon oath, state that this well record is true, correct and complete according to the records of this office and to the best of my knowledge and belief.

John O. Farmer  
Name and title of representative of company  
President

Subscribed and sworn to before me this 14th day of June, 1968

My Commission expires 2/15/71

Helen Carlson Notary Public.