

RECEIVED JUN 2 1976

Form CP-4

STATE OF KANSAS
STATE CORPORATION COMMISSION

Give All Information Completely
Make Required Affidavit
Mail or Deliver Report to:
Conservation Division
State Corporation Commission
P. O. Box 17027
Wichita, Kansas 67217
NORTH

WELL PLUGGING RECORD

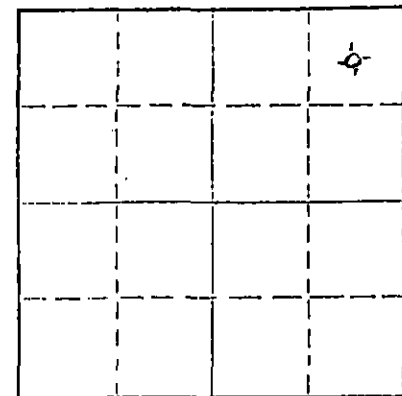

Locate well correctly on above
Section Plat

Hodgeman County, Sec. 11 Twp. 22S Rge. (E) 26 (W)
Location as "NE/CNW&SW" or footage from lines NE NE
Lease Owner Bellar Drilling Co.
Lease Name Schroeder Well No. 1
Office Address 610 Petroleum Bldg Wichita, KS
Character of Well (completed as Oil, Gas or Dry Hole) Dry Hole
Date well completed May 14, 19 76
Application for plugging filed May 14, 19 76
Application for plugging approved May 14, 19 76
Plugging commenced May 14, 19 76
Plugging completed May 14, 19 76
Reason for abandonment of well or producing formation Too low structurally

If a producing well is abandoned, date of last production 19____
Was permission obtained from the Conservation Division or its agents before plugging was commenced? Yes

Name of Conservation Agent who supervised plugging of this well Edgar J. Eves, Sublette, Kansas
Producing formation _____ Depth to top _____ Bottom _____ Total Depth of Well 4570 Feet
Show depth and thickness of all water, oil and gas formations.

OIL, GAS OR WATER RECORDS

CASING RECORD

FORMATION	CONTENT	FROM	TO	SIZE	PUT IN	PULLED OUT
				8 5/8"	302.74'	None

Describe in detail the manner in which the well was plugged, indicating where the mud fluid was placed and the method or methods used in introducing it into the hole. If cement or other plugs were used, state the character of same and depth placed, from _____ feet to _____ feet for each plug set.

Filled with heavy mud to 500'. Set Plug. Put in 70 sacks cement. Filled with heavy mud to 200'. Set plug. Put in 20 sacks cement. Filled with heavy mud to 40'. Set plug. Filled to top with 10 sacks cement and 1/2 sack hulls.

RECEIVED
STATE CORPORATION COMMISSION

JUN 28 1976 6-18-76

CONSERVATION DIVISION
Wichita, Kansas

(If additional description is necessary, use BACK of this sheet)

Name of Plugging Contractor C-G Drilling Co.
Address 1107 Union Natl Bldg, Wichita, KS 67202

STATE OF Kansas, COUNTY OF Sedgwick ss.
G. F. Galloway (employee of owner) or (owner or operator) of the above-described

well, being first sworn on oath, says: That I have knowledge of the facts, statements, and matters herein contained and the log of the above described well is filed and that the same are true and correct. So help me God.

(Signature) G. F. Galloway
1107 Union Natl Bldg, Wichita, KS
(Address)

Subscribed and sworn to before me this 19th day of May, 1976

My commission expires December 8, 1979

Phyllis Buchanan
Notary Public.

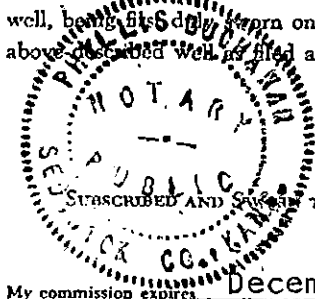

KANSAS DRILLERS LOG

RECEIVED JUN 2 1976

S. 11 T. 22S R. 26W E W

API No. 15 — 083 — 20,471-0000
 County Number

Loc. NE NE

County HODGEMAN

Operator
 HELLAR DRILLING CO.

Address
 710 PETROLEUM BUILDING, WICHITA KANSAS 67202

Well No. 1 Lease Name SCHROEDER

Footage Location
 660 feet from (N) XX line 660 feet from (E) XY line

Principal Contractor C-G DRILLING CO. Geologist LLOYD PARRISH, JR.

Spud Date MAY 4, 1976 Total Depth 4570 P.B.T.D.

Date Completed MAY 14, 1976 Oil Purchaser

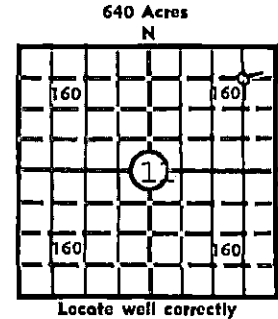

Elev.: Gr.

DF KB 2485

CASING RECORD

Report of all strings set— surface, intermediate, production, etc.

Purpose of string	Size hole drilled	Size casing set (in O.D.)	Weight lbs/ft.	Setting depth	Type cement	Sacks	Type and percent additives
SURFACE	12 1/4"	8 5/8"	28#	302.74'	COMMON	150	2% GEL 3% CA CL

LINER RECORD

PERFORATION RECORD

Top, ft.	Bottom, ft.	Sacks cement	Shots per ft.	Size & type	Depth interval

TUBING RECORD

Size	Setting depth	Packer set at

ACID, FRACTURE, SHOT, CEMENT SQUEEZE RECORD

Amount and kind of material used	Depth interval treated

INITIAL PRODUCTION

Date of first production	Producing method (flowing, pumping, gas lift, etc.)
RATE OF PRODUCTION PER 24 HOURS	Oil Gas Water Gas-oil ratio
Disposition of gas (vented, used on lease or sold)	Producing Interval(s)

INSTRUCTIONS: As provided in KCC Rule 82-2-125, within 90 days after completion of a well, one completed copy of this Drillers Log shall be transmitted to the State Geological Survey of Kansas, 4150 Monroe Street, Wichita, Kansas 67209. Copies of this form are available from the Conservation Division, State Corporation Commission, 3830 So. Meridian (P.O. Box 17027), Wichita, Kansas 66217. Phone AC 316-522-2206. If confidential custody is desired, please note Rule 82-2-125. Drillers Logs will be an open file in the Oil and Gas Division, State Geological Survey of Kansas, Lawrence, Kansas 66044.

Operator
HELLAR DRILLING CO. DESIGNATE TYPE OF COMP.: OIL, GAS,
DRY HOLE, SWDW, ETC.:
DRY HOLE

Well No. Lease Name
1 SCHROEDER

S 11 T 22 S R 26 W E
W

WELL LOG

Show all important zones of porosity and contents thereof; cored intervals, and all drill-stem tests, including depth interval tested, cushion used, time tool open, flowing and shut-in pressures, and recoveries.

SHOW GEOLOGICAL MARKERS, LOGS RUN, OR OTHER DESCRIPTIVE INFORMATION.

FORMATION DESCRIPTION, CONTENTS, ETC.	TOP	BOTTOM	NAME	DEPTH
SAND & SHALE	0	302		
SHALE RED BED	302	1145		
SAND	1145	1350		
SHALE & RED BED	1350	1490		
RED BED	1490	1652		
ANHYDRITE	1652	1694		
SHALE & SHELLS	1694	2075		
SHALE & SAND	2075	2295		
LIME & SHALE	2295	4145		
LIME	4145	4570		
RTD		4570		

USE ADDITIONAL SHEETS, IF NECESSARY, TO COMPLETE WELL RECORD.

Date Received	<i>Phyllis Buchanan</i>
	Signature Phyllis Buchanan, Office Mgr.
	Title
	May 28, 1976
	Date