

STATE OF KANSAS
STATE CORPORATION COMMISSION

WELL PLUGGING RECORD

Give All Information Completely
Make Required Affidavit
Mail or Deliver Report to
Conservation Division
State Corporation Comm.
245 North Water
Wichita, KS 67202

Hodgeman County, Sec. 7 Twp. 22 Rge. 22 E/W
Location as "NE/CNW $\frac{1}{4}$ /SW $\frac{1}{4}$ " or footage from lines
C SE SW

Lease Owner Sun Oil Company
Lease Name Gus Miller Well No. 11
Office Address Box 2039, Tulsa, Oklahoma 74102
Character of Well (Completed as Oil, Gas or Dry Hole)
dry hole

Date Well completed 19
Application for plugging filed 19
Application for plugging approved 19
Plugging commenced September 10 19 77
Plugging completed September 16 19 77
Reason for abandonment of well or producing formation
dry hole

If a producing well is abandoned, date of last production
19

Was permission obtained from the Conservation Division or
its agents before plugging was commenced? yes

Name of Conservation Agent who supervised plugging of this well Clarence Thomas, Jr.
Producing formation Depth to top Bottom Total Depth of Well 4650'
Show depth and thickness of all water, oil and gas formations.

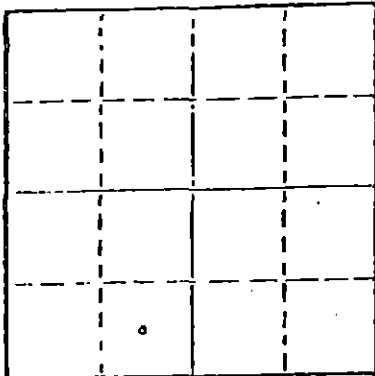

Locate well correctly on above
Section Plat

OIL, GAS OR WATER RECORDS

CASING RECORD

FORMATION	DEPTH	CONTENT	FROM	TO	SIZE	PUT IN	PULLED OUT
			0	566'	8 5/8"	566'	none
				4650'	5 1/2"	4650'	3278.74

CONSERVATION DIVISION
STATE OF KANSAS

Describe in detail the manner in which the well was plugged, indicating where the mud fluid
was placed and the method or methods used in introducing it into the hold. If cement or other
plugs were used, state the character of same and depth placed, from feet to
feet for each plug set.

Welex B plug. Shot off at 4430'. Sanded back to 4400' and dumped 5 sacks
of cement with dump bailer.

Halliburton Services plugged well with 1 plug, 15 sacks of gel and 65 sacks
of cement.

(If additional description is necessary, use BACK of this sheet)

Name of Plugging Contractor PIPE PULLERS, INC.
Box 128, Ellinwood, Kansas 67526

STATE OF KANSAS COUNTY OF BARTON ss.
Evelyn Roth

(employee of owner) or (owner or operator) of the above-described
well, being first duly sworn on oath, says: That I have knowledge of the facts, statements, and matters herein contained and the log of the
above-described well as filed and that the same are true and correct. So help me God.

(Signature) Evelyn Roth

Ellinwood, Kansas

(Address)

Subscribed and Sworn to before me this 21st day of September 19 77

My commission expires

JENNY KASSELMAN
NOTARY PUBLIC
BARTON COUNTY, KANSAS
MY COMM. EXP. JULY 16, 1978

Jenny Kasselmann

Notary Public.

Operator Sun Oil Company DESIGNATE TYPE OF COMP.: OIL, GAS, DRY HOLE, SWDW, ETC.: dry hole

Well No. 11 Lease Name Gus Miller

S 7 T 22N R 22W^E_W

WELL LOG

Show all important zones of porosity and contents thereof; cored intervals, and all drill-stem tests, including depth interval tested, cushion used, time tool open, flowing and shut-in pressures, and recoveries.

SHOW GEOLOGICAL MARKERS, LOGS RUN, OR OTHER DESCRIPTIVE INFORMATION.

FORMATION DESCRIPTION, CONTENTS, ETC.	TOP	BOTTOM	NAME	DEPTH
Alluvium shales & sands	0	566	Stone Corral	1445
Silty sands - red beds & shales	566	820	Heebner	3836
Blaine Gypsum	820	835	Lansing	3894
Red beds & shale	835	1445	Ft. Scott	4350
Stone Corral	1445	1450	Cherokee	4450
Shale & silt	1450	1880	Mississippian	4494
Lime & shale streaks & anhydrite	1880	2230	TD	4650
Shale & lime	2230	2915		
Shale & streaks lime	2915	3240		
Lime & shale	3240	3836		
Shale	3836	3895		
Lime & shale streaks	3895	4650 TD		

USE ADDITIONAL SHEETS, IF NECESSARY, TO COMPLETE WELL RECORD.

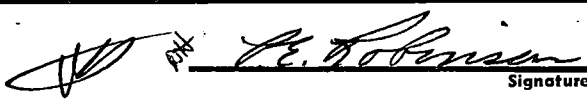
Date Received	
	Signature
	District Engineer
	Title
	11-30-77
	Date

KANSAS DRILLERS LOG

15.083.20532.00.00

Deep

S. 7 T. 22N R. 22W E W

API No. 15 — County — Number

Loc. C SE SW

County Hodgeman

Operator
Sun Oil Company

Address
Box 9697, Tulsa, Oklahoma 74107

Well No. 11 Lease Name Gus Miller

Footage Location
660 feet from ~~SS~~ (S) line 2080 feet from ~~NE~~ (W) line

Principal Contractor DAMAC Drilling Co. Geologist Gene Young

Spud Date 6-1-77 Total Depth 4650' P.B.T.D.

Date Completed 9-17-77 Oil Purchaser P&A 9-17-77

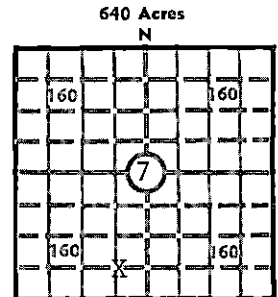

Elev.: Gr. 2275'

DF 2281' KB 2283'

CASING RECORD

Report of all strings set — surface, intermediate, production, etc.

Purpose of string	Size hole drilled	Size casing set (in O.D.)	Weight lbs/ft.	Setting depth	Type cement	Sacks	Type and percent additives
Surface	12 1/4	8 5/8"	24#	566'	Class A 50-50 Poz	360	2% Gel & 2% CaCl
Production	7 7/8	5 1/2"	14#	4650'	Class A 50-50 Poz	250	2% Gel & 18% Salt

RECEIVED
STATE CORPORATION COMMISSION

DEC 05 1977

CONSERVATION DIVISION
Wichita, Kansas

TUBING RECORD

Top, ft.	Bottom, ft.	Sacks cement	Shots per ft.	Size & type	Depth interval
			2	4" DML	4506-08

ACID, FRACTURE, SHOT, CEMENT SQUEEZE RECORD

Amount and kind of material used	Depth interval treated
Pump 150 gallons 15% NE acid	4506-08

INITIAL PRODUCTION

Date of first production P&A 9-17-77	Producing method (flowing, pumping, gas lift, etc.)
RATE OF PRODUCTION PER 24 HOURS	Oil Gas Water Gas-oil ratio
Disposition of gas (vented, used on lease or sold)	Producing interval(s)

INSTRUCTIONS: As provided in KCC Rule 82-2-125, within 90 days after completion of a well, one completed copy of this Drillers Log shall be transmitted to the State Geological Survey of Kansas, 4150 Monroe Street, Wichita, Kansas 67209. Copies of this form are available from the Conservation Division, State Corporation Commission, 3830 So. Meridian (P.O. Box 17027), Wichita, Kansas 66217. Phone AC 316-522-2206. If confidential custody is desired, please note Rule 82-2-125. Drillers Logs will be on open file in the Oil and Gas Division, State Geological Survey of Kansas, Lawrence, Kansas 66044.

15.083.20532.00.00

Operator

Sun Oil Company

DESIGNATE TYPE OF COMP.: OIL, GAS, DRY HOLE, SWDW, ETC.:

Well No.

11

Lease Name

Miller

S 7 T 22 S R 22 W^E W

WELL LOG

Show all important zones of porosity and contents thereof; cored intervals, and all drill-stem tests, including depth interval tested, cushion used, time tool open, flowing and shut-in pressures, and recoveries.

SHOW GEOLOGICAL MARKERS, LOGS RUN, OR OTHER DESCRIPTIVE INFORMATION.

FORMATION DESCRIPTION, CONTENTS, ETC.	TOP	BOTTOM	NAME	DEPTH
Clay & Rock	0	350		
Shale & Clay	350	566		
Shale & RedBed	566	762		
Shale	762	2035		
Lime & Shale	2035	4650RTD		

RECEIVED
STATE CORPORATION COMMISSION
JUL 05 1977
CONSERVATION DIVISION
Wichita, Kansas

USE ADDITIONAL SHEETS, IF NECESSARY, TO COMPLETE WELL RECORD.

Date Received

Signature
Vice President
Title
June 11, 1977
Date