

Give All Information Completely
Make Required Affidavit
Mail or Deliver Report to:
Conservation Division
State Corporation Commission
211 No. Broadway
Wichita, Kansas

WELL PLUGGING RECORD

STAFFORD County. Sec. 7 Twp. 22S Rge. 13 (E) (W)

Location as "NE/CNW/SW" or footage from lines NE NW SE
Lease Owner PETROLEUM, INC.
Lease Name SCHULZ "C" Well No. 1
Office Address R.R. #2, GREAT BEND, KANSAS
Character of Well (completed as Oil, Gas or Dry Hole) DRY HOLE
Date well completed AUG. 20 19 65
Application for plugging filed AUG. 20 19 65
Application for plugging approved AUG. 20 19 65
Plugging commenced AUG. 20 19 65
Plugging completed AUG. 20 19 65
Reason for abandonment of well or producing formation NO PRODUCIBLE ZONE

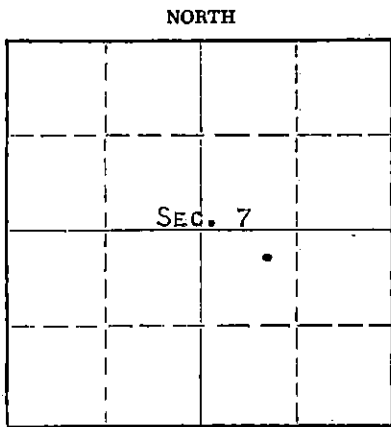

Locate well correctly on above
Section Plat

If a producing well is abandoned, date of last production NONE 19
Was permission obtained from the Conservation Division or its agents before plugging was commenced? YES

Name of Conservation Agent who supervised plugging of this well ARCHIE V. FLYING
Producing formation _____ Depth to top _____ Bottom _____ Total Depth of Well 3435' Feet
Show depth and thickness of all water, oil and gas formations.

OIL, GAS OR WATER RECORDS

CASING RECORD

FORMATION	CONTENT	FROM	TO	SIZE	PUT IN	PULLED OUT
				8-5/8"	313	NONE

Describe in detail the manner in which the well was plugged, indicating where the mud fluid was placed and the method or methods used in introducing it into the hole. If cement or other plugs were used, state the character of same and depth placed, from _____ feet to _____ feet for each plug set.

MUDDED UP WITH HEAVY MUD THROUGH DRILL PIPE TO 300', FOLLOWED WITH WOODEN PLUG, PLACED 25 SACKS CEMENT ON TOP OF PLUG. MUDDED UP WITH HEAVY MUD THROUGH DRILL PIPE TO 40', FOLLOWED BY WOODEN PLUG, PLACED 10 SACKS CEMENT ON TOP OF PLUG TO BASE OF WELL CELLAR.

RECEIVED
STATE CORPORATION COMMISSION
SEP 2 1965
CONSERVATION DIVISION
Wichita, Kansas

(If additional description is necessary, use BACK of this sheet)

Name of Plugging Contractor GARVEY DRILLING CO.
Address R.R. #2, GREAT BEND, KANSAS

STATE OF KANSAS, COUNTY OF BARTON, ss.
MONTE CHADD (employee of owner) or (~~owner~~) of the above-described well, being first duly sworn on oath, says: That I have knowledge of the facts, statements, and matters herein contained and the log of the above-described well as filed and that the same are true and correct. So help me God.

(Signature) Monte Chadd
MONTE CHADD, DIST. PROD. SUPT.
R.R. #2, GREAT BEND, KANSAS
(Address)

SUBSCRIBED AND SWORN to before me this 31 day of AUGUST, 19 65

My commission expires MAY 28, 1969

Richard M. Dumber
Notary Public.



WELL LOG

15-185-30105-0000

COMPANY Petroleum, Inc.

SEC. 7 T. 22S R. 13W

FARM Schulz

NO. C - 1

LOC. NE NW SE

TOTAL DEPTH 3435'

COUNTY Stafford

COMM. 8-14-65

COMP. 8-20-65

CONTRACTOR Garvey Drilling Company

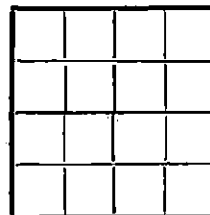

CASING 8 5/8" @ 313' w/310 sx

ELEVATION 1914' DF

PRODUCTION D & A

FIGURES INDICATE BOTTOM OF FORMATIONS

- 298' Clay, Sand, and Shale
- 313' Red Bed
- 771' Red Bed and Shale
- 796' Anhydrite
- 1680' Shale and Shells
- 1800' Shale and Lime
- 2315' Lime with Shale
- 2745' Shale with Lime
- 3421' Lime and Shale
- 3435' Brown Lime
- 3435' RTD

RECEIVED
STATE CORPORATION COMMISSION

SEP 2 1965

CONSERVATION DIVISION
Wichita, Kansas

State of Kansas }
County of Barton } SS

I, Sam N. Stephens of Garvey Drilling Company

upon oath state the above and foregoing is a true and correct copy of the log of the Schulz C-1 well.

Sam N. Stephens

Subscribed and sworn to before me this 30th day of August 19 65

My Commission Expires: May 28, 1969

Richard H. Dumbler
NOTARY PUBLIC