

WELL PLUGGING RECORD

Give All Information Completely  
Make Required Affidavit  
Mail or Deliver Report to:  
Conservation Division  
State Corporation Commission  
211 No. Broadway  
Wichita, Kansas

STAFFORD County.

Sec. 29 Twp. 22 Rge. 13 (X) W (W)

Location as "NE/CNW/SW" or footage from lines SW SW NE

Lease Owner PETROLEUM, INC.

Lease Name STEINEKE "B" Well No. 1

Office Address ROUTE 2, GREAT BEND, KANSAS

Character of Well (completed as Oil, Gas or Dry Hole) DRY HOLE

Date well completed December 4, 19 57

Application for plugging filed December 5, 19 57

Application for plugging approved December 3, 19 57

Plugging commenced December 3, 19 57

Plugging completed December 4, 19 57

Reason for abandonment of well or producing formation No Producing Zones

If a producing well is abandoned, date of last production None 19    

Was permission obtained from the Conservation Division or its agents before plugging was commenced? Yes

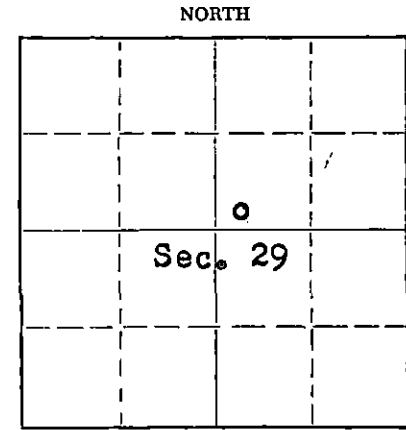

Locate well correctly on above Section Plat

Name of Conservation Agent who supervised plugging of this well Don Truan, Route 1, Russell, Kansas

Producing formation ----- Depth to top --- Bottom --- Total Depth of Well 3913 Feet

Show depth and thickness of all water, oil and gas formations.

OIL, GAS OR WATER RECORDS

CASING RECORD

FORMATION	CONTENT	FROM	TO	SIZE	PUT IN	PULLED OUT
				8-5/8"	279'	None

Describe in detail the manner in which the well was plugged, indicating where the mud fluid was placed and the method or methods used in introducing it into the hole. If cement or other plugs were used, state the character of same and depth placed, from \_\_\_\_\_ feet to \_\_\_\_\_ feet for each plug set.

Mud up with heavy mud to 275', pushed down 1/2 sack hulls to 275' followed by wooden plug. Placed 25 sacks cement through drill pipe on to plug. Mud up to 40' and placed 1/2 sack hulls at 40' followed by wooden plug and 10 sacks cement to base of well cellar.

RECEIVED  
DEC 12 1957  
CONSERVATION DIVISION

12-12-57

(If additional description is necessary, use BACK of this sheet)  
Name of Plugging Contractor Garvey Drilling Company  
Address Route 2, Great Bend, Kansas

STATE OF KANSAS, COUNTY OF BARTON, ss.  
Don Searle (employee of owner) or (owner) of the above-described

well, being first duly sworn on oath, says: That I have knowledge of the facts, statements, and matters herein contained and the log of the above-described well as filed and that the same are true and correct. So help me God.

(Signature) Don Searle

Route 2, Great Bend, Kansas  
(Address)

SUBSCRIBED AND SWORN TO before me this 11th day of December, 19 57

Ed. T. Brown  
Notary Public.

My commission expires July 11, 1960

PLUGGING  
FILED EQ-29T-22R-134  
BOOK PAGE 66-11 E-32

# WELL LOG

15.185.00698.0000

COMPANY PETROLEUM, INCORPORATED

SEC. 29 T. 22S R. 13W

FARM STEINEKE "B" NO. 1

LOC. SW, SW, NE

TOTAL DEPTH 3913'

COUNTY Stafford Co., Kansas

COMM. November 23, 1957 COMP. December 4, 1957

CONTRACTOR GARVEY DRILLING COMPANY

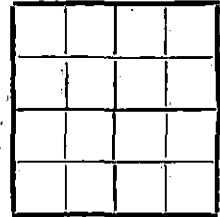

CASING 8 5/8" @ 279' W/225 sax,

ELEVATION 1907' DF

PRODUCTION D & A

FIGURES INDICATE BOTTOM OF FORMATIONS

280	Surface soil & sand
290	Shale
480	Red bed
1300	Red bed, shale & shells
1600	Shale
1695	Lime & shale
2395	Lime
2555	Shale & lime
2995	Shale
3285	Lime & shale
3330	Lime
3430	Shale
3503	Shale & lime
3670	Lime
3715	Lime & conglomerate
3884	Simpson
3913	Dolomite
3913	T. D.

RECEIVED  
STATE CONSERVATION COMMISSION  
DEC 12 1957  
CONSERVATION DIVISION  
Wichita, Kansas

PLUGGING  
FILE SEC. 29 T. 22 R. 13W  
BOOK PAGE 66 LINE 32

State of KANSAS }  
County of BARTON } SS:

I, VERNE A. MORRIS of GARVEY DRILLING CO.

upon oath state that the above and foregoing is a true and correct copy of the log of the #1 Steineke "B" well

Verne A. Morris

Subscribed and sworn to before me this 9th day of December 19 57

My Commission Expires: July 11, 1960

Ed A. Brown  
NOTARY PUBLIC