

15-55-02293-0000

STATE OF KANSAS
STATE CORPORATION COMMISSION

WELL PLUGGING RECORD

Give All Information Completely
Make Required Affidavit
Mail or E-mail Report to:
Conservation Division
State Corporation Commission
800 Bitting Building
Wichita, Kansas

Reno County, Sec. 32 Twp. 23S Rge. 10 (E) (W)

Location as "NE/CNW/SW" or footage from lines SW NE NW

Lease Owner Magnolia Petroleum Company

Lease Name Jean Johnson Well No. 4

Office Address Box 770, Great Bend, Kansas

Character of Well (completed as Oil, Gas or Dry Hole) Gas

Date well completed 5-15-44 19

Application for plugging filed 4-8-53 19

Application for plugging approved 4-9-53 19

Plugging commenced 4-22-53 19

Plugging completed 5-4-53 19

Reason for abandonment of well or producing formation All wells on lease are being plugged & abandoned.

If a producing well is abandoned, date of last production Non-Producing 19

Was permission obtained from the Conservation Division or its agents before plugging was commenced? Yes

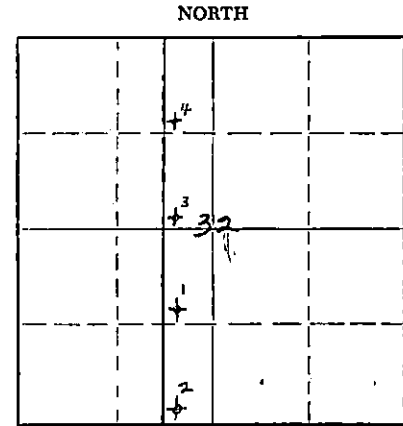

Locate well correctly on above Section Plat

Name of Conservation Agent who supervised plugging of this well Mr. R. Durkee

Producing formation Viola Dolomite Depth to top 3663 Bottom 3668 Total Depth of Well 3678 Feet

Show depth and thickness of all water, oil and gas formations.

OIL, GAS OR WATER RECORDS

CASING RECORD

FORMATION	CONTENT	FROM	TO	SIZE	PUT IN	PULLED OUT
Misoner Sand	No shows	3645	3649	10 3/4	282	None
Viola Lime	No shows	3649	3663	5 1/2	3663	1800
Viola Dolomite	Oil Show & Gas	3663	3668			

Describe in detail the manner in which the well was plugged, indicating where the mud fluid was placed and the method or methods used in introducing it into the hole. If cement or other plugs were used, state the character of same and depth placed, from _____ feet to _____ feet for each plug set.

Pumped in mud & killed gas well; ran sand to 3650'; dumped 6 sx cmnt; loaded hole with water, had 12 inches tension @ 50,000#; shot pipe @ 2900', 2800', 2761', pipe parted; pulled out pipe; put on overshot, ran pipe back in hole, couldn't get hold of pipe, pulled pipe out of hole, put on another overshot, got hold of pipe, circulated well, spotted oil; pulled pipe into, went back in with big overshot; got hold of pipe; shot pipe @ 1800', worked it loose, mudded hole, set bridge @ 225', ran 20sx cmnt, mudded hole, ran 5 sx cmnt to base of cellar. All mudding & plugging done as per Mr. Durkee, State Plugger.

5-15-53

RECEIVED
STATE CORPORATION COMMISSION
MAY 15 1953

CONSERVATION DIVISION
Wichita, Kansas

Name of Plugging Contractor Standard Pulling Company
Address Lyons, Kansas

STATE OF Kansas COUNTY OF Barton, ss.
C. A. Hill, Dist. Sup't. (employee of owner) or (owner or operator) of the above-described well, being first duly sworn on oath, says: That I have knowledge of the facts, statements, and matters herein contained and the log of the above-described well as filed and that the same are true and correct. So help me God.

(Signature) [Signature]
Box 770, Great Bend, Kansas
(Address)

SUBSCRIBED AND SWORN TO before me this 12th day of May 19 53
Harriett S. Kaiser
Notary Public.

My commission expires 1-14-57

PLUGGING
FILE SEC 32T 23 R 10 W
BOOK PAGE 21 LINE 14

WELL LOG

15-55-62293-0000

Jean JOHNSON #4
SW NE SectionRENO County
Sec. 32-23-10W

Chase District State of Kansas

Drilling commenced
Drilling CompletedMarch 31, 1944
May 15, 1944

Kansas Drilling Tools

10 3/4" 35.75# 8 Thd Lapweld New Casing	282
5 1/2" 14# 8 Rd Thd H40 R2 Seam. New Casing	3363
2" 4.7# 8 Rd Thd H40 R2 Seam. New Casing	3676

Cem w/275 Sx
Cem w/150 sx

Elevation: 1786'

FORMATION:

Clay	0	30
Sand	30	100
Red Bed Shells	100	289
10 3/4" Csg set @ 282 w/275 sx cem		
Shale & Shells	289	1895
Broken Lime	1895	2000
Shale & Lime	2000	2335
Shale	2335	2650
Shale & Shells	2650	2780
Shale	2780	2880
Shale & Lime	2880	3355
Lime	3355	3630
Lime & Shale	3630	3645
Top Misener Sand	3645	
Misener Sand	3645	3649
Top Viola Lime	3649	
Viola Lime	3649	3658
Top Viola Cherty Lime	3658	
Viola Cherty Lime	3658	3663
Top Viola Dolomite	3663	
Viola Dolomite	3663	3668
5 1/2" Csg set @ 3663 w/150 sx cem		

Loaded hole with 1500' water, drilled plug & c/o to 3668, drilled Viola Dolomite 3668 - 3672, flowed 12 hrs thru 5 1/2" csg, 12,000,000 cu ft gas - no oil, tools hung up, fished out tools, killed well, drilled Viola Dolomite 3672 - 3678, run 2" tub, swabbed water load out, acidized w/2000 gals, flowed in pits 64 hrs to clean up well. Test thru csg 15,730,000 cu ft w/625# back pressure, eff 5/15/44. TD SLM 3678

RECEIVED
STATE CORPORATION COMMISSION
MAY 15 1953
CONSERVATION DIVISION
Wichita, Kansas

PLUGGING
FILE SEC 32-23 R 10W
BOOK PAGE 21 LINE 14