

15-155-62292-0008

STATE OF KANSAS
STATE CORPORATION COMMISSION

WELL PLUGGING RECORD

Give All Information Completely
Make Required Affidavit
Mail or Deliver Report to:
Conservation Division
State Corporation Commission
800 Bitting Building
Wichita, Kansas

Reno County, Sec. 32 Twp. 23S Rge. 10 (W)

Location as "NE/CNW/SW" or footage from lines SW SE NW
Lease Owner Magnolia Petroleum Co.
Lease Name Jean JOHNSON Well No. 3
Office Address Box 770 Great Bend, Kansas
Character of Well (completed as Oil, Gas or Dry Hole) Oil
Date well completed 3-22-44 19
Application for plugging filed 12-22-52 19
Application for plugging approved 12-23-52 19
Plugging commenced 1-23-53 19
Plugging completed 2-2-53 19
Reason for abandonment of well or producing formation No production - depleted

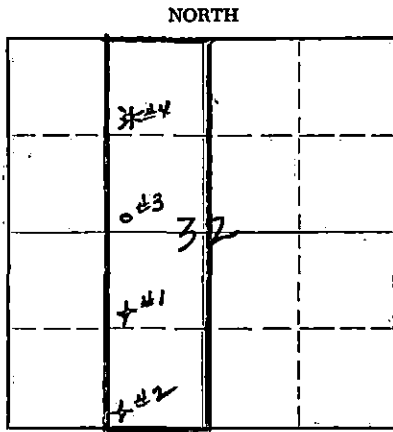

Locate well correctly on above Section Plat

If a producing well is abandoned, date of last production 9-1-52 19
Was permission obtained from the Conservation Division or its agents before plugging was commenced? Yes

Name of Conservation Agent who supervised plugging of this well Mr. R. Durkee, State Pluggor
Producing formation Viola Lime Depth to top 3682 Bottom 3693 Total Depth of Well 3693 Feet
Show depth and thickness of all water, oil and gas formations.

OIL, GAS OR WATER RECORDS

CASING RECORD

FORMATION	CONTENT	FROM	TO	SIZE	PUT IN	PULLED OUT
Viola Lime	Oil	3682	3693	10-3/4	278	None
				5-1/2	3682	1712' 8"

Describe in detail the manner in which the well was plugged, indicating where the mud fluid was placed and the method or methods used in introducing it into the hole. If cement or other plugs were used, state the character of same and depth placed, from _____ feet to _____ feet for each plug set.

Ran sand to 3675'; dumped 6 sx cmnt, worked pipe @ 45,000#, got 16" tension, shot csg @ 3074', 2993', 2820', got mud & tried to circulate well; used 20 sx mud & 10 sx hulls, filled up to 1100# pressure, did not get returns, spotted 2 tanks oil, shot csg @ 2458, 2363, 2201, 2169, 2083, 1994, 1929, 1867, 1802, 1767, 1717; got loose, mudded hole. Set bridge plug @ 240', ran 20 sx cmnt, mudded hole, ran 5 sx cmnt to base of cellar.

All mudding & plugging done as per Mr. R. Durkee, State Pluggor.

(If additional description is necessary, use BACK of this sheet)

Name of Plugging Contractor Standard Pulling Co.
Address Lyons, Kansas

STATE OF KANSAS, COUNTY OF BARTON, ss.
C. A. HILL (employee of owner) Operator of the above-described well, being first duly sworn on oath, says: That I have knowledge of the facts, statements, and matters herein contained and the log of the above-described well as filed and that the same are true and correct. So help me God.

(Signature) [Signature]
Box 770 - Great Bend, Kansas
(Address)

SUBSCRIBED AND SWORN TO before me this 9th day of February, 19 53

My commission expires Jan. 14, 1957

Harriett S. Kassel
Notary Public.

RECEIVED
STATE CORPORATION COMMISSION

FEB 10 1953 2-10-53

CONSERVATION DIVISION
Wichita, Kansas

PLUGGING
FILE SEC. 32 T. 23 R. 10
BOOK PAGE 67 LINE 36

WELL LOG

15-55-02292-0000

JEAN JOHNSON # 3

Reno County, Kansas

SW SE NW Sec 32-23S-10W

Elevation 1786'

Mast commenced	2-29-44	
Mast completed	3-1-44	Kansas Drilling Tools
Drilling commenced	3-2-44	ditto
Drilling completed	3-22-44	

10-3/4" 35.75# Beth Lapweld - new	278'	w/275 sx cmnt
5-1/2" 14# 8 rd thd H40 R2 Seam - new	3682'	w/150 sx cmnt
2" 4.7# 8 rd thd H40 R2 Seam - new	3691'	

FORMATION

Clay & Sand	0	115
Red bed	115	278
10-3/4" Csg set	278	
Shale & red bed	278	945
Shale & shells	945	1460
Lime & shale	1460	1705
Lime	1705	1760
Lime & sandy shale	1760	1875
Lime	1875	2010
Lime & shale	2010	2090
Shale	2090	2200
Shale & shells	2200	2430
Shale	2430	2520
Shale & lime	2520	2670
Shale	2670	2735
Lime & shale	2735	2935
Lime	2935	3160
Shale & lime	3160	3260
Lime	3260	3315
Sandy lime	3315	3365
Show oil	3340	
Shale & lime	3365	3430
Lime	3430	3570
Lime, shale, chert	3570	3630
Lime & shale	3630	3661
Top Misener sand	3661	
Misener sand	3661	3666
Top Viola Lime	3666	
Viola Lime	3666	3677
Viola cherty lime	3677	3682
Viola Dolomite	3682	3684
Show oil	3684	
5-1/2" Csg set	3682	

Standardized

Loaded hole 2000' wtr before drilling out plug. Drld plug. Drld Viola Dolomite 3684-3693'. Soft zone 3690 - 93'. Unloaded hole. Flowed 12 hrs thru csg. Making 4 bbl oil/hr - no wtr. Gas tested 860,000 Cu. ft. Run 2" tubing after killing well. Acidized w/2000 gals. Potential by BHPG flowing 3000 bbl max. Eff 3-28-44. Gas/oil ratio 3204 to 1. TD - SLM 3693'.

Hole Surveys: OK 325-600-1000-1250-1510-1785-2050-2350-2760-3040-3585

Acidization Record: Acidized by Chemical Process Co on 3-25-44 thru 2" tubing w/2000 gals. Used 120 bbl oil. Max pressure 800#. Finished on 20 pts. vacuum.

PLUGGING
 FILE SEC 32 T 23 R 10
 BOOK PAGE 67 LINE 36

RECEIVED
 STATE CORPORATION COMMISSION
 FEB 1 1944
 CONSERVATION DIVISION
 Wichita, Kansas