

STATE OF KANSAS  
STATE CORPORATION COMMISSION

Form CP-4

WELL PLUGGING RECORD

Give All Information Completely  
Make Required Affidavit  
Mail or Deliver Report to:  
Conservation Division  
State Corporation Commission  
212 No. Market  
Wichita, Kansas

STAFFORD County. Sec. 9 Twp. 22S. Rge. 14 (E) (W)

Location as "NE/CNW&SW&" or footage from lines SE SW NW

Lease Owner PETROLEUM, INC.

Lease Name STROBEL 'A' Well No. 1

Office Address R.R. #2, GREAT BEND, KANSAS

Character of Well (completed as Oil, Gas or Dry Hole) PILOT FLOOD INJECTION WELL

Date well completed OCTOBER 16 19 52

Application for plugging filed OCTOBER 5 19 67

Application for plugging approved OCTOBER 9 19 67

Plugging commenced OCTOBER 19 19 67

Plugging completed OCTOBER 23 19 67

Reason for abandonment of well or producing formation DISCONTINUE USE OF INJECTION WELL FOR PILOT FLOOD

If a producing well is abandoned, date of last production OCTOBER 1 19 67

Was permission obtained from the Conservation Division or its agents before plugging was commenced? YES

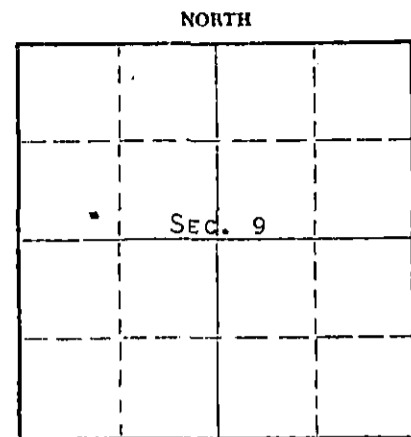

Locate well correctly on above Section Plat

Name of Conservation Agent who supervised plugging of this well ARCHIE ELVING

Producing formation KC Depth to top Bottom Total Depth of Well 3877' Feet

Show depth and thickness of all water, oil and gas formations.

OIL, GAS OR WATER RECORDS

CASING RECORD

FORMATION	CONTENT	FROM	TO	SIZE	PUT IN	PULLED OUT
WATER INJECTION L-KC	WATER	3598'	3640'	8-5/8"	220'	NONE
				5-1/2"	3876'	2774'

Describe in detail the manner in which the well was plugged, indicating where the mud fluid was placed and the method or methods used in introducing it into the hole. If cement or other plugs were used, state the character of same and depth placed, from feet to feet for each plug set.

PLUGGED BACK TOTAL DEPTH 3688' - SET PLUG @ 3550', RUN 5 SACKS CEMENT FROM 3550' TO 3520'. PUMPED 10 SACKS OF GEL MUD AND 80 SACKS OF CEMENT TO BASE OF WELL CELLAR.

Stamp: OCT 30 1967  
10-30-67  
CONSERVATION DIVISION  
WICHITA, KANSAS

(If additional description is necessary, use BACK of this sheet)

Name of Plugging Contractor GLENN & SMITH PIPE PULLING Co.

Address Box 156, ELLINWOOD, KANSAS

STATE OF KANSAS, COUNTY OF BARTON, ss.

MONTE CHADD (employee of owner) or (owner or operator) of the above-described well, being first duly sworn on oath, says: That I have knowledge of the facts, statements, and matters herein contained and the log of the above-described well as filed and that the same are true and correct. So help me God. MONTE CHADD, DIST. PROD. SUPT.

(Signature) [Signature]

R.R. #2, GREAT BEND, KANSAS (Address)

SUBSCRIBED AND SWORN TO before me this 26 day of OCTOBER, 19 67

[Signature] Notary Public.

My commission expires MAY 28, 1969

COPY

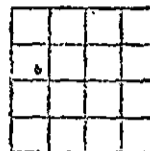
WELL LOG BUREAU—KANSAS GEOLOGICAL SOCIETY  
508 East Murdock, Wichita, KansasCompany- PETROLEUM, INC.  
Farm- Strobel "A" No. 1SEC. 9 T. 22 R. 14W  
SE SW NWTotal Depth. 3877  
Comm. 9-24-52 Comp. 10-5-52  
Shot or Treated.  
Contractor. Garvey Drilling Co.  
Issued. 12-6-52County Stafford  
KANSAS

Elevation. 1918

Production. 427 BO &amp; NW

Figures indicate Bottom of Formations.

surface oil	30
sand & clay	160
sand & gravel	180
shale & shells	220
shale	260
red bed	833
anhydrite	865
shale & shells	1700
lime & shale	3169
lime	3341
lime & shale	3433
shale	3464
lime	3770
chert	3812
shale	3872
lime	3877 RTD
Total Depth	

Tops:	
Heebner	3342
Lansing	3474
Arbuckle	3872

DST: #1 3593-3610' open  
1 hr. rec. 65' slightly  
oil cut mud, 90' very  
heavily oil cut mud, 30'  
watery oil cut mud, 1110#  
BHP

DST: #2 3626-42' open 30  
mins. rec. 10' mud no BHP

DST: #3 3657-3700' open 1 hr.  
rec. 895' free oil 360' froggy  
gasy oil BHP 1290#.

DST: #4 3874-77' open 1 hr.  
rec. 6' mud 50# BHP.

RECEIVED  
STATE CORPORATION COMMISSION

OCT 30 1967

CONSERVATION DIVISION  
Wichita, Kansas