

15-155-20586-0000

STATE OF KANSAS
STATE CORPORATION COMMISSION

WELL PLUGGING RECORD

Give All Information Completely
Make Required Affidavit
Mail or Deliver Report to
Conservation Division
State Corporation Comm.
245 North Water
Wichita, KS 67202

Reno County. Sec. 18 Twp. 22S Rge. 9W ~~E/W~~
Location as "NE/CNW 1/4 SW 1/4" or footage from lines
SE SE NE

Lease Owner Equitx Energy Corporation
Lease Name Wisby #1 Well No. 1
Office Address P. O. Box 707, Rockwall, Texas 75087
Character of Well (Completed as Oil, Gas or Dry Hole)
Dry Hole

Date Well completed November 12, 1979 19
Application for plugging filed November 12, 1979 19
Application for plugging approved November 12, 1979 19
Plugging commenced 3:30 PM November 12, 1979 19
Plugging completed 4:30 PM November 12, 1979 19
Reason for abandonment of well or producing formation
Dry Hole

If a producing well is abandoned, date of last production 19

Was permission obtained from the Conservation Division or its agents before plugging was commenced? Yes

Name of Conservation Agent who supervised plugging of this well Gilbert Toman
Producing formation _____ Depth to top _____ Bottom _____ Total Depth of Well 2052'
Show depth and thickness of all water, oil and gas formations.

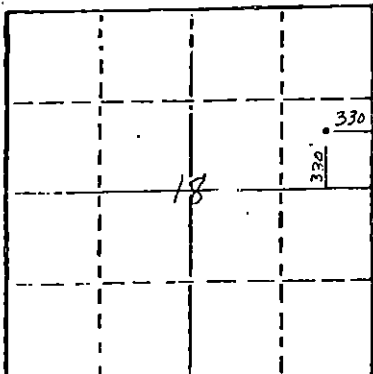

Locate well correctly on above Section Plat

OIL, GAS OR WATER RECORDS

CASING RECORD

FORMATION	CONTENT	FROM	TO	SIZE	PUT IN	PULLED OUT
				7"	198.48'	None

Describe in detail the manner in which the well was plugged, indicating where the mud fluid was placed and the method or methods used in introducing it into the hold. If cement or other plugs were used, state the character of same and depth placed, from _____ feet to _____ feet for each plug set.

Filled hole with heavy mud.
15 sacks at 190', heavy mud with
solid plug, 1/2 sack hulls to 40',
5 sacks cement.

12-13-79

RECEIVED
STATE CORPORATION COMMISSION
DEC 13 1979

(If additional description is necessary, use BACK of this sheet)

Name of Plugging Contractor Sterling Drilling Company, P. O. Box 129, Sterling, Kansas 67579

STATE OF KANSAS COUNTY OF RICE, ss.
E. A. Wuellner (employee of owner) or (owner or operator)
of the above-described well, being first duly sworn on oath, says: That I have knowledge of the facts, statements, and matters herein contained and the log of the above-described well as filed and that the same are true and correct. So help me God.

(Signature) E. A. Wuellner
STERLING DRILLING COMPANY
F. A. Wuellner, Secretary
P. O. Box 129, Sterling, Kansas 67579
(Address)

SUBSCRIBED AND SWORN TO before me this 14th day of November, 1979.

My commission expires _____

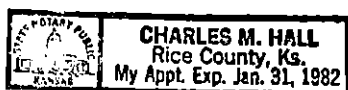

Charles M. Hall
Charles M. Hall, Notary Public.

STERLING DRILLING COMPANY
P. O. Box 129
Sterling, Kansas 67579

WELL LOG - - - - - WISBY #1
Located: SE SE-NE, Section 18-22S-9W, Reno County,
Kansas

OWNER: Equitx Energy Corporation
ROTARY DRILLING CONTRACTOR: Sterling Drilling Company

COMMENCED: November 2, 1979
COMPLETED: November 12, 1979

TOTAL DEPTH: 2052'

LOG

0 - 203' Shale and Sand
203' - 1683' Shale
1683 - 2052' Lime and Shale

CASING RECORD

Ran 5 joints 7", 20# new OD casing, 197.48'
set at 198.48' G.L. Cemented with 200 sacks
Class H with 2% gel and 3% cc. Plug down at
6:30 PM, 11-2-79, by Dowell.

Plugged.

Deviation Surveys: 1/2° at 1460'
3/4° at 1633'

RECEIVED
STATE GEOLOGICAL COMMISSION
DEC 4 1979
DIVISION