

Sec 1-23-12

15-185-12327-0000

STATE OF KANSAS
STATE CORPORATION COMMISSION

WELL PLUGGING RECORD

OR
FORMATION PLUGGING RECORD

Strike out upper line when reporting plugging of formations.

Give All Information Completely
Make Required Affidavit
Mail or Deliver Report to:
Conservation Division
State Corporation Commission
800 Bitting Building
Wichita, Kansas

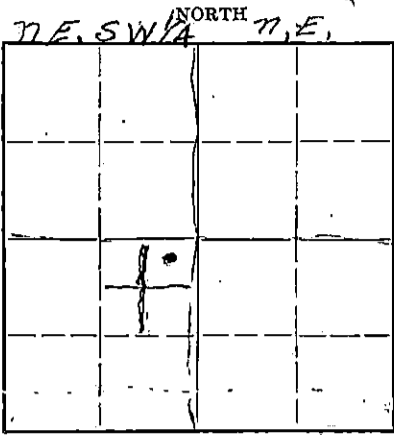

Locate well correctly on above Section Plat

Stafford County, Sec. 1 Twp. 23. Rge. 12 (E) (W)
Location as "NE 1/4 NW 1/4 SW 1/4" or footage from lines 2310' from W.L. 2310' from S. Line
Lease Owner Auto-ordnance corp
Lease Name Hill Well No. 1
Office Address 507 Union Natl. Bank Bldg. Wichita Kans
Character of Well (completed as Oil, Gas or Dry Hole) Dry hole
Date well completed 2-2 1943
Application for plugging filed 2-2 19
Application for plugging approved 2-2 19
Plugging commenced 2-2 19
Plugging completed 2-2 19
Reason for abandonment of well or producing formation dry hole
If a producing well is abandoned, date of last production 19
Was permission obtained from the Conservation Division or its agents before plugging was commenced? Yes

Name of Conservation Agent who supervised plugging of this well Mr. Alexander Great Bend Kans
Producing formation Arkuckle dolomite depth to top 36.98' Bottom 3730' Total Depth of Well 3730 Feet
Show depth and thickness of all water, oil and gas formations.

OIL, GAS OR WATER RECORDS

CASING RECORD

Formation	Content	From	To	Size	Put In	Pulled Out

Describe in detail the manner in which the well was plugged, indicating where the mud fluid was placed and the method or methods used in introducing it into the hole. If cement or other plugs were used, state the character of same and depth placed, from feet to feet for each plug set.

Well was pumped Full heavy Rotary mud to within 260' of top of hole. 6' Wood Plug was then set at 260' and 10 sacks of cement was placed on top of Wood Plug. Heavy Rotary mud then pumped to within 40' of top of hole and another 6' Wood Plug set. 9 sacks of cement was placed on top of Wood Plug filling hole 1' above base of casing which was 5' below ground level.

FILE 1-23-12
BOOK PAGE 63 LINE 24

3-9-43

(If additional description is necessary, use BACK of this sheet)

Correspondence regarding this well should be addressed to Auto-ordnance corp,
Address 507 Union Natl. Bank Bldg. Wichita Kans

STATE OF Kansas, COUNTY OF Stafford, ss.

E. K. Edmiston (employee of owner) of the above-described well, being first duly sworn, on oath, says: That I have knowledge of the facts, statements, and matters herein contained and the log of the above-described well as filed and that the same are true and correct. So help me God.

(Signature) E. K. Edmiston
517 Union Natl Bank Bldg, Wichita, Kans (Address)

Subscribed and Sworn to before me this 11th day of February, 1943

My commission expires Feb. 21, 1946

Notary Public.



AUTO-ORDNANCE CORP.
 Hill No. 1.

SEC.1 T.23 R.12 W
 NEc SW

Total Depth. 3730'
 Comm. 1-15-43 Comp. 2-1-43
 Shot or Treated.
 Contractor. Rocket Drlg. Co.
 Issued. 3-6-43

County. Stafford

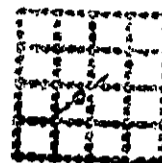

CASING:
 8 5/8" 256'

Elevation.

Production. Dry

Figures Indicate Bottom of Formations.

surface clay	0-10
sand	26
shale	60
sand	145
shale	262
shale blue	272
sand	282
red rock	575
anhydrite	592
shale & red rock	805
shale & lime	1015
shale & shells	1100
salt & shale	1260
shale & sdy lime	1400
shale	1510
shale & lime	1720
shale	1770
lime	1811
lime & shale	1871
lime brkn	1890
lime	1910
lime & shale	1978
lime	2053
lime & shale	2400
shale	2555
shale & lime	2662
shale	2730
lime brkn	2828
shale	2871
lime	3023
lime brkn	3088
lime	3163
shale	3222
shale & lime	3274
lime	3278
shale	3310
lime & shale	3315
lime (K.C.)	3329
lime	3577
shale	3585
conglomerate cherty	3621
chat	3645
shale Simpson	3698
dolomite	3700
lime Arbuckle	3730
Total Depth.	

Tops:	
Lansing	3315
Cherty Conglomerate	3585
Viola	None ??
Simpson	3645
Arbuckle	3700

FILE 1 23 12W
 ECLD 63 24

