

15-185-10114-0000

STATE OF KANSAS
STATE CORPORATION COMMISSION

WELL PLUGGING RECORD

Give All Information Completely
Make Required Affidavit
Mail or Deliver Report to:
Conservation Division
State Corporation Commission
800 Bittling Building
Wichita, Kansas

Stafford County, Sec. 29 Twp. 23S Rge. (E) 12 (W)

Location as "NE/CNW $\frac{1}{4}$ SW $\frac{1}{4}$ " or footage from lines NW/4 SW/4 NE/4
Lease Owner Skelly Oil Company
Lease Name Z. E. Riley Well No. 3
Office Address Box 1650, Tulsa, Oklahoma
Character of Well (completed as Oil, Gas or Dry Hole) Dry Hole
Date well completed January 17, 19 51
Application for plugging filed January 17, 19 51
Application for plugging approved January 19, 19 51
Plugging commenced January 17, 19 51
Plugging completed January 18, 19 51
Reason for abandonment of well or producing formation Dry Hole

NORTH

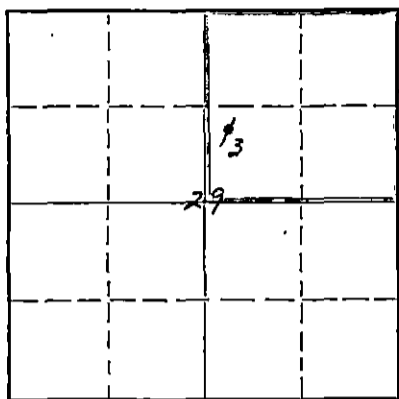

Locate well correctly on above Section Plat

If a producing well is abandoned, date of last production 19
Was permission obtained from the Conservation Division or its agents before plugging was commenced? Yes (verbally)

Name of Conservation Agent who supervised plugging of this well Mr. C. D. Stough

Producing formation Depth to top Bottom Total Depth of Well 3910 Feet

Show depth and thickness of all water, oil and gas formations.

OIL, GAS OR WATER RECORDS

CASING RECORD

Formation	Content	From	To	OD Size	Put In	Pulled Out
Arbuckle Lime	Dry	3873'	3910'	8-5/8"	674' 0"	None

Describe in detail the manner in which the well was plugged, indicating where the mud fluid was placed and the method or methods used in introducing it into the hole. If cement or other plugs were used, state the character of same and depth placed, from feet to feet for each plug set.

40 sacks of cement 3910' to 3790'
Mud laden fluid 2790' to 300'
15 sacks of cement 300' to 255'
Mud laden fluid 255' to 35'
10 sacks of cement 35' to 5'
Surface soil 5' to 0'

1-27-51
RECEIVED
STATE CORPORATION COMMISSION
JAN 27 1951
CONSERVATION DIVISION
Wichita, Kansas

(If additional description is necessary, use BACK of this sheet)

Correspondence regarding this well should be addressed to Skelly Oil Company
Address Box 391
Hutchinson, Kansas

STATE OF Kansas, COUNTY OF Reno, ss.

H. E. Wamsley (employee of owner or operator) of the above-described well, being first duly sworn on oath, says: That I have knowledge of the facts, statements, and matters herein contained and the log of the above-described well as filed and that the same are true and correct. So help me God.

(Signature)

Box 391, Hutchinson, Kansas (Address)

SUBSCRIBED AND SWORN to before me this 25th day of January, 19 51

My commission expires April 7, 1951

Japhine L. Johnson
Notary Public.

PLUGGING
FILE SEC 29 T 23 R 12 W
BOOK PAGE 56 LINE 28

SKELLY OIL COMPANY

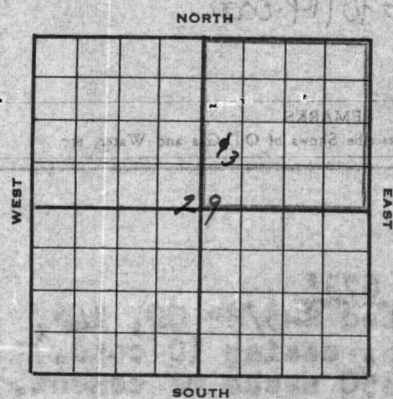

Well Record

Lease Name and No. **Z. E. Riley #37935** Well No. **3** Elev. **1866' DP**
 Lease Description **NE/4 of Section 29-238-12N, Stafford County, Kansas**
 Location made **December 30, 1950** by **Keith Fuller**
 feet from North line **990** feet from East line **NE/4**
 feet from South line **330** feet from West line of **Sec. 29**

Work com'd **12/31** 19 **50** Rig comp'd **1/4** 19 **51** Drlg. com'd **1/4** 19 **51** Drlg. comp'd **1/17** 19 **51**
 Rig Contractor **Claude Wentworth Drilling Company**
 Drilling Contractor **Claude Wentworth Drilling Co., Inc., Tulsa, Oklahoma**
 Rotary Drilling from **0'** to **3910'** Cable Tool Drilling from _____ to _____

Commenced Producing **DRY HOLE** 19 _____ Initial Prod. before shot or acid _____ Bbls.
 Initial Prod. after shot or acid _____ Bbls.
 Dry Gas Well Press. _____ Volume _____ Cu. ft.
 Casing Head Gas Pressure _____ Volume _____ Cu. ft.
 Braden Head (_____ Size) Gas Pressure _____ Volume _____ Cu. ft.
 Braden Head (_____ Size) Gas Pressure _____ Volume _____ Cu. ft.

PRODUCING FORMATION **DRY HOLE** (Name) Top Bottom TOTAL DEPTH **3910'**

CASING RECORD

OD	Size	Wt.	Thds.	Where Set	PULLED OUT			LEFT IN			KIND	Cond'n	CEMENTING	
					Jts.	Feet	In.	Jts.	Feet	In.			Sacks Used	Method Employed
	8-5/8"	24	PE	680'				17	674	0	R3 SS	0	350	Halliburton
(8-5/8" casing set 6' in cellar)														

Liner Set at _____ Length _____ Perforated at _____
 Liner Set at _____ Length _____ Perforated at _____
 Packer Set at _____ Size and Kind _____
 Packer Set at _____ Size and Kind _____

SHOT OR ACID TREATMENT RECORD

	FIRST	SECOND	THIRD	FOURTH
Date				
Acid Used				
Size Shot		Gals. Qts.	Gals. Qts.	Gals. Qts.
Shot Between	Ft. and Ft.	Ft. and Ft.	Ft. and Ft.	Ft. and Ft.
Size of Shell				
Put in by (Co.)				
Length anchor				
Distance below Cas'g				
Damage to Casing or Casing Shoulder				

SIGNIFICANT GEOLOGICAL FORMATIONS

NAME	Top	Bottom	GAS		OIL		REMARKS
			From	To	From	To	
Heebner Shale	3249'						STATE OF KANSAS JAN 27 1951 CONSERVATION DIVISION Wichita, Kansas
Topeka Lime	3269'						
Douglas	3292'						
Brown Lime	3386'						
Lansing Lime	3415'						
Conglomerate	3691'						
Viola Lime	3736'						
Simpson Shale	3811'						
Arbuckle Lime	3873'						

CLEANING OUT RECORDS

	DATE COMMENCED	DATE COMPLETED	PROD. BEFORE	PROD. AFTER	REMARKS
1st					See Reverse for other details.
2nd					" " " " "
3rd					" " " " "
4th					" " " " "

PLUGGING BACK AND DEEPENING RECORDS

	Date Commenced	Date Completed	No. Feet Plugged Back or Deepened	Prod. Before	Prod. After	REMARKS
1st						See Reverse for other details.
2nd						" " " " "
3rd						" " " " "
4th						" " " " "

(See Reverse for Record of Formation)

RECORD OF FORMATIONS

15-1851014-0000

FORMATION	TOP	BOTTOM	REMARKS
Surface soil and clay	0	30	
Sand	30	135	
Shells	135	275	
Red bed and shells	275	673	
Anhydrite	673	680	TOP ANHYDRITE 673'
Anhydrite	680	705	Set and cemented 8-5/8" OD, 24' P.H., 3, S.S. casing (C cond.) at 680' with 350 sacks of cement. Cement circulated.
Red bed and shale	705	850	
Shale	850	960	
Shale and shells	960	1775	
Shale and lime	1775	1875	
Lime	1875	2050	
Lime and shale	2050	3025	
Lime	3025	3335	
Lime and shale	3335	3472	
Lime and chert	3472	3560	
Lime	3560	3640	
Lime and shale	3640	3685	
Lime	3685	3770	
Chert	3770	3795	
Lime and chert	3795	3873	
Medium coarse crystalline dolomite	3873	3878	Slight stain
Buff, fine to coarse crystalline dolomite	3878	3910	Run Halliburton drill stem test, packer set at 3874', open 1 hour, recovered 20' sulphur water, no show off. BH-808.

TOTAL DEPTH 3910'

Since there were no commercial quantities of oil or gas encountered in drilling to the total depth of 3910', regular authority was granted to plug the well.

SHOT OR ACID TREATMENT RECORD

On January 17, began plugging the well as follows:

DATE	ACID USED	SIZE SHOT	SIZE BETWEEN	SIZE OF SHOT	PUT IN BY (Co.)	LENGTH ANCHOR	DISTANCE BELOW GATE
1951-01-17	40 sacks of cement	3910'	3790'	300'			
	Mud laden fluid	3790'	300'	255'			
	15 sacks of cement	300'	255'	5'			
	Mud laden fluid	255'	5'	5'			
	10 sacks of cement	5'	5'	5'			
	Surface soil	5'	5'	5'			

Plugged and abandoned January 18, 1951.

SLOPE TEST DATA: Tests were taken from 200'-525' with no deviation noted on this slope. A deviation of 1 degree was noted at 200'.

SIGNIFICANT GEOLOGICAL FORMATIONS

NAME	Top	Bottom	Gas	Oil	REMARKS
Surface soil	0	30			
Sand	30	135			
Shells	135	275			
Red bed and shells	275	673			
Anhydrite	673	680			
Anhydrite	680	705			
Red bed and shale	705	850			
Shale	850	960			
Shale and shells	960	1775			
Shale and lime	1775	1875			
Lime	1875	2050			
Lime and shale	2050	3025			
Lime	3025	3335			
Lime and shale	3335	3472			
Lime and chert	3472	3560			
Lime	3560	3640			
Lime and shale	3640	3685			
Lime	3685	3770			
Chert	3770	3795			
Lime and chert	3795	3873			
Medium coarse crystalline dolomite	3873	3878			
Buff, fine to coarse crystalline dolomite	3878	3910			

CLEANING OUT RECORDS

DATE COMMENCED	DATE COMPLETED	PROD. BEFORE	PROD. AFTER	REMARKS
				See Reverse for other details

PLUGGING BACK AND DEEPENING RECORDS

DATE COMMENCED	DATE COMPLETED	Prod. Below	Prod. After	REMARKS
				See Reverse for other details

LOGGING
FILE SEC 29, 23R 120
BOOK PAGE 56 LINE 70

JAN 2 1951
CONSERVATION DIVISION