

15-185-12265-0000

WELL PLUGGING RECORD

Give All Information Completely
Make Required Affidavit
Mail or Deliver Report to:
Conservation Division
State Corporation Commission
800 Biltong Building
Wichita, Kansas

NORTH

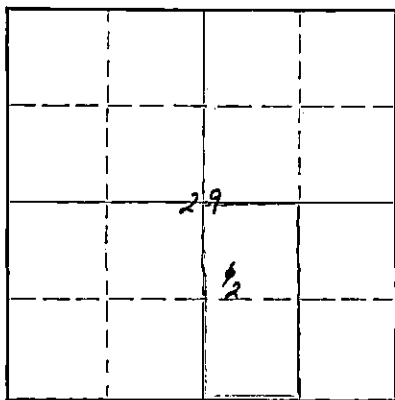

Locate well correctly on above Section Plat

Stafford County. Sec. 29 Twp. 23 S Rge. (E) 12 (W)
Location as "NE/CNW $\frac{1}{4}$ SW $\frac{1}{4}$ " or footage from lines SW $\frac{1}{4}$ NW $\frac{1}{4}$ SE $\frac{1}{4}$
Lease Owner Skelly Oil Company
Lease Name V. L. Williamson Well No. 2
Office Address Box 1650, Tulsa, Oklahoma
Character of Well (completed as Oil, Gas or Dry Hole) Dry Hole
Date well completed November 24, 1950
Application for plugging filed November 24, 1950
Application for plugging approved November 25, 1950
Plugging commenced November 24, 1950
Plugging completed November 24, 1950
Reason for abandonment of well or producing formation Dry Hole

If a producing well is abandoned, date of last production 19
Was permission obtained from the Conservation Division or its agents before plugging was commenced? Yes (verbally)

Name of Conservation Agent who supervised plugging of this well Mr. C. D. Stough
Producing formation none Depth to top Bottom Total Depth of Well 3912 Feet
Show depth and thickness of all water, oil and gas formations.

OIL, GAS OR WATER RECORDS

CASING RECORD

Formation	Content	From	To	OD Size	Put In	Pulled Out
Arbuckle Lime	Dry	3882'	3912'	8-5/8"	680' 0"	None

Describe in detail the manner in which the well was plugged, indicating where the mud fluid was placed and the method or methods used in introducing it into the hole. If cement or other plugs were used, state the character of same and depth placed, from _____ feet to _____ feet for each plug set.

40 sacks of cement 3912' to 3792'
Mud laden fluid 3792' to 300'
15 sacks of cement 300' to 255'
Mud laden fluid 255' to 35'
10 sacks of cement 35' to 5'
Surface soil 5' to 0'

(If additional description is necessary, use BACK of this sheet)

Correspondence regarding this well should be addressed to Skelly Oil Company
Address Box 391
Hutchinson, Kansas

STATE OF Kansas, COUNTY OF Reno, ss.
H. E. Wamsley (employee of owner) Notary Public of the above-described well,
being first duly sworn on oath, says: That I have knowledge of the facts, statements, and matters herein contained and the log of the above-described well as filed and that the same are true and correct. So help me God.

(Signature) [Signature]
Box 391, Hutchinson, Kansas
(Address)

SUBSCRIBED AND SWORN to before me this 8th day of December, 1950

My commission expires April 7, 1951

22-7877-8 4-49-10M

Notary Public

RECEIVED
STATE CORPORATION COMMISSION
DEC 9 - 1950 12-9-50
CONSERVATION DIVISION
Wichita, Kansas

PLUGGING
FILE SEC 29-T-23 R18W
BOOK PAGE 44 LINE 35

347						
348						
349						
350						
	Date Commenced	Date Completed	Depth of Drilling	Depth Below	Depth Above	REMARKS

PLUGGING BACK AND DEEPENING RECORDS

351						
352						
353						
354						
	DATE COMMENCED	DATE COMPLETED	DEPTH BELOW	DEPTH ABOVE		REMARKS

OPENING OUT RECORDS

355						
356						
357						
358						
359						
360						
361						
362						
	NAME	DATE	DEPTH	DEPTH	DEPTH	REMARKS

RECEIVED
 NATIONAL DIVISION
 DEC 8 1950
 FEDERAL BUREAU OF INVESTIGATION

GENERAL GEOLOGICAL FORMATIONS

363						
364						
365						
366						
367						
368						
369						
370						
	FORMATION	DEPTH	DEPTH	DEPTH	DEPTH	REMARKS

PLUGGING
 FILE SEC 291 23 R 12
 BOOK PAGE 44 LINE 35

no deviation from vertical noted. SLOPE TEST DATA: TESTS WERE TAKEN AT 250' INTERVALS FROM 250' TO 3060' WITH

371	40 sacks of cement	3792' to 3792'	3792' to 3792'	3792' to 3792'	3792' to 3792'
372	15 sacks of cement	3001' to 3001'	3001' to 3001'	3001' to 3001'	3001' to 3001'
373	10 sacks of cement	2551' to 2551'	2551' to 2551'	2551' to 2551'	2551' to 2551'
374	5 sacks of cement	2551' to 2551'	2551' to 2551'	2551' to 2551'	2551' to 2551'

On November 27, 1950, the well was plugged as follows:

Since no commercial quantities of oil or gas production were found in drilling to the total depth of 3912', regular authority was granted to plug and abandon this well.

TOTAL DEPTH 3912' 3888'

Grey coarsely crystalline dolomite 3912' 3888'

Recovered 735' of water, no oil. PACKER SET AT 3882', OPEN 1 HOUR, HAN HALLIBURTON DRILL STEAM TEST.

Shale 3882' 3865'

Lime and chert 3735' 3615'

Lime and shale 3735' 3615'

Lime and shale 3615' 3480'

Shale and lime 3480' 2995'

Lime 2995' 2995'

Lime and shale 2995' 2995'

Surface soil, sand, and clay 0' 70'

Red bed and shale 70' 280'

Clay and shells 280' 335'

Sand 335' 335'

RECORD OF FORMATIONS
 OIL COMPANY
 15-185-12265-000

SKELLY OIL COMPANY

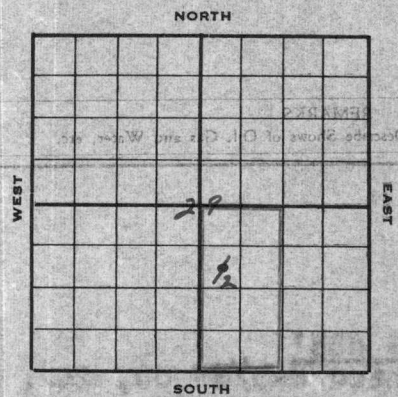

Well Record

Lease Name and No. V. L. Williamson Well No. 2 Elev. 1871' DF

Lease Description W/2 SE/4 Section 29-23E-12W,
Stafford County, Kansas

Location made November 3, 19 50 by R. G. Goshaw

990 feet from North line 330 feet from East line W/2 SE/4

330 feet from South line 330 feet from West line of Sec. 29

Work com'd 11/8 19 50 Rig comp'd 11/9 19 50 Drlg. com'd 11/9 19 50 Drlg. comp'd 11/24 19 50

Rig Contractor Claude Wentworth Drilling Co., Inc.

Drilling Contractor Claude Wentworth Drilling Co., Inc., Tulsa, Oklahoma

Rotary Drilling from 0' to 3912' Cable Tool Drilling from _____ to _____

Commenced Producing DRY HOLE 19 _____

Initial Prod. before shot or acid _____ Bbls.

Initial Prod. after shot or acid _____ Bbls.

Dry Gas Well Press _____ Volume _____ Cu. ft.

Casing Head Gas Pressure _____ Volume _____ Cu. ft.

Braden Head (_____ Size) Gas Pressure _____ Volume _____ Cu. ft.

Braden Head (_____ Size) Gas Pressure _____ Volume _____ Cu. ft.

PRODUCING FORMATION DRY HOLE (Name) Top _____ Bottom _____ TOTAL DEPTH 3912'

CASING RECORD

OD Size	Wt.	Thds.	Where Set	PULLED OUT			LEFT IN			KIND	Cond'n	CEMENTING	
				Jts.	Feet	In.	Jts.	Feet	In.			Sacks Used	Method Employed
<u>8-5/8" 24# PE</u>			<u>685'</u>				<u>17</u>	<u>680</u>	<u>0</u>	<u>R3 SS</u>	<u>G</u>	<u>300</u>	<u>Halliburton</u>
<u>(8-5/8" casing set 5' in collar)</u>													

Liner Set at _____ Length _____ Perforated at _____

Liner Set at _____ Length _____ Perforated at _____

Packer Set at _____ Size and Kind _____

Packer Set at _____ Size and Kind _____

SHOT OR ACID TREATMENT RECORD

	FIRST	SECOND	THIRD	FOURTH
Date				
Acid Used				
Size Shot				
Shot Between	Ft. and Ft.	Ft. and Ft.	Ft. and Ft.	Ft. and Ft.
Size of Shell				
Put in by (Co.)				
Length anchor				
Distance below Cas'g				
Damage to Casing or Casing Shoulder				

SIGNIFICANT GEOLOGICAL FORMATIONS

NAME	Top	Bottom	GAS		OIL		REMARKS
			From	To	From	To	
<u>Heebner Shale</u>	<u>3259'</u>						
<u>Toronto Lime</u>	<u>3279'</u>						
<u>Douglas Sand</u>	<u>3304'</u>						
<u>Lansing Lime</u>	<u>3427'</u>						
<u>Conglomerate</u>	<u>3710'</u>						
<u>Viola Lime</u>	<u>3747'</u>						
<u>Simpson Shale</u>	<u>3811'</u>						
<u>Arbuckle Line</u>	<u>3882'</u>						

RECEIVED
STATE CORPORATION COMMISSION
DEC 9 - 1950
CONSERVATION DIVISION
Wichita, Kansas

CLEANING OUT RECORDS

	DATE COMMENCED	DATE COMPLETED	PROD. BEFORE	PROD. AFTER	REMARKS
1st					See Reverse for other details.
2nd					" " " " "
3rd					" " " " "
4th					" " " " "

PLUGGING BACK AND DEEPENING RECORDS

	Date Commenced	Date Completed	No. Feet Plugged Back or Deepened	Prod. Before	Prod. After	REMARKS
1st						See Reverse for other details.
2nd						" " " " "
3rd						" " " " "
4th						" " " " "

(See Reverse for Record of Formation)