

WELL PLUGGING RECORD

Give All Information Completely
Make Required Affidavit
Mail or Deliver Report to:
Conservation Division
State Corporation Commission
211 No. Broadway
Wichita, Kansas

Stafford County. Sec. 16 Twp. 22 Rge. 12W (W)
Location as "NE/CNW&SW&" or footage from lines NW SE SE
Lease Owner Petroleum, Inc.
Lease Name Spangenberg "C" Well No. 1
Office Address Route 2, Great Bend, Kansas
Character of Well (completed as Oil, Gas or Dry Hole) Dry Hole
Date well completed June 26, 1958
Application for plugging filed June 27, 1958
Application for plugging approved June 26, 1958
Plugging commenced June 26, 1958
Plugging completed June 26, 1958
Reason for abandonment of well or producing formation No Producing Zones

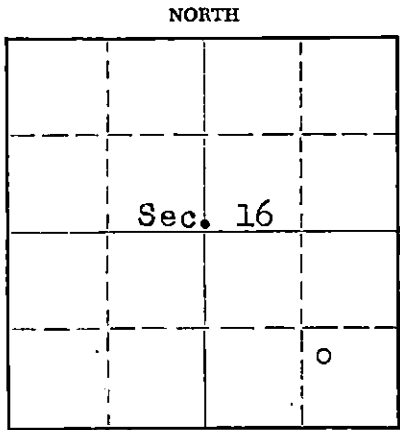

Locate well correctly on above Section Plat

If a producing well is abandoned, date of last production None 19
Was permission obtained from the Conservation Division or its agents before plugging was commenced? Yes

Name of Conservation Agent who supervised plugging of this well Frank Broadfoot, 222 S. Main, St. John, Ks.
Producing formation --- Depth to top --- Bottom --- Total Depth of Well 3691 Feet
Show depth and thickness of all water, oil and gas formations.

OIL, GAS OR WATER RECORDS

CASING RECORD

| FORMATION | CONTENT | FROM | TO | SIZE | PUT IN | PULLED OUT |
|-----------|---------|------|----|--------|--------|------------|
| | | | | 8-5/8" | 270' | None |
| | | | | | | |
| | | | | | | |
| | | | | | | |
| | | | | | | |
| | | | | | | |
| | | | | | | |

Describe in detail the manner in which the well was plugged, indicating where the mud fluid was placed and the method or methods used in introducing it into the hole. If cement or other plugs were used, state the character of same and depth placed, from _____ feet to _____ feet for each plug set.

Mud up with heavy mud to 240', pushed 1/3 sack hulls to 240' followed by a wooden plug. Placed 20 sacks cement on to plug through drill pipe.
Mud up to 40', pushed 1/3 sack hulls to 40' followed by a wooden plug and 10 sacks cement to base of well cellar.

(If additional description is necessary, use BACK of this sheet)

Name of Plugging Contractor Garvey Drilling Company
Address Route 2, Great Bend, Kansas

STATE OF Kansas, COUNTY OF Barton, ss.
R.D. Brew (employee of owner) or (owner or operator) of the above-described well, being first duly sworn on oath, says: That I have knowledge of the facts, statements, and matters herein contained and the log of the above-described well as filed and that the same are true and correct. So help me God.

(Signature) [Signature]
Route 2, Great Bend, Kansas
(Address)

SUBSCRIBED AND SWORN TO before me this 3rd. day of July, 19 58
July 11, 1960
My commission expires

[Signature] Notary Public.

RECEIVED
STATE CORPORATION COMMISSION

PLUGGING
FILE SEC 16 T 22 R 12W
BOOK PAGE 111 LINE 10

JUL 7 1958
CONSERVATION DIVISION
Wichita, Kansas

WELL LOG

COMPANY PETROLEUM, INCORPORATED

SEC. 16 T. 22S R. 12W

FARM SPANGENBERG "C" NO. 1

LOC. NW, SE, SE

TOTAL DEPTH 3691'

COUNTY STAFFORD CO., KANSAS

COMM. June 17, 1958 COMP. June 26, 1958

CONTRACTOR GARVEY DRILLING COMPANY

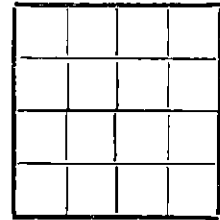

CASING 8 5/8" @ 270' W/225 sax.

ELEVATION 1863' DF

PRODUCTION D & A

FIGURES INDICATE BOTTOM OF FORMATIONS

| | |
|------|---------------------|
| 120 | Sand & surface soil |
| 270 | Sand & shale |
| 640 | Shale |
| 690 | Anhydrite |
| 1465 | Shale & shells |
| 1695 | Shale & lime |
| 1865 | Lime |
| 2310 | Shale & lime |
| 3035 | Lime & shale |
| 3135 | Shale & lime |
| 3195 | Lime |
| 3340 | Shale & lime |
| 3691 | Lime |
| 3691 | T. D. |

RECEIVED
 STATE CORPORATION COMMISSION
 JUL 7 1958
 CONSERVATION DIVISION
 Wichita, Kansas

PLUGGING
 FILE SEC. 16 T. 22 R. 12W
 BOOK PAGE 111 LINE 10

State of KANSAS }
 County of BARTON } ss:

I, VERNE A. MORRIS of GARVEY DRILLING COMPANY

upon oath state that the above and foregoing is a true and correct copy of the log of the #1 SPANGENBERG "C" well

Subscribed and sworn to before me this 2nd day of July 1958

My Commission Expires: July 11, 1960

Verne A. Morris

John T. Bower

 NOTARY PUBLIC