

State

15-079-00840-0000

STATE OF KANSAS
 STATE CORPORATION COMMISSION
 Give All Information Completely
 Make Required Affidavit
 Mail or Deliver Report to:
 Conservation Division
 State Corporation Commission
 800 Bittling Building
 Wichita, Kansas

WELL PLUGGING RECORD

OR

~~FORMATION PLUGGING RECORD~~ Strike out upper line when reporting plugging of formations.

Harvey County, Sec 18 Twp 22S Rge (E) 3 (W)

Location as "NE $\frac{1}{4}$ NW $\frac{1}{4}$ SW $\frac{1}{4}$ " or footage from lines E/2 SE/4, 330' fm Nth & East lines

Lease Owner Sinclair Prairie Oil Co

Lease Name John Neufeld-A Well No. 1

Office Address Box 521, Tulsa, Okla.

Character of Well (completed as Oil, Gas or Dry Hole) Oil well

Date, well completed June 19 1933

Application for plugging filed June 28 1941

Application for plugging approved July 2 1941

Plugging Commenced July 31 1941

Plugging Completed Aug 14 1941

Reason for abandonment of well or producing formation dry

If a producing well is abandoned, date of last production Jan. 26 1941

Was permission obtained from the Conservation Division or its agents before plugging was commenced? yes

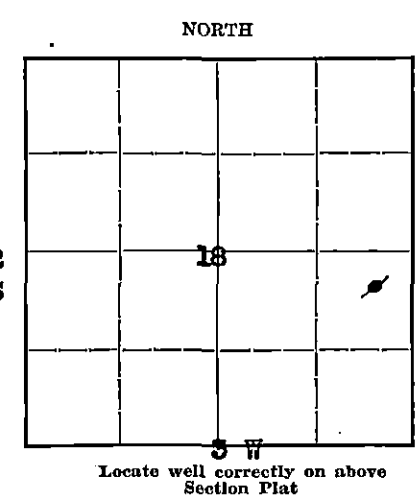

Name of Conservation Agent who supervised plugging of this well Ruel Durkee

Producing formation Chat Depth to top 3142 Bottom 3278 Total Depth of Well 3278 Feet

Show depth and thickness of all water, oil and gas formations.

OIL, GAS OR WATER RECORDS

CASING RECORD

Formation	Content	From	To	Size	Put In	Pulled Out
Chat	dry	3142	3278	15-1/2"	263	0
				8-5/8"	3173	2513

Describe in detail the manner in which the well was plugged, indicating where the mud fluid was placed and the method or methods used in introducing it into the hole. If cement or other plugs were used, state the character of same and depth placed, from _____ feet to _____ feet for each plug set.

- 3278 - 3142 crushed rock
- 3142 - 3123 cement 6 sx
- 3123 - 200 mud
- 200 - 184 cement 20 sx
- 184 - 8 mud
- 8 - 0 cement 10 sx

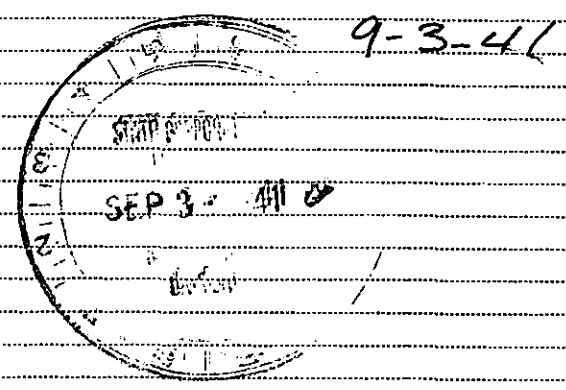
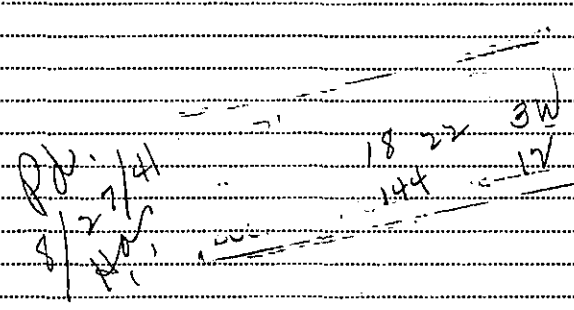

(If additional description is necessary, use BACK of this sheet)

Correspondence regarding this well should be addressed to Victor Chancellor

Address 1319-1/2 Main, Great Bend, Kans

STATE OF Kansas, COUNTY OF Barton, ss.

Victor Chancellor (employee of owner) or (owner or operator) of the above-described well, being first duly sworn on oath, says: That I have knowledge of the facts, statements, and matters herein contained and the log of the above-described well as filed and that the same are true and correct. So help me God.

(Signature) Victor Chancellor

(Address)

SUBSCRIBED AND SWORN to before me this 2nd day of September, 1941

My commission expires 6-14-43

J. H. MacFarlane
Notary Public.

STATE OF KANSAS
STATE CORPORATION COMMISSION

WELL PLUGGING RECORD

OR
FORMATION PLUGGING RECORD

Strike out upper line when reporting plugging of formations.

Give All Information Completely
Make Required Affidavit
Mail or Deliver Report to:
Conservation Division
State Corporation Commission,
800 Bldg Building,
Wichita, Kansas

Harvey County, Sec. 18 Twp. 22S Rge. (E) 3 (W)

Location as "NE 1/4 NW 1/4 SW 1/4" or footage from lines E/2 SE/4
Lease Owner Sinclair Prairie Oil Co
Lease Name John Neufeldt - A Well No. 1
Office Address Box 521, Tulsa, Okla.
Character of Well (Completed as Oil, Gas or Dry Hole)
Date, well completed June 19 1933
Application for plugging filed None filed 193
Application for plugging approved 193
Plugging Commenced November 9 193.7
Plugging Completed November 13 193.7
Reason for abandonment of well or producing formation Hunton Lime dry and it was draining oil from the Chat formation
If a producing well is abandoned, date of last production - 193
Was permission obtained from the Conservation Division or its agents before plugging was commenced? No

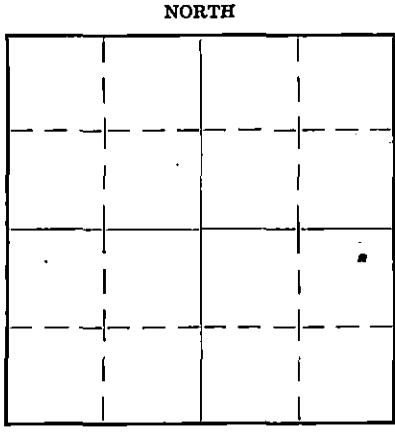

Name of Conservation Agent who supervised plugging of this well None
Producing formation Hunton Lime Depth to top 3414 Bottom 3451 Total Depth of Well 3458 Feet
Show depth and thickness of all water, oil and gas formations.

OIL, GAS OR WATER RECORDS CASING RECORD

Formation	Content	From	To	Size	Put In	Pulled Out
Mississippi Lime	oil, gas & wt	3141	3287	15 1/2	265	none
				8-1/4	3142	"
Hunton Lime	dry	3414	3458	6-5/8	3409	"
Hunton Lime formation is now plugged off. No casing pulled.						

Describe in detail the manner in which the well was plugged, indicating where the mud fluid was placed and the method or methods used in introducing it into the hole. If cement or other plugs were used, state the character of same and depth placed, from...feet to...feet for each plug set.
Old TD 3458 filled up w/ crushed rock to 3385'
Put in four 5 1/2" containers of oakum and 50# lead wool, which plugged back to 3382' TD. (lead wool put in last)

(If additional description is necessary use BACK of this sheet)
Correspondence regarding this well should be addressed to Mr. O.E. Randolph
Address Box 650, McPherson, Kas.

STATE OF Kansas, COUNTY OF McPherson

(employee of owner) or (owner or operator) of the above-described well, being first duly sworn on oath, says: That I have knowledge of the facts, statements, and matters herein contained and the log of the above-described well as filed and that the same are true and correct. So help me God.

(Signature) O.E. Randolph
McPherson Kan
(Address)

SUBSCRIBED AND SWORN to before me this 18 day of December 1937

My commission expires 3/17/41
Notary Public.