

STATE OF KANSAS
STATE CORPORATION COMMISSION

Form CP-4

Give All Information Completely
Make Required Affidavit
Mail or Deliver Report to:
Conservation Division
State Corporation Commission

WELL PLUGGING RECORD

P. O. Box 17027
Wichita, Kansas 67217
NORTH

	X		
	3a		

Locate well correctly on above
Section Plat

Kearny County, Sec. 32 Twp 21S Rge. 35 (W)
Location as "NE/CNW/SW" or footage from lines NE NW
Lease Owner Abercrombie Drilling, Inc.
Lease Name KERSTEN Well No. #1
Office Address 801 Union Center, Wichita, Kansas 67202
Character of Well (completed as Oil, Gas or Dry Hole) DRY HOLE
Date well completed November 21, 1975
Application for plugging filed (verbally) November 21, 1975
Application for plugging approved (verbally) November 21, 1975
Plugging commenced November 21, 1975
Plugging completed November 21, 1975
Reason for abandonment of well or producing formation No commercial quantity of oil or gas encountered.
If a producing well is abandoned, date of last production 19
Was permission obtained from the Conservation Division or its agents before plugging was commenced? Yes

Name of Conservation Agent who supervised plugging of this well Yes
Producing formation _____ Depth to top _____ Bottom _____ Total Depth of Well 5039 Feet
Show depth and thickness of all water, oil and gas formations.

OIL, GAS OR WATER RECORDS

CASING RECORD

FORMATION	CONTENT	FROM	TO	SIZE	PUT IN	PULLED OUT
				8 5/8"	364'	none

Describe in detail the manner in which the well was plugged, indicating where the mud fluid was placed and the method or methods used in introducing it into the hole. If cement or other plugs were used, state the character of same and depth placed, from _____ feet to _____ feet for each plug set.

1st Plug was set @ 900' with 50 sx. cement
2nd Plug was set @ 360' with 35 sx. cement
3rd Plug was set @ 40' with 10 sx. cement
Plug was down @ 2:15 pm. November 21, 1975

RECEIVED
STATE CORPORATION COMMISSION

NOV 26 1975

11-26-75

CONSERVATION DIVISION
Wichita, Kansas

Name of Plugging Contractor Abercrombie Drilling, Inc.
Address 801 Union Center, Wichita, Kansas 67202

STATE OF KANSAS, COUNTY OF SEDGWICK, ss.
Jerry A. Langrehr-Exec. Vice President (employee of owner) or (owner or operator) of the above-described well, being first duly sworn on oath, says: That I have knowledge of the facts, statements, and matters herein contained and the log of the above-described well as filed and that the same are true and correct. So help me God.

(Signature) Jerry A. Langrehr
801 Union Center, Wichita, Kansas 67202
(Address)

Subscribed AND SWORN to before me this 25th day of November, 1975
My commission expires July 21, 1979
Sandra Russell
Sandra Russell Notary Public.

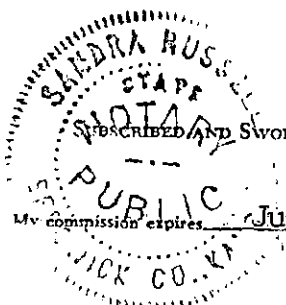

KANSAS DRILLERS LOG

API No. 15 — 093 — 20,238-0000
 County Number

S. 32 T. 21S. R. 35 E. W

Loc. NE NW

County Kearny

Operator
 Abercrombie Drilling, Inc.

Address
 801 Union Center, Wichita, Kansas 67202

Well No. #1 Lease Name KERSTEN

Footage Location
 660 feet from (N) (SE line) 1980 feet from (E) (W) line

Principal Contractor Abercrombie Drilling, Inc. Geologist Robert McCann

Spud Date November 9, 1975 Total Depth 5039' P.B.T.D.

Date Completed November 21, 1975 Oil Purchaser Unknown

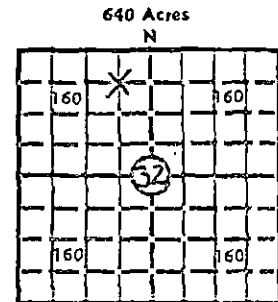

Locate well correctly

Elev.: Gr. 3178'

DF. 3183' KB 3186'

CASING RECORD

Report of all strings set—surface, intermediate, production, etc.

Purpose of string	Size hole drilled	Size casing set (in O.D.)	Weight lbs/ft.	Setting depth	Type cement	Sacks	Type and percent additives
To Surface	12 1/4"	8 5/8"		364'	Common	250	2% gel, 2% ca. cl.

LINER RECORD

PERFORATION RECORD

Top, ft.	Bottom, ft.	Sacks cement	Shots per ft.	Size & type	Depth interval

TUBING RECORD

Size	Setting depth	Packer set at

ACID, FRACTURE, SHOT, CEMENT SQUEEZE RECORD

Amount and kind of material used	Depth interval treated
RECEIVED STATE CORPORATION COMMISSION NOV 20 1975 CONSERVATION DIVISION Wichita, Kansas	

INITIAL PRODUCTION

Date of first production	Producing method (flowing, pumping, gas lift, etc.)
RATE OF PRODUCTION PER 24 HOURS	Oil Gas Water Gas-oil ratio
bbls. MCF bbls. CFPB	
Disposition of gas (vented, used on lease or sold)	Producing interval(s)

INSTRUCTIONS: As provided in KCC Rule 82-2-125, within 90 days after completion of a well, one completed copy of this Drillers Log shall be transmitted to the State Geological Survey of Kansas, 4150 Monroe Street, Wichita, Kansas 67209. Copies of this form are available from the Conservation Division, State Corporation Commission, 3830 So. Meridian (P.O. Box 17027), Wichita, Kansas 66217. Phone AC 316-522-2206. If confidential custody is desired, please note Rule 82-2-125. Drillers Logs will be on open file in the Oil and Gas Division, State Geological Survey of Kansas, Lawrence, Kansas 66044.

Operator Abercrombie Drilling, Inc.		DESIGNATE TYPE OF COMP.: OIL, GAS, DRY HOLE, SWDW, ETC.:
Well No. #1	Lease Name KERSTEN	DRY HOLE
S 32 T 21S R 35 E W		

WELL LOG

Show all important zones of porosity and contents thereof; cored intervals, and all drill-stem tests, including depth interval tested, cushion used, time tool open, flowing and shut-in pressures, and recoveries.

SHOW GEOLOGICAL MARKERS, LOGS RUN, OR OTHER DESCRIPTIVE INFORMATION.

FORMATION DESCRIPTION, CONTENTS, ETC.	TOP	BOTTOM	NAME	DEPTH
Surface sand, clay & shale	0	364	ELECTRIC LOG	TOPS:
Shale and sand	364	1890		
Shale & lime	1890	2186	B/Anhydrite	2197'
Anhydrite	2186	2215	Hollenberg	2644'
Shale	2215	2730	Herrington	2678'
Shale & Lime	2730	3940	Winfield	2737'
Lime & Shale	3940	4530	Heebner	3927'
Lime	4530	5039	Toronto	3950'
Rotary Total Depth		5039	Lansing	3980'
			B/Kansas City	4448'
			Marmaton	4476'
			Beymer Zone	4570'
			Johnson Zone	4604'
			Morrow Shale	4837'
			Mississippi	4884'
			ELTD	5033'
			RID	5039'

DST #1 (4500'-4530') 20", 45", 60", 45"
 Strong blow throughout test. Rec. 840'
 gas in pipe. 1748' Gassy saltwater.
 IFP 71-367#; IBHP 1148#; FFP 414-822#;
 FBHP 1125#.

DST #2 (4572'-4590') 20", 45", 30", 45"
 Weak blow for 30 min. Rec. 20' mud w/
 few spots oil. IFP 11-11#; IBHP 1148#;
 FFP 23-23#; FBHP 1113#.

DST #3 (4601'-4627') 20", 45", 30", 45"
 Weak blow for 30 min. Rec. 15' mud.
 IFP 11-11#; IBHP 41#; FFP 11-11#;
 FBHP 23#.

USE ADDITIONAL SHEETS, IF NECESSARY, TO COMPLETE WELL RECORD.

Date Received	<p align="center"><i>Jerry A. Langrehr</i> _____ Jerry A. Langrehr Signature Exec. Vice President _____ Title November 25, 1975 _____ Date</p>
---------------	---