

STATE CORPORATION COMMISSION OF KANSAS  
OIL & GAS CONSERVATION DIVISION

WELL COMPLETION OR RECOMPLETION FORM  
ACO-1 WELL HISTORY

DESCRIPTION OF WELL AND LEASE

Operator: License # 5290  
Name J. B. Hinkle dba Hinkle Oil Co.  
Address 1016 Union Center Building  
City/State/Zip Wichita, Kansas 67202

Purchaser.....

Operator Contact Person Orvie Howell  
Phone 316-267-0231

Contractor: License # 5302  
Name Red Tiger Drilling Company

Wellsite Geologist Orvie Howell  
Phone (316) 267-0231

Designate Type of Completion  
 New Well  Re-Entry  Workover  
 Oil  SWD  Temp Abd  
 Gas  Inj  Delayed Comp.  
 Dry  Other (Core, Water Supply etc.)

If OWO: old well info as follows:  
Operator .....  
Well Name .....  
Comp. Date ..... Old Total Depth.....

WELL HISTORY

Drilling Method:  
 Mud Rotary  Air Rotary  Cable  
4/24/87 5/2/87 5/2/87  
Spud Date Date Reached TD Completion Date  
4,000'  
Total Depth PBD  
Amount of Surface Pipe Set and Cemented at 332 feet  
Multiple Stage Cementing Collar Used?  Yes  No  
If yes, show depth set.....feet  
If alternate 2 completion, cement circulated  
from.....feet depth to.....w/.....SX cmt

API No. 15-145-21,258-0000  
County Pawnee  
SW/4 SE/4 NW/4 1 21S 18W  East  
Sec..... Twp..... Rge.....  West

2970 Ft North from Southeast Corner of Section  
3630 Ft West from Southeast Corner of Section  
(Note: Locate well in section plat below)

Lease Name Weisensee Well # 1

Field Name Wildcat

Producing Formation.....

Elevation: Ground 2111 KB 2116  
Section Plat

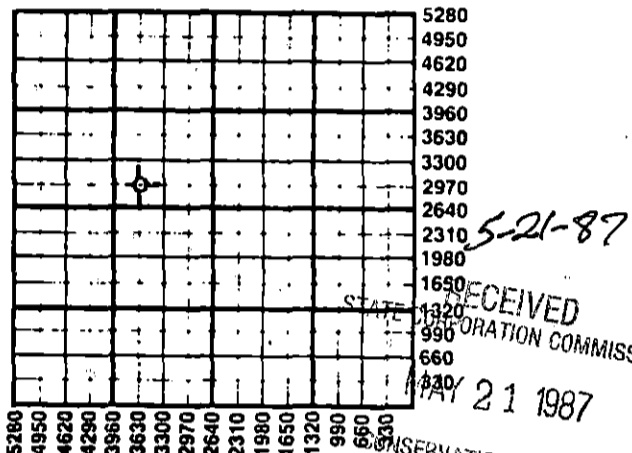

WATER SUPPLY INFORMATION

Disposition of Produced Water:  Disposal  
Docket # .....  Repressuring

Questions on this portion of the ACO-1 call:  
Water Resources Board (913) 296-3717

Source of Water:  
Division of Water Resources Permit #.....  
 Groundwater.....Ft North from Southeast Corner  
(Well) .....Ft West from Southeast Corner of  
Sec Twp Rge  East  West  
 Surface Water 4100 Ft North from Southeast Corner  
5000 Ft West from Southeast Corner  
Sec 13 Twp 21S Rge 18  East  West  
 Other (explain).....  
(purchased from city, R.W.D. #)

INSTRUCTIONS: This form shall be completed in duplicate and filed with the Kansas Corporation Commission, 200 Colorado Derby Building, Wichita, Kansas 67202, within 90 days after completion or recompletion of any well. Rule 82-3-130 and 82-3-107 apply.  
Information on side two of this form will be held confidential for a period of 12 months if requested in writing and submitted with the form. See rule 82-3-107 for confidentiality in excess of 12 months.  
One copy of all wireline logs and drillers time log shall be attached with this form. Submit CP-4 form with all plugged wells. Submit CP-111 form with all temporarily abandoned wells.

All requirements of the statutes, rules and regulations promulgated to regulate the oil and gas industry have been fully complied with and the statements herein are complete and correct to the best of my knowledge.

Signature Orvie Howell  
Title General Manager/Geologist Date 5/19/87

Subscribed and sworn to before me this 19th day of May 1987.  
Notary Public Melanie Frieden

Date Commission Expires January 30, 1988



K.C.C. OFFICE USE ONLY  
F  Letter of Confidentiality Attached  
C  Wireline Log Received  
C  Drillers Time Log Received  
Distribution  
 KCC  SWD/Rep  NGPA  
 KGS  Plug  Other  
(Specify)

Sec. 1, Twp. 21, Rge. 18

SIDE TWO

Operator Name ..... J. B. Hinkle dba Hinkle Oil Co. Lease Name..... Weisensee ..... Well #..... 1

Sec..... 1 ..... Twp..... 21S ..... Rge..... 18W .....  East  West County..... Pawnee .....

WELL LOG

INSTRUCTIONS: Show important tops and base of formations penetrated. Detail all cores. Report all drill stem tests giving interval tested, time tool open and closed, flowing and shut-in pressures, whether shut-in pressure reached static level, hydrostatic pressures, bottom hole temperature, fluid recovery, and flow rates if gas to surface during test. Attach extra sheet if more space is needed. Attach copy of log.

Drill Stem Tests Taken  Yes  No  
 Samples Sent to Geological Survey  Yes  No  
 Cores Taken  Yes  No

Formation Description  
 Log  Sample

DST #1 3757-3768: Open: 60"-40"-60"-45"  
 Recovered 1200' gas in pipe + 60' oil specked gas cut mud, IFP: 77-66#, ISIP: 1068#, FFP: 77-77#, FSIP: 1044#.

Name	Top	Bottom
ANHYDRITE	1162	
BROWN LIME/ LANSING	3556	
BASE KANSAS CITY	3836	
BASE PAWNEE	3943	
CONGLOMERATE SD	3964	

DST #2 3942-3978: Open: 60"-45"-30"-30"  
 Recovered 2700' salt water. Chlorides 45,000 ppm, IFP: 881-1254#, ISIP: 1254#, FFP: 1254-1254#, FSIP: 1254#.

CASING RECORD <input checked="" type="checkbox"/> New <input type="checkbox"/> Used							
Report all strings set-conductor, surface, intermediate, production, etc.							
Purpose of String	Size Hole Drilled	Size Casing Set (in O.D.)	Weight Lbs/Ft.	Setting Depth	Type of Cement	#Sacks Used	Type and Percent Additives
Surface	12 1/4"	8 5/8"	20#	339'	60/40 Poz	200	2% Gel 3%CC
PERFORATION RECORD				Acid, Fracture, Shot, Cement Squeeze Record			
Shots Per Foot	Specify Footage of Each Interval Perforated			(Amount and Kind of Material Used)		Depth	
.....	.....			.....		.....	
.....	.....			.....		.....	
.....	.....			.....		.....	
.....	.....			.....		.....	
TUBING RECORD				Liner Run <input type="checkbox"/> Yes <input type="checkbox"/> No			
Date of First Production	Producing Method						
	<input type="checkbox"/> Flowing <input type="checkbox"/> Pumping <input type="checkbox"/> Gas Lift <input type="checkbox"/> Other (explain).....						
Estimated Production Per 24 Hours	Oil	Gas	Water	Gas-Oil Ratio	Gravity		
	Bbls	MCF	Bbls	CFPB			

METHOD OF COMPLETION

Production Interval

Disposition of gas:  Vented  Open Hole  Perforation  
 Sold  Other (Specify) .....  
 Used on Lease  Dually Completed .....  
 Commingled .....