

STATE OF KANSAS
 STATE CORPORATION COMMISSION
 CONSERVATION DIVISION
 P. O. BOX 17027
 WICHITA, KANSAS 67217

FORM CP-4

WELL PLUGGING RECORD

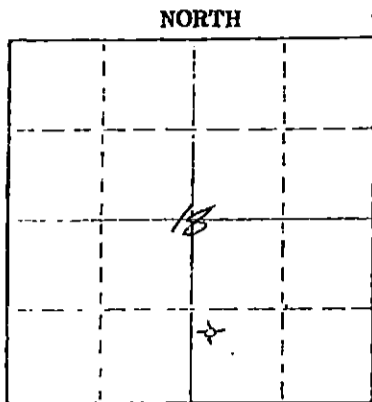

HARVEY County, Sec. 18 Twp. 22 Rge. 3 (E) (W)
 Location as "NE/CNW&SW" or footage from lines NW SW SE
 Lease Owner SOUTHERN STATES OIL
 Lease Name FROESE Well No. 3
 Office Address P.O. BX 1365 GREAT BEND KS 67530
 Character of Well (completed as Oil, Gas or Dry Hole) _____
 Date well completed 4-26 19 77
 Application for plugging filed 4-26 19 77
 Application for plugging approved 4-26 19 77
 Plugging commenced 4-26 19 77
 Plugging completed 4-26 19 77
 Reason for abandonment of well or producing formation DRY HOLE

If a producing well is abandoned, date of last production _____ 19 ____
 Was permission obtained from the Conservation Division or its agents before plugging was commenced? YES

Name of Conservation Agent who supervised plugging of this well HUGH SCOTT
 Producing formation NONE Depth to top _____ Bottom _____ Total Depth of Well 3670
 Show depth and thickness of all water, oil and gas formations.

OIL, GAS OR WATER RECORDS

5-2-77

CASING RECORD

FORMATION	CONTENT	FROM	TO	SIZE	RECEIVED STATE CORPORATION COMMISSION MAY 02 1977 CONSERVATION DIVISION Wichita, Kansas
CONGLOMERATE		3230	3238		
MISSISSIPPI CHAT		3238	3287		
MISSISSIPPI DOLO.		3287	3469		
MISSISSIPPI LIME		3469	3508		
KINDERHOOK SHALE		3508	3622		
MISENER SAND		3622	3629		
HUNTON DOLOM		3630	3654		
MAQUOKETA SHALE		3654			

Describe in detail the manner in which the well was plugged, indicating where the mud fluid was placed and the method or methods used in introducing it into the hole. If cement or other plugs were used, state the character of same and depth placed, from _____ feet to _____ feet for each plug set.

FILLED HOLE W/MUD TO -260 & SET 8 5/8" PLUG.
 APPLIED 40 SX CLASS A COMMON W/PUMP TRUCK. FILLED HOLE W/ ~~CEMENT~~ MUD TO -70 & SET 8 5/8" PLUG. APPLIED 10 SX CLASS A COMMON W/PUMP TRUCK. PUT 2 SX CLASS A COMMON IN RAT HOLE

(If additional description is necessary, use BACK of this sheet)

Name of Plugging Contractor KAN-60 INC.
 Address BX 277, MARION, KS. 66861

STATE OF KANSAS COUNTY OF HARVEY SS.
FRANK S MIZE (employee of owner) or (owner or operator) of the above-described well, being first duly sworn on oath, says: That I have knowledge of the facts, statements, and matters herein contained and the log of the above-described well as filed and that the same are true and correct. So help me God.

(Signature) Frank S. Mize
BX 277 MARION KS 66861
 (Address)

Subscribed and sworn to before me this 26th day of April, 19 77

My commission expires October 11, 1977
Cynthia D. Rutledge
 Cynthia D. Rutledge
 Notary Public.

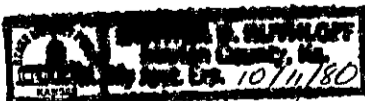

KANSAS DRILLERS LOG

S. 18 T. 22 R. 3 ^W _K

API No. 15 — 079 — 20301-0000
 County Number

Loc. NW SW SE

County Harvey

Operator
 Southern States Oil Company

Address
 Box 1365 Great Bend, Kansas 67530

Well No. 3 Lease Name Froese

Footage Location
 990 feet from (N) (S) line 2310 feet from (E) (W) line

Principal Contractor Kan Go, Inc. Geologist Steve Powell

Spud Date 4-18-77 Total Depth 3670 P.B.T.D.

Date Completed 4-26-77 Oil Purchaser D & A

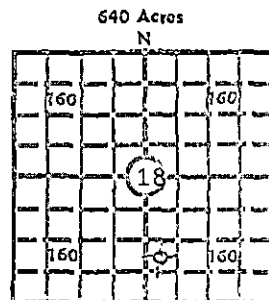

Locate well correctly
 Elev.: Gr. 1429

DF _____ KB 1439

CASING RECORD

Report of all strings set — surface, intermediate, production, etc.

Purpose of string	Size hole drilled	Size casing set (in O.D.)	Weight lbs/ft.	Setting depth	Type cement	Sacks	Type and percent additives
Surface	12 1/4	8 5/8		263 K.B.	Class A	250	2% cacl

LINER RECORD

PERFORATION RECORD

Top, ft.	Bottom, ft.	Sacks cement	Shots per ft.	Size & type	Depth interval

TUBING RECORD

Size	Setting depth	Packer set at

ACID, FRACTURE, SHOT, CEMENT SQUEEZE RECORD

Amount and kind of material used	Depth interval treated

RECEIVED
 STATE CORPORATION COMMISSION
 MAY 23 1977

CONSERVATION DIVISION
 Wichita, Kansas

INITIAL PRODUCTION

Date of first production <u>D & A</u>		Producing method (flowing, pumping, gas lift, etc.)			
RATE OF PRODUCTION PER 24 HOURS	Oil	Gas	Water	Gas-oil ratio	CFPB
	bbls.	MCF	bbls.		
Disposition of gas: (vented, used on lease or sold)			Producing interval (s) <u>D & A</u>		

INSTRUCTIONS: As provided in KCC Rule 82-2-125, within 90 days after completion of a well, one completed copy of this Drillers Log shall be transmitted to the State Geological Survey of Kansas, 4150 Monroe Street, Wichita, Kansas 67209. Copies of this form are available from the Conservation Division, State Corporation Commission, 3830 So. Meridian (P.O. Box 17027), Wichita, Kansas 66217. Phone AC 316-522-2206. If confidential custody is desired, please note Rule 82-2-125. Drillers Logs will be on open file in the Oil and Gas Division, State Geological Survey of Kansas, Lawrence, Kansas 66044.

Operator Southern States Oil Company		DESIGNATE TYPE OF COMP.: OIL, GAS, DRY HOLE, SWDW, ETC.:
Well No. 3	Lease Name Froese	D & A
S _c 18 T ₂₂ R ₅ XX W		

WELL LOG

Show all important zones of porosity and contents thereof; cored intervals, and all drill-stem tests, including depth interval tested, cushion used, time tool open, flowing and shut-in pressures, and recoveries.

SHOW GEOLOGICAL MARKERS, LOGS RUN, OR OTHER DESCRIPTIVE INFORMATION.

FORMATION DESCRIPTION, CONTENTS, ETC.	TOP	BOTTOM	NAME	DEPTH
			Great Guns R.A. Guard	Logged from T.D. to 2400 K.B.
Conglomerate	3230	3238		
Mississippi Chat	3238	3287		
Mississippi Dold	3287	3464		
Mississippi Lime	3464	3508		
Kinderhook Shale	3508	3622		
Misener Sand	3622	3624		

USE ADDITIONAL SHEETS, IF NECESSARY, TO COMPLETE WELL RECORD.

Date Received	<i>Frank L. Sneyd</i>
	GEOLOGIST
	5-18-77

Signature
Title
Date