

WELL PLUGGING RECORD

Give All Information Completely
Make Required Affidavit
Mail or Deliver Report to:
Conservation Division
State Corporation Commission
800 Bittling Building
Wichita, Kansas

Stafford County, Sec. 9 Twp. 22S Rge. (E) 13 (W)

Location as "NE/CNW $\frac{1}{4}$ SW $\frac{1}{4}$ " or footage from lines NE/4 NE/4 SE/4
Lease Owner Skelly Oil Company
Lease Name Kelley "A" Well No. 1
Office Address Box 1650, Tulsa, Oklahoma
Character of Well (completed as Oil, Gas or Dry Hole) Oil
Date well completed December 12, 1949
Application for plugging filed August 12, 1951
Application for plugging approved August 22, 1951
Plugging commenced September 10, 1951
Plugging completed September 19, 1951
Reason for abandonment of well or producing formation Depleted Oil Well

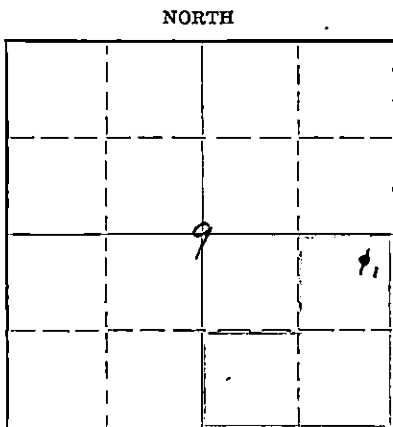

Locate well correctly on above Section Plat

If a producing well is abandoned, date of last production August 15, 1951
Was permission obtained from the Conservation Division or its agents before plugging was commenced? Yes

Name of Conservation Agent who supervised plugging of this well Mr. C. D. Stough
Producing formation Arbuckle Lime Depth to top 3779' Bottom 3784' Total Depth of Well 3784' Feet
Show depth and thickness of all water, oil and gas formations. PB 3781'

OIL, GAS OR WATER RECORDS

CASING RECORD

Formation	Content	From	To	OD Size	Put In	Pulled Out
Arbuckle Lime	Oil	3779'	3784'	8-5/8"	744'6"	None
				5-1/2"	3819'0"	2383'0"

Describe in detail the manner in which the well was plugged, indicating where the mud fluid was placed and the method or methods used in introducing it into the hole. If cement or other plugs were used, state the character of same and depth placed, from _____ feet to _____ feet for each plug set.

Bridging plug 3500'
2 sacks Cal-Seal 3500' to 3484'
Sand 3484' to 3450'
5 sacks of cement 3450' to 3410'
Mud laden fluid 3410' to 250'
15 sacks of cement 250' to 205'
Mud laden fluid 205' to 35'
10 sacks of cement 35' to 8'
Surface soil 8' to 0'

(If additional description is necessary, use BACK of this sheet)
Name of Plugging Contractor C. E. Shull Casing Pulling Company
Address Great Bend, Kansas

STATE OF Kansas, COUNTY OF Reno, ss.
H. E. Wamsley (employee of owner) of the above-described well,
being first duly sworn on oath, says: That I have knowledge of the facts, statements, and matters herein contained and the log of the above-described well as filed and that the same are true and correct. So help me God.

(Signature) [Signature]
Box 391, Hutchinson, Kansas (Address)

SUBSCRIBED AND SWORN to before me this 15th day of October, 1951

My commission expires April 7, 1955

RECEIVED
STATE CORPORATION COMMISSION
Notary Public.

23-307 16 1951 20M

10-16-51

CONSERVATION DIVISION
Wichita, Kansas

PLUGGING
FILE SEC 9 T 4 R 130
BOOK PAGE 105 LINE 1

15-185-12634-0000

SKELLY OIL COMPANY

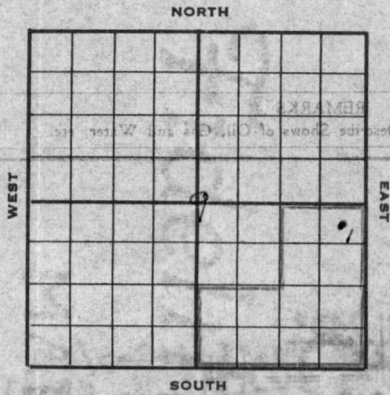

Well Record

Lease Name and No. Kelley "A" #27292 Well No. 1 Elev. 1889' BH 1893' DV
 Lease Description NE/4 SE/4 and S/2 SE/4 Sec. 9-223-13W, Stafford County, Kansas (120 acres)
 Location made November 19, 1949 by Sen Construction Company
330 feet from North line 330 feet from East line SE/4
 feet from South line feet from West line of Sec. 9

Work com'd 11/25 19 49 Rig comp'd 11/26 19 49 Drlg. com'd 11/26 19 49 Drlg. comp'd 12/7 19 49

Rig Contractor Claude Wentworth Drilling Co., Inc.

Drilling Contractor Claude Wentworth Drilling Co., Inc., Tulsa, Oklahoma

Rotary Drilling from Top to 3784' Cable Tool Drilling from To complete to

Commenced Producing December 12, 1949 { Initial Prod. before shot or acid 3/4 BO trees, wtr/hr. Bbls.
 Initial Prod. after shot or acid POB 8 hrs. 42.78 BO 10.70 Bbls.
wtr. to estab. 24 hr. 609 pot. 128 bbls.

Dry Gas Well Press Volume Cu. ft.

Casing Head Gas Pressure Volume Cu. ft.

Braden Head (8-5/8" x 5 1/2" O.D.) Gas Pressure Volume Cu. ft.

Braden Head (Size) Gas Pressure Volume Cu. ft.

PRODUCING FORMATION Arbuckle Line Top 3779' Bottom 3784' TOTAL DEPTH 3784'

CASING RECORD

OD Size	Wt.	Thds.	Where Set	PULLED OUT			LEFT IN			KIND	Cond'n	CEMENTING	
				Jts.	Feet	In.	Jts.	Feet	In.			Sacks Used	Method Employed
8-5/8"	19	PE				11	258	9	R1 LW	C			
8-5/8"	24	8V				3	67	10	R1 LW	C			
8-5/8"	24	8R				6	122	11	R1 LW	A			
8-5/8"	28 1/2	PE	748'	(Lot #5)			14	295	0	R1 LW	A	400 Halliburton	
5-1/2"	14	8R	3779'			161	3819	0	J55 R1 SB	A	125	Halliburton	
(8-5/8" OD casing set 6' in collar and 5 1/2" cased to derrick floor)													

Liner Set at Length Perforated at

Liner Set at Length Perforated at

Packer Set at Size and Kind

Packer Set at Size and Kind

SHOT OR ACID TREATMENT RECORD

	FIRST	SECOND	THIRD	FOURTH
Date	<u>12/12/49</u>			
Acid Used	<u>250</u>			
Size Shot	<u> </u> Gals. Qts.	<u> </u> Gals. Qts.	<u> </u> Gals. Qts.	<u> </u> Gals. Qts.
Shot Between	<u>3779</u> Ft. and <u>3784</u> Ft.	<u> </u> Ft. and <u> </u> Ft.	<u> </u> Ft. and <u> </u> Ft.	<u> </u> Ft. and <u> </u> Ft.
Size of Shell	<u> </u>			
Put in by (Co.)	<u>Dowell Inc.</u>			
Length anchor	<u> </u>			
Distance below Cas'g	<u> </u>			
Damage to Casing or Casing Shoulder	<u> </u>			

SIGNIFICANT GEOLOGICAL FORMATIONS

NAME	Top	Bottom	GAS		OIL		REMARKS
			From	To	From	To	
Lansing Lino	<u>3385'</u>						
Conglomerate	<u>3650'</u>						
Viola Lino	<u>3677'</u>						
Simpson Series	<u>3722'</u>						
Arbuckle Lino	<u>3778'</u>				<u>3778'</u>	<u>3783'</u>	spotted oil stain
					<u>3783'</u>	<u>3784'</u>	fair oil stain

CLEANING OUT RECORDS

	DATE COMMENCED	DATE COMPLETED	PROD. BEFORE	PROD. AFTER	REMARKS
1st					See Reverse for other details.
2nd					" " " " "
3rd					" " " " "
4th					" " " " "

PLUGGING BACK AND DEEPENING RECORDS

	Date Commenced	Date Completed	No. Feet Plugged Back or Deepened	Prod. Before	Prod. After	REMARKS
1st						See Reverse for other details.
2nd						" " " " "
3rd						" " " " "
4th						" " " " "

(See Reverse for Record of Formation)

RECEIVED
 STATE CORPORATION COMMISSION
 OCT 16 1951
 CONSERVATION DIVISION
 Wichita, Kans.

Moved in and rigged up cable tools of W. L. Copeland Drilling Company on August 16, 1951. Pulled rods and tubing and ran Lane-Wells Gamma Ray Survey. Set Lane-Wells bridging plug at 3500', swabbed hole dry and dumped 2 sacks of Cal-Seal from 3500' to 3484'. Perforated 5 1/2" casing with 38 holes from 3456' to 3462 1/2' by Lane-Wells, no shows. On August 18, treated through casing with 500 gallons of Halliburton 15% acid as follows:

ACID TREATMENT NO. 2 - Between 3456' and 3462 1/2'

Treatment put in 8/18/51 by Halliburton, using 500 gallons of acid and 86 barrels of water.

<u>TIME</u>	<u>CP</u>	<u>TP</u>	<u>REMARKS</u>
5:50 pm			Started acid in hole
5:54 pm			500 gallons of acid in casing
6:01 pm			Started water in hole
6:15 pm			Hole loaded
6:24 pm	750#		100 gallons of acid in formation
6:27 pm	500#		500 gallons of acid in formation

Swabbed out water used in treating, then bailed off bottom 7 hours, 4 gallons of acid water per hour with scum of oil. On August 19, treated through 5 1/2" casing with 2000 gallons of Halliburton 15% acid as follows:

ACID TREATMENT NO. 3 - Between 3456' and 3462 1/2'

Treatment put in 8/19/51 by Halliburton, using 2000 gallons of acid and 90 barrels of oil.

<u>TIME</u>	<u>CP</u>	<u>TP</u>	<u>REMARKS</u>
1:43 pm			2000 gallons of acid in casing, started flush
1:50 pm			Acid on bottom
1:55 pm	450#		Hole loaded
2:00 pm	500#		500 gallons of acid in formation
2:05 pm	550#		1000 gallons of acid in formation
2:10 pm	600#		1500 gallons of acid in formation
2:15 pm	650#		2000 gallons of acid in formation

Swabbed out oil used in treating with 48 barrels of acid water. Swabbed off bottom 12 hours, 90 barrels of water and no oil. At this time regular authority was granted to plug and abandon the well.

On September 10, moved in and rigged up machine and plugged the well as follows:

PB with sand	3484' to 3450'
5 sacks of cement	3450' to 3410'

Ripped off and pulled 2383' of 5 1/2" OD, 14#, 8R thd., R-1, J-55, SS casing.

PB with mud laden fluid	3410' to 250'
15 sacks of cement	250' to 205'
Mud laden fluid	205' to 35'
10 sacks of cement	35' to 8'
Surface soil	8' to 0'

Plugged and abandoned September 19, 1951

See

SKELLY OIL COMPANY

REPORT OF CHANGE IN WELL RECORD

Give complete description of all cleaning out, deepening, plugging back and fishing jobs, changes in casing, material lost in hole, etc., not recorded in original well record.

LEASE NAME Kelley "A" WELL NO. 1

CLEANING OUT RECORD				PLUGGING BACK OR DEEPENING RECORD			
Date commenced..... 19.....				Date commenced..... <u>October 16, 19 50</u>			
Date completed..... 19.....				Date completed..... <u>October 31, 19 50</u>			
Cleaned out from..... to..... T. D.....				Plugged back or deepened from <u>3784'</u> to <u>3781'</u> T.D. <u>3781'</u>			
Prod. before.....	bbls. oil.....	bbls. water.....	cu. ft. gas.....	Prod. before.....	bbls. oil.....	bbls. water.....	cu. ft. gas.....
Prod. after.....	bbls. oil.....	bbls. water.....	cu. ft. gas.....	Prod. after.....	bbls. oil.....	bbls. water.....	cu. ft. gas.....
Kind of tools used:.....				Kind of tools used: <u>Pulling Unit</u>			
Tools owned by:.....				Tools owned by: <u>Skelly Oil Company</u>			

SHOT RECORD

Date	Size shot	Shot between	Size of shell	Put in by (Co.)	Length anchor	Distance below casing	Damage to casing or casing shoulder
	Qts.	Ft. and Ft.					
	Qts.	Ft. and Ft.					
	Qts.	Ft. and Ft.					
	Qts.	Ft. and Ft.					

CHANGES IN CASING RECORD

SIZE	Wt.	Thds.	Where Set	PULLED OUT			LEFT IN			KIND	Cond'n	CEMENTING	
				Jts.	Feet	In.	Jts.	Feet	In.			Sacks Used	Method Employed

Liner set at..... Length..... Perforated at.....

Packer set at..... Size and kind.....

REMARKS (Give review of work accomplished and any other comment of interest) On October 16, 1950, pulled rods and tubing. On October 17, ran Dowell water locator survey, which indicated heavy production from 3781' to 3783'. On October 18, plugged back with 19 gallons of Dowell plastic from 3784' to 3781'. Ran 2" tubing and rods and repaired pumping engine. On October 23, FOB 24 hours, 10 barrels of oil and 190 barrels of water. On October 24, FOB 24 hours, 9

(Use reverse side for continuation of remarks and for formation record).

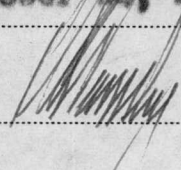

Superintendent.

SKELLY OIL COMPANY

REPORT OF CHANGE IN WELL RECORD

Give complete description of all cleaning out, deepening, plugging back and fishing jobs, changes in casing, material lost in hole, etc., not recorded in original well record.

LEASE NAME Kelley "A" (Stafford County, Kans.) WELL NO. 1

CLEANING OUT RECORD				PLUGGING BACK OR DEEPENING RECORD			
Date commenced.....	193.....			Date commenced.....	August 16, 193 <u>51</u>		
Date completed.....	193.....			Date completed.....	Sept. 19, 193 <u>51</u>		
Cleaned out from.....	to.....	T. D.....		Plugged back or deepened from.....	to.....	T. D.....	
Prod. before.....	bbls. oil.....	bbls. water.....	cu. ft. gas.....	Prod. before.....	2 bbls. oil.....	63 bbls. water.....	-- cu. ft. gas.....
Prod. after.....	bbls. oil.....	bbls. water.....	cu. ft. gas.....	Prod. after.....	0 bbls. oil.....	90 bbls. water.....	-- cu. ft. gas.....
Kind of tools used:.....				Kind of tools used:.....	Cable		
Tools owned by:.....				Tools owned by:.....	Wm. Copeland		

ACID TEST SHOT RECORD

Date	8/18/51	8/19/51		
Size shot	500 gals. Qts.	2000 gals. Qts.		
Shot between	3456 Ft. and 3462 Ft.	3456 Ft. and 3462 Ft.	Ft. and Ft.	Ft. and Ft.
Size of shell				
Put in by (Co.)	Halliburton	Halliburton		
Length anchor				
Distance below casing				
Damage to casing or casing shoulder				

CHANGES IN CASING RECORD

SIZE	Wt.	Thds.	Where Set	PULLED OUT			LEFT IN			KIND	Cond'n	CEMENTING	
				Jts.	Feet	In.	Jts.	Feet	In.			Sacks Used	Method Employed
5 1/2" OD	14 1/2	82		100	2383	0	61	1436	0	J55 R1 SS	B		

Liner set at..... Length..... Perforated at.....

Packer set at..... Size and kind.....

REMARKS (Give review of work accomplished and any other comment of interest)

(Use reverse side for continuation of remarks and for formation record).



Superintendent.