

STATE CORPORATION COMMISSION OF KANSAS
OIL & GAS CONSERVATION DIVISION

WELL COMPLETION OR RECOMPLETION FORM
ACO-1 WELL HISTORY

DESCRIPTION OF WELL AND LEASE

Operator: license # 8061
name Oil Producers, Inc. of Kansas
address P.O. Box 8647
Wichita, Kansas 67208
City/State/Zip

Operator Contact Person Diana Richecky
Phone 316-682-3022

Contractor: license # 5427
name D.R. Lauck Oil Co.

Wellsite Geologist William Shepherd
Phone 316-263-5495

PURCHASER: Inland Crude Purchasing Co.

Designate Type of Completion
 New Well Re-Entry Workover

- Oil SWD Temp Abd
- Gas Inj Delayed Comp.
- Dry Other (Core, Water Supply etc.)

OWWO: old well info as follows:
Operator
Well Name
Comp. Date Old Total Depth

WELL HISTORY

Drilling Method: Mud Rotary Air Rotary Cable

7/31/84 8/6/84 8/30/84
Start Date Date Reached TD Completion Date

3998 3948
Stat Depth PBTD

Amount of Surface Pipe Set and Cemented at 342 feet

Multiple Stage Cementing Collar Used? Yes No

If Yes, Show Depth Set feet

Alternate 2 completion, cement circulated
from feet depth to 342 w/ 200 SX cmt

API NO. 15 - 185-22041-000

County Stafford

NW SW NW Sec 3 Twp 23S Rge 14 East X West
(location)

3630 Ft North from Southeast Corner of Section
2310 Ft West from Southeast Corner of Section
(Note: locate well in section plat below)

Lease Name DeVore "C" Well# 3

Field Name Crissman North

Producing Formation Lansing H

Elevation: Ground 1951 KB 1956

Section Plat

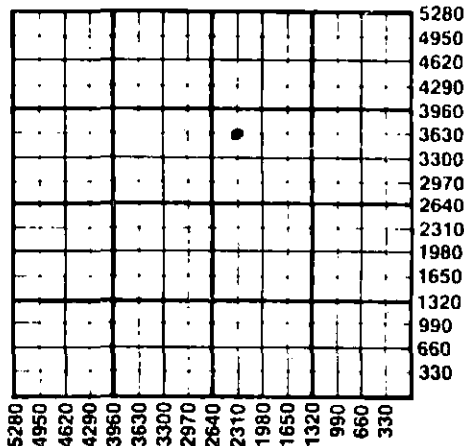

WATER SUPPLY INFORMATION

Source of Water: cancelled Permit #T 84-476
Division of Water Resources Permit # existing water well

Groundwater 3630 Ft North From Southeast Corner and
(Well) 4290 Ft. West From Southeast Corner of
DeVore #2 Sec 3 Twp 23 Rge 14 East West

Surface Water Ft North From Southeast Corner and
(Stream, Pond etc.) Ft West From Southeast Corner
Sec Twp Rge East West

Other (explain)
(purchased from city, R.W.D.#)

Disposition of Produced Water: Disposal Repressuring

Docket #

9-10-84

INSTRUCTIONS: This form shall be completed in duplicate and filed with the Kansas Corporation Commission, 2000 Dodge Derby Building, Wichita, Kansas 67202, within 90 days after completion or recompletion of any well. Rules 82-3-130 and 82-3-107 apply.

Information on side two of this form will be held confidential for a period of 12 months if requested in writing and submitted with the form. See rule 82-3-107 for confidentiality in excess of 12 months.

A true copy of all wireline logs and drillers time log shall be attached with this form. Submit CP-4 form with all plugged wells. Submit CP-111 form with all temporarily abandoned wells.

All requirements of the statutes, rules, and regulations promulgated to regulate the oil and gas industry have been fully complied with and the statements herein are complete and correct to the best of my knowledge.

Signature: [Signature]
Title: President
Date: 9/7/84
Subscribed and sworn to before me this 7th day of September 1984
Notary Public: [Signature] S.M. Miller
Notary Commission Expires: February 17, 1985

K.C.C. OFFICE USE ONLY
F Letter of Confidentiality Attached
C Wireline Log Received
C Drillers Timelog Received
Distribution
 KCC SWD/Rep NGPA
 KGS Plug Other (Specify)

Sec. 22 Twp. 23 Rge. 14W

Operator Name Oil Prod. Inc. of Ks Lease Name DeVore "C" Well# 3 SEC. 3 TWP. 23 RGE. 14 East West

WELL LOG

INSTRUCTIONS: Show important tops and base of formations penetrated. Detail all cores. Report all drill stem tests giving interval tested, time tool open and closed, flowing and shut-in pressures, whether shut-in pressure reached static level, hydrostatic pressures, bottom hole temperature, fluid recovery, and flow rates if gas to surface during test. Attach extra sheet if more space is needed. Attach copy of log.

Drill Stem Tests Taken Yes No
 Samples Sent to Geological Survey Yes No
 Cores Taken Yes No

DST #1 3645-3664 30"-45"-30"-60"
 Kansas City Test
 rec. 955' GIP, 65' OGCM (18% oi, 26% gas, 54% Mud and 2% water) Had a strong blow in 3 minutes

ISIP 394-394
 IFP 59-59
 FFP 68-68 temp: 113^o F
 FSIP 394
 IHP 1941
 FHP 1911

| Name | Formation Description | |
|-------------|-----------------------|--------|
| | Top | Bottom |
| Log | | |
| Anhydrite | 854 | +1102 |
| Heebner | 3390 | -1434 |
| Toronto | 3409 | -1453 |
| Douglas | 3426 | -1470 |
| Brown Line | 3520 | -1564 |
| Lansing KC | 3533 | -1577 |
| Cong. Shale | 3838 | -1582 |
| Eros Viola | 3858 | -1902 |
| Viola | 3884 | -1928 |
| Simpson | 3914 | -1957 |
| Arbuckle | 3968 | -2012 |
| RTD | 3998 | -2042 |
| Sample | | |
| Anydrite | 856 | |
| Heebner | 3389 | |
| Toronto | 3408 | |
| Douglas | 3426 | |
| Brown Line | 3519 | |
| Lansing KC | 3532 | |
| Cong. Shale | 3838 | |
| Viola | 3881 | |
| Simpson | 3909 | |
| Arbuckle | 3968 | |
| T.D. | 3995 | |

| CASING RECORD <input type="checkbox"/> new <input type="checkbox"/> used | | | | | | | |
|---|-------------------|---------------------------|----------------|---------------|----------------|--------------|----------------------------|
| Report all strings set - conductor, surface, intermediate, production, etc. | | | | | | | |
| Purpose of string | size hole drilled | size casing set (in O.D.) | weight lbs/ft. | setting depth | type of cement | # sacks used | type and percent additives |
| (Used) Surface | | 8 5/8 | .28# | 342 | .65/.35 POZ | 200 | 2% gel. 3% CaCl |
| (new) Prod. | 5.1/2 | 4.1/2 | .10.5 | 3996 | Class A | 130 | 2% gel. 3% KCL. 5% salt |

| PERFORATION RECORD | | Acid, Fracture, Shot, Cement Squeeze Record | |
|--------------------|---|--|------------|
| shots per foot | specify footage of each interval perforated | (amount and kind of material used) | Depth |
| 2 shots/ft. | 3653-3658' | 250 gal. 15% MA | 3653-3658' |
| 2 shots/ft. | 3644-3652' | 2500 gal. 15% retarded Acid, overflushed w/500 gal. of 2% KCL H ₂ O | 3644-3652' |

| TUBING RECORD | | | | Liner Run <input type="checkbox"/> Yes <input type="checkbox"/> No | |
|-----------------------------------|--------|--|-------|--|---------|
| size | set at | packer at | | | |
| | | | | | |
| Date of First Production | | Producing method <input type="checkbox"/> flowing <input checked="" type="checkbox"/> pumping <input type="checkbox"/> gas lift <input type="checkbox"/> Other (explain) | | | |
| Sept. 1984 | | | | | |
| Estimated Production Per 24 Hours | Oil | Gas | Water | Gas-Oil Ratio | Gravity |
| | Bbls | MCF | Bbls | | |

Disposition of gas: vented sold used on lease

METHOD OF COMPLETION open hole perforation other (specify)

Dually Completed. Commingled

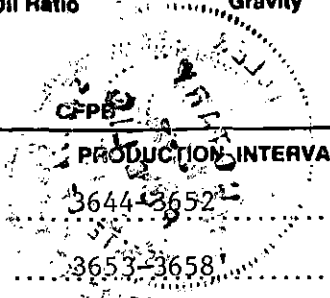

D. R. Lauck Oil Company, Inc.

221 South Broadway-Suite 400

Wichita, Kansas 67202

August 20, 1984

State of Kansas Division of Water Resources
Kansas State Board of Agriculture
109 S.W. Ninth Street
Topeka, Kansas 66612-1283

Re: Application No. T84-476 (Permit #4057)
Oil Producers, Inc. of Kansas
Devore "C" #3
NW SW NW Sec. 3-23S-14W
Stafford County, Kansas

Attention Mr. Joe Walker

Gentlemen:

Our Application for Temporary Permit to use groundwater for the subject well was filed in error. We did not drill the water well, and instead, we used the water well drilled for Oil Producers, Inc. of Kansas Devore "C" #2, NE SW NW Sec. 3-23S-14W, Stafford County, Kansas, (Application No. T84-155, your Permit #3736). Therefore, we would like to cancel our Application No. T84-476 (your Permit #4057).

Thank you for your help in this matter, and we are sorry for the inconvenience caused you in this regard.

Yours very truly,

D. R. LAUCK OIL COMPANY, INC.

John D. Knightley
President

sjl

→ cc: Oil Producers, Inc. of Kansas
P.O. Box 8647
Wichita, Kansas 67208

RECEIVED
STATE CORPORATION COMMISSION

SEP 1 0 1984

CONSERVATION DIVISION
Wichita, Kansas

2nd check #20 8-2-84
T-84-476

APPLICATION FOR TEMPORARY PERMIT

Area 2
GWD 5

- TO USE GROUNDWATER
- TO USE SURFACE WATER (check one)

Re: Oil Producers, Inc. of Kansas
Devore "C" #3
NW SW NW Sec. 3-23S-14W
Stafford County, Kansas



THE STATE OF KANSAS

Submit To:

CHIEF ENGINEER-DIRECTOR
Division of Water Resources
Kansas State Board of Agriculture
109 SW Ninth Street
Topeka, Kansas 66612-1283



A STATUTORY FILING FEE OF \$25.00 MUST ACCOMPANY THIS APPLICATION.

(1) APPLICANT

NAME D. R. Lauck Oil Company, Inc.
STREET 221 S. Broadway, Suite 400
RURAL ROUTE _____
CITY Wichita, Kansas 67202
(state) (zip)
TELEPHONE NO. (316) 263-8267
(area code)

(4) OWNER OF LAND UPON WHICH POINT OF DIVERSION IS LOCATED:

Ronnie Devore, St. John, Kansas
IF OTHER THAN APPLICANT, SUBMIT STATEMENT SHOWING OWNER'S PERMISSION TO INSTALL DIVERSION WORKS HAS BEEN OBTAINED.

Permission obtained in Oil & Gas Lease.

(5) WATER IS TO BE USED FOR:

Drilling oil and/or gas well.

(2) LOCATION OF POINT OF DIVERSION

Sec. 3, Twp. 23S, Rng. 14W (W),
Stafford County, Kansas.

(briefly describe proposed use)

DISTANCE FROM SECTION LINES:

3660 FT. FROM SOUTH LINE
&
5050 FT. FROM EAST LINE

(6) LOCATION OF PLACE OF USE:

100' East and 30' South of water well.

(3) WATER USE DATA

PROPOSED MAX. PUMPING RATE (gpm) 60
AMOUNT REQUESTED (gallons) 350,000
(not to exceed one million gallons)
DEPTH OF WELL (feet) 60, or
NAME OF STREAM _____

(7) PERIOD OF USE - (6 months max.)

July 30, 1984
(commencing - date)
August 30, 1984
(ending - date)

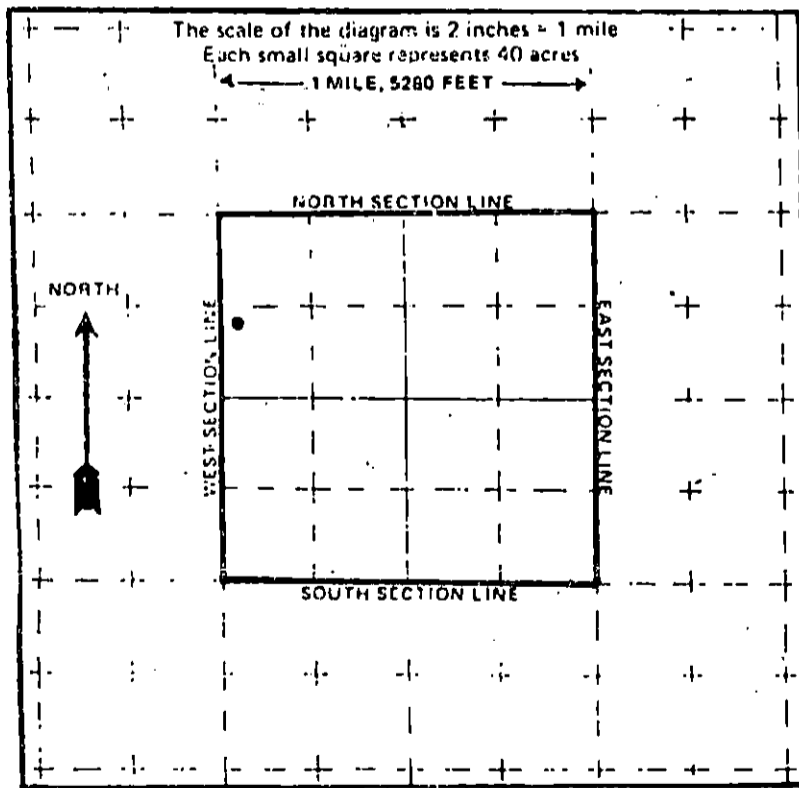

(8)

LOCATION OF THE PROPOSED POINT OF DIVERSION SHALL BE INDICATED ON THE DIAGRAM TO THE LEFT. USE THE CENTER SECTION.

IF SURFACE WATER, INDICATE ON THE DIAGRAM THE COURSE OF THE STREAM, AND ITS NAME.

RECEIVED
STATE CORPORATION COMMISSION

SEP 10 1984

CONSERVATION DIVISION
Wichita, Kansas

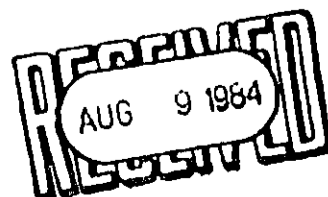

... OF THE PROPOSED ... SIDE. IF ADDITIONAL

... WELLS - None known.

Well A OWNER(S): _____
ADDRESS : _____
Well B OWNER(S): _____
ADDRESS : _____
Well C OWNER(S): _____
ADDRESS : _____

(10) FOR SURFACE WATER USE, LIST BELOW THE NAMES AND ADDRESSES OF ALL LAND-OWNERS FROM A POINT ONE-HALF MILE UPSTREAM TO A POINT ONE-HALF MILE DOWNSTREAM OF THE TRACT OF LAND UPON WHICH THE POINT OF DIVERSION IS LOCATED. IF ADDITIONAL SPACE IS NEEDED, ATTACH SHEET.

TRACT A OWNER(S): _____
ADDRESS : _____
TRACT B OWNER(S): _____
ADDRESS : _____
TRACT C OWNER(S): _____
ADDRESS : _____

(11) THE APPLICANT STATES THAT THE INFORMATION SET HEREON IS TRUE AND ACCURATE TO THE BEST OF HIS/HER KNOWLEDGE.

D. R. Lauck Oil Company, Inc.

SIGNATURE OF APPLICANT or John D. Knightley AUTHORIZED REPRESENTATIVE DATE 7/31/84
TITLE President, John D. Knightley

DO NOT WRITE BELOW THIS LINE

CONDITIONS OF APPROVAL:

THE APPLICANT SHALL MAINTAIN RECORDS FROM WHICH THE QUANTITY OF WATER ACTUALLY DIVERTED MAY BE READILY DETERMINED.

THE USE OF WATER HEREIN AUTHORIZED SHALL NOT IMPAIR ANY USE UNDER EXISTING WATER RIGHTS NOR PREJUDICALLY AND UNREASONABLY AFFECT THE PUBLIC INTEREST.

The point of diversion authorized by the approval of this application for temporary permit is more particularly described as being located in the Northwest Quarter of the Southwest Quarter of the Northwest Quarter (NW $\frac{1}{4}$ SW $\frac{1}{4}$ NW $\frac{1}{4}$) of Section 3, Township 23 South, Range 14 West, Stafford County, Kansas.

APPLICATION APPROVED

PERMIT NUMBER T84-476
DATE ISSUED Aug. 3, 1984
EXPIRATION DATE Aug. 30, 1984

Greg Ellis Hydrologist
David Pope, P.E. Chief Engineer - Director
Division of Water Resources
Kansas State Board of Agriculture
Joseph A. Walker Hydrologist