

This form shall be filed in duplicate with the Kansas Corporation Commission, 200 Colorado Derby Building, Wichita, Kansas 67202, within ten days after the completion of the well, regardless of how the well was completed.

Attach separate letter of request if the information is to be held confidential. If confidential, only file one copy. Information on side one will be of public record and side two will then be held confidential.

Circle one: Oil Gas, Dry, SWD, OWWO, Injection. Type and complete ALL sections. Applications must be filed for dual completion, commingling, SWD and injection, T.A.

Attach wireline logs (i.e. electrical log, sonic log, gamma ray neutron log, etc.). KCC # (316) 263-3238. (Rules 82-2-105 & 82-2-125)

OPERATOR The Roxana Corporation

API NO. 15-185-21,589-0000

ADDRESS P. O. Box 1162

COUNTY Stafford

Great Bend, Kansas 67530

FIELD Crissman North

**CONTACT PERSON J. C. Musgrove

PROD. FORMATION Simpson Sand

PHONE (316) 792-1383

LEASE Link

PURCHASER The Permian Corporation

WELL NO. 4

ADDRESS P. O. Box 1183

WELL LOCATION C.S/2 SW/4

Houston, Texas 77001

660 Ft. from South Line and

DRILLING Lobo Drilling Company

1320 Ft. from West Line of,

CONTRACTOR

ADDRESS P. O. Box 877

Great Bend, Kansas 67530

the SW/4 SEC. 4 TWP. 23 RGE. 14 W

PLUGGING

CONTRACTOR

ADDRESS

TOTAL DEPTH 4050' PBSD 4023'

SPUD DATE 4-13-82 DATE COMPLETED 4-18-82

ELEV: GR 1962' DF 1964' KB 1967'

DRILLED WITH (CABLE) (ROTARY) (AIR) TOOLS

Amount of surface pipe set and cemented 455'

WELL PLAT R14W

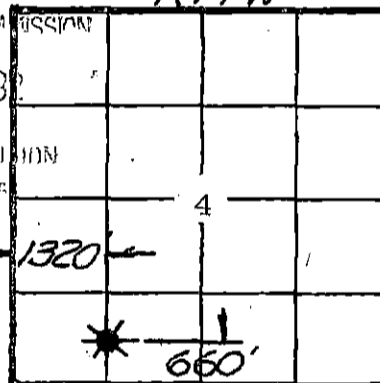

KCC KGS (Office Use)

T 23 S

AFFIDAVIT

STATE OF Kansas, COUNTY OF Barton SS, I,

James C. Musgrove OF LAWFUL AGE, BEING FIRST DULY SWORN UPON HIS OATH,

DEPOSES THAT HE IS Vice President (FOR)(OF) The Roxana Corporation

OPERATOR OF THE Link LEASE, AND IS DULY AUTHORIZED TO MAKE

THIS AFFIDAVIT FOR AND ON THE BEHALF OF SAID OPERATOR, THAT WELL NO. 4 ON

SAID LEASE HAS BEEN COMPLETED AS OF THE 15th DAY OF June, 1982, AND THAT

ALL INFORMATION ENTERED HEREIN WITH RESPECT TO SAID WELL IS TRUE AND CORRECT.

FURTHER AFFIANT SAITH NOT.

SUBSCRIBED AND SWORN BEFORE ME THIS 15th DAY OF June, 1982

(S) James C. Musgrove

Richard L. Miller

NOTARY PUBLIC

MY COMMISSION EXPIRES: July 19, 1982

**The person who can be reached by phone regarding any questions concerning this information. Within 45 days of completion, a witnessed initial test by the Commission is required if the well produces more than 25 BOPD or is located in a Basic Order Pool.

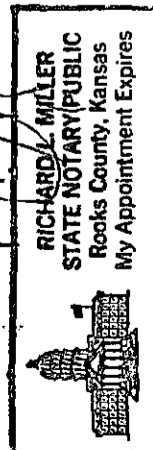

SIDE TWO

WELL LOG

Show all important zones of porosity and contents thereof; cased intervals, and all drill-stem tests, including depth interval tested, cushion used, time tool open, flowing and shut-in pressures, and recoveries.

SHOW GEOLOGICAL MARKERS, LOGS RUN, OR OTHER DESCRIPTIVE INFORMATION.

FORMATION DESCRIPTION, CONTENTS, ETC.	TOP	BOTTOM	NAME	DEPTH
NO DST.			Heebner	3214 -1445
			Brown Lime	3544 -1577
			Lansing	3556 -1589
			Base K.C.	3796 -1829
			Viola	3918 -1951
			Simpson	3950 -1983
			Simpson Sand	3964 -1997
			Arbuckle	4012 -2045
			T.D.	4049 -2082
Perf 3967-3980 - show oil & gas Nat'l. Frac with 500 gal acid, 22,500 gal. gel wtr. 190 sx 20/40 sand, 75 sx 10/20 sand. Swab 12½ bbl. fluid per hour. 75% oil.				
Tubing - rods - P.O.P.				

Report of all strings set— surface, intermediate, production, etc. CASING RECORD (New) or (Used)

Purpose of string	Size hole drilled	Size casing set (in O.D.)	Weight lbs/ft.	Setting depth	Type cement	Sacks	Type and percent additives
Surface	12 1/4"	8 5/8"	23#	455'	60/40 Poz	300	2% gel, 3% cc.
Production	7 7/8"	4 1/2"	10½#	4049'	60/40 Poz	175	Salt sat.

LINER RECORD

PERFORATION RECORD

Top, ft.	Bottom, ft.	Sacks cement	Shots per ft.	Size & type	Depth interval
			2	Dyna-Jets	3967-3980
TUBING RECORD					
Size	Setting depth	Packer set at			
2 3/8 Eue	4014'				

ACID, FRACTURE, SHOT, CEMENT SQUEEZE RECORD

Amount and kind of material used	Depth interval treated
500 acid - 22,500 gel wtr.	3967-3980
190 sx 20/40 sand, 75 sx 10/20 sand	

Date of first production	Producing method (flowing, pumping, gas lift, etc.)	Gravity		
RATE OF PRODUCTION PER 24 HOURS	Oil	Gas	Water	Gas-oil ratio
	25 bbls.	--	10 % 2 1/2 bbls.	-- CFPB
Disposition of gas (vented, used on lease or sold)			Perforations	
Lease			3967-3980	